

Assessment of Non-Water Body  
(update to mapping required)

AECOM

Date: June 12/12

Land Parcel/Site ID: JER 3598 R4.37

Page 2 of 2

Site Sketch

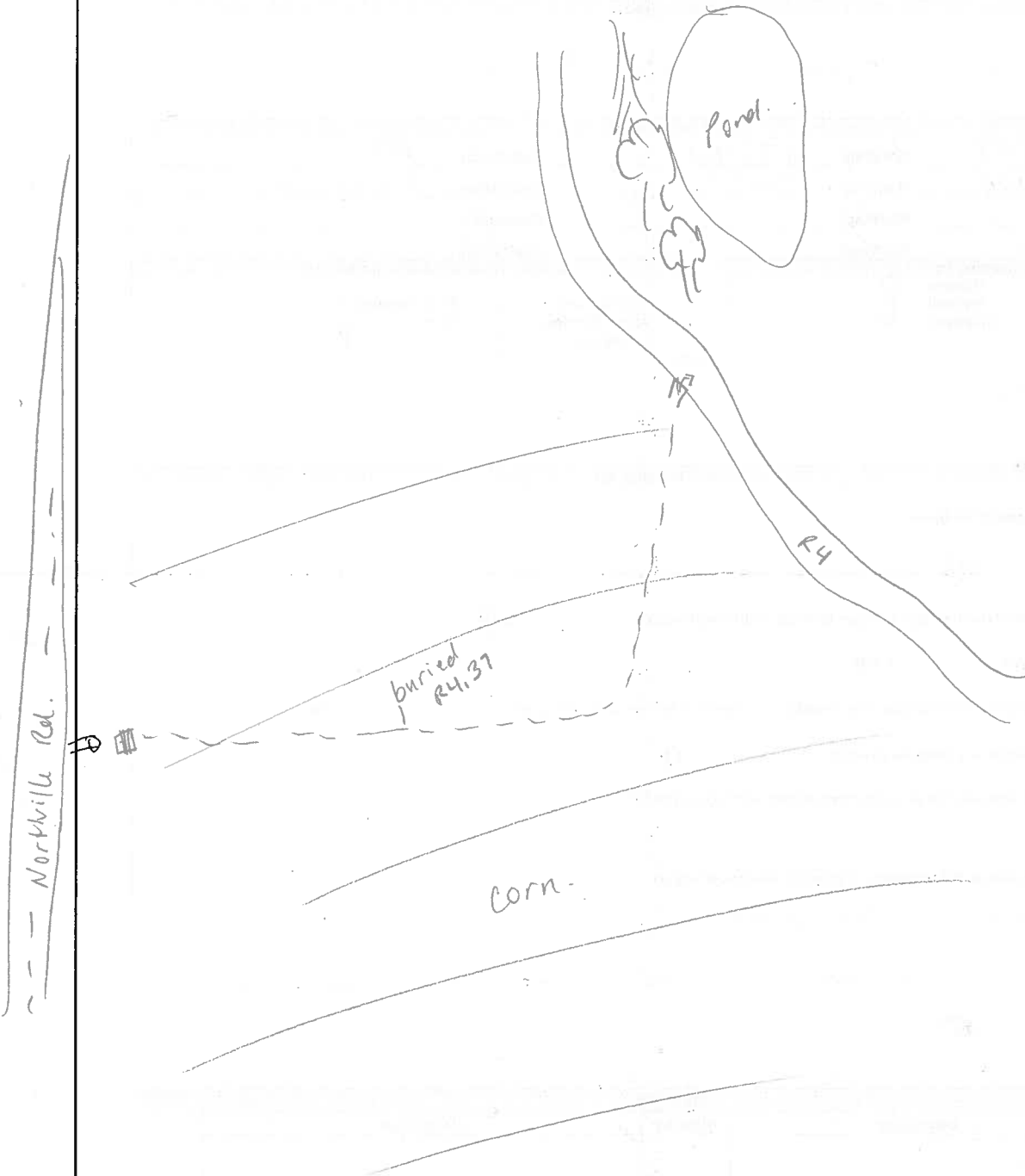

Initial QA/QC: L. Bentley June 26, 2012  
Technical QA/QC: Sktken July 10/12

**Water Bodies Assessment Field Collection Form**

<b>AECOM</b>		Page 1 of 4	
<b>General Information</b>			
Study Area: <u>Jericho</u>	<u>Goshen</u>	<u>Bluewater</u>	Land Parcel# <u>FER 3365</u> Site ID: <u>R4.27</u>
Date: <u>July 30/12</u>	Start time: <u>15:00</u>	End Time: <u>15:10</u>	
Weather Conditions: <u>Sunny 27°C</u>		Field Crew: <u>C. Boros, T. Sharney</u>	
		Field Notes By: <u>C. Boros</u>	
<b>Site Location</b>			
<u>Army Camp Rd, south of <del>Proof</del> <u>Proof</u></u>			
<u>Roadside Survey</u>			
<b>UTM Co-ordinates (continue on page 3 if necessary)</b>			
Easting: <u>0424041</u>	Northing: <u>4776279</u>	Description:	
Easting:	Northing:	Description:	
Easting:	Northing:	Description:	
Easting:	Northing:	Description:	
<b>Surrounding Landuse</b>		<b>Type of Watercourse</b>	
Residential <input type="checkbox"/>	Meadow <input type="checkbox"/>	Intermittent <input checked="" type="checkbox"/>	Channelized <input checked="" type="checkbox"/>
Agriculture <input checked="" type="checkbox"/>	Wetland <input type="checkbox"/>	Permanent <input type="checkbox"/>	Natural Channel <input type="checkbox"/>
Forest <input type="checkbox"/>	Livestock <input type="checkbox"/>	Ephemeral <input type="checkbox"/>	
Other <input type="checkbox"/>			
Description: <u>soy bean field</u>		Description: <u>straight channel</u>	
Notes: (Include any inputs into the system i.e. tile drainage, seepages, overland flow)			
<u>none observed</u>			
Is any portion of the water body underground or not as mapped? <u>Y/N</u>			
If Yes describe:			
GPS Coordinate: Easting -	Northing -	Description -	
Description of Land Topography Surrounding Water Body (rolling hills, sloping towards water body)			
<u>flat</u>			
<b>In-Situ Water Quality</b>		<b>Ground Water and Seepage Indicators</b>	
WT (°C): <u>/</u>	AT (°C): <u>/</u>	Watercress <input type="checkbox"/>	Bank Seepage <input type="checkbox"/>
pH: <u>/</u>	Cond ( s/cm): <u>/</u>	Iron Staining <input type="checkbox"/>	None <input checked="" type="checkbox"/>
D.O. (mg/L): <u>/</u>		Bubbling <input type="checkbox"/>	<input type="checkbox"/>
Water Clarity: <u>Clear</u> <input type="checkbox"/>	<u>Turbid</u> <input type="checkbox"/>	Other <input type="checkbox"/>	
Water Colour:		Details:	
Notes: <u>no water at road culvert</u>			

**Water Bodies Assessment Field Collection Form**

dry

Site Length (m): <u>50m</u>		Bank Stability:				
Channel Dimensions		Stable	Slightly unstable	Moderately unstable	Unstable	
Mean Wetted Width (m): <u>0.7</u>	Mean Wetted Depth (m): <u>/</u>	Left Bank <input checked="" type="checkbox"/>	<input type="checkbox"/>	<input type="checkbox"/>	<input type="checkbox"/>	
Mean Bankfull Width (m): <u>2.5</u>	Mean Bankfull Depth (m): <u>/</u>	Right Bank <input checked="" type="checkbox"/>	<input type="checkbox"/>	<input type="checkbox"/>	<input type="checkbox"/>	
Mean Top of Bank Width (m): <u>5.5</u>	Mean Top of Bank Depth (m): <u>/</u>	Description: <u>well vegetated</u>				
Flow Description: (high or low flow conditions, stagnant, etc)						
<u>no flow → dry channel except for small pool of water 40m from road</u>						
Substrate (< = >)		Morphological Structure (%)				
Description		Pool	Riffle	Run	Flat	
Bo - Boulder Co - Cobble Gr - Gravel Sa - Sand Si - Silt Cl - Clay MK - Muck DT - Detritus		Notes: <u>dry</u>				
<u>sa = cl = si</u>						
Instream Cover (%)						
Other	Woody Debris	Boulders	Cobble	Aquatic Vegetation*	None	Undercut Banks
			<u>2</u>	<u>19</u>		Average Depth: (% Cover)
Note: Low = 0 - 30%; Moderate = 30 - 75%; High = 75 - 100%						
*Aquatic Vegetation Species Present (algae, submergent, emergent etc.)						
<u>grasses</u>						
Canopy Cover (% closed cover):			Types of Cover (% cover)			
100-90%	<input type="checkbox"/>	30-1%	<input checked="" type="checkbox"/>	Trees <u>5</u>	Shrubs <u>20</u>	Man-made structures
90-60%	<input type="checkbox"/>	0%	<input type="checkbox"/>	Grasses <u>75</u>	Herbaceous	Other
60-30%	<input type="checkbox"/>					
Note: Low = 0 - 30%; Moderate = 30 - 60%; High = 60 - 100%						
Notes: (vegetation species, types of structures)						
<u>yellow fox tail, dogwood</u>						
Riparian Vegetation			Riparian Vegetation			
Width and Description of riparian vegetation:			Width and Description of riparian vegetation:			
LB - <u>1.5m - meadow</u>			RB - <u>1.5m - meadow</u>			
Overhanging Vegetation Present Y / N <input checked="" type="checkbox"/>			% Overhanging Vegetation:			
Description of Overhanging Vegetation:						
None Observed <input type="checkbox"/> Man-Made <input type="checkbox"/> Natural <input type="checkbox"/> Low Flow Barrier <input checked="" type="checkbox"/>						
Description of Barrier: <u>dry channel</u>						
Height of Barrier (m)			GPS Coordinates:			

**Water Bodies Assessment Field Collection Form**

**AECOM**

Date: *July 30/12*

Land Parcel/Site ID: *JER 3365*

Page 3 of 4

*RA.27*

**Other General Comments Regarding the Study Area:**

*Channel dry except for one small pool (40m from road). Straight & channelized w well vegetated banks.*

**Additional UTM Coordinates:**

Photo Log			
Picture #	Description	Picture #	Description
<i>1-3</i>	<i>east side - channel</i>		
<i>4</i>	<i>field on west side</i>		

Water Bodies Assessment Field Collection Form

AECOM

Page 4 of 4

Study Area:

Jericho

Goshen

Bluewater

Land Parcel

TR 3365

Site ID

R 4.27

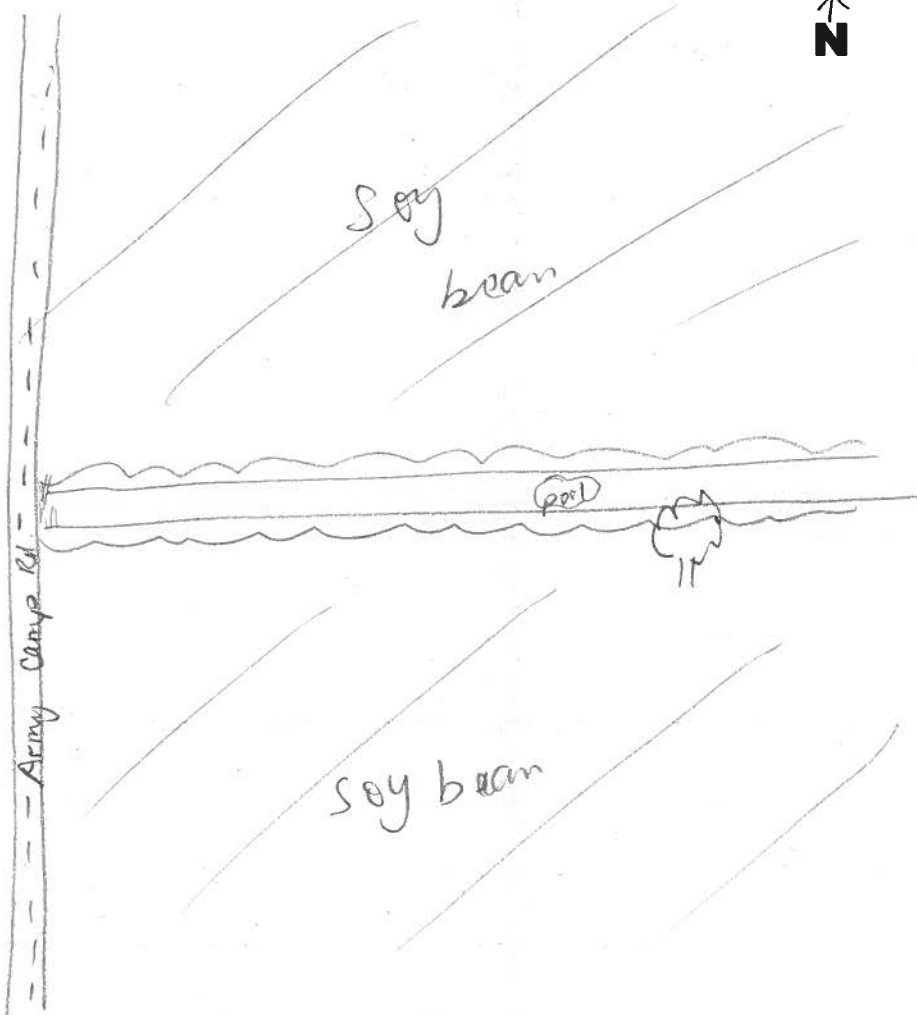

LEGEND	
10d depth (cm)	→
6w width	⇨
Riffle	⇨
Run/Glide	⇨
Pool	○
Island/Bar	■
Fine Substrate	□
Gravel Substrate	##
Cobble/Boulder	oOooO
Debris	***
Cattail	CT
Submerg/Float Veg	SV/FV
Emergent Vegetation	EV
Watercress	W
Iron Staining	Fe
Eroded Bank	
Riprap / Other Stabilization	xxx
Instream Log/Tree	☐
Dam/Weir/Obstruction	AAA
Riparian Tree	⊙
Seep/Spring	↳
Undercut Bank	—
Barrier to Fish Movement	—
Seasonal Barrier	-S-
Fence line	-x-x-
Culvert	⌊

Horizontal View of Channel

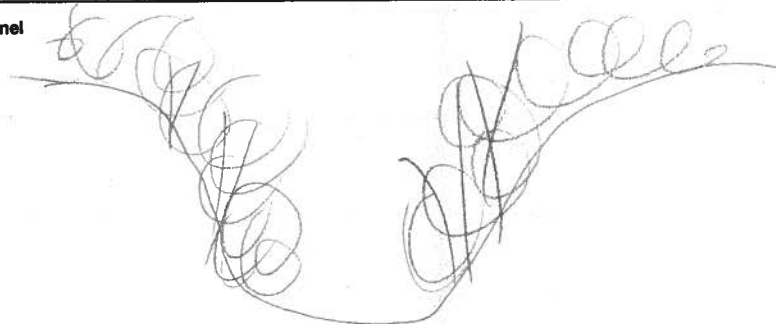

Initial QA/QC By: L. Bentley

Date: August 14, 2012

Technical QA/QC By: [Signature]

Date: Oct 2/12

**Water Bodies Assessment Field Collection Form**

**AECOM**

**General Information**

Study Area: Jericho ~~Goshen~~ Bluewater Land Parcel# JE 3481/1064/ Site ID: R 4.8 C  
 Date: July 25 / 12 Start time: 11:35 3300 End Time:

Weather Conditions: Sunny 25°C Field Crew: C. Boros, J. EPP  
 Field Notes By: C. Boros

**Site Location**

Northville Rd & Ravenswood Rd.

**UTM Co-ordinates (continue on page 3 if necessary)**

Easting: 428536 Northing: 4780147 Description: R 4.8s  
 Easting: 427994 Northing: 4780880 Description: R 4.8e  
 Easting: \_\_\_\_\_ Northing: \_\_\_\_\_ Description: \_\_\_\_\_  
 Easting: \_\_\_\_\_ Northing: \_\_\_\_\_ Description: \_\_\_\_\_

**Surrounding Landuse**

Residential  Meadow   
 Agriculture  Wetland   
 Forest  Livestock   
 Other \_\_\_\_\_

Description: soy bean fields, then forest + meadow then soy bean field again

**Type of Watercourse**

Intermittent  Channelized   
 Permanent  Natural Channel   
 Ephemeral  \_\_\_\_\_

Description: Dry - most likely channelized by farmer - starting to naturalize

**Notes: (include any inputs into the system i.e. tile drainage, seepages, overland flow)**

tile drain observed - not flowing

Is any portion of the water body underground or not as mapped? Y (N)  
 If Yes describe:

GPS Coordinate: Easting - \_\_\_\_\_ Northing - \_\_\_\_\_ Description - \_\_\_\_\_

**Description of Land Topography Surrounding Water Body (rolling hills, sloping towards water body)**

flat

**In-Situ Water Quality**

WT (°C): \_\_\_\_\_ AT (°C): \_\_\_\_\_  
 pH: \_\_\_\_\_ Cond ( s/cm): \_\_\_\_\_  
 D.O. (mg/L) \_\_\_\_\_  
 Water Clarity: Clear  Turbid   
 Water Colour: \_\_\_\_\_

Notes: Dry - no water for wq

**Ground Water and Seepage Indicators**

Watercress  Bank Seepage   
 Iron Staining  None   
 Bubbling  \_\_\_\_\_   
 Other

Details:

**Water Bodies Assessment Field Collection Form**

Stream Morphology																							
Site Length (m): 600m			Bank Stability:																				
* <u>Dry</u>			<table border="0" style="width:100%;"> <tr> <td></td> <td align="center">Stable</td> <td align="center">Slightly unstable</td> <td align="center">Moderately unstable</td> <td align="center">Unstable</td> <td></td> </tr> <tr> <td>Left Bank</td> <td align="center"><input checked="" type="checkbox"/></td> <td align="center"><input type="checkbox"/></td> <td align="center"><input type="checkbox"/></td> <td align="center"><input type="checkbox"/></td> <td></td> </tr> <tr> <td>Right Bank</td> <td align="center"><input checked="" type="checkbox"/></td> <td align="center"><input type="checkbox"/></td> <td align="center"><input type="checkbox"/></td> <td align="center"><input type="checkbox"/></td> <td></td> </tr> </table>				Stable	Slightly unstable	Moderately unstable	Unstable		Left Bank	<input checked="" type="checkbox"/>	<input type="checkbox"/>	<input type="checkbox"/>	<input type="checkbox"/>		Right Bank	<input checked="" type="checkbox"/>	<input type="checkbox"/>	<input type="checkbox"/>	<input type="checkbox"/>	
	Stable	Slightly unstable	Moderately unstable	Unstable																			
Left Bank	<input checked="" type="checkbox"/>	<input type="checkbox"/>	<input type="checkbox"/>	<input type="checkbox"/>																			
Right Bank	<input checked="" type="checkbox"/>	<input type="checkbox"/>	<input type="checkbox"/>	<input type="checkbox"/>																			
Channel Dimensions			Description: well vegetated																				
Mean <del>Wetted</del> Width (m):	1.5	Mean Wetted Depth (m):	/																				
Mean Bankfull Width (m):	2.5	Mean Bankfull Depth (m):	0.4																				
Mean Top of Bank Width (m):	4	Mean Top of Bank Depth (m):	1																				
Flow Description: (high or low flow conditions, stagnant, etc)																							
Dry - no flow																							
Habitat																							
Substrate (< = >)			Morphological Structure (%)																				
Description Bo - Boulder Co - Cobble Gr - Gravel Sa - Sand Si - Silt Cl - Clay MK - Muck DT - Detritus			<table border="1" style="width:100%; text-align: center;"> <tr> <th>Pool</th> <th>Riffle</th> <th>Run</th> <th>Flat</th> </tr> <tr> <td> </td> <td> </td> <td> </td> <td> </td> </tr> </table>			Pool	Riffle	Run	Flat														
Pool	Riffle	Run	Flat																				
Bedrock = clay > gr, sa, si			Notes: some areas of meandering but mostly straight																				
Instream Cover (%)																							
Other	Woody Debris	Boulders	Cobble	Aquatic Vegetation*	None	Undercut Banks																	
	2	5	20	10		Average Depth: (% Cover)																	
Note: Low = 0 - 30%; Moderate = 30 - 75%; High = 75 - 100%																							
*Aquatic Vegetation Species Present (algae, submergent, emergent etc.)																							
grasses - emergent																							
Canopy Cover (% closed cover):			Types of Cover (% cover)																				
100-90%	<input type="checkbox"/>	30-1%	<input type="checkbox"/>	Trees	30	Shrubs	10	Man-made structures															
90-60%	<input type="checkbox"/>	0%	<input type="checkbox"/>	Grasses	10	Herbaceous	50	Other															
60-30%	<input checked="" type="checkbox"/>																						
Note: Low = 0 - 30%; Moderate = 30 - 60%; High = 60 - 100%																							
Notes: (vegetation species, types of structures)																							
Oak, grapevine																							
Riparian Vegetation																							
Width and Description of riparian vegetation:			Riparian Vegetation																				
LB - 1-2m meadow in agr; 10m forest			RB - 1-2m meadow in agr; 10m forest																				
Overhanging Vegetation Present			% Overhanging Vegetation:																				
Description of Overhanging Vegetation:			2																				
Some grapevine + Hawthorn																							
Obstructions to Fish Passage																							
None Observed	<input type="checkbox"/>	Man-Made	<input type="checkbox"/>	Natural	<input type="checkbox"/>	Low Flow Barrier	<input checked="" type="checkbox"/>																
Description of Barrier: Channel dry																							
Height of Barrier (m)			GPS Coordinates:																				

**Water Bodies Assessment Field Collection Form**

**AECOM**

Date: *July 25/12*

Land Parcel/Site ID:

*J5K 3481, 1064,  
3300*

Page 3 of 4

*E4.B.C*

**Other General Comments Regarding the Study Area:**

*Walked from Ravenswood north.*

*Watercourse dry. Channelized feature that runs through  
agri fields and one section of deciduous forest. Substrate  
bedrock + dry clay w/ rubble + boulder. Banks well vegetated*

**Additional UTM Coordinates:**

**Photo log**

Picture #	Description	Picture #	Description
<i>1-8</i>	<i>* See map section 1</i>		
<i>9-18</i>	<i>2</i>		
<i>19-24</i>	<i>3</i>		
<i>25-29</i>	<i>4</i>		



Water Bodies Assessment Field Collection Form

AECOM

Page 4 of 4

Watercourse Sketch

Study Area:

Jericho
~~Goshen~~
Bluewater
Land Parcel#
JSP 3481
Site ID
R48E  
1064/  
3300

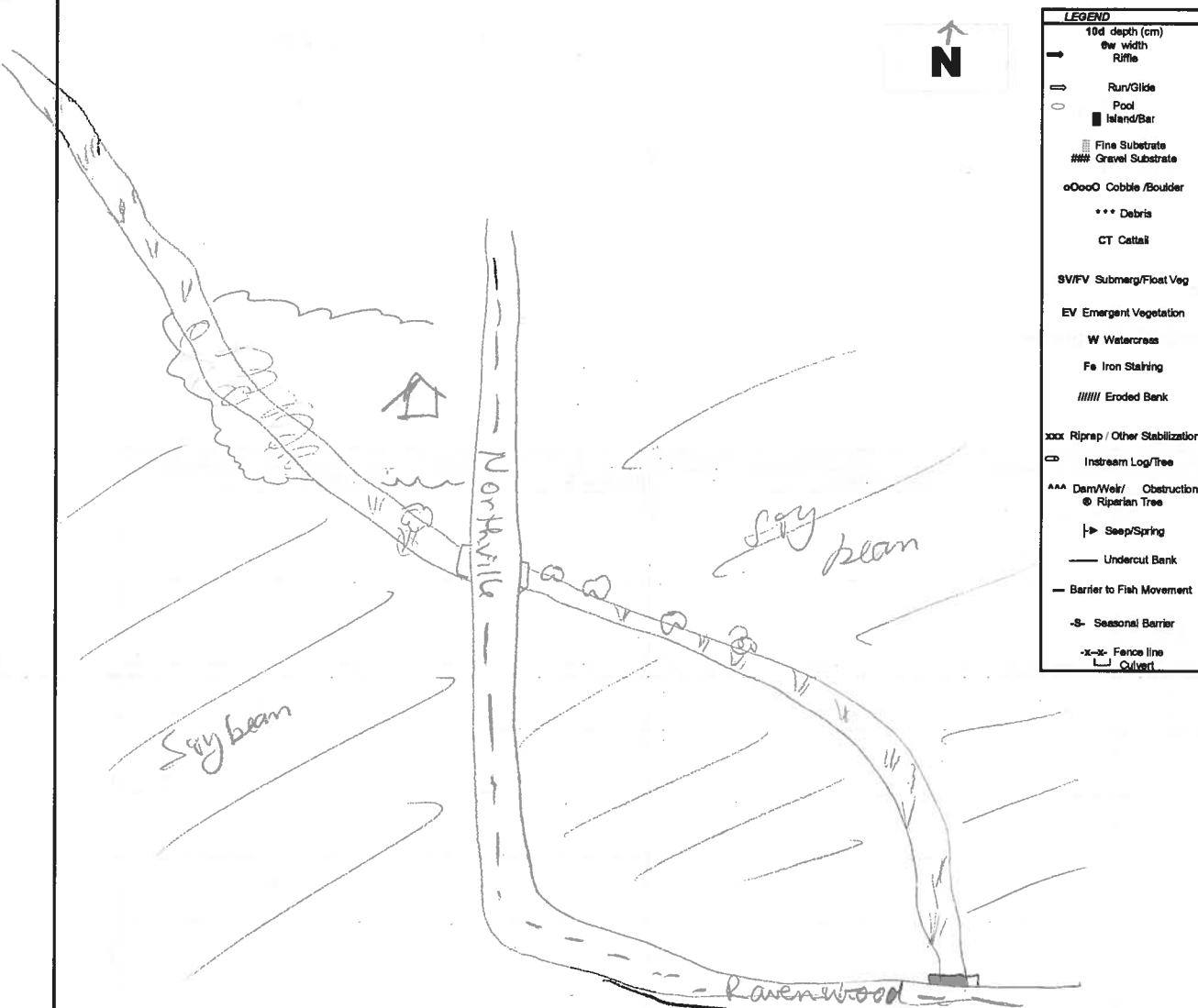

LEGEND	
→	10d depth (cm) 0w width Riffle
⇌	Run/Glide
○	Pool
■	Island/Bar
▨	Fine Substrate
###	Gravel Substrate
oOooO	Cobble /Boulder
***	Debris
CT	Cattail
SV/FV	Submerg/Float Veg
EV	Emergent Vegetation
W	Watercross
Fe	Iron Staining
	Eroded Bank
xxx	Riprap / Other Stabilization
⊃	Instream Log/Tree
AAA	Dam/Weir/ Obstruction
⊙	Riparian Tree
↳	Seep/Spring
—	Undercut Bank
—	Barrier to Fish Movement
-S-	Seasonal Barrier
-x-x-	Fence line
⌊	Outlet

Horizontal View of Channel



Initial QA/QC By: L Bentley

Date: August 14, 2012

Technical QA/QC By: [Signature]

Date: Oct 2/12

**Assessment of Non-Water Body  
(update to mapping required)**

**AECOM**

**General Information**

Study Area: Jericho Goshen Bluewater Land Parcel# JER 3607 Site ID: R4.45-JER3607

Date: MAY 17/12 Start time: 12:50 PM End Time: 13:00 PM

Weather Conditions: SUNNY, 16°C Field Crew: S. LOHNES J. EPP  
Field Notes By: S. LOHNES

**Site Location**

~~WAS~~ east of Gordon, south of Cedar Point Line.

**UTM Co-ordinates**

Easting: \_\_\_\_\_ Northing: \_\_\_\_\_ Description: \_\_\_\_\_  
Easting: \_\_\_\_\_ Northing: \_\_\_\_\_ Description: \_\_\_\_\_  
Easting: \_\_\_\_\_ Northing: \_\_\_\_\_ Description: \_\_\_\_\_  
Easting: \_\_\_\_\_ Northing: \_\_\_\_\_ Description: \_\_\_\_\_

<b>Surrounding Landuse</b> Residential <input type="checkbox"/> Agriculture <input checked="" type="checkbox"/> Forest <input type="checkbox"/> Other <input type="checkbox"/>		<b>Ground Water and Seepage Indicators</b> Watercress <input type="checkbox"/> Iron Staining <input type="checkbox"/> Bubbling <input type="checkbox"/>	
Meadow <input type="checkbox"/> Wetland <input type="checkbox"/> Livestock <input type="checkbox"/>		Bank Seepage <input type="checkbox"/> None <input checked="" type="checkbox"/>	
Description:		Details:	

**Feature Description**

Is the mapped water body any of the below:

- 1) a grassed waterway? Y (N)
- 2) Temporary channel for surface drainage, that can be tilled or driven through? Y (N)
- 3) Rock chutes or spillways? Y (N)
- 4) Roadside ditches that are not connected or do not contain a permanent or intermittent stream? Y (N)
- 5) Temporarily ponded areas that are normally farmed? Y (N)
- 6) Artificial bodies of water intended for storage, treatment for farming purposes? Y (N)
- 8) Any other: no waterbody, remove from mapping

Description: (i.e. length of change, if it reappears, if there is evidence of water)

**Photo log**

Picture #	Description	Picture #	Description
1	sheet		
2	overview (facing east)		

Assessment of Non-Water Body  
(update to mapping required)

AECOM

Date: MAY 17/12

Land Parcel/Site ID: R4.45\_JER3607

Page 2 of 2

Site Sketch

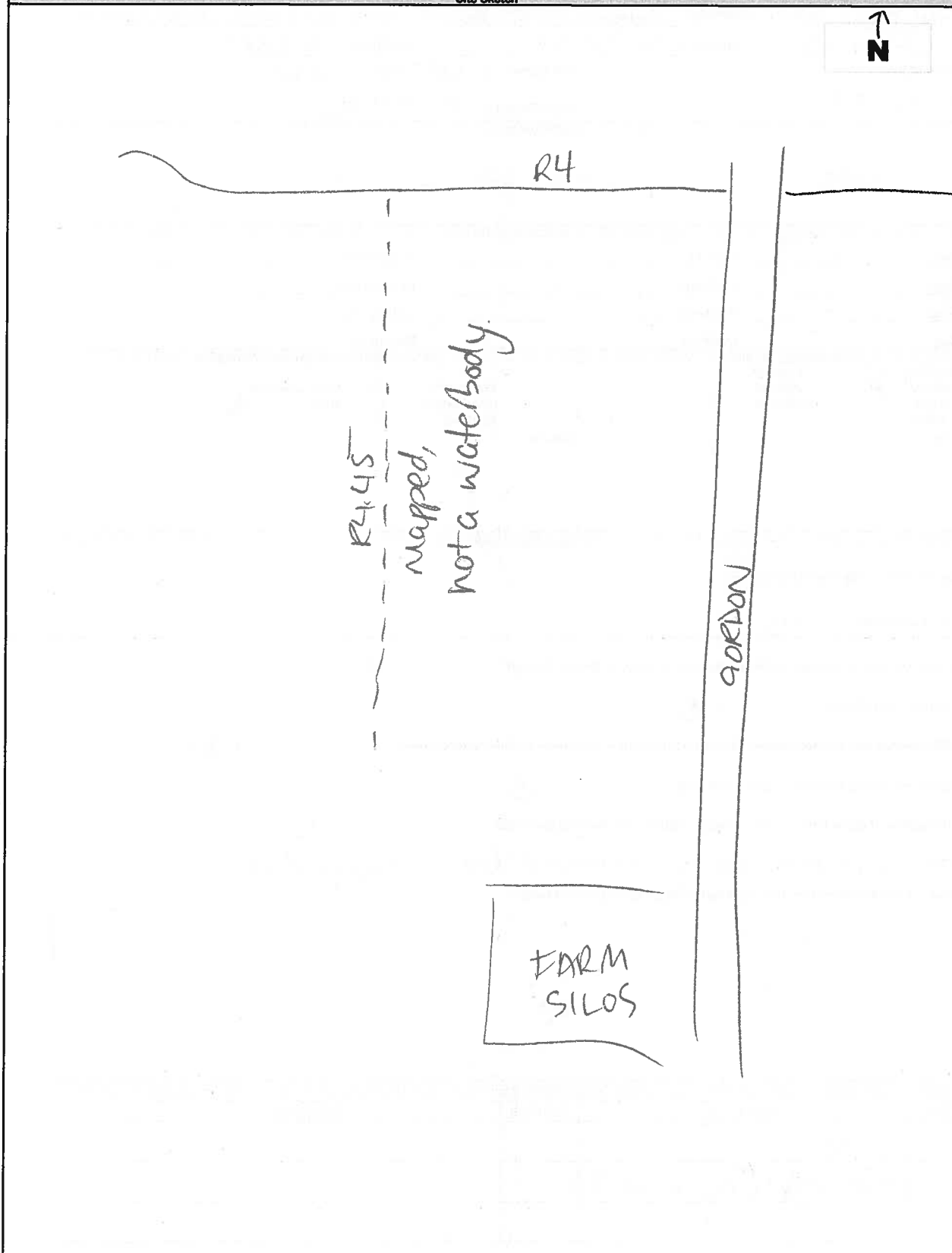
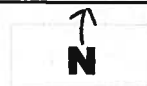

Initial QA/QC: L. Bentley May 22, 2012

Technical QA/QC: S. C. C. July 10/12

Water Bodies Assessment Field Collection Form

AECOM

General Information

Study Area: Jericho Goshen Bluewater Land Parcel# JER 3498/3553 Site ID: R4.8A  
 Date: May 23/12 Start time: 15:10 End Time: 15:40  
 Weather Conditions: Sunny 25°C Field Crew: C. Birou, J. Epp  
 Field Notes By: C. Birou

Site Location

Thompson Ln, west of Gordon.

UTM Co-ordinates (continue on page 3 if necessary)

Easting: <u>429195</u>	Northing: <u>4778179</u>	Description: <u>R4.8 JER3493</u>
Easting: <u>429982</u>	Northing: <u>4784872</u>	Description: <u>R4.8 JER3553 wa</u>
Easting: <u>429163</u>	Northing: <u>4777957</u>	Description: <u>R4.8 JER3553 wa</u>
Easting:	Northing:	Description:

Surrounding Landuse		Type of Watercourse	
Residential <input type="checkbox"/>	Meadow <input type="checkbox"/>	Intermittent <input type="checkbox"/>	Channelized <input checked="" type="checkbox"/>
Agriculture <input checked="" type="checkbox"/>	Wetland <input type="checkbox"/>	Permanent <input checked="" type="checkbox"/>	Natural Channel <input type="checkbox"/>
Forest <input type="checkbox"/>	Livestock <input type="checkbox"/>	Ephemeral <input type="checkbox"/>	
Other <input type="checkbox"/>			
Description: <u>planted crop fields</u>		Description: <u>straight</u>	

Notes: (include any inputs into the system i.e. tile drainage, seepages, overland flow)  
tile drain inputs observed - flowing

Is any portion of the water body underground or not as mapped? Y / N  
 If Yes describe:

GPS Coordinate: Easting - Northing - Description -  
 Description of Land Topography Surrounding Water Body (rolling hills, sloping towards water body)  
flat

In-Situ Water Quality		Ground Water and Seepage Indicators	
WT (°C): <u>29.86</u>	AT (°C): <u>25</u>	Watercress <input type="checkbox"/>	Bank Seepage <input type="checkbox"/>
pH: <u>8.42</u>	Cond (µs/cm): <u>737</u>	Iron Staining <input type="checkbox"/>	None <input checked="" type="checkbox"/>
D.O. (mg/L) <u>10.08</u>		Bubbling <input type="checkbox"/>	
Water Clarity: Clear <input checked="" type="checkbox"/> Turbid <input type="checkbox"/>		Other <input type="checkbox"/>	
Water Colour: <u>n/a</u>		Details: <u>/</u>	
Notes: <u>north side of Thompson</u> <u>small pool, algae present</u>			

**Water Bodies Assessment Field Collection Form**

Stream Morphology							
Site Length (m): <u>120m</u>			Bank Stability:				
Channel Dimensions			Stable	Slightly unstable	Moderately unstable	Unstable	
Mean Wetted Width (m): <u>0.5</u>	Mean Wetted Depth (m): <u>0.10</u>	Left Bank	<input checked="" type="checkbox"/>	<input type="checkbox"/>	<input type="checkbox"/>	<input type="checkbox"/>	
Mean Bankfull Width (m): <u>1</u>	Mean Bankfull Depth (m): <u>0.30</u>		Right Bank	<input checked="" type="checkbox"/>	<input type="checkbox"/>	<input type="checkbox"/>	<input type="checkbox"/>
Mean Top of Bank Width (m): <u>3</u>	Mean Top of Bank Depth (m): <u>2</u>	Description: <u>well veg.</u>					
Flow Description: (high or low flow conditions, stagnant, etc) <u>slow flow</u>							
Habitat							
Substrate (< = >)			Morphological Structure (%)				
Description Bo - Boulder Co - Cobble Gr - Gravel Sa - Sand Si - Silt Cl - Clay MK - Muck DT - Detritus  <u>si, cl, mk</u>			Pool	Riffle	Run	Flat	
						<u>100</u>	
			Notes: <u>straight</u>				
Instream Cover (%) <u>80</u>							
Other	<u>Small</u> Woody Debris	Boulders	Cobble	Aquatic Vegetation*	None	Undercut Banks	
<u>/</u>	<u>10</u>	<u>/</u>	<u>/</u>	<u>70</u>	<u>/</u>	Average Depth: (% Cover) <u>/</u>	
Note: Low = 0 - 30%; Moderate = 30 - 75%; High = 75 - 100%							
*Aquatic Vegetation Species Present (algae, submergent, emergent etc.) <u>algae - attached &gt; algae - blooms &gt; emergent grasses &gt;&gt; sedges</u>							
Canopy Cover (% closed cover):				Types of Cover (% cover)			
100-90%	<input type="checkbox"/>	30-1%	<input checked="" type="checkbox"/>	Trees	Shrubs <u>50</u>	Man-made structures	
90-60%	<input type="checkbox"/>	0%	<input type="checkbox"/>	Grasses <u>50</u>	Herbaceous	Other	
60-30%	<input type="checkbox"/>						
Note: Low = 0 - 30%; Moderate = 30 - 60%; High = 60 - 100%							
Notes: (vegetation species, types of structures) <u>dogwood, hawthorn, ash.</u>							
Riparian Vegetation							
Width and Description of riparian vegetation: LB - <u>1.5m - meadow + grasses</u>			RB - <u>1.5m - meadow + grasses</u>				
Overhanging Vegetation Present <input checked="" type="checkbox"/> N			% Overhanging Vegetation: <u>10</u>				
Description of Overhanging Vegetation: <u>sporadic dogwood + hawthorn on South side.</u>							
Obstructions to Fish Passage							
None Observed	<input checked="" type="checkbox"/>	Man-Made	<input type="checkbox"/>	Natural	<input type="checkbox"/>	Low Flow Barrier	<input type="checkbox"/>
Description of Barrier:							
Height of Barrier (m)			GPS Coordinates:				

**Water Bodies Assessment Field Collection Form**

**AECOM**

Date: May 23 / 12

Land Parcel/Site ID: R4.8A  
JER 3493/3553

Page 3 of 4

**Other General Comments Regarding the Study Area:**

- minnows observed, green frog heard  
 - Watercourse similar 40m north of study area and south  
 - chimney crayfish homes observed on JER 3493

Moving from upstream to downstream watercourse starts out in ~~open area~~ open area moving into a <sup>partial</sup> closed canopy heads under the road and flows into a grass choked channel. The entire reach is straight and has a soft bottom. Very little overhanging veg.

**Additional UTM Coordinates:**

**Photo log**

Picture #	Description	Picture #	Description
1a 1b	Sheet from road looking N		
2	North start looking at road		
3-4	Channel overview		
5	chimney crayfish home		
6-7	Channel overview		
8-9	culvert on North side		
10-11	Convergence area		
12-17	overview South side		

North side

Water Bodies Assessment Field Collection Form

AECOM

Page 4 of 4

Watercourse Sketch

Study Area:

Jericho

Goshen

Bluewater

Land Parcel#

JER 3493/3553

Site ID

R4.8A

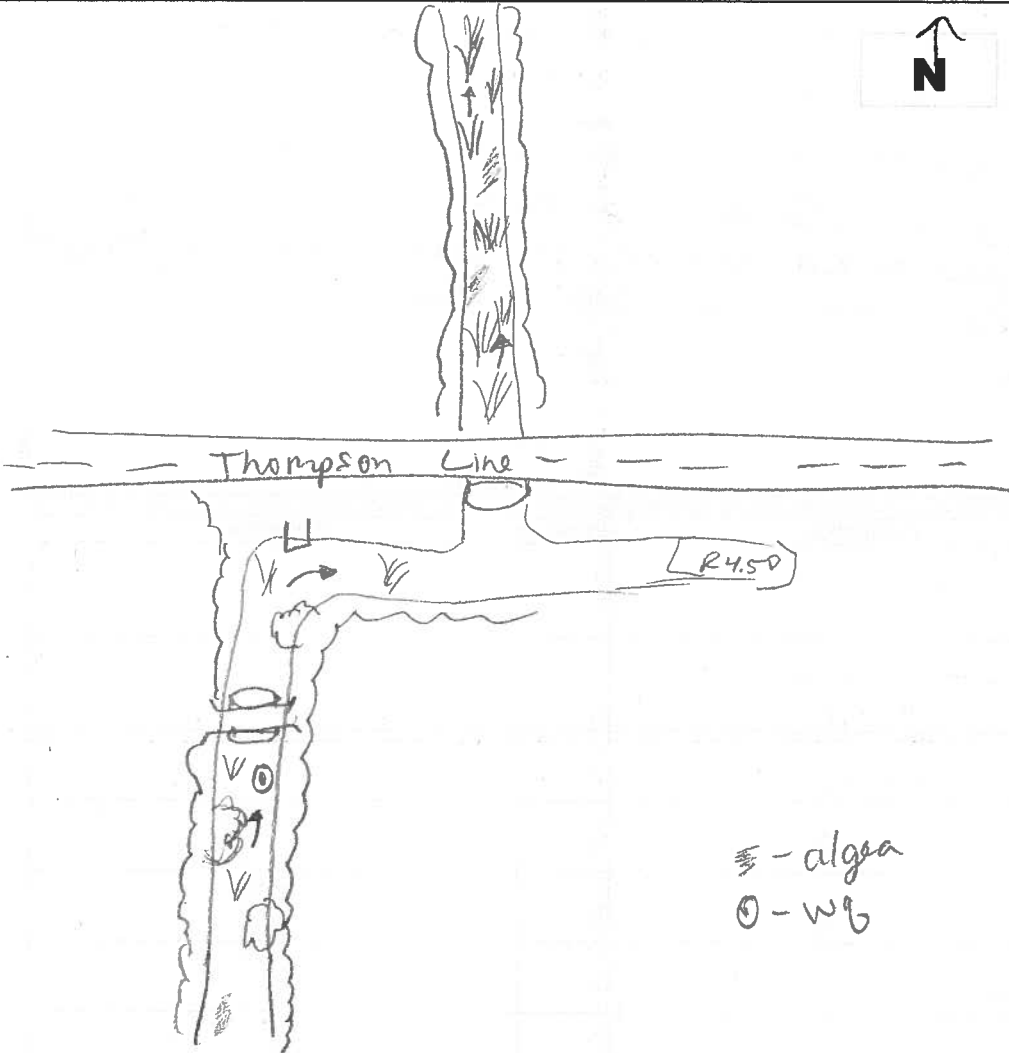

LEGEND	
10d depth (cm)	→
Sw width	⇌
Rifle	⇌
Run/Glide	⇌
Pool	○
Island/Bar	■
Fine Substrate	▨
Gravel Substrate	###
Cobble/Boulder	oOooO
Debris	***
Cattail	CT
Submerg/Float Veg	SV/FV
Emergent Vegetation	EV
Watercress	W
Iron Slaking	Fe
Eroded Bank	////
Riprap / Other Stabilization	xxx
Instream Log/Tree	⊃
Dam/Weir/ Obstruction	AAA
Riparian Tree	⊙
Seep/Spring	↳
Undercut Bank	—
Barrier to Fish Movement	—
Seasonal Barrier	-S-
Fence line	-x-x-
Culvert	□

≡ - algae  
○ - WB

Horizontal View of Channel

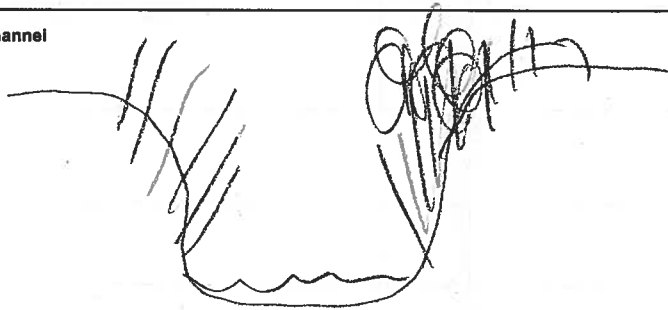

Initial QA/QC By: L. Bentley

Date: May 30, 2012

Technical QA/QC By: [Signature] Date: Jun 11/12

Water Bodies Assessment Field Collection Form

<b>AECOM</b>		Page 1 of 4	
<b>General Information</b>			
Study Area: <u>Jericho</u>	Goshen: _____	Bluewater Land Parcel# <u>JER 3553/3563</u>	Site ID: <u>R4.50</u>
Date: <u>May 23 / 12</u>	Start time: <u>15:40</u>	End Time: <u>16:10</u>	
Weather Conditions: <u>Sunny 25°C</u>		Field Crew: <u>C. Boros, J. Epp</u>	
		Field Notes By: <u>C. Boros</u>	
<b>Site Location</b>			
<u>Just south of Thomson Line, West of Gordon.</u>			
<b>UTM Co-ordinates (continue on page 3 if necessary)</b>			
Easting: <u>429221</u>	Northing: <u>4778032</u>	Description: <u>R4.50 start</u>	
Easting: <u>429246</u>	Northing: <u>4777946</u>	Description: <u>R4.50 e</u>	
Easting: <u>429240</u>	Northing: <u>4778032</u>	Description: <u>R4.50 wq</u>	
Easting: <u>429181</u>	Northing: <u>4778032</u>	Description: <u>4.8 JER 3553+ → Rock pile</u>	
<b>Surrounding Landuse</b>		<b>Type of Watercourse</b>	
Residential <input type="checkbox"/>	Meadow <input type="checkbox"/>	Intermittent <input checked="" type="checkbox"/>	Channelized <input checked="" type="checkbox"/>
Agriculture <input checked="" type="checkbox"/>	Wetland <input type="checkbox"/>	Permanent <input type="checkbox"/>	Natural Channel <input type="checkbox"/>
Forest <input type="checkbox"/>	Livestock <input type="checkbox"/>	Ephemeral <input type="checkbox"/>	
Other <input type="checkbox"/>		Description: <u>dry at time of investigation except for first 10m</u>	
Description: <u>planted crop fields</u>			
<b>Notes: (include any inputs into the system i.e. tile drainage, seepages, overland flow)</b>			
<u>tile drains - flowing at road</u>			
Is any portion of the water body underground or not as mapped? <u>Y / N</u>			
If Yes describe:			
GPS Coordinate: Easting -	Northing -	Description -	
<b>Description of Land Topography Surrounding Water Body (rolling hills, sloping towards water body)</b>			
<u>flat</u>			
<b>In-Situ Water Quality</b>		<b>Ground Water and Seepage Indicators</b>	
WT (°C): <u>13.70</u>	AT (°C): <u>25</u>	Watercress <input type="checkbox"/>	Bank Seepage <input type="checkbox"/>
pH: <u>6.67</u>	Cond (µs/cm): <u>635</u>	Iron Staining <input type="checkbox"/>	None <input checked="" type="checkbox"/>
D.O. (mg/L) <u>14.03</u>		Bubbling <input type="checkbox"/>	<input type="checkbox"/>
Water Clarity: Clear <input checked="" type="checkbox"/>	Turbid <input type="checkbox"/>	Other <input type="checkbox"/>	
Water Colour: <u>no colour</u>		Details:	
Notes: <u>roadside, shallow water</u>			



**Water Bodies Assessment Field Collection Form**

Stream Morphology					
Site Length (m): 10m by the road			Bank Stability:		
Channel Dimensions			Stable	Slightly unstable	
Mean Wetted Width (m): 0.5	Mean Wetted Depth (m): 0.10		Moderately unstable	Unstable	
Mean Bankfull Width (m): 1	Mean Bankfull Depth (m): 0.30		Left Bank <input checked="" type="checkbox"/> <input checked="" type="checkbox"/> <input type="checkbox"/> <input type="checkbox"/>		
Mean Top of Bank Width (m): 3	Mean Top of Bank Depth (m): 2		Right Bank <input checked="" type="checkbox"/> <input type="checkbox"/> <input type="checkbox"/> <input type="checkbox"/>		
Description: well veg, one area of slumping					
Flow Description: (high or low flow conditions, stagnant, etc) slow flow					
Habitat					
Substrate (< = >)		Morphological Structure (%)			
Bo - Boulder	Description silt/cl/mk	Pool	Riffle	Run	
Co - Cobble				Flat	
Gr - Gravel		/	/	/	100
Sa - Sand					
Si - Silt					
Cl - Clay					
MK - Muck					
DT - Detritus					
Notes: straight					
Instream Cover (%) 60 - 10m by road					
Other	Woody Debris	Boulders	Cobble	Aquatic Vegetation*	
/	/	/		60	
				None	
				Undercut Banks	
				Average Depth: /	
				(% Cover) /	
Note: Low = 0 - 30%; Moderate = 30 - 75%; High = 75 - 100%					
*Aquatic Vegetation Species Present (algae, submergent, emergent etc.)					
algae - attached > algae blooms >> grasses					
Canopy Cover (% closed cover):		Types of Cover (% cover)			
100-90% <input type="checkbox"/>	30-1% <input type="checkbox"/>	Trees	Shrubs 30	Man-made structures	
90-80% <input type="checkbox"/>	0% <input type="checkbox"/>	Grasses 10	Herbaceous	Other	
60-30% <input checked="" type="checkbox"/>					
Note: Low = 0 - 30%; Moderate = 30 - 60%; High = 60 - 100%					
Notes: (vegetation species, types of structures)					
dogwood, hawthorn					
Riparian Vegetation					
Width and Description of riparian vegetation:	LB - 1m - meadow	RB - 1m - meadow			
Overhanging Vegetation Present <input checked="" type="checkbox"/> N	% Overhanging Vegetation: 30				
Description of Overhanging Vegetation:	shrubs hanging over stream - small clumps				
Obstructions to Fish Passage					
None Observed <input checked="" type="checkbox"/>	Man-Made <input type="checkbox"/>	Natural <input type="checkbox"/>	Low Flow Barrier <input type="checkbox"/>		
Description of Barrier:					
Height of Barrier (m)	/	GPS Coordinates:	/		

**Water Bodies Assessment Field Collection Form**

**AECOM**

Date: May 23/12

Land Parcel/Site ID: <sup>JGR</sup> 3553/3568

Page 3 of 4  
RA.50

**Other General Comments Regarding the Study Area:**

Water is only present in first 10m of channel by road.  
↳ it is entirely fed by tile drain

- entire study area channel is straight + channelized, shrubs and grasses overhang in some areas

- Snake observed on bank ~ 25m from rockpile

**Additional UTM Coordinates:**

Photo log			
Picture #	Description	Picture #	Description
1a	Sheet		
1b	convergence area		
2-5	Watercourse by road		
6	tile drains on north E bend		
7	looking S - dry channel		
8-9	tile drains + pools		
10-12	dry channel		
13-14	watercourse roadside		
15	Rockpile		

Water Bodies Assessment Field Collection Form

AECOM

Page 4 of 4

Watercourse Sketch

Study Area:

Jericho

Goshen

Bluewater

Land Parcel#

JER 3553/3563

Site ID

R4.50



LEGEND	
10d depth (cm)	→
Sw width	⇌
Rifle	⇌
Run/Glide	⇌
Pool	○
Island/Bar	■
Fine Substrate	
Gravel Substrate	####
Cobble/Boulder	oOooO
Debris	***
Cattail	CT
Submerg/Float Veg	SV/FV
Emergent Vegetation	EV
Watercross	W
Iron Staking	Fe
Eroded Bank	
Riprap / Other Stabilization	xxx
Instream Log/Tree	⊃
Dam/Weir/ Obstruction	AAA
Riparian Tree	⊙
Seep/Spring	↳
Undercut Bank	—
Barrier to Fish Movement	—
Seasonal Barrier	-S-
Fence line	-x-x-
Canal	┌

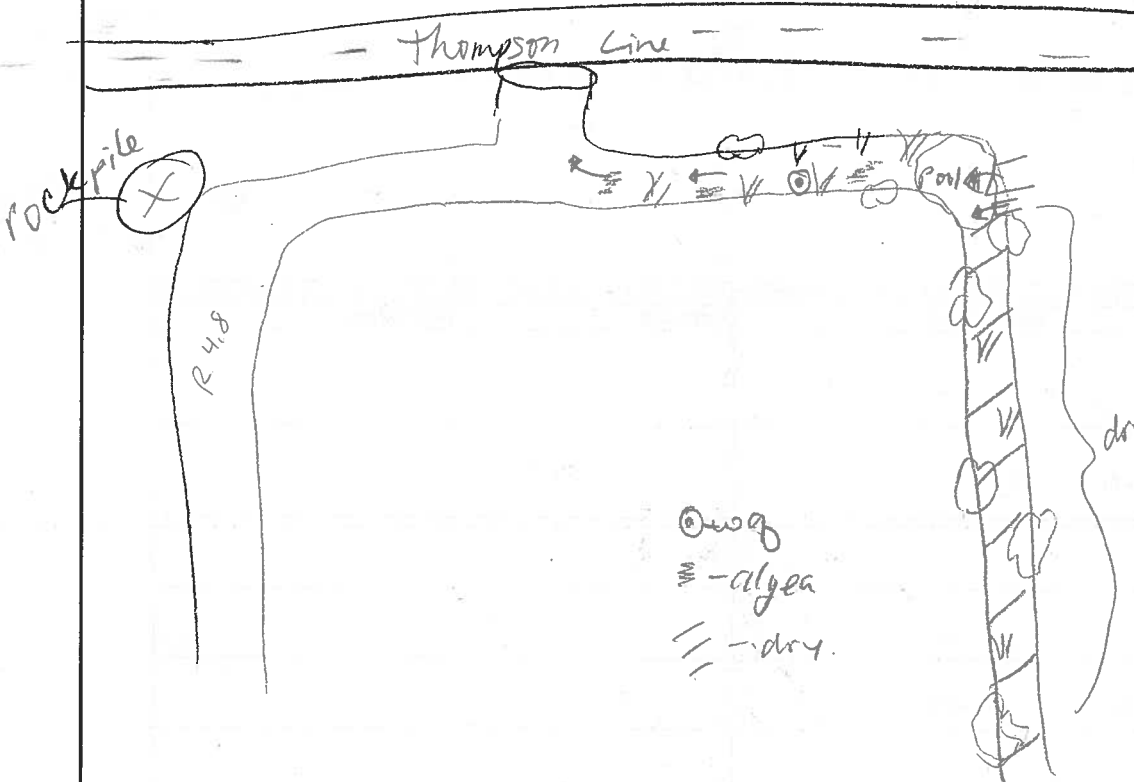

Horizontal View of Channel

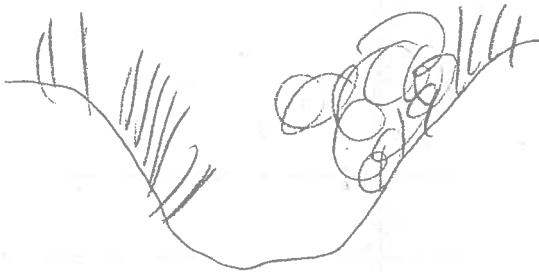

Initial QA/QC By:

L Bentley

Date: May 30, 2012

Technical QA/QC By:

Stetken Date: Jun 11/12

General Information

Study Area: Jericho Goshen Bluewater Land Parcel# JER 1141 Site ID: R4.11-JER1141  
 Date: May 10/12 Start time: 14:02 End Time: 14:10 PM  
 Weather Conditions: Sunny, 13°C Field Crew: S. Lohnes C. Harding  
 Field Notes By: S-Lohnes

Site Location

West of Jericho Rd, north of Thomson Line

UTM Co-ordinates

Easting: \_\_\_\_\_ Northing: \_\_\_\_\_ Description: \_\_\_\_\_  
 Easting: \_\_\_\_\_ Northing: \_\_\_\_\_ Description: \_\_\_\_\_  
 Easting: \_\_\_\_\_ Northing: \_\_\_\_\_ Description: \_\_\_\_\_  
 Easting: \_\_\_\_\_ Northing: \_\_\_\_\_ Description: \_\_\_\_\_

Surrounding Landuse

Residential  Meadow   
 Agriculture  Wetland   
 Forest  Livestock   
 Other

Ground Water and Seepage Indicators

Watercress  Bank Seepage   
 Iron Staining  None   
 Bubbling

Description:

Details:

Feature Description

Is the mapped water body any of the below:

- 1) a grassed waterway? Y  N
- 2) Temporary channel for surface drainage, that can be tilled or driven through? Y  N
- 3) Rock chutes or spillways? Y  N
- 4) Roadside ditches that are not connected or do not contain a permanent or intermittent stream? Y  N
- 5) Temporarily ponded areas that are normally farmed? Y  N
- 6) Artificial bodies of water intended for storage, treatment for farming purposes? Y  N

8) Any other: no waterbody or depression  
 Description: (i.e. length of change, if it reappears, if there is evidence of water)

Photo log

Picture #	Description	Picture #	Description

Site Sketch

N



Initial QA/QC: C. Bentley May 16, 2012  
Junker Oct 2/12

AECOM

Page 1 of 2

General Information

Study Area: Jericho Goshen Bluewater Land Parcel# JER 1142 Site ID: 24.11-JER 1142  
 Date: MAY 10/12 Start time: 13:45 End Time: 13:49

Weather Conditions: SUNNY 13°C Field Crew: SLOANES C. HARDING  
 Field Notes By: SLOANES

Site Location

West of Jericho Rd, north of Thomson Line.

UTM Co-ordinates

Easting: \_\_\_\_\_ Northing: \_\_\_\_\_ Description: \_\_\_\_\_  
 Easting: \_\_\_\_\_ Northing: \_\_\_\_\_ Description: \_\_\_\_\_  
 Easting: \_\_\_\_\_ Northing: \_\_\_\_\_ Description: \_\_\_\_\_  
 Easting: \_\_\_\_\_ Northing: \_\_\_\_\_ Description: \_\_\_\_\_

Surrounding Landuse

Residential  Meadow   
 Agriculture  Wetland   
 Forest  Livestock   
 Other

Ground Water and Seepage Indicators

Watercress  Bank Seepage   
 Iron Staining  None   
 Bubbling

Description: \_\_\_\_\_

Details: \_\_\_\_\_

Feature Description

Is the mapped water body any of the below:

- 1) a grassed waterway? Y / N
- 2) Temporary channel for surface drainage, that can be tilled or driven through? Y / N
- 3) Rock chutes or spillways? Y / N
- 4) Roadside ditches that are not connected or do not contain a permanent or intermittent stream? Y / N
- 5) Temporarily ponded areas that are normally farmed? Y / N
- 6) Artificial bodies of water intended for storage, treatment for farming purposes? Y / N
- 8) Any other: no watercourse - agricultural field. Y / N

Description: (i.e. length of change, if it reappears, if there is evidence of water)

Photo log

Picture #	Description	Picture #	Description

Assessment of Non-Water Body  
(update to mapping required)

R4.11A

AECOM

Date: MAY 10/12

Land Parcel/Site ID: JER1142 R4.11

Page 2 of 2

Site Sketch

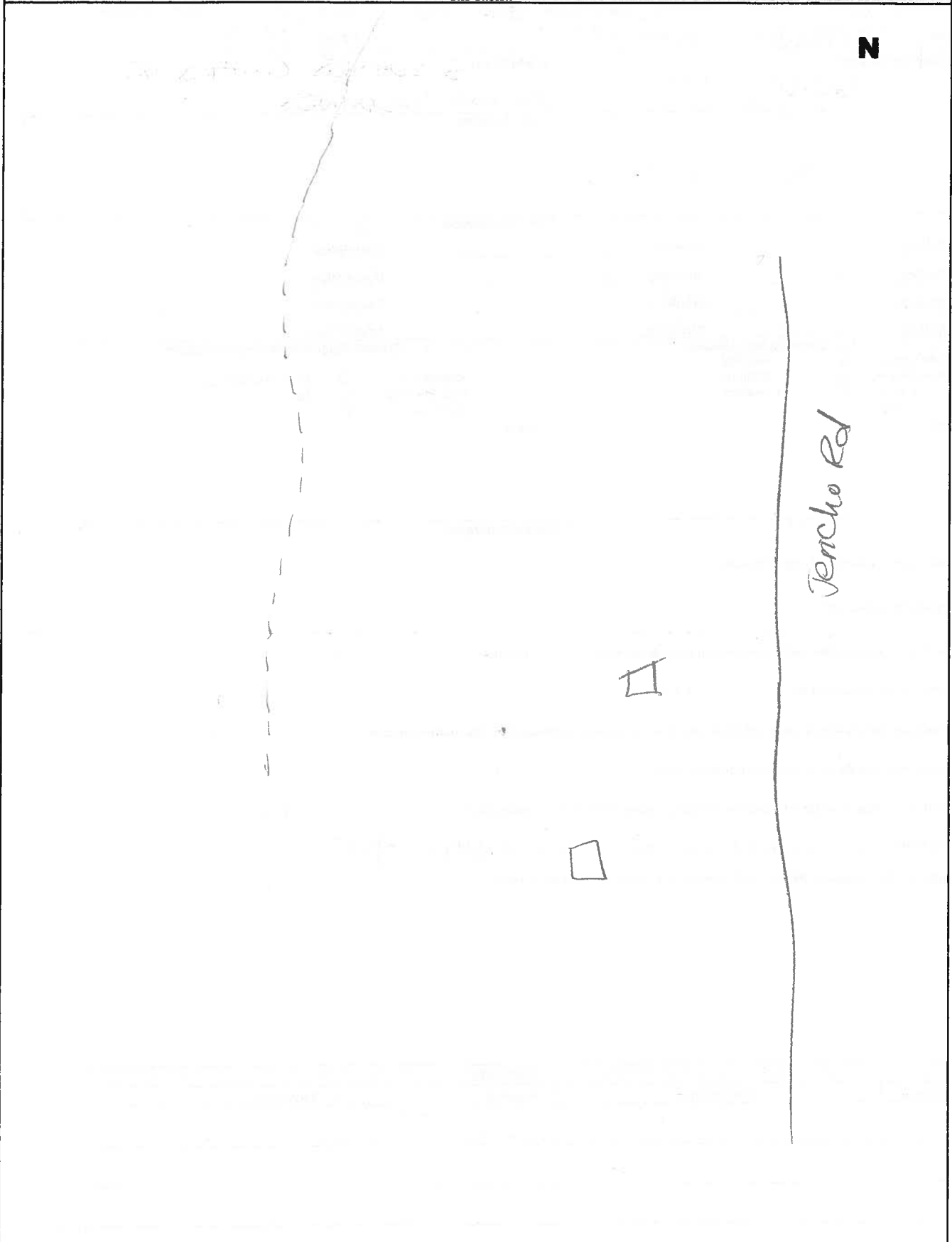

Initial QA/QC: L. Bentley May 16, 2012

Assessment of Non-Water Body  
(update to mapping required)

R4.11 A.

<b>AECOM</b>		Page 1 of 2	
<b>General Information</b>			
Study Area: <u>Jericho</u>	Goshen	Bluewater	Land Parcel# <u>1008</u> Site ID: <u>R4.11-JER-1008</u>
Date: <u>MAY 10/12</u>	Start time: <u>14:00</u>	End Time: <u>14:10</u>	
Weather Conditions: <u>Sunny 13°C</u>		Field Crew: <u>S. LOHNES C. HARLING</u>	
		Field Notes By: <u>S. LOHNES</u>	
<b>Site Location</b>			
<u>west of Jericho Rd. North of Thomson Line</u>			
<b>UTM Co-ordinates</b>			
Easting: _____	Northing: _____	Description: _____	
Easting: _____	Northing: _____	Description: _____	
Easting: _____	Northing: _____	Description: _____	
Easting: _____	Northing: _____	Description: _____	
<b>Surrounding Landuse</b>		<b>Ground Water and Seepage Indicators</b>	
Residential <input type="checkbox"/>	Meadow <input type="checkbox"/>	Watercress <input type="checkbox"/>	Bank Seepage <input type="checkbox"/>
Agriculture <input type="checkbox"/>	Wetland <input type="checkbox"/>	Iron Staining <input type="checkbox"/>	None <input type="checkbox"/>
Forest <input type="checkbox"/>	Livestock <input type="checkbox"/>	Bubbling <input type="checkbox"/>	
Other <input type="checkbox"/>			
Description: <u>/</u>		Details: <u>/</u>	
<b>Feature Description</b>			
Is the mapped water body any of the below:			
1) a grassed waterway?	<u>Y</u> <u>N</u>		
2) Temporary channel for surface drainage, that can be tilled or driven through?	<u>Y</u> <u>N</u>		
3) Rock chutes or spillways?	<u>Y</u> <u>N</u>		
4) Roadside ditches that are not connected or do not contain a permanent or intermittent stream?	<u>Y</u> <u>N</u>		
5) Temporarily ponded areas that are normally farmed?	<u>Y</u> <u>N</u>		
6) Artificial bodies of water intended for storage, treatment for farming purposes?	<u>Y</u> <u>N</u>		
8) Any other:	<u>no watercourse, row crop field</u>		
Description: (i.e. length of change, if it reappears, if there is evidence of water)			
<b>Photo log</b>			
Picture #	Description	Picture #	Description



Assessment of Non-Water Body  
(update to mapping required)

R4.11A.

AECOM

Date: May 10/12

Land Parcel/Site ID: R4.11-JER1008

Page 2 of 2

Site Sketch

N



Initial QA/QC: L Bentley May 16, 2012  
Sketcher Oct 2/12

Water Bodies Assessment Field Collection Form

R4.25A

AECOM

General Information

Study Area: Jericho Goshen Bluewater Land Parcel# 3305 Site ID: R4.25-JER3305

Date: MAY 10/2012 Start time: 807 AM End Time: 09:00 AM

Weather Conditions: Sunny, 6°C Field Crew: S. LOHNES C. HARDING  
Field Notes By: S. LOHNES

Site Location

West of Northville Rd @ Decker

UTM Co-ordinates (Continue on page 3 if necessary)

Easting: 0428229	Northing: 4778870	Description: START @ Northville Rd!
Easting: 0428120	Northing: 4778767	Description: H <sub>2</sub> O CHEM
Easting: 0428117	Northing: 4778709	Description: END
Easting:	Northing:	Description:

Surrounding Landuse

Residential  Meadow   
Agriculture  Wetland   
Forest  Livestock   
Other

Type of Watercourse

Intermittent  Channelized   
Permanent  Natural Channel   
Ephemeral

Description: residential w/ manicured lawn up to channel banks then row crop one w/c rocks w/s section

Description:

Notes: (include any inputs into the system i.e. tile drainage, seepages, overland flow)  
tile drain observed d/s of Northville Rd, roadside drainage inputs into system @ Northville Rd.

Is any portion of the water body underground or not as mapped? Y/N

If Yes describe:

GPS Coordinate: Easting - Northing - Description -

Description of Land Topography Surrounding Water Body (rolling hills, sloping towards water body)

gentle slope towards water course.

In-Situ Water Quality

WT (°C): 9.1°C AT (°C): 12°C  
pH: 8.06 Cond ( s/cm): 795  
D.O. (mg/L) 6.76  
Water Clarity: Clear  Turbid

Ground Water and Seepage Indicators

Watercress  Bank Seepage   
Iron Staining  None   
Bubbling   
Other

Water Colour: colourless

Details: isolated water areas plants in some areas

Notes: taken in a run w/ open canopy & no instream vegetation.

# Water Bodies Assessment Field Collection Form

Stream Morphology																				
Site Length (m): <u>300m</u>			Bank Stability:																	
Channel Dimensions			<table style="width: 100%; text-align: center;"> <tr> <td></td> <td>Stable</td> <td>Slightly unstable</td> <td>Moderately unstable</td> <td>Unstable</td> </tr> <tr> <td>Left Bank</td> <td><input type="checkbox"/></td> <td><input checked="" type="checkbox"/></td> <td><input type="checkbox"/></td> <td><input type="checkbox"/></td> </tr> <tr> <td>Right Bank</td> <td><input checked="" type="checkbox"/></td> <td><input type="checkbox"/></td> <td><input type="checkbox"/></td> <td><input type="checkbox"/></td> </tr> </table>				Stable	Slightly unstable	Moderately unstable	Unstable	Left Bank	<input type="checkbox"/>	<input checked="" type="checkbox"/>	<input type="checkbox"/>	<input type="checkbox"/>	Right Bank	<input checked="" type="checkbox"/>	<input type="checkbox"/>	<input type="checkbox"/>	<input type="checkbox"/>
	Stable	Slightly unstable	Moderately unstable	Unstable																
Left Bank	<input type="checkbox"/>	<input checked="" type="checkbox"/>	<input type="checkbox"/>	<input type="checkbox"/>																
Right Bank	<input checked="" type="checkbox"/>	<input type="checkbox"/>	<input type="checkbox"/>	<input type="checkbox"/>																
Mean Wetted Width (m): <u>2.0m</u>	Mean Wetted Depth (m): <u>0.2m</u>	Description: <u>some exposed roots &amp; erosion scars.</u>																		
Mean Bankfull Width (m): <u>3.5m</u>	Mean Bankfull Depth (m): <u>0.45m</u>																			
Mean Top of Bank Width (m): <u>4.5m</u>	Mean Top of Bank Depth (m): <u>1.6m</u>																			
Flow Description: (high or low flow conditions, stagnant, etc) <u>low flow</u>																				
Riparian																				
Substrate (<=>)		Description		Morphological Structure (%)																
Bo - Boulder Co - Cobble Gr - Gravel Sa - Sand Si - Silt Cl - Clay MK - Muck DT - Detritus		<u>Cl. + Si</u>		<table border="1" style="width: 100%; text-align: center;"> <tr> <th>Pool</th> <th>Riffle</th> <th>Run</th> <th>Flat</th> </tr> <tr> <td></td> <td></td> <td>100</td> <td></td> </tr> </table>		Pool	Riffle	Run	Flat			100								
Pool	Riffle	Run	Flat																	
		100																		
				Notes: <u>low gradient</u>																
Instream Cover (%)																				
Other	Woody Debris	Boulders	Cobble	Aquatic Vegetation*	None															
				<u>20</u>																
Undercut Banks																				
Average Depth: (% Cover)																				
Note: Low = 0 - 30%; Moderate = 30 - 75%; High = 75 - 100%																				
*Aquatic Vegetation Species Present (algae, submergent, emergent etc.) <u>grasses &amp; watercress</u>																				
Canopy Cover (% closed cover):			Types of Cover (% cover)																	
100-90%	<input type="checkbox"/>	30-1%	<input checked="" type="checkbox"/>	Trees <u>10</u>	Shrubs <u>10</u>															
90-60%	<input type="checkbox"/>	0%	<input type="checkbox"/>	Grasses _____	Herbaceous _____															
60-30%	<input type="checkbox"/>				Man-made structures _____															
Other _____																				
Note: Low = 0 - 30%; Moderate = 30 - 60%; High = 60 - 100%																				
Notes: (vegetation species, types of structures) <u>mature willow trees in residential area &amp; dogwood + willow shrubs in roadcap</u>																				
Riparian Vegetation																				
Width of riparian vegetation: <u>2.1m for both banks</u>																				
Description of vegetation community surrounding 30 m from watercourse: <u>R ups row crop L ups residential + hay field.</u>																				
Obstructions to Fish Passage																				
No Obstructions	<input checked="" type="checkbox"/>	Man-Made	<input type="checkbox"/>	Natural	<input type="checkbox"/>															
Description of Barrier:																				
Height of Barrier (m)			GPS Coordinates:																	

Water Bodies Assessment Field Collection Form

AECOM

Date: May 10/2012

Land Parcel/Site ID:

R4.25A  
JER 3305

Page 3 of 4

Other General Comments Regarding the Study Area:

- watercourse flows from row crop agriculture w/ low riparian diversity and shading into residential property w/ some mature riparian trees + shrubs (lilac, maple) and manicured lawn.
- upstream section near top of site has overhanging root system dogwood & willow. → muskrat family using this area.
- stickleback observed.

Additional UTM Coordinates:

Photo Log			
Picture #	Description	Picture #	Description
1	Sheet		
2	@ roadside		
3	looking back @ roadside		
4	unstable bank		
5	tile input		
6	laneway culvert		
7	turbid area from wildlife use		
8	erosion scar		
9-17	overview		

Water Bodies Assessment Field Collection Form

AECOM

Page 4 of 4

Study Area:

Jericho

Goshen

Bluewater

Land Parcel#

Jer 3305

Site ID

R4.25A

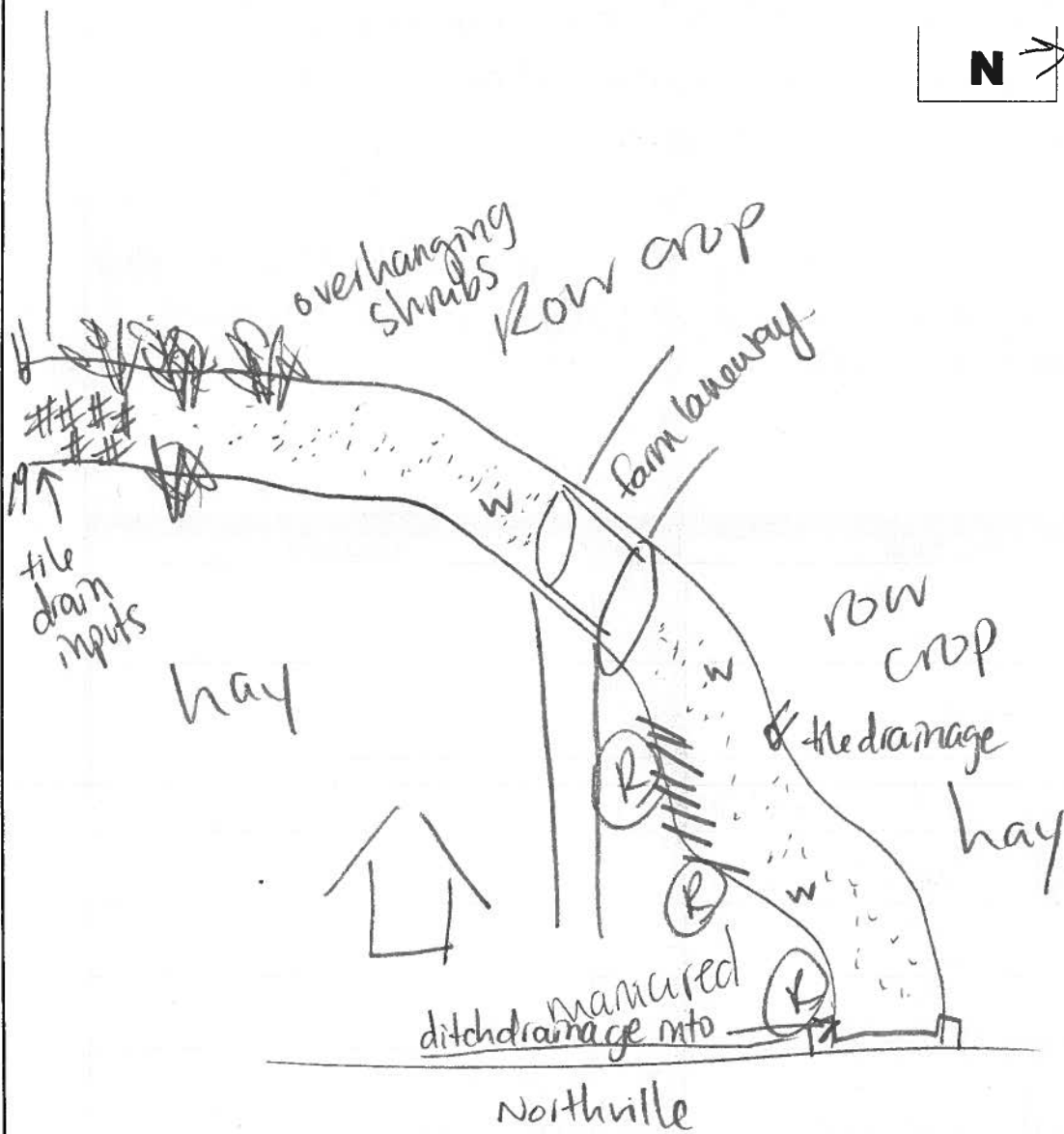

**LEGEND**

- 10d depth (cm)
- 6w width
- Riffle
- Run/Glide
- Pool
- Island/Bar
- Fine Substrate
- Gravel Substrate
- Cobble/Boulder
- Debris
- CT Cattail
- SV/FV Submerg/Float Veg
- EV Emergent Vegetation
- W Watercress
- Fe Iron Staining
- Eroded Bank
- Riprap / Other Stabilization
- Instream Log/Tree
- Dam/Weir / Obstruction
- Riparian Tree
- Seep/Spring
- Undercut Bank
- Barrier to Fish Movement
- Seasonal Barrier
- Fence line
- Culvert

Horizontal View of Channel

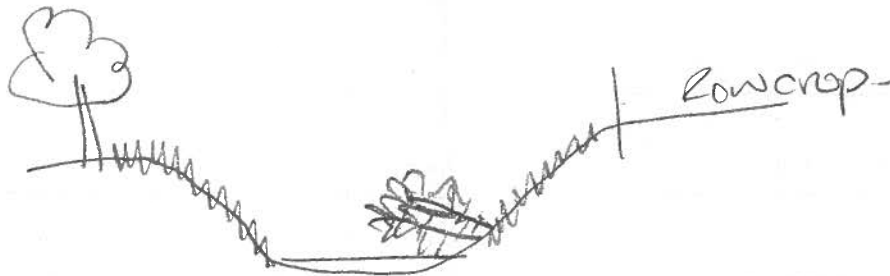

Initial QA/QC By: L. Bentley

Date: May 16, 2012

Technical QA/QC By: [Signature]

Date: Jun 11/12

Water Bodies Assessment Field Collection Form

R4.25A

<b>AECOM</b>	
<b>General Information</b>	
Study Area: <u>Jericho</u> Goshen Bluewater Land Parcel# <u>3308</u> Site ID: <u>R4.25A-0023308</u>	
Date: <u>MAY 16/2018</u> Start time: <u>08:00 AM</u> End Time: <u>09:01 AM</u>	
Weather Conditions: <u>overcast, 10°C</u>	Field Crew: <u>S. LOHNER D. BPP</u> Field Notes By: <u>S. LOHNER</u>
<b>Site Location</b>	
<u>@ Thomsonline and Northville road Carrosses intersection</u>	
<b>UTM Co-ordinates (continue on page 3 if necessary)</b>	
Easting: <u>428197</u> Northing: <u>4778084</u> Description: <u>START @ road</u>	
Easting: <u>428183</u> Northing: <u>4778109</u> Description: <u>H<sub>2</sub>O chem</u>	
Easting: _____ Northing: _____ Description: _____	
Easting: _____ Northing: _____ Description: _____	
<b>Surrounding Landuse</b>	<b>Type of Watercourse</b>
Residential <input checked="" type="checkbox"/> Meadow <input type="checkbox"/> Agriculture <input type="checkbox"/> Wetland <input type="checkbox"/> Forest <input type="checkbox"/> Livestock <input checked="" type="checkbox"/> Other _____	Intermittent <input type="checkbox"/> Channelized <input checked="" type="checkbox"/> Permanent <input checked="" type="checkbox"/> Natural Channel <input type="checkbox"/> Ephemeral <input type="checkbox"/> _____ <input type="checkbox"/>
Description: <u>adjacent fenced pasture w/ cattle &amp; residence.</u>	Description: <u>beginning to naturalize</u>
<b>Notes: (include any inputs into the system i.e. tile drainage, seepages, overland flow)</b>	
<u>tile drainage &amp; <del>road</del> roadside ditching.</u>	
Is any portion of the water body underground or not as mapped? <u>Y/N</u>	
If Yes describe: _____	
<b>GPS Coordinates</b>	<b>Description</b>
Easting - _____ Northing - _____ Description - _____	<b>Description of Land Topography Surrounding Water Body (rolling hills, sloping towards water body)</b>
<u>flat w/ some sloping to w/c.</u>	
<b>In-Situ Water Quality</b>	<b>Ground Water and Seepage Indicators</b>
WT (°C): <u>10.9</u> AT (°C): <u>10.2</u>	Watercress <input checked="" type="checkbox"/> Bank Seepage <input type="checkbox"/>
pH: <u>7.41</u> Cond ( s/cm): <u>802</u>	Iron Staining <input type="checkbox"/> None <input type="checkbox"/>
D.O. (mg/L) <u>6.56</u>	Bubbling <input type="checkbox"/> _____ <input type="checkbox"/>
Water Clarity: Clear <input checked="" type="checkbox"/> Turbid <input type="checkbox"/>	Other <input type="checkbox"/> _____
Water Colour: <u>colourless</u>	Details: <u>big mats @ tile drain outlet</u>
Notes: <u>taken ~ 30m north of Thomson Line</u>	

**Water Bodies Assessment Field Collection Form**

Stream Morphology							
Site Length (m): <u>300m</u>			Bank Stability:				
Channel Dimensions			Stable	Slightly unstable	Moderately unstable	Unstable	
Mean Wetted Width (m): <u>0.40m</u>	Mean Wetted Depth (m): <u>0.10m</u>	Left Bank <input type="checkbox"/> <input type="checkbox"/> <input checked="" type="checkbox"/> <input type="checkbox"/>					
Mean Bankfull Width (m): <u>0.60m</u>	Mean Bankfull Depth (m): <u>0.20m</u>	Right Bank <input type="checkbox"/> <input type="checkbox"/> <input checked="" type="checkbox"/> <input type="checkbox"/>					
Mean Top of Bank Width (m): <u>6.0m</u>	Mean Top of Bank Depth (m): <u>2.0m</u>	Description: <u>stable along south section of reach then eroding where cattle access creek</u>					
Flow Description: (high or low flow conditions, stagnant, etc) <u>moderate flow, low volume</u>							
Habitat							
Substrate (<=>)		Description		Morphological Structure (%)			
Bo - Boulder	Co - Cobble	Gr - Gravel	Sa - Sand	Si - Silt	Cl - Clay		
MK - Muck	DT - Detritus	<u>Si + Cl &gt;&gt; Gr.</u>		Pool	Riffle	Run	Flat
				1		<del>99</del>	
				Notes: <u>all runs &amp; pool @ culvert outlet</u>			
Instream Cover (%)							
Other	Woody Debris	Boulders	Cobble	Aquatic Vegetation*	None	Undercut Banks	
				5		Average Depth: (% Cover)	
Note: Low = 0 - 30%; Moderate = 30 - 75%; High = 75 - 100%							
*Aquatic Vegetation Species Present (algae, submergent, emergent etc.) <u>watercress &amp; water speedwell, some phragmites</u>							
Canopy Cover (% closed cover):			Types of Cover (% cover)				
100-90%	<input type="checkbox"/>	30-1%	<input type="checkbox"/>	Trees	Shrubs	Man-made structures	
90-60%	<input type="checkbox"/>	0%	<input checked="" type="checkbox"/>	Grasses	Herbaceous	Other	
60-30%	<input type="checkbox"/>						
Note: Low = 0 - 30%; Moderate = 30 - 60%; High = 60 - 100%							
Notes: (vegetation species, types of structures) <u>no canopy cover</u>							
Riparian Vegetation							
Width and Description of riparian vegetation:	LB - <u>varies between 20m &amp; &lt;1m</u>	RB - <u>&lt;1m active in stock pasture</u>					
Overhanging Vegetation Present	Y/N	%	Description of Overhanging Vegetation:				
	<input checked="" type="checkbox"/>		<u>grasses &amp; phragmites some red-osier @ culvert</u>				
Obstructions to Fish Passage							
None Observed	<input checked="" type="checkbox"/>	Man-Made	<input type="checkbox"/>	Natural	<input type="checkbox"/>	Low Flow Barrier	<input type="checkbox"/>
Description of Barrier:							
Height of Barrier (m)			GPS Coordinates:				

Water Bodies Assessment Field Collection Form

R4.25A

AECOM

Date: MAY 16/2012

Land Parcel/Site ID: 888308

Page 3 of 4

Other General Comments Regarding the Study Area:

- watercourse flows northerly roadside before starting this section. It then flows through historically channelized section w/ adjacent livestock pasture + grassed meadow before entering paddock where cattle access stream. Erosion on L & R banks from cattle access.

Additional UTM Coordinates:

Photo log

Picture #	Description	Picture #	Description
1	overview, facing NW		
2	roadside drainage, facing south		
3	culvert from under Thomson		
4	facing northwest		
5	facing south		
6	tile input w/ watercross		
7	looking <sup>down</sup> stream		
8	looking <sup>up</sup> stream		
9	cattle access in paddock		
10	bank erosion		
11	adjacent pasture		



Water Bodies Assessment Field Collection Form

R4.25A.

AECOM

Page 4 of 4

Watercourse Sketch

Study Area:

Jericho

Goshen

Bluewater

Land Parcel# 3308

Site ID

R4.25 JER3308

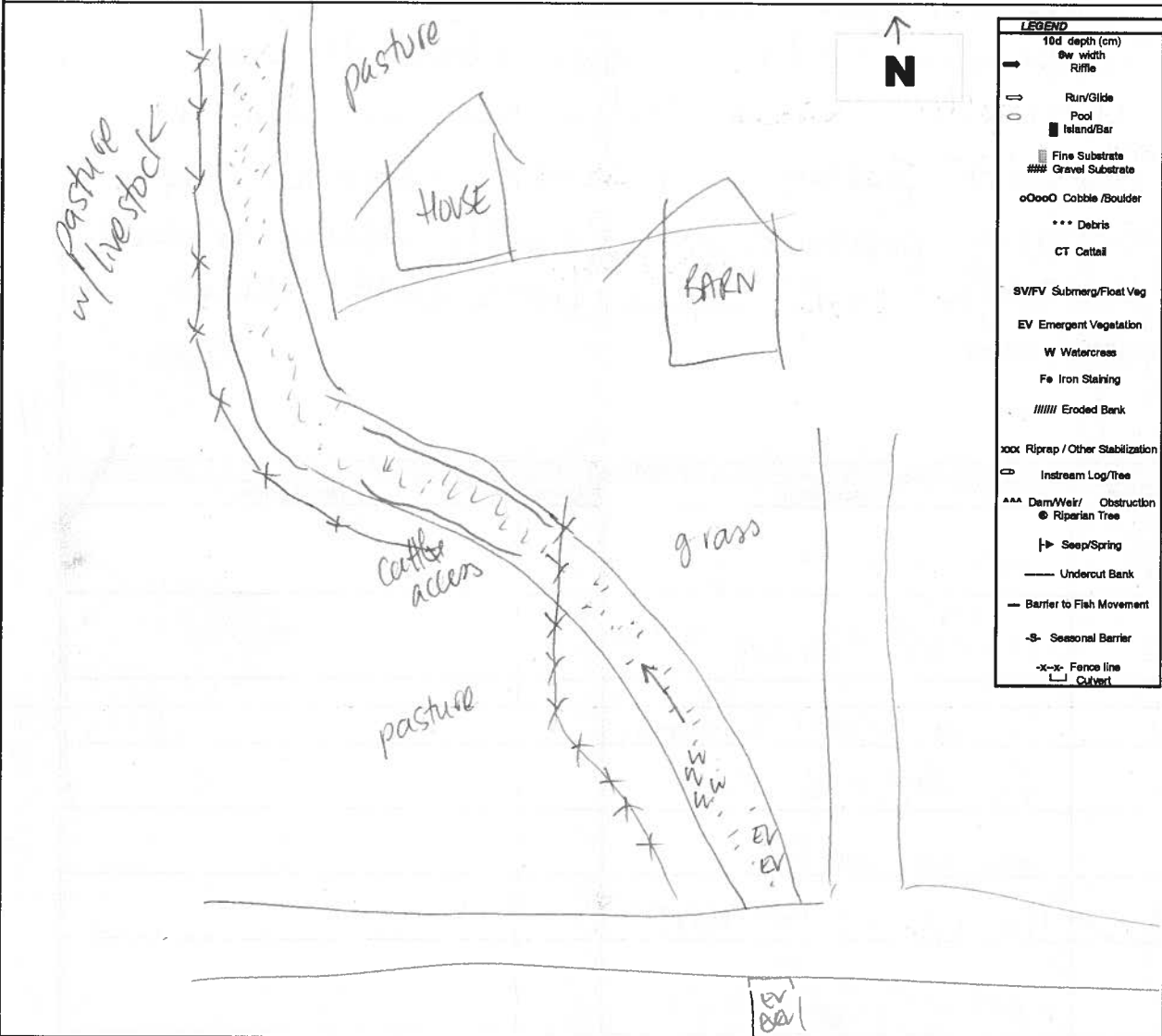

Horizontal View of Channel

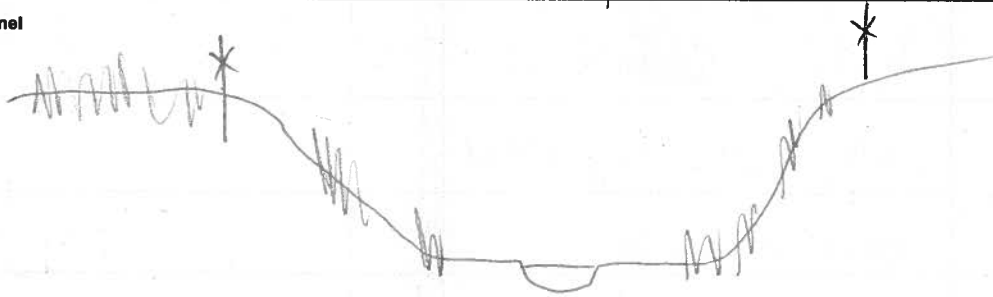

Initial QA/QC By:

L. Bentley

Date: May 22, 2012

Technical QA/QC By:

Slutka

Date: Jun 11/12

Water Bodies Assessment Field Collection Form

AECOM

General Information

Study Area: Jericho Goshen Bluewater Land Parcel# JER3307 Site ID: R4.25A.

Date: July 25 /12 Start time: 13:00 End Time: 13:50

Weather Conditions:

Summer 27°C

Field Crew: C. Boros, J. Epp

Field Notes By: C. Boros

Site Location

Northville road, north of Thompson Ln

UTM Co-ordinates (continue on page 3 if necessary)

Easting: <u>428117</u>	Northing: <u>4778699</u>	Description: <u>R4.25S</u>
Easting: <u>428124</u>	Northing: <u>4778570</u>	Description: <u>R4.25 wg</u>
Easting: <u>428131</u>	Northing: <u>4779505</u>	Description: <u><del>R4.25</del> R4.25 rock pile</u>
Easting: <u>428129</u>	Northing: <u>4778401</u>	Description: <u>R4.25 sand.</u>

Surrounding Landuse

Residential  Meadow   
 Agriculture  Wetland   
 Forest  Livestock   
 Other

Description:

corn fields

Type of Watercourse

Intermittent  Channelized   
 Permanent  Natural Channel   
 Ephemeral

Description:

sections dry, no observable flow

Notes: (include any inputs into the system i.e. tile drainage, seepages, overland flow)

Tile drains observed

Is any portion of the water body underground or not as mapped? Y / N

If Yes describe:

GPS Coordinate: Easting -

Northing -

Description -

Description of Land Topography Surrounding Water Body (rolling hills, sloping towards water body)

flat

In-Situ Water Quality

WT (°C): 18.12 AT (°C): 28°C  
 pH: 6.54 Cond (µs/cm): 940  
 D.O. (mg/L): 1.45  
 Water Clarity: Clear  Turbid

Water Colour: n/a

Notes: Small pool area, dense duckweed

Ground Water and Seepage Indicators

Watercress  Bank Seepage   
 Iron Staining  None   
 Bubbling  Watercress   
 Other

Details:

small mats of watercress observed

**Water Bodies Assessment Field Collection Form**

Stream Morphology																				
Site Length (m): 38m			Bank Stability:																	
<b>Channel Dimensions</b>			<table style="width:100%; text-align: center;"> <tr> <td></td> <td>Stable</td> <td>Slightly unstable</td> <td>Moderately unstable</td> <td>Unstable</td> </tr> <tr> <td>Left Bank</td> <td><input checked="" type="checkbox"/></td> <td><input type="checkbox"/></td> <td><input type="checkbox"/></td> <td><input type="checkbox"/></td> </tr> <tr> <td>Right Bank</td> <td><input checked="" type="checkbox"/></td> <td><input type="checkbox"/></td> <td><input type="checkbox"/></td> <td><input type="checkbox"/></td> </tr> </table>				Stable	Slightly unstable	Moderately unstable	Unstable	Left Bank	<input checked="" type="checkbox"/>	<input type="checkbox"/>	<input type="checkbox"/>	<input type="checkbox"/>	Right Bank	<input checked="" type="checkbox"/>	<input type="checkbox"/>	<input type="checkbox"/>	<input type="checkbox"/>
	Stable	Slightly unstable	Moderately unstable	Unstable																
Left Bank	<input checked="" type="checkbox"/>	<input type="checkbox"/>	<input type="checkbox"/>	<input type="checkbox"/>																
Right Bank	<input checked="" type="checkbox"/>	<input type="checkbox"/>	<input type="checkbox"/>	<input type="checkbox"/>																
Mean Wetted Width (m): <del>0.8</del> 0.8	Mean Wetted Depth (m): 0.13		Description: well vegetated																	
Mean Bankfull Width (m): 1.2	Mean Bankfull Depth (m): 0.30																			
Mean Top of Bank Width (m): 5	Mean Top of Bank Depth (m): 3																			
Flow Description: (high or low flow conditions, stagnant, etc)																				
no observable flow → stretches of dry patch (35% of channel reach dry)																				
Habitat																				
<b>Substrate (&lt;=&gt;)</b>			<b>Morphological Structure (%)</b>																	
Bo - Boulder Co - Cobble Gr - Gravel Sa - Sand Si - Silt Cl - Clay MK - Muck DT - Detritus			<table border="1" style="width:100%; text-align: center;"> <tr> <th>Pool</th> <th>Riffle</th> <th>Run</th> <th>Flat</th> </tr> <tr> <td>/</td> <td>/</td> <td>/</td> <td>100</td> </tr> </table>			Pool	Riffle	Run	Flat	/	/	/	100							
Pool	Riffle	Run	Flat																	
/	/	/	100																	
Description Cl = Si > Sa = mk			Notes: straight channel																	
Instream Cover (%)																				
Other	Woody Debris	Boulders	Cobble	Aquatic Vegetation*	None	Undercut Banks														
			2	75		Average Depth: 0.20 (% Cover) 5														
Note: Low = 0 - 30%; Moderate = 30 - 75%; High = 75 - 100%																				
*Aquatic Vegetation Species Present (algae, submergent, emergent etc.)																				
Grasses > watercress, bittercress, duckweed > algae																				
<b>Canopy Cover (% closed cover):</b>			<b>Types of Cover (% cover)</b>																	
100-90%	<input type="checkbox"/>	30-1%	<input type="checkbox"/>	Trees	10	Shrubs	40	Man-made structures												
90-60%	<input type="checkbox"/>	0%	<input type="checkbox"/>	Grasses	25	Herbaceous	25	Other												
60-30%	<input checked="" type="checkbox"/>																			
Note: Low = 0 - 30%; Moderate = 30 - 60%; High = 60 - 100%																				
Notes: (vegetation species, types of structures)																				
willow, sumac, dogwood																				
Riparian Vegetation																				
Width and Description of riparian vegetation:			Riparian Vegetation																	
LB - 1m - meadow			RB - 1m - meadow																	
Overhanging Vegetation Present <input checked="" type="checkbox"/> N			% Overhanging Vegetation: 10																	
Description of Overhanging Vegetation: some overhanging <del>sumac</del> sumac & dogwood - sporadic pockets																				
Obstructions to Fish Passage																				
None Observed	<input type="checkbox"/>	Man-Made	<input type="checkbox"/>	Natural	<input type="checkbox"/>	Low Flow Barrier	<input checked="" type="checkbox"/>													
Description of Barrier: Stretches of dry channel																				
Height of Barrier (m)			GPS Coordinates:																	

Water Bodies Assessment Field Collection Form

AECOM

Date: July 25 / 12

Land Parcel/Site ID: JEE 3307

Page 3 of 4

RA-25A

Other General Comments Regarding the Study Area:

Straight channelized stream in ~~stretch~~<sup>stretches</sup> of dry channel, highly veg banks + instream. Canopy cover moderate and low amount of overhanging veg. Substrate soft.

Additional UTM Coordinates:

Photo log

Picture #	Description	Picture #	Description
1-4	Channel overview (north)		
5-10	" mid		
11	Rock pile		
12	South end - from bridge		
13	mid - from bridge		
14	South end,		

Water Bodies Assessment Field Collection Form

AECOM

Page 4 of 4

Watercourse Sketch

Study Area:

Jericho

Goshen

Bluewater

Land Parcel#

JER3307

Site ID

RA.25A

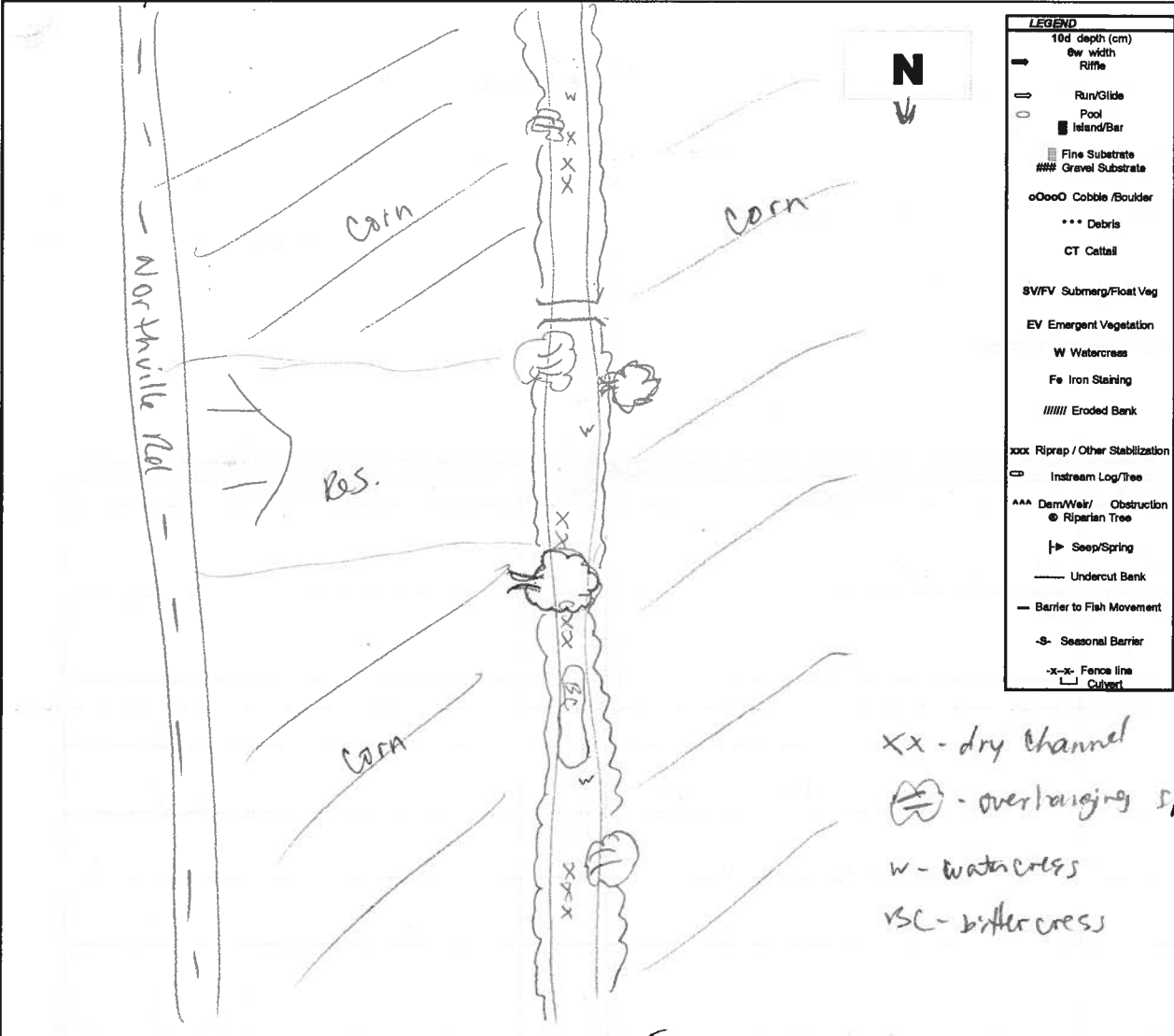

**LEGEND**

- 10d depth (cm)
- 6w width
- Riffle
- Run/Glide
- Pool
- Island/Bar
- Fine Substrate
- Gravel Substrate
- Cobble/Boulder
- Debris
- Cattail
- Submerg/Float Veg
- Emergent Vegetation
- Watercress
- Iron Staining
- Eroded Bank
- Riprap / Other Stabilization
- Instream Log/Tree
- Dam/Weir/ Obstruction
- Riparian Tree
- Seep/Spring
- Undercut Bank
- Barrier to Fish Movement
- Seasonal Barrier
- Fence line
- Covert

xx - dry channel  
 (⊖) - overhanging shrub  
 w - watercress  
 vsc - bittercress

Horizontal View of Channel



Initial QA/QC By: Bentley

Date: August 14, 2012

Technical QA/QC By: [Signature]

Date: Oct 2/12

AECOM

General Information

Study Area: Jericho Goshen Bluewater Land Parcel# 1055 Site ID: RS.1-JER1055  
 Date: MAY 10/2012 Start time: 16:27 End Time: 16:50

Weather Conditions: Sunny, 14°C  
 Field Crew: SLOHNES C. HARRIS  
 Field Notes By: SLOHNES

Site Location

west of Army Camp Rd., south of Lakeshore Rd, north of Ravenswood

UTM Co-ordinates (continue on page 3 if necessary)

Easting: 0423821 Northing: 4781619 Description: @ ARMYCAMP RD  
 Easting: 0423684 Northing: 4781197 Description: end of reach  
 Easting: Northing: Description: + H<sub>2</sub>O CHEM  
 Easting: Northing: Description:

Surrounding Landuse

Residential  Meadow   
 Agriculture  Wetland   
 Forest  Livestock   
 Other

Type of Watercourse

Intermittent  Channelized   
 Permanent  Natural Channel   
 Ephemeral

Description: small woodlot on R w/s bank, row crop other

Description: naturalizing w/ channel

Notes: (include any inputs into the system i.e. tile drainage, seepages, overland flow)

tile drainage + roadside ditches

Is any portion of the water body underground or not as mapped? Y (N)  
 If Yes describe:

see

GPS Coordinate: Easting - Northing - Description -

Description of Land Topography Surrounding Water Body (rolling hills, sloping towards water body)

gentle slope towards w/c

In-Situ Water Quality

WT (°C): 17.6°C AT (°C): 14°C  
 pH: 8.70 Cond ( s/cm): 617  
 D.O. (mg/L) 10.6  
 Water Clarity: Clear  Turbid

Water Colour: colourless

Notes: algae

Ground Water and Seepage Indicators

Watercress  Bank Seepage   
 Iron Staining  None   
 Bubbling   
 Other

Details: mats of water cress in d/s section

### Water Bodies Assessment Field Collection Form

Stream Morphology													
Site Length (m): <b>430m</b>			Bank Stability:										
Channel Dimensions:			Stable	Slightly unstable	Moderately unstable	Unstable							
Mean Wetted Width (m): <b>0.80m</b>	Mean Wetted Depth (m): <b>0.20m</b>	Left Bank	<input checked="" type="checkbox"/>	<input type="checkbox"/>	<input type="checkbox"/>	<input type="checkbox"/>							
Mean Bankfull Width (m): <b>1.7m</b>	Mean Bankfull Depth (m): <b>0.65m</b>	Right Bank	<input checked="" type="checkbox"/>	<input type="checkbox"/>	<input type="checkbox"/>	<input type="checkbox"/>							
Mean Top of Bank Width (m): <b>4.5m</b>	Mean Top of Bank Depth (m): <b>1.8m</b>	Description: <b>vegetated</b>											
Flow Description: (high or low flow conditions, stagnant, etc) <b>moderate flow</b>													
Habitat													
Substrate (<=>)		Description		Morphological Structure (%)									
Bo - Boulder	Co - Cobble	Gr - Gravel	Sa - Sand	Si - Silt	Cl - Clay								
MK - Muck	DT - Detritus	<b>Sa + Gr &gt;&gt; Bo</b>		Notes: <b>low gradient</b>									
				<table border="1" style="width: 100%; border-collapse: collapse;"> <thead> <tr> <th>Pool</th> <th>Riffle</th> <th>Run</th> <th>Flat</th> </tr> </thead> <tbody> <tr> <td></td> <td></td> <td style="text-align: center;">100</td> <td></td> </tr> </tbody> </table>		Pool	Riffle	Run	Flat			100	
Pool	Riffle	Run	Flat										
		100											
Instream Cover (%)													
Other	Woody Debris	Boulders	Cobble	Aquatic Vegetation*	None	Undercut Banks							
				90		Average Depth: (% Cover)							
Note: Low = 0 - 30%; Moderate = 30 - 75%; High = 75 - 100%													
*Aquatic Vegetation Species Present (algae, submergent, emergent etc.) <b>algae + watercress, grasses</b>													
Canopy Cover (% closed cover):			Types of Cover (% cover)										
100-90%	<input type="checkbox"/>	30-1%	<input type="checkbox"/>	Trees <b>50</b>	Shrubs <b>10</b>	Man-made structures							
90-60%	<input type="checkbox"/>	0%	<input type="checkbox"/>	Grasses	Herbaceous	Other							
60-30%	<input checked="" type="checkbox"/>												
Note: Low = 0 - 30%; Moderate = 30 - 60%; High = 60 - 100%													
Notes: (vegetation species, types of structures) <b>oak, willow, FOD forest, willow + dogwood shrubs</b>													
Riparian Vegetation													
Width and Description of riparian vegetation:			LB - <b>1m grasses</b>			RB - <b>varies, 1m in fields, 300m in forest</b>							
Overhanging Vegetation Present <input checked="" type="checkbox"/> N			% Overhanging Vegetation: <b>20%</b>										
Description of Overhanging Vegetation: <b>red osier dogwood + willow - some grasses.</b>													
Obstructions to Fish Passage													
None Observed	<input checked="" type="checkbox"/>	Man-Made	<input type="checkbox"/>	Natural	<input type="checkbox"/>	Low Flow Barrier	<input type="checkbox"/>						
Description of Barrier:													
Height of Barrier (m)			GPS Coordinates:										

24.61-C

AECOM

Date: May 10/12

Land Parcel/Site ID: R516  
JER 1055

Page 3 of 4

Other General Comments Regarding the Study Area:

- cyprinids observed near ArmyCamp Rd culvert
- moderate flow in a naturalizing channel with algae, watercress & grasses predominate as vegetation.

Additional UTM Coordinates:

Photo log			
Picture #	Description	Picture #	Description
1	Sheet		
2	overview from road		
3	adj land		
4	watercress		
5-10	overview		
11	H <sub>2</sub> O chem		
12-13	overview		



Water Bodies Assessment Field Collection Form

R4-61-C

RSIC

AECOM

Page 4 of 4

Watercourse Sketch

Study Area:

Jericho

Goshen

Bluewater

Land Parcel#

1055

Site ID

RSIC JER1055

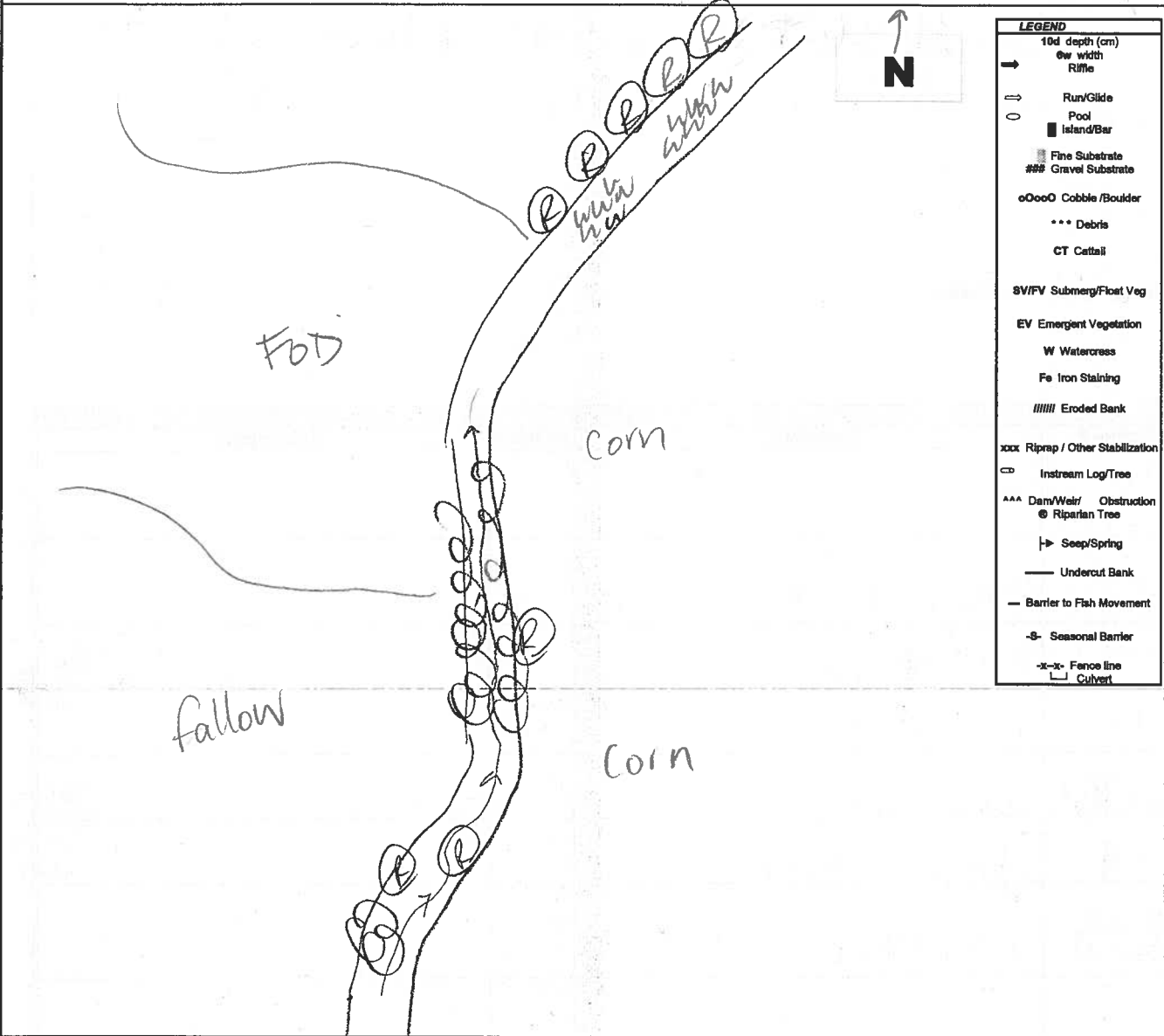

Horizontal View of Channel

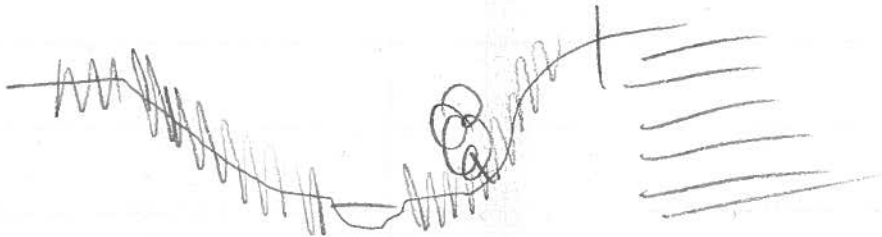

Initial QA/QC By: L. Bentley

Date: May 16, 2012

Technical QA/QC By: [Signature] Date: Jan 11/12

Water Bodies Assessment Field Collection Form

R4.61-C

RSTC

AECOM

General Information

Study Area: Jericho Goshen Bluewater Land Parcel# JER1017 Site ID: RST-JER1017  
 Date: MAY 10/2012 Start time: 16:13 End Time: 16:20  
 Weather Conditions: Sunny, 13°C Field Crew: S. LOHNES C. HARDING  
 Field Notes By: SLOHNES

Site Location

East of Army Camp Rd to Bruce Scott

ASA roadside survey

UTM Co-ordinates (continue on page 3 if necessary)

Easting: 0423833 Northing: 4781635 Description: roadside  
 Easting: Northing: Description:  
 Easting: Northing: Description:  
 Easting: Northing: Description:

Surrounding Land Use

Type of Watercourse

Residential <input type="checkbox"/>	Meadow <input type="checkbox"/>	Intermittent <input type="checkbox"/>	Channelized <input checked="" type="checkbox"/>
Agriculture <input checked="" type="checkbox"/>	Wetland <input type="checkbox"/>	Permanent <input checked="" type="checkbox"/>	Natural Channel <input type="checkbox"/>
Forest <input type="checkbox"/>	Livestock <input type="checkbox"/>	Ephemeral <input type="checkbox"/>	
Other <input type="checkbox"/>			

Description: row crop. Description: channelized b/w fields of corn.

Notes: (include any inputs into the system i.e. tile drainage, seepages, overland flow)

roadside ditch.

Is any portion of the water body underground or not as mapped? Y / (N)

If Yes describe:  
 >

GPS Coordinate: Easting - Northing - Description -

Description of Land Topography Surrounding Water Body (rolling hills, sloping towards water body)

gentle slope towards w/c

In-Situ Water Quality

Ground Water and Seepage Indicators

WT (°C):	AT (°C): 13°C	Watercress <input checked="" type="checkbox"/>	Bank Seepage <input type="checkbox"/>
pH:	Cond ( s/cm):	Iron Staining <input type="checkbox"/>	None <input type="checkbox"/>
D.O. (mg/L)		Bubbling <input type="checkbox"/>	
Water Clarity: Clear <input type="checkbox"/> Turbid <input type="checkbox"/>		Other <input type="checkbox"/>	

Water Colour: ASA

Details: observed d/s of culvert

Notes:

## Water Bodies Assessment Field Collection Form

Stream Morphology																			
Site Length (m): <span style="font-size: 1.2em;">50m</span>		Bank Stability:																	
Channel Dimensions		<table style="width: 100%; text-align: center;"> <tr> <td></td> <td>Stable</td> <td>Slightly unstable</td> <td>Moderately unstable</td> <td>Unstable</td> </tr> <tr> <td>Left Bank</td> <td><input checked="" type="checkbox"/></td> <td><input type="checkbox"/></td> <td><input type="checkbox"/></td> <td><input type="checkbox"/></td> </tr> <tr> <td>Right Bank</td> <td><input checked="" type="checkbox"/></td> <td><input type="checkbox"/></td> <td><input type="checkbox"/></td> <td><input type="checkbox"/></td> </tr> </table>				Stable	Slightly unstable	Moderately unstable	Unstable	Left Bank	<input checked="" type="checkbox"/>	<input type="checkbox"/>	<input type="checkbox"/>	<input type="checkbox"/>	Right Bank	<input checked="" type="checkbox"/>	<input type="checkbox"/>	<input type="checkbox"/>	<input type="checkbox"/>
	Stable	Slightly unstable	Moderately unstable	Unstable															
Left Bank	<input checked="" type="checkbox"/>	<input type="checkbox"/>	<input type="checkbox"/>	<input type="checkbox"/>															
Right Bank	<input checked="" type="checkbox"/>	<input type="checkbox"/>	<input type="checkbox"/>	<input type="checkbox"/>															
Mean Wetted Width (m): <span style="font-size: 1.2em;">0.7m</span>	Mean Wetted Depth (m): <span style="font-size: 1.2em;">0.2m</span>	Description: <span style="font-size: 1.2em;">grassed.</span>																	
Mean Bankfull Width (m): <span style="font-size: 1.2em;">2.5m</span>	Mean Bankfull Depth (m): <span style="font-size: 1.2em;">0.35m</span>																		
Mean Top of Bank Width (m): <span style="font-size: 1.2em;">6.0m</span>	Mean Top of Bank Depth (m): <span style="font-size: 1.2em;">2.5m</span>																		
Flow Description: (high or low flow conditions, stagnant, etc) <span style="font-size: 1.2em;">moderate flow</span>																			
Habitat																			
Substrate (< = >)		Morphological Structure (%)																	
Bo - Boulder Co - Cobble Gr - Gravel Sa - Sand Si - Silt Cl - Clay MK - Muck DT - Detritus	Description <span style="font-size: 1.2em;">Sa &gt;&gt; Gra</span>	<table border="1" style="width: 100%; text-align: center;"> <tr> <th>Pool</th> <th>Riffle</th> <th>Run</th> <th>Flat</th> </tr> <tr> <td></td> <td></td> <td>100</td> <td></td> </tr> </table>			Pool	Riffle	Run	Flat			100								
Pool	Riffle	Run	Flat																
		100																	
		Notes:																	
Instream Cover (%)																			
Other	Woody Debris	Boulders	Cobble	Aquatic Vegetation*	None	Undercut Banks													
				<span style="font-size: 1.2em;">85</span>		Average Depth: (% Cover)													
Note: Low = 0 - 30%; Moderate = 30 - 75%; High = 75 - 100%																			
*Aquatic Vegetation Species Present (algae, submergent, emergent etc.) <span style="font-size: 1.2em;">attached + floating algae, watercress, grasses</span>																			
Canopy Cover (% closed cover):			Types of Cover (% cover)																
100-90%	<input type="checkbox"/>	30-1%	<input checked="" type="checkbox"/>	Trees	Shrubs	Man-made structures													
90-60%	<input type="checkbox"/>	0%	<input checked="" type="checkbox"/>	Grasses	Herbaceous	Other													
60-30%	<input type="checkbox"/>				<span style="font-size: 1.2em;">10%</span>														
Note: Low = 0 - 30%; Moderate = 30 - 60%; High = 60 - 100%																			
Notes: (vegetation species, types of structures) <span style="font-size: 1.2em;">willow + dogwood</span>																			
Obstructions to Fish Passage																			
No Obstructions <input checked="" type="checkbox"/> Man-Made <input type="checkbox"/> Natural <input type="checkbox"/> Low Flow Barrier <input type="checkbox"/>																			
Description of Barrier:																			
Height of Barrier (m)			GPS Coordinates:																

R4.61-C

AECOM

Date: MAY 10/18

Land Parcel/Site ID: R5-TC  
JK 1017

Page 3 of 4

Other General Comments Regarding the Study Area:

- narrow riparian buffers between back of new crops - few shrubs
- some watercress and algae in stream over sandy substrate with some pockets of gravel near Army Camp Rd.

Additional UTM Coordinates:

Photo Log			
Picture #	Description	Picture #	Description
1	Sheet		
2	Channel d/s of road		
3	Substrate d/s		
4	roadside ditch (S)		

Water Bodies Assessment Field Collection Form

(R4.61-C)

(RS+E)

AECOM

Page 4 of 4

Study Area:

Jericho

Goshen

Bluewater

Land Parcel#

JER 1017

Site ID

RS-T-JER1017

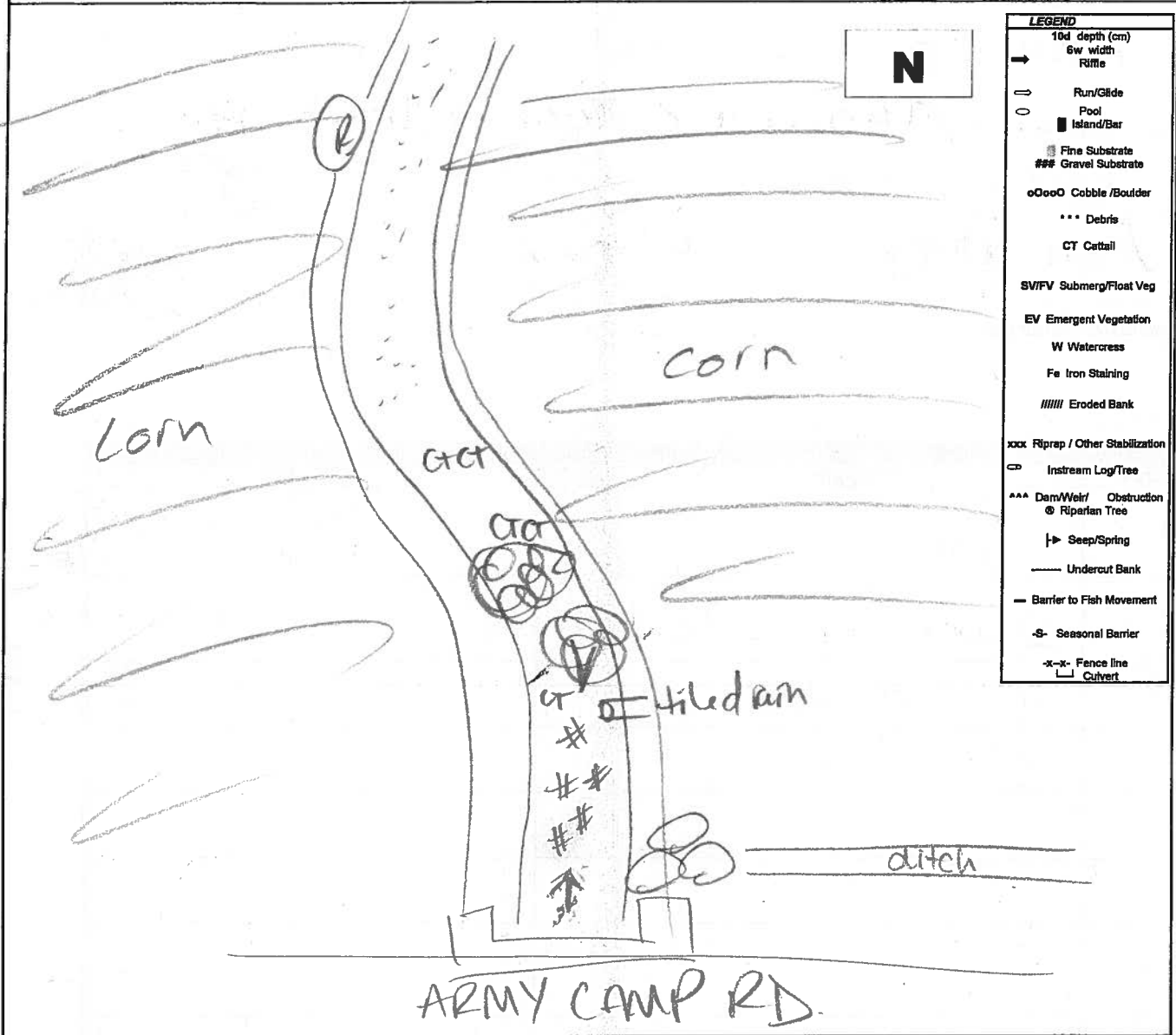

Horizontal View of Channel



Initial QA/QC By: L. Bentley

Date: May 16, 2012

Technical QA/QC By: Slutsker

Date: June 11/12

Water Bodies Assessment Field Collection Form

24.61-C

<b>AECOM</b>		Page 1 of 4	
<b>General Information</b>			
Study Area: <u>Jericho</u>	Goshen	Bluewater	Land Parcel# <u>JER 3162/1017</u> Site ID: <u>45.1e</u>
Date: <u>July 30/12</u>	Start time: <u>16:10</u>	End Time: <u>16:40</u>	
Weather Conditions: <u>Sunny 30°C</u>		Field Crew: <u>C. Barros, T. Skorney</u>	
		Field Notes By: <u>C. Barros</u>	
<b>Site Location</b>			
<u>Bruce Scott Rd, east of Army Camp</u>			
<b>UTM Co-ordinates (continue on page 3 if necessary)</b>			
Easting: <u>423962</u>	Northing: <u>4782029</u>	Description: <u>wg</u>	
Easting: <u>424037</u>	Northing: <u>4782098</u>	Description: <u>RS.1 road</u>	
Easting: <u>0423933</u>	Northing: <u>4781992</u>	Description: <u>RS.1 Road</u>	
Easting:	Northing:	Description:	
<b>Surrounding Landuse</b>		<b>Type of Watercourse</b>	
Residential <input type="checkbox"/>	Meadow <input type="checkbox"/>	Intermittent <input type="checkbox"/>	Channelized <input checked="" type="checkbox"/>
Agriculture <input checked="" type="checkbox"/>	Wetland <input type="checkbox"/>	Permanent <input checked="" type="checkbox"/>	Natural Channel <input checked="" type="checkbox"/>
Forest <input type="checkbox"/>	Livestock <input type="checkbox"/>	Ephemeral <input type="checkbox"/>	
Other <input type="checkbox"/>	Barns <input checked="" type="checkbox"/>	Description: <u>starting to naturalize</u>	
Description: <u>agri - south</u> <u>Barns - north</u>			
Notes: (include any inputs into the system i.e. tile drainage, seepages, overland flow)			
Is any portion of the water body underground or not as mapped? Y <input type="checkbox"/> N <input checked="" type="checkbox"/>			
If Yes describe:			
/ / / /			
GPS Coordinate: Easting -		Northing - Description -	
Description of Land Topography Surrounding Water Body (rolling hills, sloping towards water body)			
<u>flat</u>			
<b>In-Situ Water Quality</b>		<b>Ground Water and Seepage Indicators</b>	
WT (°C): <u>28.00</u>	AT (°C): <u>30°</u>	Watercress <input checked="" type="checkbox"/>	Bank Seepage <input type="checkbox"/>
pH: <u>8.65</u>	Cond (µs/cm): <u>874</u>	Iron Staining <input type="checkbox"/>	None <input type="checkbox"/>
D.O. (mg/L) <u>29.5</u>		Bubbling <input type="checkbox"/>	<input type="checkbox"/>
Water Clarity: Clear <input type="checkbox"/>	Turbid <u>51</u> <input checked="" type="checkbox"/>	Other <input type="checkbox"/>	
Water Colour: <u>brown</u>	Details: <u>small clumps throughout</u>		
Notes: <u>small pool, no flow</u>			

ASA  
107

**Water Bodies Assessment Field Collection Form**

Stream Morphology																				
Site Length (m): <i>140m</i>			Bank Stability:																	
Channel Dimensions			<table style="width:100%; text-align: center;"> <tr> <td></td> <td>Stable</td> <td>Slightly unstable</td> <td>Moderately unstable</td> <td>Unstable</td> </tr> <tr> <td>Left Bank</td> <td><input type="checkbox"/></td> <td><input checked="" type="checkbox"/></td> <td><input type="checkbox"/></td> <td><input type="checkbox"/></td> </tr> <tr> <td>Right Bank</td> <td><input type="checkbox"/></td> <td><input checked="" type="checkbox"/></td> <td><input type="checkbox"/></td> <td><input type="checkbox"/></td> </tr> </table>				Stable	Slightly unstable	Moderately unstable	Unstable	Left Bank	<input type="checkbox"/>	<input checked="" type="checkbox"/>	<input type="checkbox"/>	<input type="checkbox"/>	Right Bank	<input type="checkbox"/>	<input checked="" type="checkbox"/>	<input type="checkbox"/>	<input type="checkbox"/>
	Stable	Slightly unstable	Moderately unstable	Unstable																
Left Bank	<input type="checkbox"/>	<input checked="" type="checkbox"/>	<input type="checkbox"/>	<input type="checkbox"/>																
Right Bank	<input type="checkbox"/>	<input checked="" type="checkbox"/>	<input type="checkbox"/>	<input type="checkbox"/>																
Mean Wetted Width (m): <i>0.6</i>	Mean Wetted Depth (m): <i>0.2</i>	Description: <i>some undercutting + erosion</i>																		
Mean Bankfull Width (m): <i>1.4</i>	Mean Bankfull Depth (m): <i>0.5</i>																			
Mean Top of Bank Width (m): <i>5</i>	Mean Top of Bank Depth (m): <i>2</i>																			
Flow Description: (high or low flow conditions, stagnant, etc)																				
<i>no observable flow - dry at culvert but water in rest of channel</i>																				
Habitat																				
Substrate (<=>)		Description		Morphological Structure (%)																
Bo - Boulder				Pool	Riffle															
Co - Cobble				Run	Flat															
Gr - Gravel					<i>100</i>															
Sa - Sand				Notes: <i>small meanders but no riffles or pools</i>																
Si - Silt																				
Cl - Clay																				
MK - Muck																				
DT - Detritus																				
Instream Cover (%)																				
Other	Woody Debris	Boulders	Cobble	Aquatic Vegetation*	None	Undercut Banks														
	<i>5</i>	<i>5</i>	<i>10</i>	<i>30</i>		Average Depth: <i>0.10</i> (% Cover) <i>5</i>														
Note: Low = 0 - 30%; Moderate = 30 - 75%; High = 75 - 100%																				
*Aquatic Vegetation Species Present (algae, submergent, emergent etc.)																				
<i>algae = grasses (emergent) &gt;&gt; water plantain &gt;&gt; watercress</i>																				
Canopy Cover (% closed cover):			Types of Cover (% cover)																	
100-90%	<input type="checkbox"/>	30-1%	<input checked="" type="checkbox"/>	Trees	<i>5</i>	Shrubs	<i>15</i>	Man-made structures												
90-60%	<input type="checkbox"/>	0%	<input type="checkbox"/>	Grasses	<i>80</i>	Herbaceous		Other												
60-30%	<input type="checkbox"/>																			
Note: Low = 0 - 30%; Moderate = 30 - 60%; High = 60 - 100%																				
Notes: (vegetation species, types of structures)																				
<i>dogwood</i>																				
Riparian Vegetation																				
Width and Description of riparian vegetation:			Riparian Vegetation																	
LB - <i>5m - meadow + grass</i>			RB - <i>5m - grass meadow</i>																	
Overhanging Vegetation Present <i>Y/N</i>			% Overhanging Vegetation:																	
Description of Overhanging Vegetation:																				
Obstructions to Fish Passage																				
None Observed	<input type="checkbox"/>	Man-Made	<input type="checkbox"/>	Natural	<input type="checkbox"/>	Low Flow Barrier	<input checked="" type="checkbox"/>													
Description of Barrier: <i>dry at culvert</i>																				
Height of Barrier (m)			GPS Coordinates:																	

Water Bodies Assessment Field Collection Form

24.61-C

AECOM

Date: July 30/12

Land Parcel/Site ID: JER 3162/1017

Page 3 of 4  
P5.1C

Other General Comments Regarding the Study Area:

Historically channelized and now naturalizing - slightly meandering. Highly veg banks, + some sections of the stream, by grass. Soft bottom and low canopy cover.

Watercourse looks similar on JER 1017 Apr 30m.

Additional UTM Coordinates:

frogs observed

Photo log

Picture #	Description	Picture #	Description
1-6	from road walking north		
7	log		
8-14	walking north to end of site		
15-19	looking south		



Water Bodies Assessment Field Collection Form

R4.61-C

AECOM

Page 4 of 4

Watercourse Sketch

Study Area:

Jericho

Goshen

Bluewater

Land Parcel#

JER 3162/

Site ID

R51C

1017

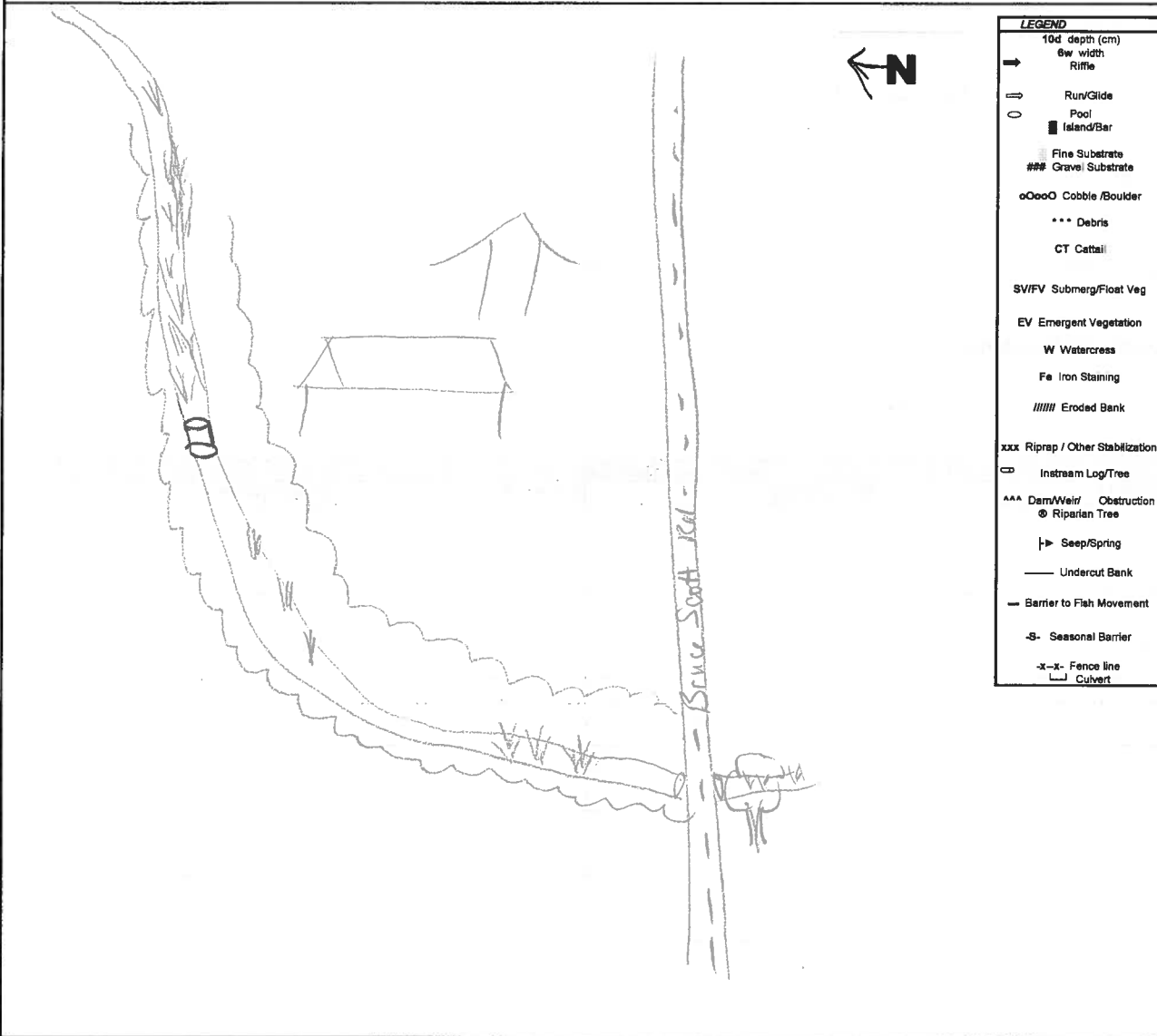

Horizontal View of Channel

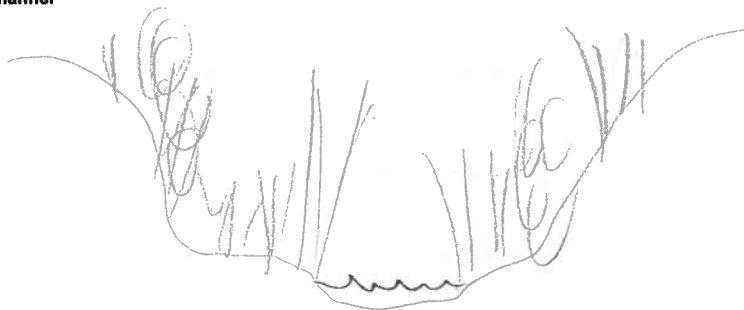

Initial QA/QC By: L. Bentley

Date: August 14, 2012

Technical QA/QC By: [Signature]

Date: Oct 2/12

Water Bodies Assessment Field Collection Form

\*ASA  
R0A081000

24.61-A

AECOM

General Information

Study Area: Jericho Goshen Bluewater Land Parcel# 25.1A Site ID: JCR3346+3358

Date: May 28/12 Start time: 14h45 End Time: 15h00

Weather Conditions: sun-hot 34°C Field Crew: CHARLES S. DARAIHE  
Field Notes By: S. DARAIHE

Site Location

West of army camp road and north + south of Thompson line.

UTM Co-ordinates (continue on page 3 if necessary)

None taken

Easting: \_\_\_\_\_ Northing: \_\_\_\_\_ Description: \_\_\_\_\_

Easting: \_\_\_\_\_ Northing: \_\_\_\_\_ Description: \_\_\_\_\_

Easting: \_\_\_\_\_ Northing: \_\_\_\_\_ Description: \_\_\_\_\_

Easting: \_\_\_\_\_ Northing: \_\_\_\_\_ Description: \_\_\_\_\_

Surrounding Landuse

- Residential
- Agriculture
- Forest
- Other
- Meadow
- Wetland
- Livestock

Type of Watercourse

- Intermittent
- Permanent
- Ephemeral
- Channelized
- Natural Channel

Description: wheat  
Went on 3346  
Fallow corn on 3142

Description: Ditch excavated

Notes: (include any inputs into the system i.e. tile drainage, seepages, overland flow)

~~None~~ Ditch Follow the north side of Thompson line

Is any portion of the water body underground or not as mapped? Y/N

GPS Coordinate: Easting - \_\_\_\_\_ Northing - \_\_\_\_\_ Description - \_\_\_\_\_

Description of Land Topography Surrounding Water Body (rolling hills, sloping towards water body)

Flat Field and roads

In-Situ Water Quality

WT (°C): 27 AT (°C): 34.1  
pH: 8.51 Cond ( s/cm): 501  
D.O. (mg/L): 14.12  
Water Clarity: Clear  Turbid

Water Colour: Brown

Notes:

Ground Water and Seepage Indicators

- Watercress
- Iron Staining
- Bubbling
- Other
- Bank Seepage
- None

Details:

Water Bodies Assessment Field Collection Form

Stream Morphology			
Site Length (m): 240 Road + 60 east		Bank Stability:	
Channel Dimensions		Stable	Slightly unstable
Mean Wetted Width (m): 2.00	Mean Wetted Depth (m): 0.35	Left Bank <input checked="" type="checkbox"/>	<input type="checkbox"/>
Mean Bankfull Width (m): 4.00	Mean Bankfull Depth (m): 1.00	Right Bank <input checked="" type="checkbox"/>	<input type="checkbox"/>
Mean Top of Bank Width (m): 8.00	Mean Top of Bank Depth (m): 2.50	Description: excavated	
Flow Description: (high or low flow conditions, stagnant, etc)			
x Very low Flow			
Substrate (<=>)		Biological Structure (%)	
Bo - Boulder	Description	Run	Flat
Co - Cobble	Si		100
Gr - Gravel			
Sa - Sand			
Si - Silt			
Cl - Clay			
MK - Muck			
DT - Detritus			
Instream Cover (%)			
Other	Woody Debris	Boulders	
Note: Low = 0 - 30%; Moderate = 30 - 75%; High = 75 - 100%			
*Aquatic Vegetation Species Present (algae, subm)			
Algae only			
Canopy Cover (% closed cover):			
100-90% <input type="checkbox"/>	30-1% <input checked="" type="checkbox"/>	Trees 2	Shrubs
90-60% <input type="checkbox"/>	0% <input type="checkbox"/>	Grasses	Herbaceous
60-30% <input type="checkbox"/>			Man-made structures
Note: Low = 0 - 30%; Moderate = 30 - 60%; High = 60 - 100%			
Notes: (vegetation species, types of structures)			
<del>Grasses</del> Willow tree			
Width and Description of riparian vegetation:		Riparian Vegetation	
LB - 1m Grasses		RB - 1m Grasses	
Overhanging Vegetation Present Y/N <input checked="" type="checkbox"/>		% Overhanging Vegetation:	
Description of Overhanging Vegetation:			
Obstructions to Fish Passage			
None Observed <input checked="" type="checkbox"/>	Man-Made <input type="checkbox"/>	Natural <input type="checkbox"/>	Low Flow Barrier <input type="checkbox"/>
Description of Barrier:			
Height of Barrier (m)		GPS Coordinates:	

algae considered cover? looks like floating algae

Water Bodies Assessment Field Collection Form

24.61-A

AECOM

Date: MAY 28 / 12

Land Parcel/Site ID: <sup>JKR</sup> 3346-3358 <sub>43-7A</sub> Page 3 of 4

Other General Comments Regarding the Study Area:

- On the parcel # 3358, the ditch are dry (Thompson line). (input)
- See a pair of mallards
- The Bank are excavated to remove CAT TAILS (And Bottom of the Stream)
- real Flat and low Flow

Additional UTM Coordinates:

Photo log

Picture #	Description	Picture #	Description
975	Facing north on Army Camp Rd		
976	Facing south Army Camp Rd		
<del>977</del>	<del>FACING west ON 3358 THOMPSON LINE</del>		
<del>978</del>	<del>FACING east on 3358 thompson line</del>		
979	Facing east on 3358 thompson line		
980	Facing west on 3358 thompson line		
981	input with culvert on 3346 north of thompson line		

Water Bodies Assessment Field Collection Form

R4.61-C

AECOM

Page 4 of 4

Watercourse Sketch JER

Study Area:

Jericho

Goshen

Bluewater

Land Parcel#

3346-3358

Site ID

RS-1A

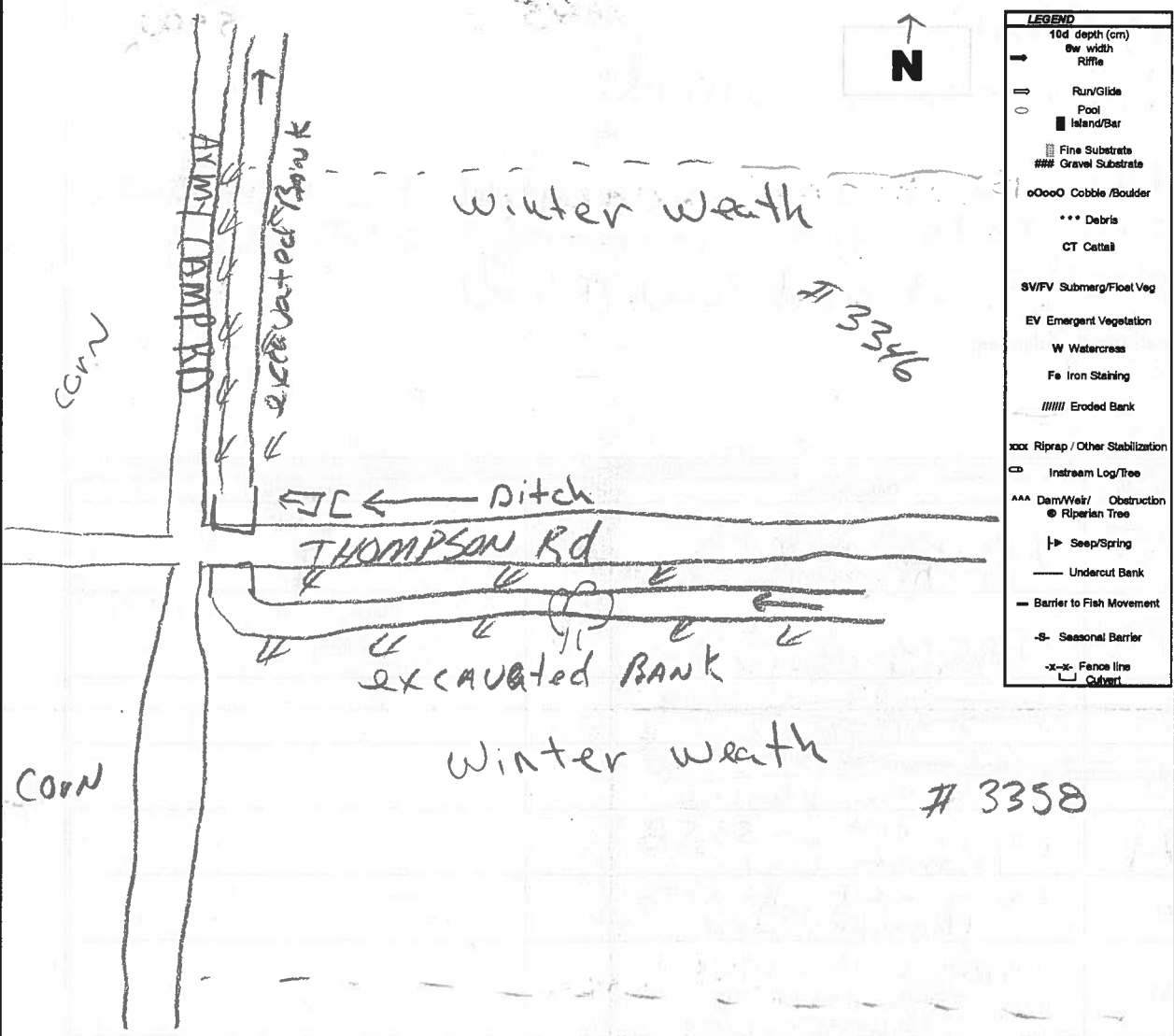

**LEGEND**

- 10d depth (cm) →
- 8w width →
- Riffle →
- Run/Glide →
- Pool ○
- Island/Bar ■
- Fine Substrate #
- Gravel Substrate ##
- oOooO Cobble/Boulder
- \*\*\* Debris
- CT Cattail
- SV/FV Submerg/Floet Veg
- EV Emergent Vegetation
- W Watercress
- Fe Iron Staking
- ||||| Eroded Bank
- xxx Riprap / Other Stabilization
- ▭ Instream Log/Tree
- AAA Dam/Waik/ Obstruction
- Riparian Tree
- ↳ Seep/Spring
- Undercut Bank
- Barrier to Fish Movement
- S- Seasonal Barrier
- x-x- Fence line
- ▭ Culvert

Horizontal View of Channel

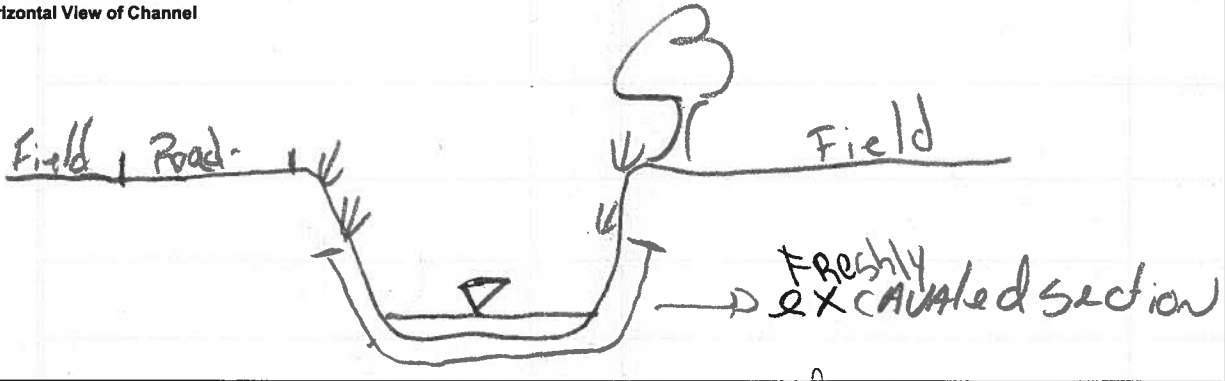

Initial QA/QC By: L. Bentley

Date: June 4, 2012

Technical QA/QC By: J. Miller

Date: Oct 2/12

Water Bodies Assessment Field Collection Form

24.61-A

AECOM

General Information

Study Area: Jericho Goshen Bluewater Land Parcel# 3342 Site ID: R5.1A  
 Date: MAY 30/12 Start time: 1145 End Time: 1240

Weather Conditions: cloudy 25°C  
 Field Crew: CHARON S DARACHU  
 Field Notes By: S DARACHU

Site Location

South of Ravenswood and across army camp Rd.

UTM Co-ordinates (continue on page 3 if necessary)

Easting: 424045 Northing: 4780265 Description: R5.1A  
 Easting: 424144 Northing: 4780125 Description: R5.1 Turtle  
 Easting: 424174 Northing: 4780062 Description: R5.1 B

Surrounding Landuse  
 Residential  Meadow   
 Agriculture  3342 Wetland   
 Forest  Livestock  3139  
 Other   
 Description: Crop soy beans  
 cow

Type of Watercourse  
 Intermittent  Channelized   
 Permanent  Natural Channel   
 Ephemeral   
 Description:

Notes: (include any inputs into the system i.e. tile drainage, seepages, overland flow)  
 -> tile close to RAVENWOOD R/B

Is any portion of the water body underground or not as mapped? Y / (N)  
 If Yes describe:

GPS Coordinate: Easting - Northing - Description -

Description of Land Topography Surrounding Water Body (rolling hills, sloping towards water body)  
 Flat - Sloped to water course.

In-Situ Water Quality  
 WT (°C): 22.8 AT (°C): 24.8  
 pH: 8.73 Cond ( s/cm): 633  
 D.O. (mg/L): 11.44  
 Water Clarity: Clear  Turbid   
 Water Colour:  
 Notes: + transp.  
 closed the culvert  
 of Ravenswood.

Ground Water and Seepage Indicators  
 Watercress  Bank Seepage   
 Iron Staining  None   
 Bubbling   
 Other   
 Details:

**Water Bodies Assessment Field Collection Form**

Stream Morphology			
Site Length (m):		220m	
Channel Dimensions		Bank Stability:	
Mean Wetted Width (m):	1.00	Mean Wetted Depth (m):	0.15
Mean Bankfull Width (m):	3.00	Mean Bankfull Depth (m):	0.50
Mean Top of Bank Width (m):	5.00	Mean Top of Bank Depth (m):	1.80
		Stable <input checked="" type="checkbox"/> Slightly unstable <input type="checkbox"/> Moderately unstable <input type="checkbox"/> Unstable <input type="checkbox"/> Left Bank <input checked="" type="checkbox"/> Right Bank <input checked="" type="checkbox"/>	
Description: <span style="font-size: 1.2em;">Grassed</span>			

Flow Description: (high or low flow conditions, stagnant, etc)  
low flow

Substrate (<=>)		Habitat												
Bo - Boulder Co - Cobble Gr - Gravel Sa - Sand Si - Silt Cl - Clay MK - Muck DT - Detritus	Description <span style="font-size: 1.5em;">Si</span>	<table border="1" style="width: 100%; border-collapse: collapse; text-align: center;"> <thead> <tr> <th colspan="4">Morphological Structure (%)</th> </tr> <tr> <th>Pool</th> <th>Riffle</th> <th>Run</th> <th>Flat</th> </tr> </thead> <tbody> <tr> <td></td> <td></td> <td><del>75</del></td> <td>100</td> </tr> </tbody> </table> Notes:	Morphological Structure (%)				Pool	Riffle	Run	Flat			<del>75</del>	100
Morphological Structure (%)														
Pool	Riffle	Run	Flat											
		<del>75</del>	100											

Instream Cover (%)						
Other	Woody Debris	Boulders	Cobble	Aquatic Vegetation*	None	Undercut Banks
				50	X	Average Depth: _____ (% Cover) _____

Note: Low = 0 - 30%; Moderate = 30 - 75%; High = 75 - 100%  
 \*Aquatic Vegetation Species Present (algae, submergent, emergent etc.)  
algae present with Cattail

Canopy Cover (% closed cover):			Types of Cover (% cover)			
100-90%	<input type="checkbox"/>	30-1%	<input type="checkbox"/>	Trees	Shrubs	Man-made structures
90-60%	<input type="checkbox"/>	0%	<input checked="" type="checkbox"/>	Grasses	Herbaceous	Other
60-30%	<input type="checkbox"/>					

Note: Low = 0 - 30%; Moderate = 30 - 60%; High = 60 - 100%  
 Notes: (vegetation species, types of structures)

Riparian Vegetation	
Width and Description of riparian vegetation: LB - <span style="font-size: 1.2em;">1m to 220m</span> <span style="font-size: 1.2em;">grasses, <del>sedges</del> wild roses</span>	RB - <span style="font-size: 1.2em;">20m</span> <span style="font-size: 1.2em;">Grasses Salix tree and shrubs wild roses</span>

Overhanging Vegetation Present  (N) % Overhanging Vegetation: \_\_\_\_\_  
 Description of Overhanging Vegetation:

Obstructions to Fish Passage			
None Observed	<input checked="" type="checkbox"/>	Man-Made	<input type="checkbox"/>
Natural	<input type="checkbox"/>	Low Flow Barrier	<input type="checkbox"/>

Description of Barrier:  
 Height of Barrier (m): \_\_\_\_\_      GPS Coordinates: \_\_\_\_\_



Water Bodies Assessment Field Collection Form

3139

24.61-A

AECOM

Date: May 30/12

Land Parcel/Site ID:

~~3342/RS1A~~

Page 3 of 4

Other General Comments Regarding the Study Area:

- Turtle observed (snapping)
- Cyprinidae observed
- Very opened habitat.
- Freshly excavated for remove instream vegetation
- Straight Stream.

Additional UTM Coordinates:

Photo log

Picture #	Description	Picture #	Description
1109	Drain R/B #1		
1108	Culvert under Ravenswood Rd.		
1110	U/S From the culvert Ravenswood		
1111	D/S Facing North		
1112	U/S Facing South		
1113	Culvert under Army camp		
1114	From culvert Army Camp Rd D/S		
1115	U/S From culvert Army Rd		
1116	Culvert Army Rd From U/S		
1117	turtle (RS11 Turtle)		
1118	Culvert RS11B		
1119	Facing North D/S RS11B		

1120 Fence line U/S RS11B



Water Bodies Assessment Field Collection Form

R4.61-A

AECOM

Page 4 of 4

Watercourse Sketch

Study Area:

Jericho

Goshen

Bluwater

Land Parcel#

3139  
3342

Site ID

R5.1A

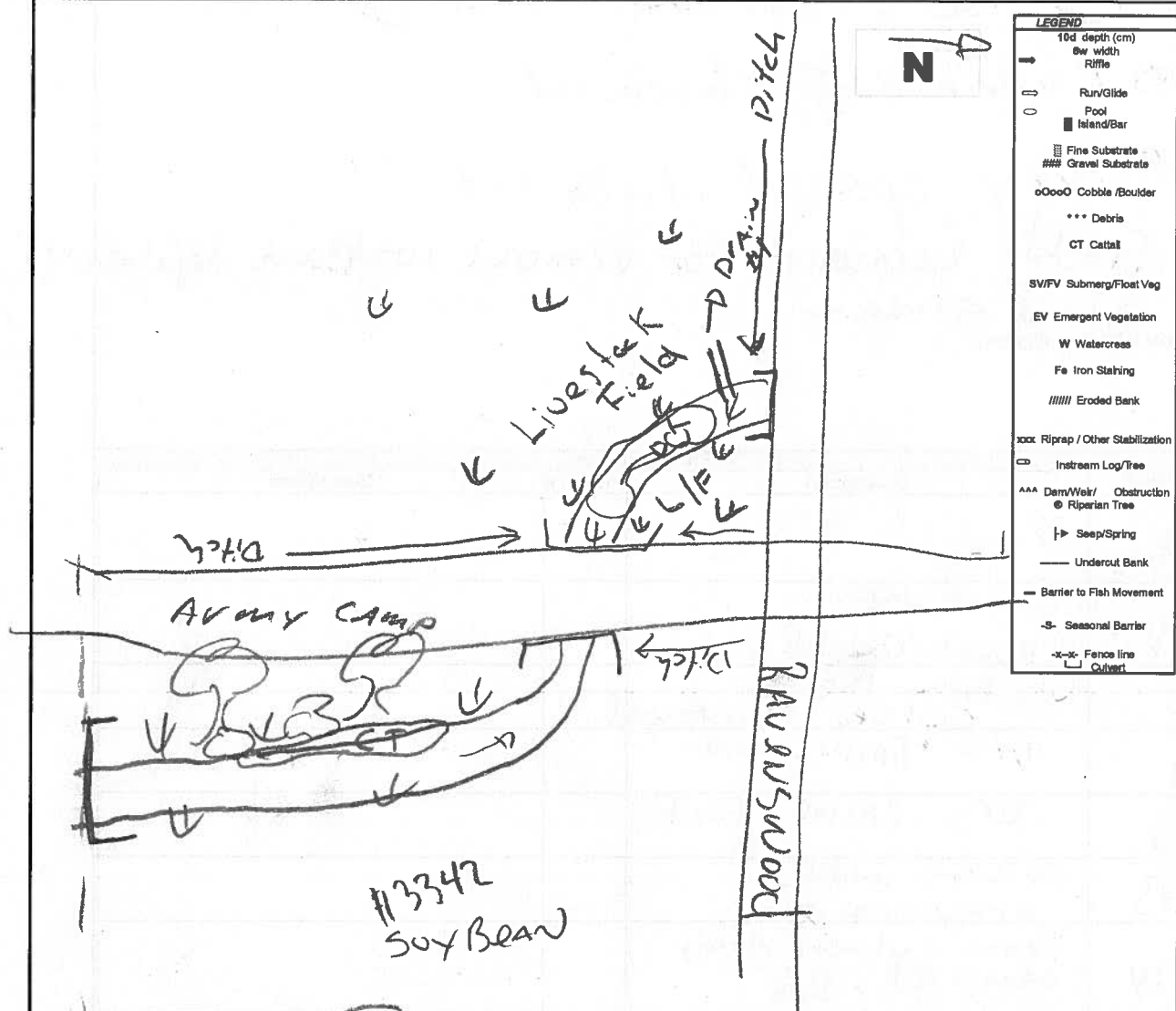

Horizontal View of Channel

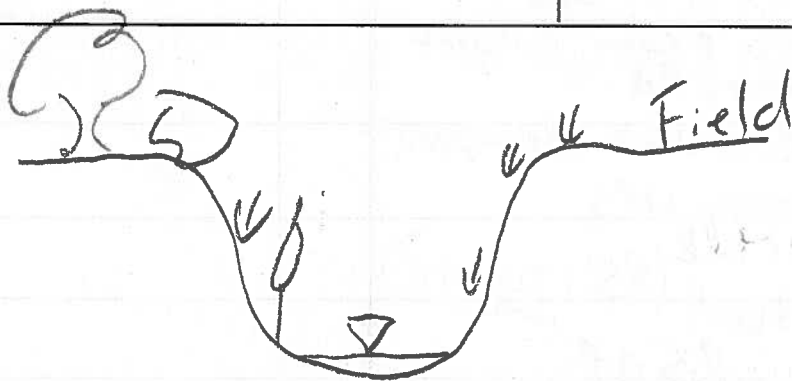

Initial QA/QC By:

L. Bentley

Date:

June 4, 2012

Technical QA/QC By:

Sutke

Date:

Oct 2012

Water Bodies Assessment Field Collection Form

RS1-A (R4.61-A)

AECOM

General Information

Study Area: Jericho Goshen Bluewater Land Parcel# 1056 Site ID: RS1-JER1056  
 Date: MAY 14/12 Start time: 0800 AM End Time: 08:40 AM  
 Weather Conditions: Sunny, 10°C Field Crew: S. LOHNES C. HARDING  
 Field Notes By: S. LOHNES

Site Location

North of Ravenswood, west of Army Camp Rd.

UTM Co-ordinates (omitted on page 5 if necessary)

Easting: 0424036	Northing: 4780289	Description: START @ Ravenswood
Easting: 0423944	Northing: 4480516	Description: H <sub>2</sub> O chem
Easting: 0423959	Northing: 4780689	Description: end + burner
Easting:	Northing:	Description:

Surrounding Landuse

Residential  Meadow   
 Agriculture  Wetland   
 Forest  Livestock   
 Other   
 Description: row crops

Type of Watercourse

Intermittent  Channelized   
 Permanent  Natural Channel   
 Ephemeral   
 Description: permanent flowing north

Notes: (include any inputs into the system i.e. tile drainage, seepages, overland flow)

roadside ditch,

Is any portion of the water body underground or not as mapped? Y / N

If Yes describe:

GPS Coordinate: Easting - Northing - Description -

Description of Land Topography Surrounding Water Body (rolling hills, sloping towards water body)

slopes from agricultural land towards watercourse

In-Situ Water Quality

WT (°C): 7.9°C AT (°C): 10°C  
 pH: 8.21 Cond (µs/cm): 670  
 D.O. (mg/L): 7.23  
 Water Clarity: Clear  Turbid

Water Colour: colourless

Notes:

Ground Water and Seepage Indicators

Watercress  Bank Seepage   
 Iron Staining  None   
 Bubbling   
 Other   
 Details: some clumps

Water Bodies Assessment Field Collection Form

R4.61-A R5.1A

AECOM

Page 4 of 4

Study Area: Jericho Goshen Bluewater Land Parcel# 1056 Site ID R5.1-1056

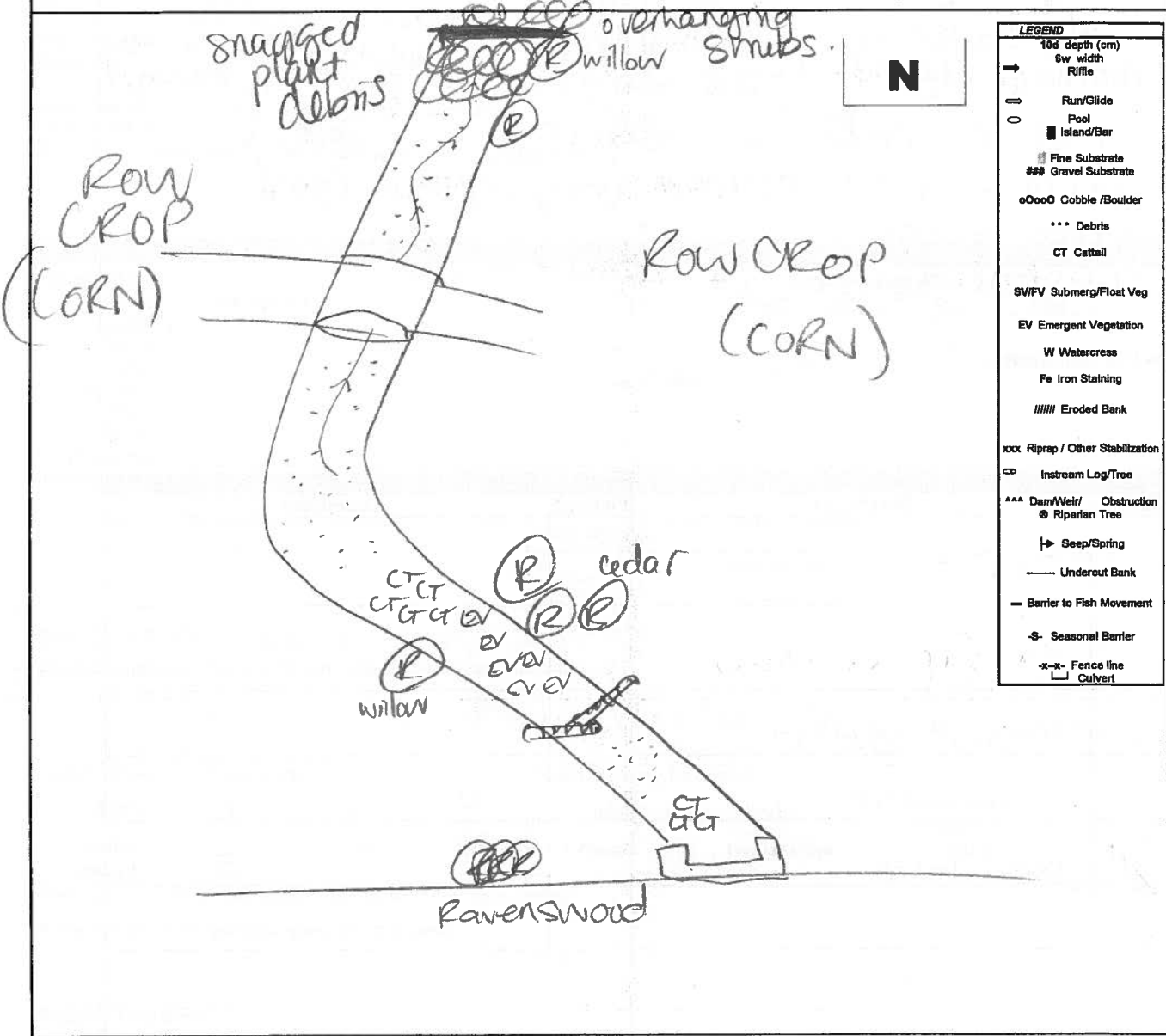

Horizontal View of Channel

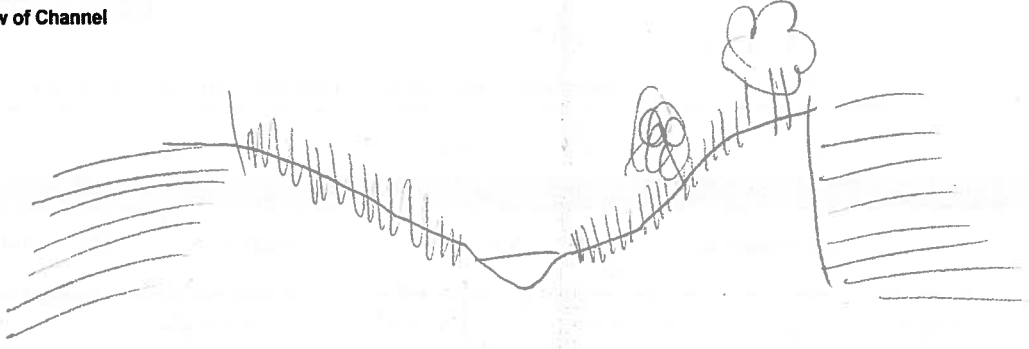

Initial QA/QC By: L. Bentley

Date: May 16, 2012

Technical QA/QC By: Slutka

Date: Jun 11/12

Water Bodies Assessment Field Collection Form

24.61-A

AECOM

General Information

Study Area: Jericho Goshen Bluewater Land Parcel# JER 1015, 1099 Site ID: R5.1A

Date: July 31 / 12 Start time: 8:30 3346, 3343, 3345 End Time: 9:40

Weather Conditions:

Cloudy, 20°C

Field Crew: C. Boros, T. Shorney

Field Notes By: C. Boros

ASA  
3346

Site Location

Army Camp Rd, btw Ravenswood + Thomson Ln

UTM Co-ordinates (continue on page 3 if necessary)

Easting: <u>424174</u>	Northing: <u>4780052</u>	Description: <u>R5.1 st</u>
Easting: <u>424183</u>	Northing: <u>4779803</u>	Description: <u>R5.1 News</u>
Easting: <u>0424094</u>	Northing: <u>4779449</u>	Description: <u>R5.1 New end</u>
Easting: <u>424086</u>	Northing: <u>4778215</u>	Description: <u>R5.1 end</u>

Surrounding Landuse

Residential  Meadow   
 Agriculture  Wetland   
 Forest  Livestock   
 Other  Roadside

Description:

East - agri - soy bean  
West - road

Type of Watercourse

Intermittent  Channelized   
 Permanent  Natural Channel   
 Ephemeral

Description:

Straight

Notes: (include any inputs into the system i.e. tile drainage, seepages, overland flow)

Tile drain noted -

Is any portion of the water body underground or not as mapped? Y (N)

If Yes describe:

GPS Coordinate: Easting - Northing - Description -

Description of Land Topography Surrounding Water Body (rolling hills, sloping towards water body)

flat

In-Situ Water Quality

WT (°C): 21.01 AT (°C): 20°C  
 pH: 7.94 Cond (µs/cm): 55.3  
 D.O. (mg/L) 6.71  
 Water Clarity: Clear  Turbid 5/10

Water Colour: brown 0424103 } GPS points  
4778821

Notes: Shallow water (0.10 m), no flow

Ground Water and Seepage Indicators

Watercress  Bank Seepage   
 Iron Staining  None   
 Bubbling   
 Other

Details:

- small clumps on 1015

**Water Bodies Assessment Field Collection Form**

Stream Morphology																				
Site Length (m): 1800m			Bank Stability:																	
Channel Dimensions <i>Dry channel w small pools</i>			<table border="1" style="width:100%; text-align: center;"> <tr> <td></td> <td>Stable</td> <td>Slightly unstable</td> <td>Moderately unstable</td> <td>Unstable</td> </tr> <tr> <td>Left Bank</td> <td><input checked="" type="checkbox"/></td> <td><input type="checkbox"/></td> <td><input type="checkbox"/></td> <td><input type="checkbox"/></td> </tr> <tr> <td>Right Bank</td> <td><input checked="" type="checkbox"/></td> <td><input type="checkbox"/></td> <td><input type="checkbox"/></td> <td><input type="checkbox"/></td> </tr> </table>				Stable	Slightly unstable	Moderately unstable	Unstable	Left Bank	<input checked="" type="checkbox"/>	<input type="checkbox"/>	<input type="checkbox"/>	<input type="checkbox"/>	Right Bank	<input checked="" type="checkbox"/>	<input type="checkbox"/>	<input type="checkbox"/>	<input type="checkbox"/>
	Stable	Slightly unstable	Moderately unstable	Unstable																
Left Bank	<input checked="" type="checkbox"/>	<input type="checkbox"/>	<input type="checkbox"/>	<input type="checkbox"/>																
Right Bank	<input checked="" type="checkbox"/>	<input type="checkbox"/>	<input type="checkbox"/>	<input type="checkbox"/>																
Mean Wetted Width (m): <i>dry</i> 1.6	Mean Wetted Depth (m): <i>—</i>		Description: <i>No erosion noted</i>																	
Mean Bankfull Width (m): 3	Mean Bankfull Depth (m): 0.5																			
Mean Top of Bank Width (m): 5	Mean Top of Bank Depth (m): 2.5																			
Flow Description: (high or low flow conditions, stagnant, etc)																				
<i>No flow - dry for most of channel</i>																				
Habitat																				
Substrate (<=>)			Morphological Structure (%)																	
Bo - Boulder Co - Cobble Gr - Gravel Sa - Sand Si - Silt Cl - Clay MK - Muck DT - Detritus			<table border="1" style="width:100%; text-align: center;"> <tr> <td>Pool</td> <td>Riffle</td> <td>Run</td> <td>Flat</td> </tr> <tr> <td></td> <td></td> <td></td> <td></td> </tr> </table>			Pool	Riffle	Run	Flat											
Pool	Riffle	Run	Flat																	
Description: <i>si = cl = sa &gt; mk</i>			Notes:																	
Instream Cover (%)																				
Other	Woody Debris	Boulders	Cobble	Aquatic Vegetation*	None	Undercut Banks														
			5	25		Average Depth: (% Cover)														
Note: Low = 0 - 30%; Moderate = 30 - 75%; High = 75 - 100%																				
*Aquatic Vegetation Species Present (algae, submergent, emergent etc.)																				
<i>Water plantain &gt; grasses</i>																				
Canopy Cover (% closed cover):			Types of Cover (% cover)																	
100-90%	<input type="checkbox"/>	30-1%	<input checked="" type="checkbox"/>	Trees	Shrubs 50	Man-made structures														
90-60%	<input type="checkbox"/>	0%	<input type="checkbox"/>	Grasses 50	Herbaceous	Other														
60-30%	<input type="checkbox"/>																			
Note: Low = 0 - 30%; Moderate = 30 - 60%; High = 60 - 100%																				
Notes: (vegetation species, types of structures)																				
<i>dogwood, wild floral, bromegrass, golden Pedsa</i>																				
Riparian Vegetation																				
Width and Description of riparian vegetation:			Riparian Vegetation:																	
LB - 1.5 - meadow w trees			RB - 4m - meadow																	
Overhanging Vegetation Present Y/N <input checked="" type="checkbox"/>			% Overhanging Vegetation:																	
Description of Overhanging Vegetation:																				
Obstructions to Fish Passage																				
None Observed	<input type="checkbox"/>	Man-Made	<input type="checkbox"/>	Natural	<input type="checkbox"/>	Low Flow Barrier	<input checked="" type="checkbox"/>													
Description of Barrier: <i>majority of stream was dry</i>																				
Height of Barrier (m)			GPS Coordinates:																	

**Water Bodies Assessment Field Collection Form**

R4.61-A

**AECOM**

Date: July 31/12

Land Parcel/Site ID: JER 1015, 1014, 3346, 3343, 3345 Page 3 of 4

RS-1A

**Other General Comments Regarding the Study Area:**

Unmapped watercourse - runs along property JER 3140. Dry channel - overgrown  
w/ shrubs + grasses. Channelized, straight. Bankfull ~ 2m width, TOB width = 3m  
ASA for 3140

R4.62  
R5.1 - straight channelized feature. Most of reach dry - only  
sporadic isolated pools. Banks vegetated. Channel not  
highly vegetated. Stretches of cattail along bankside.

**Additional UTM Coordinates:**

Chimney crayfish observed →

**Photo log**

Picture #	Description	Picture #	Description
1-20	North branch N walking S		
21-29	unmapped watercourse		
30-43	mind - south branch		

Water Bodies Assessment Field Collection Form

R4.61-A

AECOM

Page 4 of 4

Watercourse Sketch

Study Area:

Jericho

Goshen

Bluewater

Land Parcel#

JER1015, 1099, 3340,  
3343, 3345

Site ID

RS11A

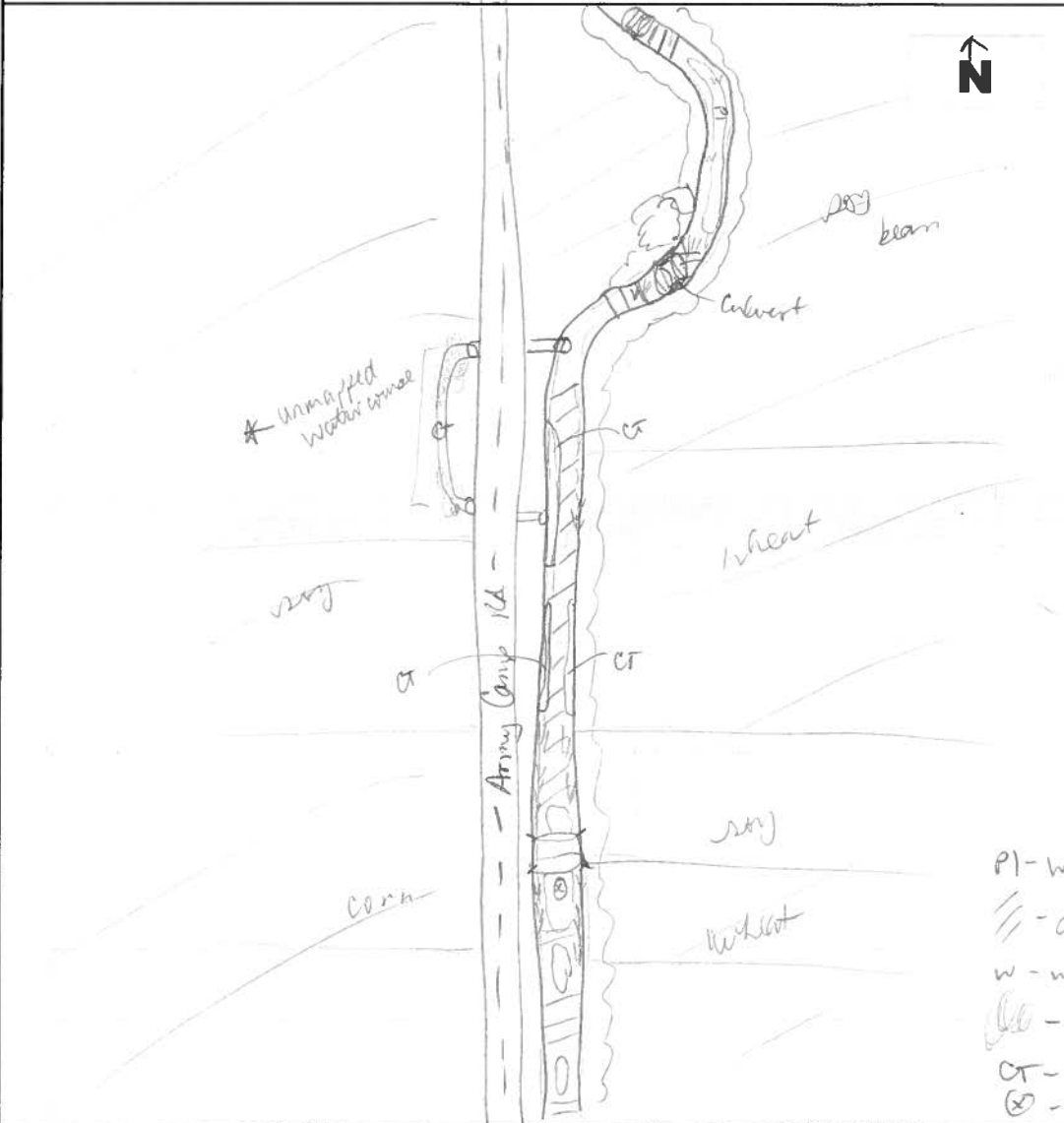

LEGEND	
10d depth (cm)	8w width
→	Riffle
⇨	Run/Glide
○	Pool
■	Island/Bar
▨	Fine Substrate
##	Gravel Substrate
oOoO	Cobble/Boulder
***	Debris
CT	Cattail
SVFV	Submerg/Float Veg
EV	Emergent Vegetation
W	Watercress
Fe	Iron Staining
	Eroded Bank
xxx	Riprap / Other Stabilization
CD	Instream Log/Tree
AAA	Dam/Weir / Obstruction
⊙	Riparian Tree
↳	Seep/Spring
—	Undercut Bank
—	Barrier to Fish Movement
-S-	Seasonal Barrier
-x-x-	Fence line
└┘	Culvert

P1 - water plantain  
 // - dry channel  
 w - watercress  
 (shrub) - shrubs over-grown  
 CT - cattail  
 ⊗ - wg

Horizontal View of Channel



Initial QA/QC By: L. Bentley

Date: August 4, 2012 Technical QA/QC By: [Signature]

Date: Oct 2/12

25.1B 24.61-B

AECOM

General Information

Study Area: Jericho Goshen Bluewater Land Parcel# 1129 Site ID: 25.1B JER1129  
 Date: MAY 10/12 Start time: 16:50 PM End Time: 17:25 PM

Weather Conditions: Sunny, 14°C Field Crew: S. LOHNES CHARLING  
 Field Notes By: S. LOHNES.

Site Location

west of ARMY CAMP Rd between Hwy 21 + Ravenswood

UTM Co-ordinates (continue on page 3 if necessary)

Easting:	Northing:	Description:
0423712	4780826	H <sub>2</sub> O CHEM.
0423953	4780704	END @ willow tree

Surrounding Landuse Residential <input type="checkbox"/> Agriculture <input checked="" type="checkbox"/> Forest <input type="checkbox"/> Other <input type="checkbox"/> Description: non crops	Meadow <input type="checkbox"/> Wetland <input type="checkbox"/> Livestock <input type="checkbox"/>	Type of Watercourse Intermittent <input type="checkbox"/> Permanent <input checked="" type="checkbox"/> Ephemeral <input type="checkbox"/> Description: naturalizing w/ channel	Channelized <input checked="" type="checkbox"/> Natural Channel <input type="checkbox"/> <input type="checkbox"/>
---	---	---	---

Notes: (include any inputs into the system i.e. tile drainage, seepages, overland flow)

tile drains + flow from fields.

Is any portion of the water body underground or not as mapped? Y (N)  
 If Yes describe:

GPS Coordinate: Easting - Northing - Description -

Description of Land Topography Surrounding Water Body (rolling hills, sloping towards water body)

gentle slope towards w/c

In-Situ Water Quality

WT (°C): 17.4°C AT (°C): 14°C  
 pH: 8.26 Cond ( s/cm): 637  
 D.O. (mg/L) 7.40  
 Water Clarity: Clear  Turbid  Slightly  
 Water Colour: clear

Ground Water and Seepage Indicators

Watercress  Bank Seepage   
 Iron Staining  None   
 Bubbling    
 Other

Details: some large mats of watercress.

Notes: taken in area w/ cattail growth.



### Water Bodies Assessment Field Collection Form

Stream Morphology																				
Site Length (m): <u>600m</u>			Bank Stability:																	
Channel Dimensions			<table style="width: 100%; text-align: center;"> <tr> <td></td> <td>Stable</td> <td>Slightly unstable</td> <td>Moderately unstable</td> <td>Unstable</td> </tr> <tr> <td>Left Bank</td> <td><input checked="" type="checkbox"/></td> <td><input type="checkbox"/></td> <td><input type="checkbox"/></td> <td><input type="checkbox"/></td> </tr> <tr> <td>Right Bank</td> <td><input checked="" type="checkbox"/></td> <td><input type="checkbox"/></td> <td><input type="checkbox"/></td> <td><input type="checkbox"/></td> </tr> </table>				Stable	Slightly unstable	Moderately unstable	Unstable	Left Bank	<input checked="" type="checkbox"/>	<input type="checkbox"/>	<input type="checkbox"/>	<input type="checkbox"/>	Right Bank	<input checked="" type="checkbox"/>	<input type="checkbox"/>	<input type="checkbox"/>	<input type="checkbox"/>
	Stable	Slightly unstable	Moderately unstable	Unstable																
Left Bank	<input checked="" type="checkbox"/>	<input type="checkbox"/>	<input type="checkbox"/>	<input type="checkbox"/>																
Right Bank	<input checked="" type="checkbox"/>	<input type="checkbox"/>	<input type="checkbox"/>	<input type="checkbox"/>																
Mean Wetted Width (m): <u>2.0m</u>	Mean Wetted Depth (m): <u>0.20m</u>	Description: <u>vegetated</u>																		
Mean Bankfull Width (m): <u>2.5m</u>	Mean Bankfull Depth (m): <u>0.45m</u>																			
Mean Top of Bank Width (m): <u>4.5m</u>	Mean Top of Bank Depth (m): <u>1.4m</u>																			
Flow Description: (high or low flow conditions, stagnant, etc)																				
<u>low flow</u>																				
Habitat																				
Substrate (<=>)			Morphological Structure (%)																	
Description Bo - Boulder Co - Cobble Gr - Gravel Sa - Sand Si - Silt Cl - Clay MK - Muck DT - Detritus			<table border="1" style="width: 100%; text-align: center;"> <tr> <th>Pool</th> <th>Riffle</th> <th>Run</th> <th>Flat</th> </tr> <tr> <td></td> <td></td> <td>100</td> <td></td> </tr> </table>			Pool	Riffle	Run	Flat			100								
Pool	Riffle	Run	Flat																	
		100																		
<u>Sa + Si</u>			Notes: <u>low gradient reach.</u>																	
Instream Cover (%)																				
Other	Woody Debris	Boulders	Cobble	Aquatic Vegetation*	None	Undercut Banks														
				<u>85</u>		Average Depth: (% Cover)														
Note: Low = 0 - 30%; Moderate = 30 - 75%; High = 75 - 100%																				
*Aquatic Vegetation Species Present (algae, submergent, emergent etc.)																				
<u>cattails + grasses, algae.</u>																				
Canopy Cover (% closed cover):				Types of Cover (% cover)																
100-90%	<input type="checkbox"/>	30-1%	<input checked="" type="checkbox"/>	Trees	Shrubs <u>10%</u>	Man-made structures														
90-60%	<input type="checkbox"/>	0%	<input type="checkbox"/>	Grasses	Herbaceous	Other														
60-30%	<input type="checkbox"/>																			
Note: Low = 0 - 30%; Moderate = 30 - 60%; High = 60 - 100%																				
Notes: (vegetation species, types of structures)																				
<u>very little closed canopy.</u>																				
Riparian Vegetation																				
Width and Description of riparian vegetation:			Riparian Vegetation																	
LB - <u>&lt; 1m</u>			RB - <u>&lt; 1m</u>																	
Overhanging Vegetation Present <input checked="" type="checkbox"/> N			% Overhanging Vegetation: <u>10%</u>																	
Description of Overhanging Vegetation: <u>grasses, cattails</u>																				
Obstructions to Fish Passage																				
None Observed	<input checked="" type="checkbox"/>	Man-Made	<input type="checkbox"/>	Natural	<input type="checkbox"/>	Low Flow Barrier	<input type="checkbox"/>													
Description of Barrier:																				
Height of Barrier (m)			GPS Coordinates:																	

~~RS.1-B~~ 24.61-B

AECOM

Date: MAY 10/12

Land Parcel/Site ID: ~~RS.1-300189~~ Page 3 of 4

Other General Comments Regarding the Study Area:

- watercourse flows over sand + silt substrate on low gradient between two row crop fields with very narrow grassed riparian buffers.  
 - few shrubs dot the banks, providing little shade while instream structure was predominantly cattails + grasses -

Additional UTM Coordinates:

Photo log			
Picture #	Description	Picture #	Description
1	sheet	13	cattails / H <sub>2</sub> O chem
2	overview	14	bank veg.
3	adjacent land	15	instream CT
4	" "	16	typical land adj
5	riparian tree	17	" "
6	rock pile w/ veg.	18	CT pocket
7	instream cover	19	" "
8	" "	20	Shading
9	@ lane culvert	21	instream aq. veg
10	" "	22	Overview
11	row crop + bend m w/c <sup>23</sup>		"
12	" " facing NW		

Water Bodies Assessment Field Collection Form

(24.61-B)  
 (RS-1B)

Watercourse Sketch

Study Area: Jericho Goshen Bluewater Land Parcel# JER1129 Site ID RST JER1129

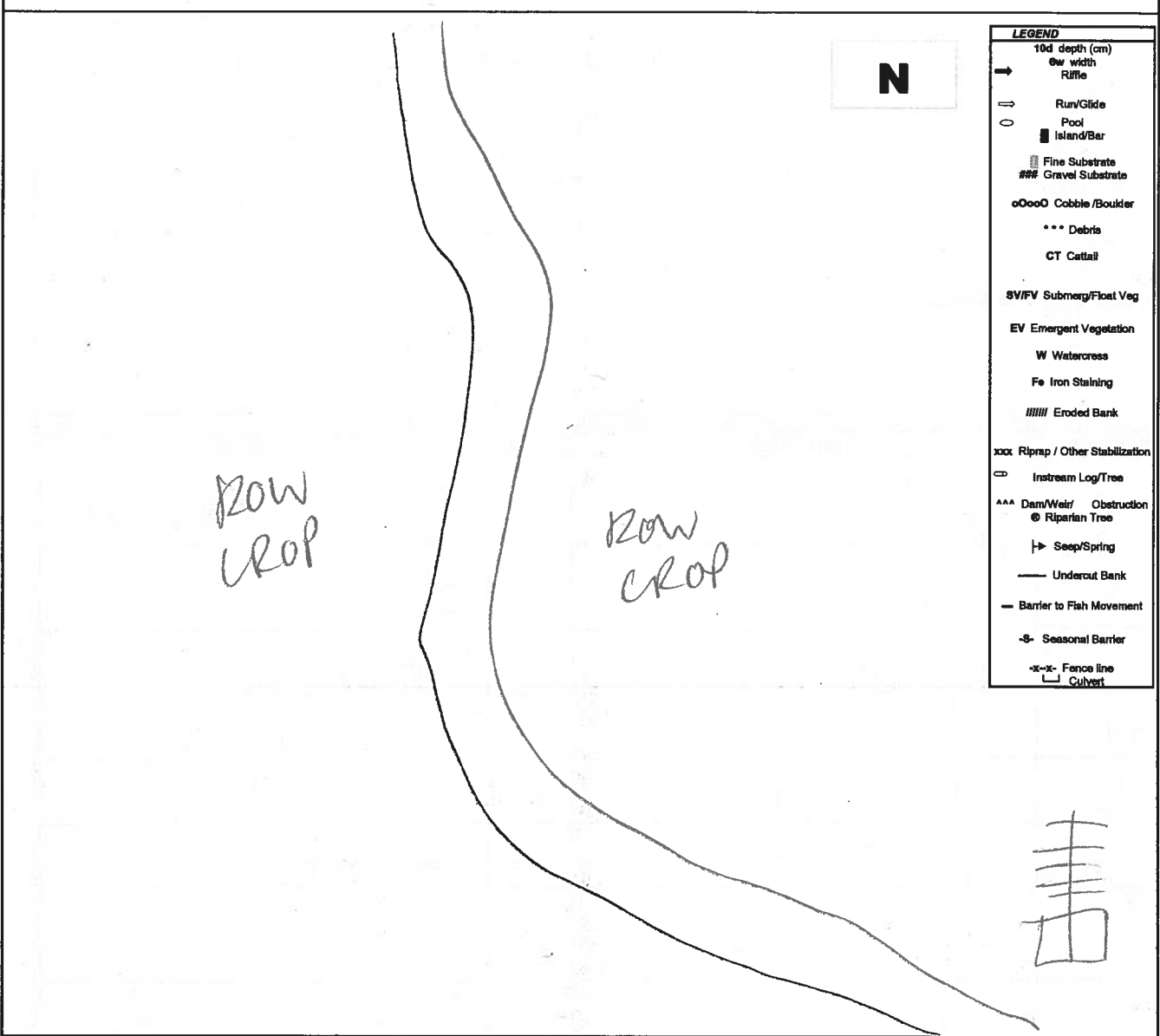

Horizontal View of Channel

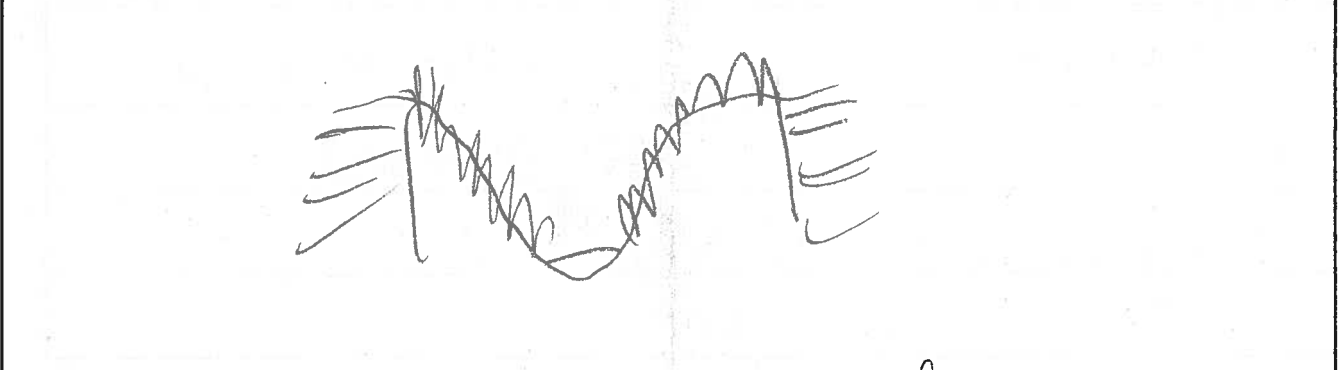

Initial QA/QC By: L. Bentley Date: May 16, 2012 Technical QA/QC By: [Signature] Date: Jun 11, 12

<b>AECOM</b>	
<b>General Information</b>	
Study Area: Jericho Goshen Bluewater Land Parcel# <u>3203</u>	Site ID: <u>RS</u>
Date: <u>May 31/12</u> Start time: <u>1100</u>	End Time: <u>1200</u>
Weather Conditions: <u>sun + some cloud 19°C</u>	Field Crew: <u>charlene &amp; darlene</u>
	Field Notes By: <u>SOANAICH</u>
<b>Site Location</b>	
<u>EAST OF KINNAIRD RD</u> <u>NHS OF THOMPSON</u>	
<u>ASA</u>	
<b>UTM Co-ordinates (continue on page 3 if necessary)</b>	
Easting: <u>423048</u> Northing: <u>4778225</u> Description: <u>RSST</u>	
Easting: <u>422683</u> Northing: <u>4778452</u> Description: <u>RS RP</u>	
Easting: <u>422655</u> Northing: <u>4778659</u> Description: <u>RSEND</u>	
Easting: _____ Northing: _____ Description: _____	
<b>Surrounding Landuse</b> Residential <input type="checkbox"/> Meadow <input type="checkbox"/> Agriculture <input checked="" type="checkbox"/> Wetland <input type="checkbox"/> Forest <input checked="" type="checkbox"/> Livestock <input type="checkbox"/> Other _____	<b>Type of Watercourse</b> Intermittent <input type="checkbox"/> Channelized <input checked="" type="checkbox"/> Permanent <input checked="" type="checkbox"/> Natural Channel <input type="checkbox"/> Ephemeral <input type="checkbox"/> _____ <input type="checkbox"/>
Description: <u>Section adjacent to Thompson Line</u>	Description: _____
Notes: (include any inputs into the system i.e. tile drainage, seepages, overland flow)	
<u>culvert ditch on south of Thompson line (RSST)</u>	
Is any portion of the water body underground or not as mapped? <u>Y/N</u>	
If Yes describe: _____	
GPS Coordinate: Easting - _____ Northing - _____ Description - _____	
Description of Land Topography Surrounding Water Body (rolling hills, sloping towards water body)	
<u>FLAT</u>	
<b>In-Situ Water Quality</b>	<b>Ground Water and Seepage Indicators</b>
WT (°C): <u>13.9</u> AT (°C): <u>18.5</u>	Watercress <input checked="" type="checkbox"/> Bank Seepage <input type="checkbox"/>
pH: <u>7.38</u> Cond ( s/cm): <u>526</u>	Iron Staining <input type="checkbox"/> None <input checked="" type="checkbox"/>
D.O. (mg/L) <u>11.52</u>	Bubbling <input type="checkbox"/> _____ <input type="checkbox"/>
Water Clarity: Clear <input checked="" type="checkbox"/> Turbid <input type="checkbox"/>	Other <input type="checkbox"/> _____
Water Colour: <u>transparent</u>	Details: _____
Notes: <u>W/S of Thompson Rd</u> <u>no culvert, (field)</u>	

Water Bodies Assessment Field Collection Form

Stream Morphology																				
Site Length (m): 500m			Bank Stability:																	
Channel Dimensions			<table style="width:100%; text-align: center;"> <tr> <td></td> <td>Stable</td> <td>Slightly unstable</td> <td>Moderately unstable</td> <td>Unstable</td> </tr> <tr> <td>Left Bank</td> <td><input checked="" type="checkbox"/></td> <td><input type="checkbox"/></td> <td><input type="checkbox"/></td> <td><input type="checkbox"/></td> </tr> <tr> <td>Right Bank</td> <td><input checked="" type="checkbox"/></td> <td><input type="checkbox"/></td> <td><input type="checkbox"/></td> <td><input type="checkbox"/></td> </tr> </table>				Stable	Slightly unstable	Moderately unstable	Unstable	Left Bank	<input checked="" type="checkbox"/>	<input type="checkbox"/>	<input type="checkbox"/>	<input type="checkbox"/>	Right Bank	<input checked="" type="checkbox"/>	<input type="checkbox"/>	<input type="checkbox"/>	<input type="checkbox"/>
	Stable	Slightly unstable	Moderately unstable	Unstable																
Left Bank	<input checked="" type="checkbox"/>	<input type="checkbox"/>	<input type="checkbox"/>	<input type="checkbox"/>																
Right Bank	<input checked="" type="checkbox"/>	<input type="checkbox"/>	<input type="checkbox"/>	<input type="checkbox"/>																
Mean Wetted Width (m): 0.90	Mean Wetted Depth (m): 0.05	Description: <u>Vegetated</u>																		
Mean Bankfull Width (m): 1.25	Mean Bankfull Depth (m): 0.45																			
Mean Top of Bank Width (m): 4.75	Mean Top of Bank Depth (m): 2.10																			
Flow Description: (high or low flow conditions, stagnant, etc) <u>low flow</u>																				
Habitat																				
Substrate (<=>)		Description		Morphological Structure (%)																
Bo - Boulder	Co - Cobble	<u>S: &gt;&gt; Co</u>		Pool	Riffle															
Gr - Gravel	Sa - Sand			Run	Flat															
Si - Silt	Cl - Clay	50      50																		
MK - Muck	DT - Detritus	Notes:																		
Instream Cover (%)																				
Other	Woody Debris	Boulders	Cobble	Aquatic Vegetation*	None															
			2	90																
					Average Depth: _____															
					(% Cover) _____															
Note: Low = 0 - 30%; Moderate = 30 - 75%; High = 75 - 100%																				
*Aquatic Vegetation Species Present (algae, submergent, emergent etc.)																				
<u>CATTAILS - ALGAE</u>																				
Canopy Cover (% closed cover):			Types of Cover (% cover)																	
100-90%	<input type="checkbox"/>	30-1%	<input checked="" type="checkbox"/>	Trees	5															
90-60%	<input type="checkbox"/>	0%	<input type="checkbox"/>	Shrubs	5															
60-30%	<input type="checkbox"/>			Man-made structures																
			Grasses _____ Herbaceous _____ Other _____																	
Note: Low = 0 - 30%; Moderate = 30 - 60%; High = 60 - 100%																				
Notes: (vegetation species, types of structures)																				
<u>Wild Calla</u>																				
<u>CATTAILS - Pennsylvania Bittercress</u>																				
Width and Description of riparian vegetation:			Riparian Vegetation																	
LB - <u>1m</u>			RB - <u>1m</u>																	
<u>Grasses, wild Roses, Common Raspberry, willow</u>																				
Overhanging Vegetation Present <input checked="" type="checkbox"/> N			% Overhanging Vegetation: <u>2</u>																	
Description of Overhanging Vegetation:																				
<u>SHRUBS</u>																				
Obstructions to Fish Passage																				
None Observed	<input type="checkbox"/>	Man-Made	<input type="checkbox"/>	Natural	<input type="checkbox"/>															
				Low Flow Barrier	<input checked="" type="checkbox"/>															
Description of Barrier: <u>in the section follow Thompson line by CATTAILS ON #3203 and ON JER 1138</u>																				
Height of Barrier (m) _____ GPS Coordinates: _____																				