

Water Bodies (Pond) Assessment Field Collection Form

AECOM

General Information

Study Area: Jéricho Goshen Bluewater Land Parcel# 3293 Site ID: P.2.18  
 Date: MAY 15/2012 Start time: 13:50 End Time: 18:50  
 Weather Conditions: SUNNY 20° Field Crew: B. Boros, A. Arsenault  
 Field Notes By: A. Arsenault

Site Location

west of Kennedy rd, north of land parcel 3294.

ASA from 32'

UTM Co-ordinates (Continue on page 2 if necessary)

Easting: 0431587 Northing: 4781238 Description: POND LOOK-OUT  
 Easting: Northing: Description:

Surrounding Land Use

Type of Pond

- |   |                                    |                                       |   |
|---|------------------------------------|---------------------------------------|---|
| Residential <input type="checkbox"/>            | Meadow <input type="checkbox"/>    | Natural <input type="checkbox"/>      | Dammed <input type="checkbox"/>           |
| Agriculture <input checked="" type="checkbox"/> | Wetland <input type="checkbox"/>   | Permanent <input type="checkbox"/>    | Seasonal <input type="checkbox"/>         |
| Forest <input type="checkbox"/>                 | Livestock <input type="checkbox"/> | Dugout Pond <input type="checkbox"/>  | Used for Farming <input type="checkbox"/> |
| Other <input type="checkbox"/>                  |                                    | Vernal Pools <input type="checkbox"/> |   |

Description: could not assess Description: could not assess

In-Situ Water Quality

Ground Water and Seepage Indicators

WT (°C): AT (°C):  
 pH: Cond ( s/cm):  
 D.O. (mg/L)  
 Water Clarity: Clear  Turbid   
 Water Colour: could not assess

- Watercress  Bank Seepage   
 Iron Staining  None   
 Bubbling   
 Other

Details: could not assess

Wildlife Observations

Observations of Fish and Wildlife  
could not assess

In-Situ Habitat

Physical Characteristics of Pond

Substrate (<=>) Description: could not assess  
 Bo - Boulder  
 Co - Cobble  
 Gr - Gravel  
 Sa - Sand  
 Si - Silt  
 Cl - Clay  
 MK - Muck  
 DT - Detritus

Estimated Size: Estimated Depth (m):  
 Notes: could not assess

In-Situ Cover (%)

None	Woody Debris	Boulders	Cobble	Aquatic Vegetation*	Structures	Other

Note: Low = 0 - 30% ; Moderate = 30 - 75% ; High = 75 - 100%  
 \*Aquatic Vegetation Species Present (algae, submergent, emergent etc.)

Description and Width of Riparian Vegetation  
could not assess

Water Bodies (Pond) Assessment Field Collection Form

AECOM

Date: May 15/12

Land Parcel/Site ID: 3ER 3293 P2.10

Page 2 of 2

Other General Comments Regarding the Study Area:

- Pond was slightly visible from property line look-out but unfortunately could not properly assess area - permission not granted

Picture #	Description	Picture #	Description
1,2	overview		

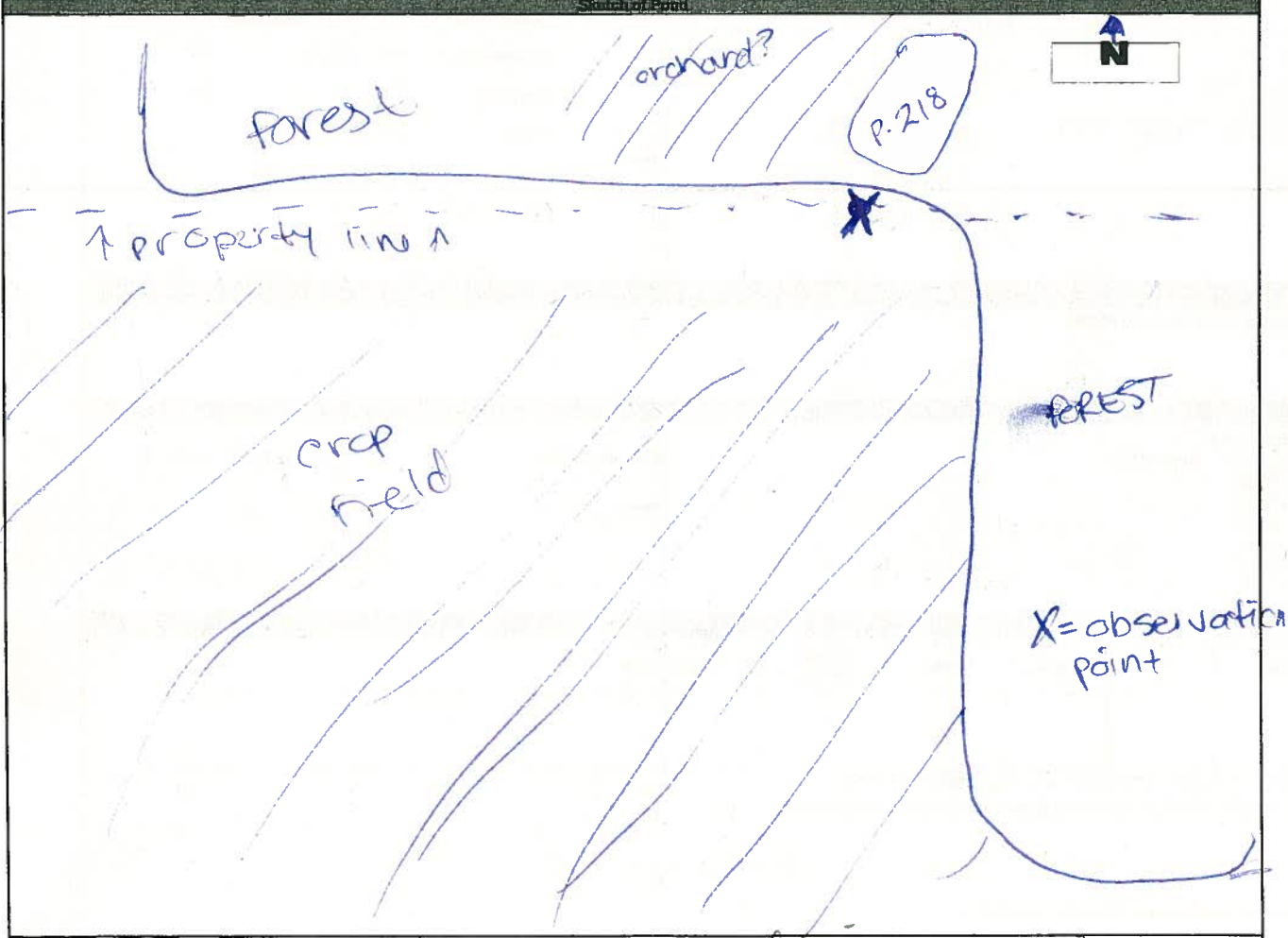

Initial QA/QC By: L. Bentley

Date: May 22, 2012

Technical QA/QC By: Schittler

Date: Jun 11/12

**Assessment of Non-Water Body  
(update to mapping required)**

**AECOM**

**General Information**

Study Area: Jericho Goshen Bluewater Land Parcel# 1013 Site ID: P2.115  
 Date: May 23/12 Start time: 15:54 End Time: 16:16  
 Weather Conditions: Sunny 24°C Field Crew: S. Aitken, S. Daraiche  
 Field Notes By: S. Aitken

**Site Location**

located north of Townsend line, pond located near barns

**UTM Co-ordinates**

see map

Easting: _____	Northing: _____	Description: _____
Easting: _____	Northing: _____	Description: _____
Easting: _____	Northing: _____	Description: _____
Easting: _____	Northing: _____	Description: _____

**Surrounding Landuse**

Residential <input type="checkbox"/>	Meadow <input type="checkbox"/>
Agriculture <input checked="" type="checkbox"/>	Wetland <input type="checkbox"/>
Forest <input type="checkbox"/>	Livestock <input type="checkbox"/>
Other <input type="checkbox"/>	

Description:

appears to be fenced off

**Ground Water and Seepage Indicators**

Watercress <input type="checkbox"/>	Bank Seepage <input type="checkbox"/>
Iron Staining <input type="checkbox"/>	None <input checked="" type="checkbox"/>
Bubbling <input type="checkbox"/>	

Details:

**Feature Description**

Is the mapped water body any of the below:

- 1) a grassed waterway? Y / N
- 2) Temporary channel for surface drainage, that can be tilled or driven through? Y / N
- 3) Rock chutes or spillways? Y / N
- 4) Roadside ditches that are not connected or do not contain a permanent or intermittent stream? Y / N
- 5) Temporarily ponded areas that are normally farmed? Y / N
- 6) Artificial bodies of water intended for storage, treatment for farming purposes? (Y / N)
- 8) Any other:

Description: (i.e. length of change, if it reappears, if there is evidence of water)

appears to be a man-made pond for agricultural purposes

**Photo log**

-NONE

Picture #	Description	Picture #	Description

Assessment of Non-Water Body  
(update to mapping required)

AECOM

Date: May 23/12

Land Parcel/Site ID: 1013/P2.115

Page 2 of 2

Site Sketch

N

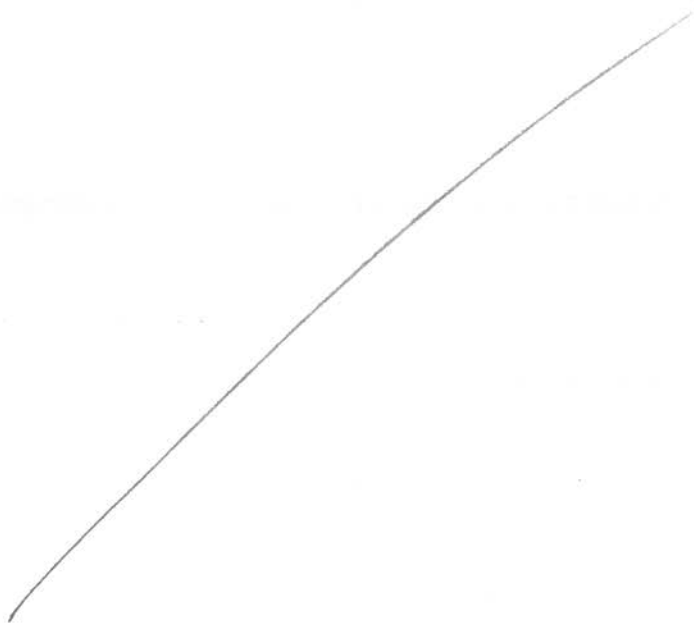

Initial QA/QC: L. Bentley June 13, 2012

24<sup>th</sup> September 2012

**Assessment of Non-Water Body  
(update to mapping required)**

**AECOM**

**General Information**

Study Area: Jericho Goshen Bluewater Land Parcel# 1013 Site ID: P2114  
 Date: May 23/12 Start time: 15:54 End Time: 16:16  
 Weather Conditions: Sunny 24°C Field Crew: S. Aitken, S. Daraiche  
 Field Notes By: S. Aitken

**Site Location**

north of Townsend Line, conducted ASA from JER 1013

**UTM Co-ordinates**

see map

Easting: _____	Northing: _____	Description: _____
Easting: _____	Northing: _____	Description: _____
Easting: _____	Northing: _____	Description: _____
Easting: _____	Northing: _____	Description: _____

**Surrounding Landuse**

Residential <input type="checkbox"/>	Meadow <input type="checkbox"/>
Agriculture <input checked="" type="checkbox"/>	Wetland <input type="checkbox"/>
Forest <input type="checkbox"/>	Livestock <input type="checkbox"/>
Other <input type="checkbox"/>	

Description:

last years corn

**Ground Water and Seepage Indicators**

Watercress <input type="checkbox"/>	Bank Seepage <input type="checkbox"/>
Iron Staining <input type="checkbox"/>	None <input checked="" type="checkbox"/>
Bubbling <input type="checkbox"/>	

Details:

none observed

**Feature Description**

Is the mapped water body any of the below:

- 1) a grassed waterway? Y / N
- 2) Temporary channel for surface drainage, that can be tilled or driven through? Y / N
- 3) Rock chutes or spillways? Y / N
- 4) Roadside ditches that are not connected or do not contain a permanent or intermittent stream? Y / N
- 5) Temporarily ponded areas that are normally farmed? (Y) N
- 6) Artificial bodies of water intended for storage, treatment for farming purposes? Y / N
- 8) Any other:

Description: (i.e. length of change, if it reappears, if there is evidence of water)

Small depression that may hold water, however can be farmed → dry at time of investigation

**Photo log**

Picture #	Description	Picture #	Description
<u>95</u>	<u>overview of site</u>		
	<u>facing east</u>		

Assessment of Non-Water Body  
(update to mapping required)

AECOM

Date: May 23/12

Land Parcel/Site ID: 1013/P2.114

Page 2 of 2

Site Sketch

N

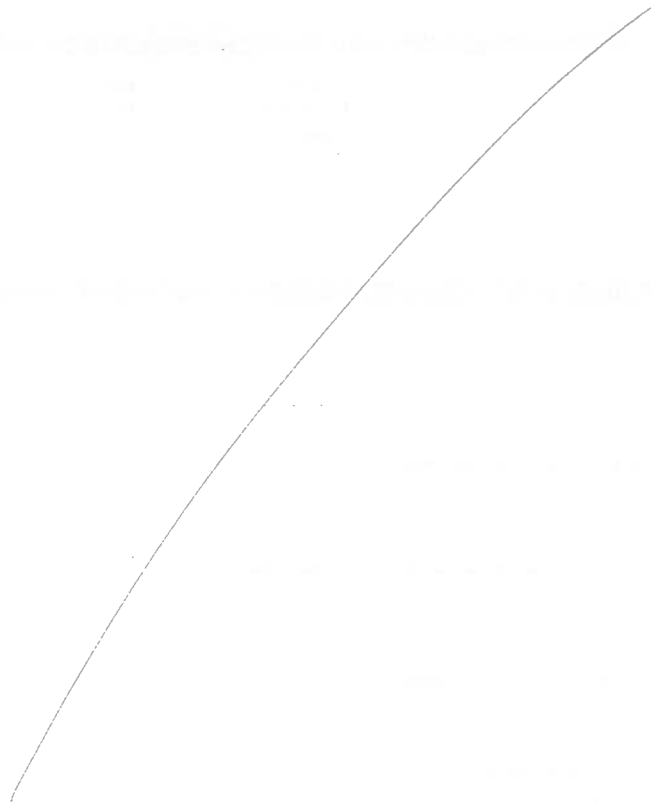

Initial QA/QC: L. Bentley June 13, 2012

*ADW.*

Water Bodies (Pond) Assessment Field Collection Form

ASCOM

General Information

Study Area: Jericho Goshen Bluewater Land Parcel# BOR 1453 Site ID: Pond 1453 - P1138

Date: MAY 30 2012 Start time: 9:15 End Time: 9:45

Weather Conditions: Field Crew: C. BOROS A. ARSENAULT

SUNNY 19° Field Notes By: C. BOROS

Site Location

Elginfield Rd, west of Sylvan

Unmapped pond

UTM Co-ordinates

Easting: 0436310 Northing: 4777781 Description: Bor 1453

Easting: Northing: Description:

Surrounding Landuse

- Residential
- Agriculture
- Forest
- Other
- Meadow
- Wetland
- Livestock

Description: forest surrounding pond.

Type of Pond

- Natural
- Permanent
- Dugout Pond
- Vernal Pools
- Dammed
- Seasonal
- Used for Farming

Description: dammed it to skate on in winter

In-Situ Water Quality

WT (°C): 17.53 AT (°C): 19°  
 pH: 6.36 Cond (us/cm): 431  
 D.O. (mg/L) 2.25  
 Water Clarity: Clear  Turbid

Water Colour: murky brown (very silty bottom)

Ground Water and Seepage Indicators

- Watercress
- Iron Staining
- Bubbling
- Bank Seepage
- None

Details:

Wildlife Observations

Observations of Fish and Wildlife  
 Green frogs abundant.

In-Situ Habitat

- Bo - Boulder
- Co - Cobble
- Gr - Gravel
- Sa - Sand
- Si - Silt
- Cl - Clay
- MK - Muck
- DT - Detritus

mk

Physical Characteristics of Pond

Estimated Size: 12 x 25m Estimated Depth (m): ~3ft (water depth)  
 Notes: mk bottom

In-Situ Cover (%)

None	Woody Debris	Boulders	Cobble	Aquatic Vegetation*	Structures	Other

Note: Low = 0-30%; Moderate = 30-75%; High = 75-100%

\*Aquatic Vegetation Species Present (algae, submergent, emergent etc.)

Some emergent grasses surrounding pond edges.  
 ↳ hard to assess - could not wade - mk

Description and Width of Riparian Vegetation

1 - 8m -> at residential side 1m + grasses N+S+E side forest

Water Bodies (Pond) Assessment Field Collection Form

AECOM

Date: MAY 30/12

Land Parcel/Site ID: Pond 1453 <sup>BOR</sup>

Page 2 of 2

Online Pond  Y /  N

Provide Description dammed the stream to create pond.

Offline Pond  Y /  N

Other General Comments Regarding the Study Area:

- ~3ft deep (water depth) but suspected to be much deeper in the mulchy substrate. (land owner told us this)
- Green frogs calling, abundant tree cover
- man-made dam allowing flow-through @ (S) east of pond towards Elginfield Rd.

Photo log	
Picture #	Description
1-3	overview from N end
4 (4314 - 4316 in R2.72)	

Sketch of Pond

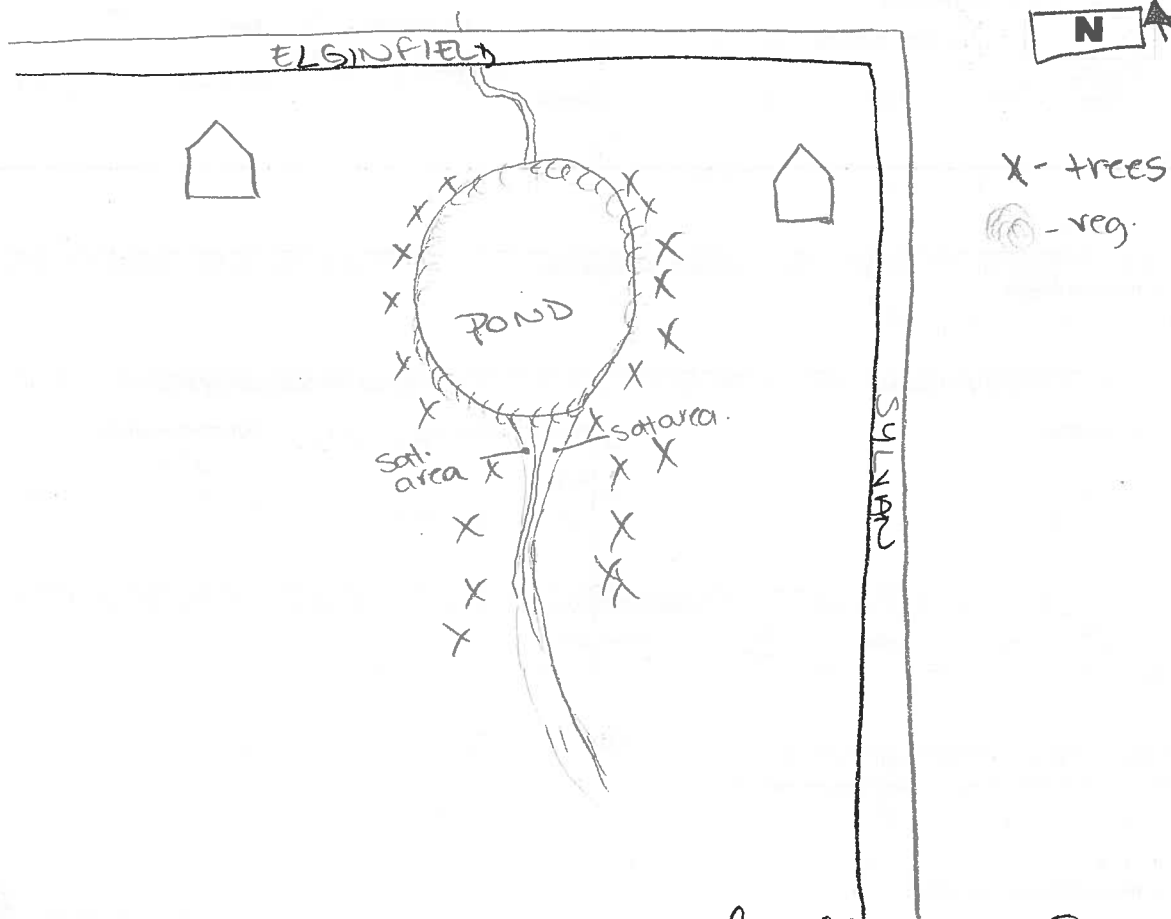

Initial QA/QC By: L. Bentley

Date: June 9, 2012

Technical QA/QC By: [Signature]

Date: Oct 4/12



Water Bodies (Pond) Assessment Field Collection Form

AECOM

General Information

Study Area: Jericho Goshen Bluewater Land Parcel# 752 2946 Site ID: P2.131  
 Date: May 31/12 Start time: 14:45 End Time: 15:00  
 Weather Conditions: Sunny, 12°C Field Crew: C. Boros, A. Arsenault  
 Field Notes By: C. Boros

Site Location

W: beach Kel, South of Binnam Kel.

UTM Co-ordinates

Easting: 0433408 Northing: 4706749 Description: P2.131

Easting: Northing: Description:

Surrounding Landuse

Residential  Meadow   
 Agriculture  Wetland   
 Forest  Livestock   
 Other

Type of Pond

Natural  Dammed   
 Permanent  Seasonal   
 Dugout Pond  Used for Farming   
 Vernal Pools

Description:

trees immediately surrounding them  
hay field

Description:

In-Situ Water Quality

WT (°C): 21.07 AT (°C): 12°C  
 pH: 8.64 Cond (µs/cm): 407  
 D.O. (mg/L) 11.92  
 Water Clarity: Clear  Turbid

Ground Water and Seepage Indicators

Watercress  Bank Seepage   
 Iron Staining  None   
 Bubbling

Water Colour:

sl. turbid brown

Details:

Wildlife Observations

Observations of Fish and Wildlife

Green frog heard

In-Situ Habitat

Substrate (<=>)

Bo - Boulder Description  
 Co - Cobble  
 Gr - Gravel  
 Sa - Sand mk, sa, si  
 Si - Silt  
 Cl - Clay  
 MK - Muck  
 DT - Detritus

Physical Characteristics of Pond

Estimated Size: 30m x 20m Estimated Depth (m): n/a  
 Notes: 400 deep to water

In-Situ Cover (%)

None	Woody Debris	Boulders	Cobble	Aquatic Vegetation*	Structures	Other
—	—	—	—	80	—	—

Note: Low = 0 - 30%; Moderate = 30 - 75%; High = 75 - 100%

\*Aquatic Vegetation Species Present (algae, submergent, emergent etc.)

Pondweed >> algae - attached

Description and Width of Riparian Vegetation

trees + shrubs around pond ~5m → poplar, cedar, willow, dogwood

**Water Bodies (Pond) Assessment Field Collection Form**

**AECOM**      Date: May 31/12      Land Parcel/Site ID: P2131-JER00410      Page 2 of 2

Online Pond    Y/N      Provide Description    no stream near by  
 Offline Pond    /N

**Other General Comments Regarding the Study Area:**  
Benthos observed, small amount of emergent veg surrounding pond

Photo log			
Picture #	Description	Picture #	Description
1	overview		
2-4	pond overview		

**Sketch of Pond**



Initial QA/QC By: L. Bentley      Date: June 9, 2012      Technical QA/QC By: [Signature]      Date: Oct 2/12

Water Bodies (Pond) Assessment Field Collection Form

<b>AECOM</b>							<b>General Information</b>								
Study Area: <u>Jericho</u>		Goshen		Bluewater		Land Parcel# <u>JER1047</u>		Site ID: <u>P3.44-JER1047</u>							
Date: <u>MAY 16/2012</u>		Start time: <u>17:05 PM</u>		End Time: <u>17:35 PM</u>		Weather Conditions: <u>Sunny, windy, 12°C</u>		Field Crew: <u>SLOANES J. PAPP</u>		Field Notes By: <u>SLOANES</u>					
<b>Site Location</b>															
<u>@ very far east end of property JER1047</u>															
<b>UTM Co-ordinates</b>															
Easting: <u>431397</u>		Northing: <u>4782530</u>		Description: <u>Pond location</u>											
Easting:		Northing:		Description:											
<b>Surrounding Landuse</b>							<b>Type of Pond</b>								
Residential <input type="checkbox"/>		Meadow <input type="checkbox"/>		Natural <input type="checkbox"/>		Dammed <input type="checkbox"/>									
Agriculture <input checked="" type="checkbox"/>		Wetland <input type="checkbox"/>		Permanent <input type="checkbox"/>		Seasonal <input type="checkbox"/>									
Forest <input checked="" type="checkbox"/>		Livestock <input type="checkbox"/>		Dugout Pond <input checked="" type="checkbox"/>		Used for Farming <input type="checkbox"/>									
Other <input type="checkbox"/>				Vernal Pools <input type="checkbox"/>											
Description: <u>mainly row crop w/ patch of forest in eastern margin</u>							Description: <u>dugout pond - poss. natural</u>								
<b>In-Situ Water Quality</b>															
WT (°C): <u>18.1°C</u>		AT (°C): <u>12°C</u>													
pH: <u>7.86</u>		Cond ( s/cm): <u>518</u>													
D.O. (mg/L) <u>4.38</u>															
Water Clarity: <u>Clear</u> <input checked="" type="checkbox"/>		Turbid <input type="checkbox"/>													
Water Colour: <u>brown</u>															
<b>Ground Water and Seepage Indicators</b>															
Watercress <input type="checkbox"/>		Bank Seepage <input type="checkbox"/>													
Iron Staining <input type="checkbox"/>		None <input checked="" type="checkbox"/>													
Bubbling <input type="checkbox"/>															
Details: <u>none observed</u>															
<b>Wildlife Observations</b>															
Observations of Fish and Wildlife: <u>RTHA (nesting in hedge row), fish observed (sp. unk).</u>															
<b>In-Situ Habitat</b>							<b>Physical Characteristics of Pond</b>								
Substrate (<=>)		Description		Estimated Size: <u>10x40 m</u>		Estimated Depth (m): <u>&gt;2m</u>									
Bo - Boulder				Notes: <u>shape indicates possibly dugout natural pond</u>											
Co - Cobble															
Gr - Gravel															
Sa - Sand		<u>Si + Sa</u>													
Si - Silt															
Cl - Clay															
MK - Muck															
DT - Detritus															
<b>In-Situ Cover (%)</b>															
None	Woody Debris	Boulders	Cobble	Aquatic Vegetation*	Structures	Other									
	<u>10</u>			<u>30</u>											
Note: Low = 0 - 30%; Moderate = 30 - 75%; High = 75 - 100%															
*Aquatic Vegetation Species Present (algae, submergent, emergent etc.)															
<u>pond duckweed</u>															
<b>Description and Width of Riparian Vegetation</b>															
<u>shrubs - red osier, raspberry, alders, trees - tr. aspen stand + willow + walnut</u>															

Water Bodies (Pond) Assessment Field Collection Form

**AECOM** Date: May 16/12 Land Parcel/Site ID: P3.44 SER1047 Page 2 of 2

Online Pond Y /  N Provide Description  
 Offline Pond Y /  N

Other General Comments Regarding the Study Area:  
 large dugout pond w/ naturalized banks + mature overhanging trees + shrubs

Photo log	
Picture #	Description
1	sheet
2	overview
3	along edge of veg
4-5	adj land use

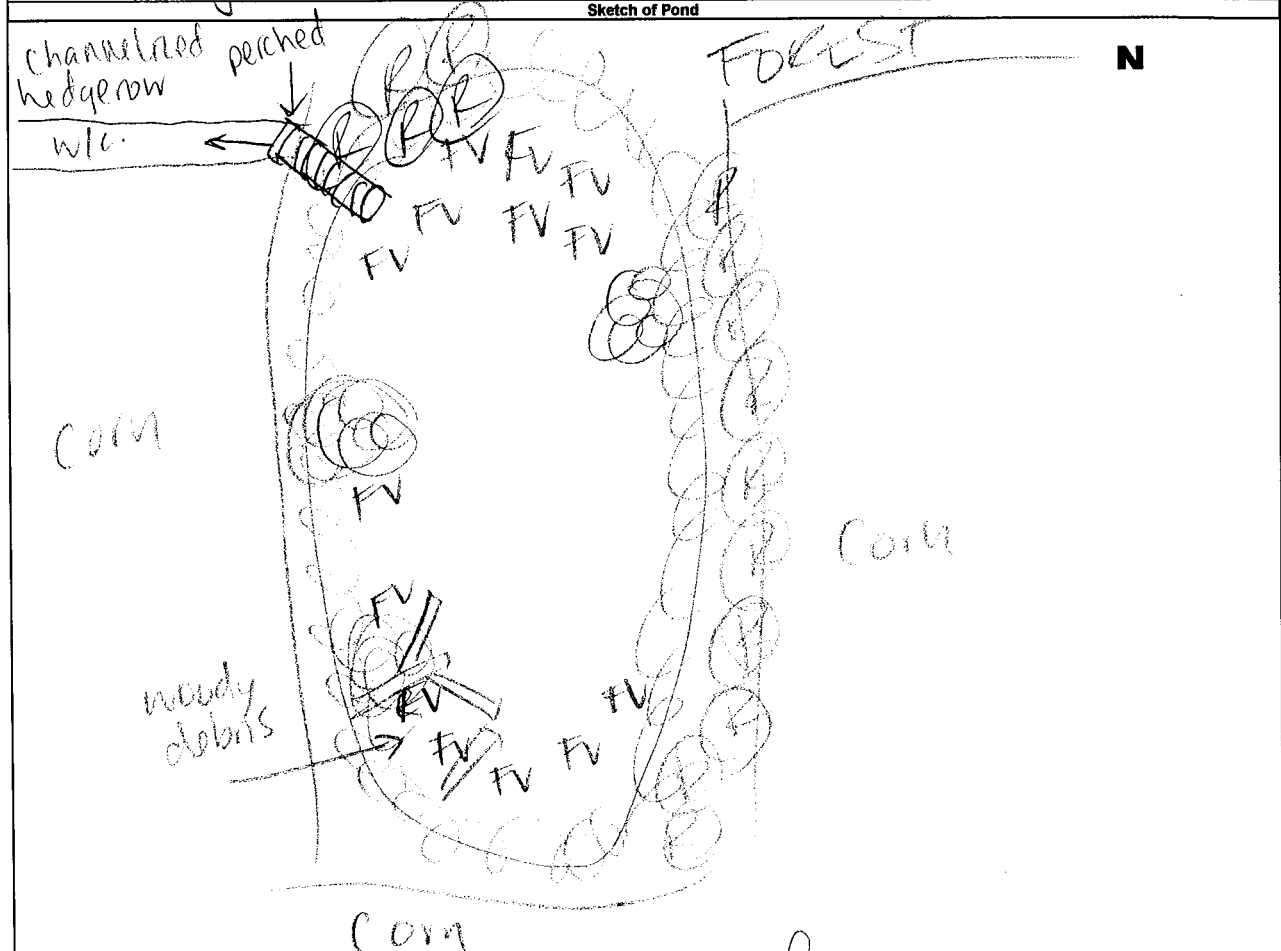

Initial QA/QC By: L. Bentley Date: May 22, 2012 Technical QA/QC By: [Signature] Date: Jun 11/12

Water Bodies (Pond) Assessment Field Collection Form

**AECOM**

**General Information**

Study Area: Jericho Goshen Bluewater Land Parcel# JER 1104 Site ID: P3.29  
 Date: May 23/12 Start time: 8:15 End Time: 8:45  
 Weather Conditions: Cloudy, 12°C Field Crew: C. Boros, J. Epp  
 Field Notes By: C. Boros

**Site Location**

Bog Lane, East of Northville Rd.

**UTM Co-ordinates**

Easting: 429292 Northing: 4783504 Description: P3.29 wq  
 Easting: Northing: Description:

**Surrounding Landuse**

- Residential
- Agriculture
- Forest
- Other
- Meadow
- Wetland
- Livestock

Description: Not sure - some industrial / mining activities

**Type of Pond**

- Natural
- Permanent
- Dugout Pond
- Vernal Pools
- Dammed
- Seasonal
- Used for Farming

Description:

**In-Situ Water Quality**

WT (°C): 19.68 AT (°C): 12  
 pH: 8.91 Cond (µs/cm): 335  
 D.O. (mg/L) 11.50  
 Water Clarity: Clear  Turbid   
 Water Colour: brown

**Ground Water and Seepage Indicators**

- Watercress
- Iron Staining
- Bubbling
- Bank Seepage
- None

Details:

**Wildlife Observations**

**Observations of Fish and Wildlife**

Jon Comments ->

**In-Situ Habitat**

Substrate (<=>) Description  
 Bo - Boulder  
 Co - Cobble  
 Gr - Gravel  
 Sa - Sand  
 Si - Silt  
 Cl - Clay  
 MK - Muck  
 DT - Detritus  
sa, gr, si, cl.

**Physical Characteristics of Pond**

Estimated Size: 200m x 100m Estimated Depth (m): n/a  
 Notes: drop off quickly at edge

**In-Situ Cover (%)**

None	Woody Debris	Boulders	Cobble	Aquatic Vegetation*	Structures	Other
				<u>80%</u>		

Note: Low = 0 - 30%; Moderate = 30 - 75%; High = 75 - 100%

\*Aquatic Vegetation Species Present (algae, submergent, emergent etc.)

-> hard to determine overall but along edges ~80% -> algae >> grasses

**Description and Width of Riparian Vegetation**

~5m in smallest area, ~15m at biggest -> regenerating meadow

Water Bodies (Pond) Assessment Field Collection Form

AECOM Date: May 23/12 Land Parcel/Site ID: P3.29 NER 110A Page 2 of 2

Online Pond Y / N Provide Description manmade, pond offline however looks like overflow channel to watercourse exists  
 Offline Pond  N

Other General Comments Regarding the Study Area:  
minnows observed - also Sunfish, Bass sp.  
↳ multiple species  
- green frog  
- dead swan

Picture #		Description	
<u>1-3</u>	<u>sheet overview</u>		

Sketch of Pond

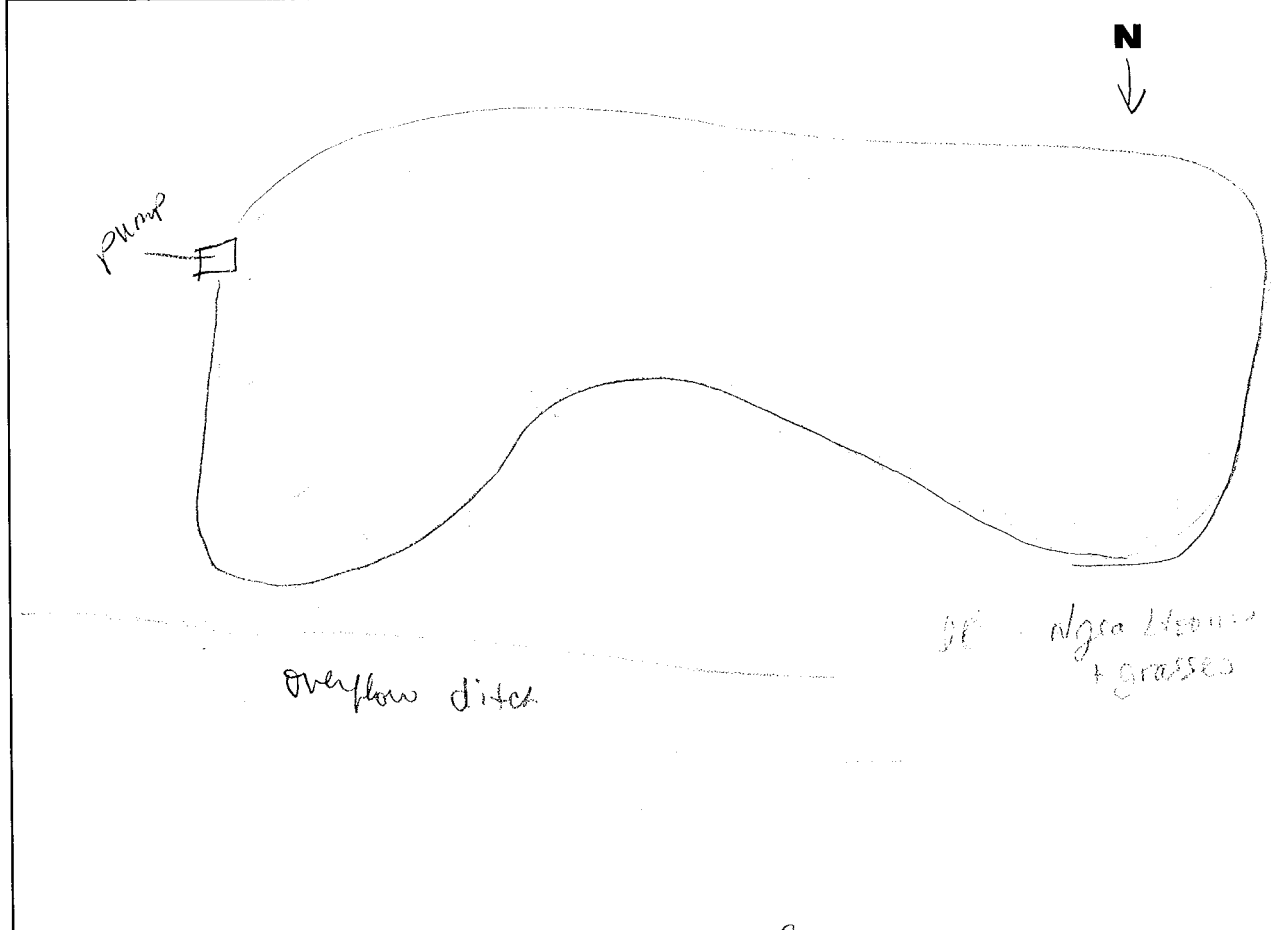

Initial QA/QC By: L. Bentley Date: May 30/2012 Technical QA/QC By: [Signature] Date: Jun 11/12

Water Bodies (Pond) Assessment Field Collection Form

AECOM

General Information

Study Area: Jericho Goshen Bluewater Land Parcel# JER 3598 Site ID: ~~P4.45~~ P4.45

Date: Sept 28/12 Start time: 10:00 End Time: 10:30

Weather Conditions: Cloudy, 9°C Field Crew: C. Boros, R. Dyer-Coward Field Notes By: C. Boros

Site Location

Northville Rd, south of Cedar Point Ln.

UTM Co-ordinates

Easting: 428319 Northing: 4774166 Description:

Easting: Northing: Description:

Surrounding Landuse

- Residential
- Agriculture
- Forest
- Other
- Meadow
- Wetland
- Livestock

Description: corn fields, barn + house

Type of Pond

- Natural
- Permanent
- Dugout Pond
- Vernal Pools
- Dammed
- Seasonal
- Used for Farming

Description: most likely used for farming

In-Situ Water Quality

WT (°C): 12.23 AT (°C):  
 pH: 7.34 Cond (µs/cm): 317  
 D.O. (mg/L) 6.06  
 Water Clarity: Clear  Turbid

Water Colour: greenish/black

Ground Water and Seepage Indicators

- Watercress
- Iron Staining
- Bubbling
- Bank Seepage
- None

Details:

Wildlife Observations

Observations of Fish and Wildlife

frogs observed

In-Situ Habitat

Substrate (<=>)  
 Bo - Boulder  
 Co - Cobble  
 Gr - Gravel  
 Sa - Sand  
 Si - Silt  
 Cl - Clay  
 MK - Muck  
 DT - Detritus  
 Description: soft bottom

Physical Characteristics of Pond

Estimated Size: 50m x 15m Estimated Depth (m): n/a  
 Notes: not wadeable

In-Situ Cover (%)

None	Woody Debris	Boulders	Cobble	Aquatic Vegetation*	Structures	Other
				75		

Note: Low = 0 - 30%; Moderate = 30 - 75%; High = 75 - 100%

\*Aquatic Vegetation Species Present (algae, submergent, emergent etc.)

algae >> duckweed > emergent grasses

Description and Width of Riparian Vegetation

thin layer of algae covering entire pond just under water surface

Water Bodies (Pond) Assessment Field Collection Form

AECOM

Date: *Sept 28/12*

Land Parcel/Site ID: *JER 3598* ~~71521~~ Page 2 of 2

Online Pond  *(M)*

Provide Description *however adjacent to stream so may be connected in times of very high flow*

Offline Pond  *(N)*

Other General Comments Regarding the Study Area:

*Pipe inlet/outlet most likely used for pumping. Possibly connected to pond north west. low canopy cover*

		Photo log	
Picture #	Description	Picture #	Description
<i>1-2</i>	<i>overview</i>		
<i>3</i>	<i>duckweed</i>		
<i>4</i>	<i>riparian</i>		
<i>5</i>	<i>algae</i>		

Sketch of Pond

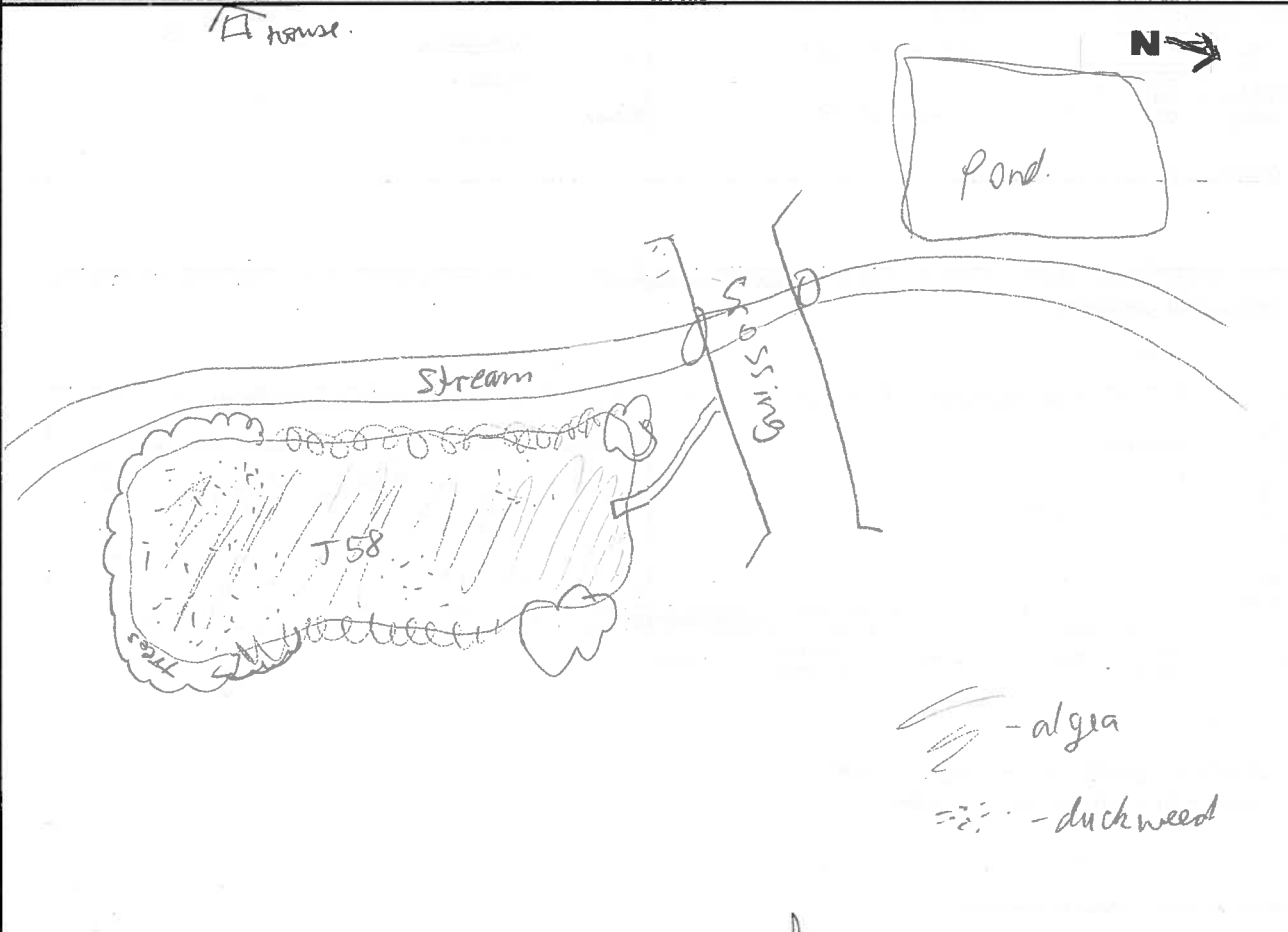

Initial QA/QC By: *JLm*

Date: *Oct 2/12*

Technical QA/QC By: *Slutkin*

Date: *Oct 2/12*



Water Bodies (Pond) Assessment Field Collection Form

AECOM

General Information

Study Area: Jericho Goshen Bluewater Land Parcel# JER3329 Site ID: P4.28

Date: June 12/12 Start time: 8:10 End Time: 8:10

Weather Conditions: Cloudy Field Crew: C. Barros, J. EPP  
Field Notes By: C. Barros

Site Location

Kennedy Rd., west of Northville

Roadside Survey

UTM Co-ordinates

Easting: 427987 Northing: 4782216 Description: P4.28

Easting: Northing: Description:

Surrounding Landuse

- Residential
- Agriculture
- Forest
- Other
- Meadow
- Wetland
- Livestock

Description: 3m of forest then wheat field

Type of Pond

- Natural
- Permanent
- Dugout Pond
- Vernal Pools
- Dammed
- Seasonal
- Used for Farming

Description: Could not tell

In-Situ Water Quality

WT (°C): / AT (°C): /  
pH: / Cond ( s/cm): /  
D.O. (mg/L) /

Water Clarity: Clear  Turbid

Water Colour: no access

Ground Water and Seepage Indicators

- Watercress
- Iron Staining
- Bubbling
- Bank Seepage
- None

Details: no access

Wildlife Observations

Observations of Fish and Wildlife

None

In-Situ Habitat

Substrate (< = >)

- Bo - Boulder
- Co - Cobble
- Gr - Gravel
- Sa - Sand
- Si - Silt
- Cl - Clay
- MK - Muck
- DT - Detritus

Description

No access

Physical Characteristics of Pond

Estimated Size: Estimated Depth (m):

Notes: Could not assess

In-Situ Cover (%)

None	Woody Debris	Boulders	Cobble	Aquatic Vegetation*	Structures	Other

Note: Low = 0 - 30% ; Moderate = 30 - 75% ; High = 75 - 100%

\*Aquatic Vegetation Species Present (algae, submergent, emergent etc.)

Description and Width of Riparian Vegetation

Water Bodies (Pond) Assessment Field Collection Form

AECOM

Date: June 12/12

Land Parcel/Site ID: JER 3329 PA. 28 Page 2 of 2

Online Pond Y /  N  
Offline Pond  Y N

Provide Description does not appear to be online

Other General Comments Regarding the Study Area:

Could not see the pond from road - forest buffer blocking view.

Photo log

Picture #	Description	Picture #	Description
1a 153	sheet overview from road		

Sketch of Pond

N

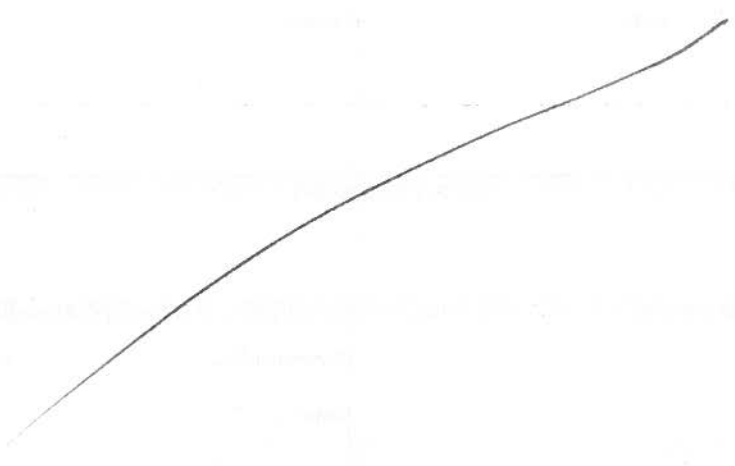

Initial QA/QC By: L Bentley

Date: June 26, 2012

Technical QA/QC By: Saitkin

Date: July 10/12

Water Bodies (Pond) Assessment Field Collection Form

<b>AECOM</b>							Page 1 of 2
<b>General Information</b>							
Study Area: Jericho		Goshen	Bluewater	Land Parcel#: JER 3348	Site ID: P4,29		
Date: May 23/12		Start time: 10:20		End Time: 10:35			
Weather Conditions: Sunny 15°C				Field Crew: C. Baros, J. Epp		Field Notes By: J. Epp	
<b>Site Location</b>							
South of Ravenswood, west of Jericho.							
<b>UTM Co-ordinates</b>							
Easting: 425283		Northing: 4780214		Description: P4.29 (site of Water Quality)			
Easting:		Northing:		Description:			
<b>Surrounding Landuse</b>				<b>Type of Pond</b>			
Residential <input type="checkbox"/>	Meadow <input type="checkbox"/>			Natural <input type="checkbox"/>	Dammed <input type="checkbox"/>		
Agriculture <input checked="" type="checkbox"/>	Wetland <input type="checkbox"/>			Permanent <input checked="" type="checkbox"/>	Seasonal <input type="checkbox"/>		
Forest <input checked="" type="checkbox"/>	Livestock <input type="checkbox"/>			Dugout Pond <input checked="" type="checkbox"/>	Used for Farming <input type="checkbox"/>		
Other <input type="checkbox"/>					Vernal Pools <input type="checkbox"/>		
Description: Mostly surround by forest. Roadside directly south and agricultural to the East with a few meter buffer (23m)				Description: Deep pond, steep incline from edge, rectangle in shape.			
<b>In-Situ Water Quality</b>				<b>Ground Water and Seepage Indicators</b>			
WT (°C): 21.26		AT (°C): 15		Watercress <input type="checkbox"/>		Bank Seepage <input type="checkbox"/>	
pH: 7.95		Cond ( s/cm): 250		Iron Staining <input type="checkbox"/>		None <input checked="" type="checkbox"/>	
D.O. (mg/L) 10.3		Water Clarity: Clear <input type="checkbox"/> Turbid <input checked="" type="checkbox"/>		Bubbling <input type="checkbox"/>			
Water Colour: brown				Details:			
<b>Wildlife Observations</b>							
Observations of Fish and Wildlife Minnow observed (~10), Green frog call heard. Cattfish observed (2)							
<b>In-Situ Habitat</b>				<b>Physical Characteristics of Pond</b>			
Substrate (<=>)		Description		Estimated Size:		Estimated Depth (m):	
Bo - Boulder			Si, cl	100m x 20m		couldn't see bottom of pond, too deep to walk out.	
Co - Cobble				Notes:			
Gr - Gravel							
Sa - Sand							
Si - Silt							
Cl - Clay							
MK - Muck							
DT - Detritus							
<b>In-Situ Cover (%) 40</b>							
None	Woody Debris	Boulders	Cobble	Aquatic Vegetation*	Structures	Other	
	5	1	1	35			
*Aquatic Vegetation Species Present (algae, submergent, emergent etc.) submergent vegetation, smartweed? niad?							
Description and Width of Riparian Vegetation Forest (hardwood) to south + west > 30m Softwood + hardwood trees + phragmites to the North 6m shrubs + willows to the west 3m east.							

Water Bodies (Pond) Assessment Field Collection Form

AECOM

Date: May 23/12

Land Parcel/Site ID: JER 3348

Page 2 of 2

Online Pond Y/N

Provide Description

No connection to watercourse (which is not present) or to roadside ditch

Offline Pond Y/N

Other General Comments Regarding the Study Area:

New-made pond, near roadside, surrounded mostly by forested area. Agricultural land immediately East of pond.

		Photo log	
Picture #	Description	Picture #	Description
1a	Overview looking South East		
1b			
2	Overview looking South		
3	Overview looking South West		

Sketch of Pond

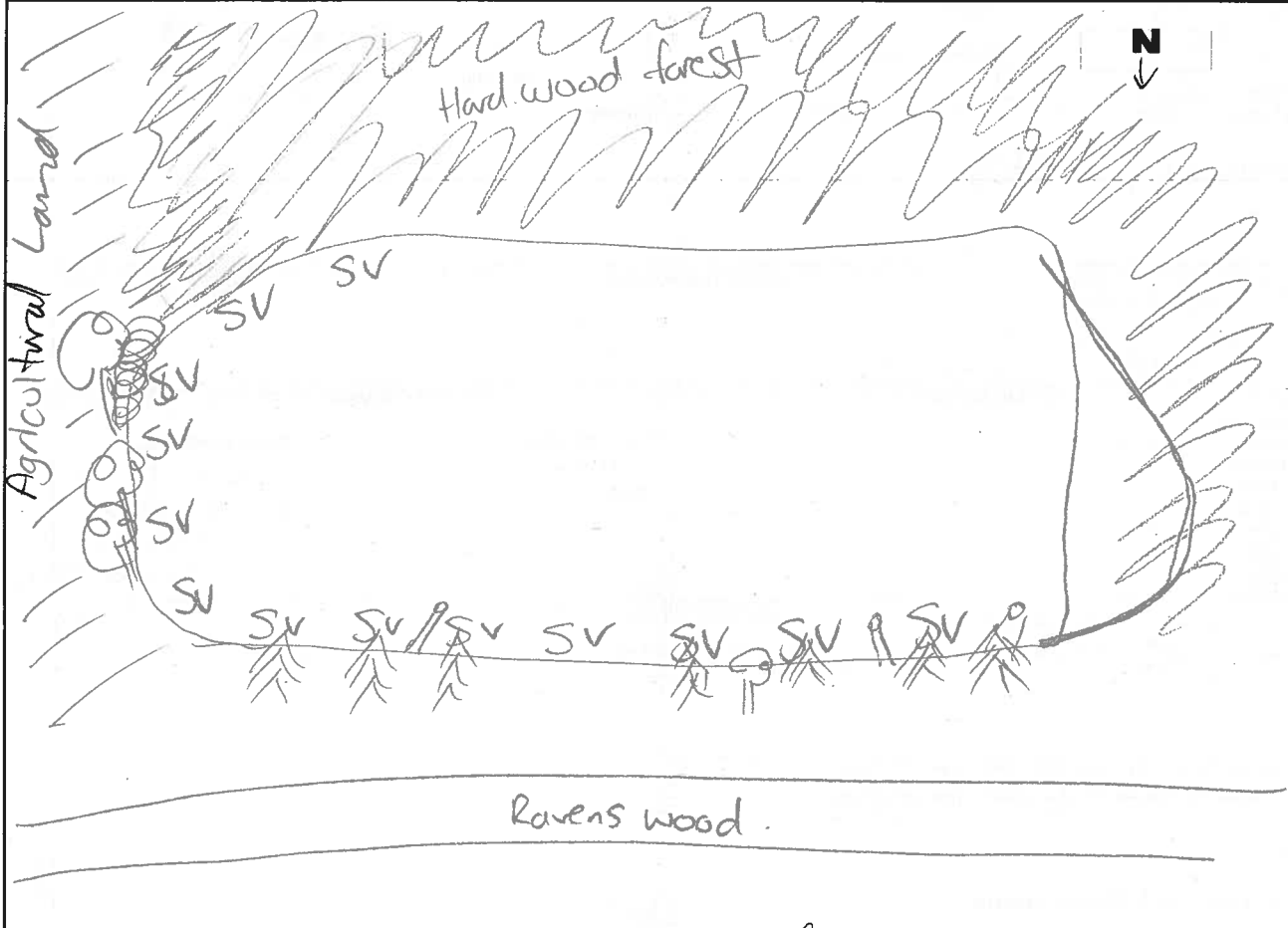

Initial QA/QC By: L Bentley

Date: May 30, 2012

Technical QA/QC By: [Signature]

Date: Jun 11/12

Water Bodies (Pond) Assessment Field Collection Form

AECOM

General Information

Study Area: Jericho Goshen Bluewater Land Parcel# JER 3484 Site ID: P 3484 P4.37  
 Date: May 22/12 Start time: 15:00 End Time: 15:30

Weather Conditions:

Cloudy, 12°C

Field Crew: C. Boros, J. EPP  
 Field Notes By: C. Boros

Site Location

East side of Northville Rd, north of Decker

UTM Co-ordinates

Easting: 428819 Northing: 4779530 Description: R4.8 JER 3484 pond

Easting: Northing: Description:

Surrounding Landuse

- Residential
- Agriculture
- Forest
- Other
- Meadow
- Wetland
- Livestock

Description: corn field

Type of Pond

- Natural
- Permanent
- Dugout Pond
- Vernal Pools
- Dammed
- Seasonal
- Used for Farming

Description: small dugout pond

In-Situ Water Quality

WT (°C): / AT (°C):  
 pH: / Cond ( s/cm):  
 D.O. (mg/L) /  
 Water Clarity: Clear  Turbid

Water Colour:

did not complete

Ground Water and Seepage Indicators

- Watercress
- Iron Staining
- Bubbling
- Bank Seepage
- None

Details:

Wildlife Observations

Observations of Fish and Wildlife

green frogs observed.

In-Situ Habitat

Substrate (<=>)

- Bo - Boulder
- Co - Cobble
- Gr - Gravel
- Sa - Sand
- Si - Silt
- Cl - Clay
- MK - Muck
- DT - Detritus

si = cl = sa

Physical Characteristics of Pond

Estimated Size: 7x7m Estimated Depth (m): 2/1.5m

Notes:

In-Situ Cover (%)

None	Woody Debris	Boulders	Cobble	Aquatic Vegetation*	Structures	Other
				40		

Note: Low = 0 - 30% ; Moderate = 30 - 75% ; High = 75 - 100%

\*Aquatic Vegetation Species Present (algae, submergent, emergent etc.)

algae > emergent veg.

Description and Width of Riparian Vegetation

~2m - meadow veg

Water Bodies (Pond) Assessment Field Collection Form

AECOM

Date: May 22/12

Land Parcel/Site ID: P4.37-  
SER 3484

Page 2 of 2

Online Pond  Y  N

Provide Description *not online*

Offline Pond  Y  N

Other General Comments Regarding the Study Area:

*small pond - likely rain fed. Good frog habitat*

Picture #		Photo log	
Picture #	Description	Picture #	Description
1	<i>overview (img 3771)</i>		

Sketch of Pond

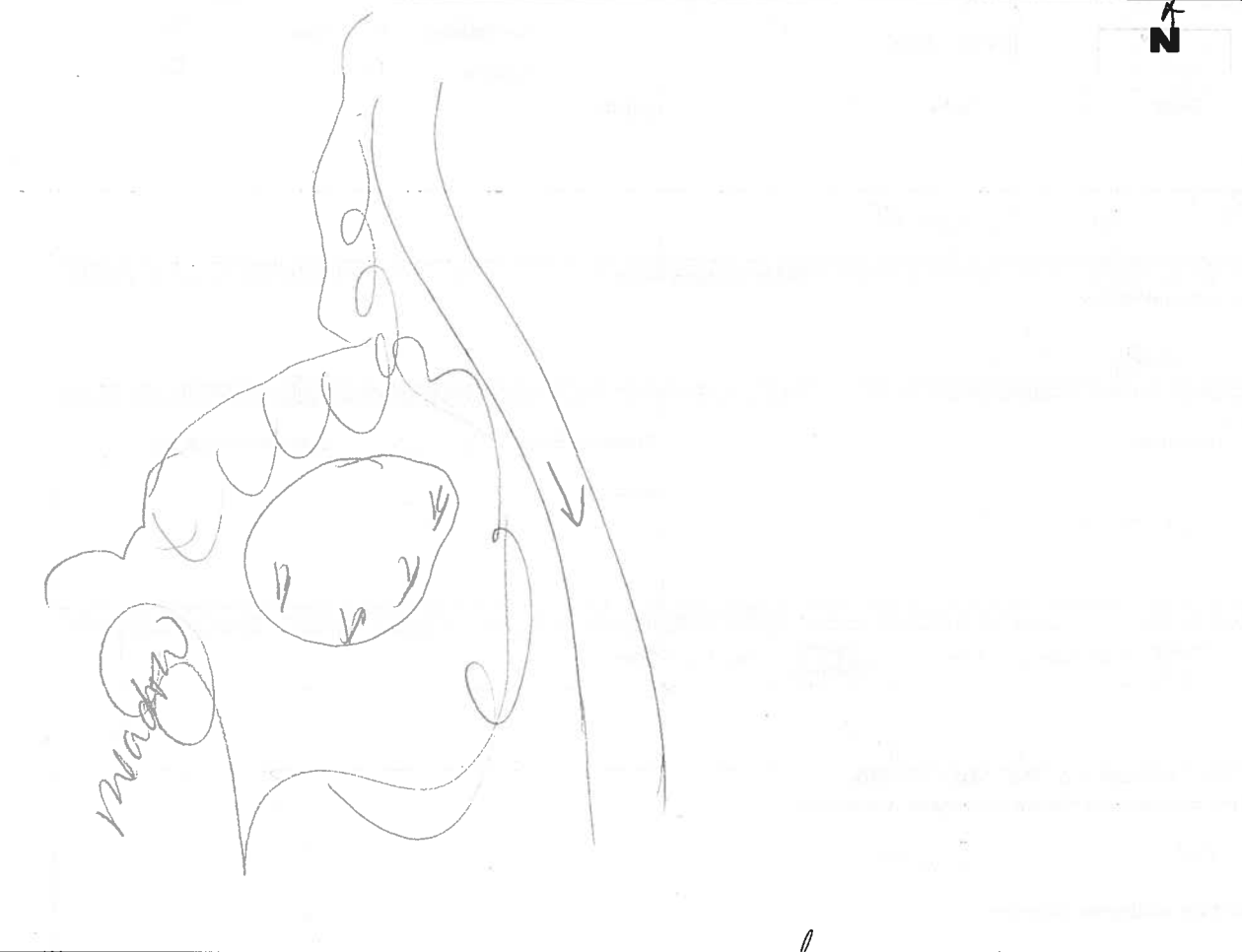

Initial QA/QC By: *C. Bentley*

Date: *Oct. 25/12*

Technical QA/QC By: *[Signature]*

Date: *Jan 11/12*

Water Bodies (Pond) Assessment Field Collection Form

P4B P4.40  
New Pond

<b>AECOM</b>		Page 1 of 2				
<b>General Information</b>						
Study Area: <u>Jericho</u>	<u>Goshen</u>	<u>Bluewater</u>	Land Parcel# <u>3382</u> Site ID: <u><del>R4B</del> P4.40</u>			
Date: <u>max 29/12</u>	Start time: <u>8:00</u>	End Time: <u>11:10</u>				
Weather Conditions: <u>covered</u> <u>24°C</u>		Field Crew: <u>S DAMICHE-STANDING</u> Field Notes By: <u>S DAMICHE</u>				
<b>Site Location</b>						
<u>North of Ridger Rd and east of Jerico Rd</u> <u>W/S of P4C</u>						
<small>UTM Co-Ordinates (continue on page 2 if necessary)</small>						
Easting: <u>426263</u>	Northing: <u>4776944</u>	Description: <u>R4B</u>				
Easting:	Northing:	Description:				
<b>Surrounding Landuse</b>		<b>Type of Pond</b>				
Residential <input type="checkbox"/>	Meadow <input type="checkbox"/>	Natural <input checked="" type="checkbox"/>	Dammed <input type="checkbox"/>			
Agriculture <input type="checkbox"/>	Wetland <input type="checkbox"/>	Permanent <input type="checkbox"/>	Seasonal <input type="checkbox"/>			
Forest <input checked="" type="checkbox"/>	Livestock <input type="checkbox"/>	Dugout Pond <input type="checkbox"/>	Used for Farming <input type="checkbox"/>			
Other <input type="checkbox"/>		Vernal Pools <input type="checkbox"/>				
Description: <u>Adjacent to Road</u>		Description: <u>natural pond + wetland</u>				
<b>In-Situ Water Quality</b>		<b>Ground Water and Seepage Indicators</b>				
WT (°C): <u>24.8</u>	AT (°C): <u>24.1</u>	Watercress <input type="checkbox"/>	Bank Seepage <input type="checkbox"/>			
pH: <u>7.09</u>	Cond ( s/cm): <u>333</u>	Iron Staining <input type="checkbox"/>	None <input checked="" type="checkbox"/>			
D.O. (mg/L) <u>6.54</u>		Bubbling <input type="checkbox"/>	<input type="checkbox"/>			
Water Clarity: <u>Clear</u> <input checked="" type="checkbox"/>	Turbid <input type="checkbox"/>	Other <input type="checkbox"/>				
Water Colour: <u>None</u>		Details: <u>none</u>				
<b>Wildlife Observations</b>						
Observations of Fish and Wildlife <u>Only Birds</u>						
<b>In-Situ Habitat</b>		<b>Physical Characteristics of Pond</b>				
Substrate (<=>) Bo - Boulder      Description Co - Cobble Gr - Gravel Sa - Sand Si - Silt Cl - Clay MK - Muck DT - Detritus <u>Si</u>		Estimated Size: <u>20x60 m</u>	Estimated Depth (m): <u>0.50</u>			
		Notes:				
<b>In-Situ Cover (%)</b>						
None	Woody Debris	Boulders	Cobble	Aquatic Vegetation*	Structures	Other
				<u>20</u>		
Note: Low = 0 - 30% ; Moderate = 30 - 75% ; High = 75 - 100%						
*Aquatic Vegetation Species Present (algae, submergent, emergent etc.)						
<u>Juncus sp.      canux sp.      Stone wort,      Musk grass</u>						
Description and Width of Riparian Vegetation <u>canux sp.      salix shrub, ash, grasses</u> <u>20m</u>						

Water Bodies (Pond) Assessment Field Collection Form

AECOM

Date:

MAY 29/12

Land Parcel/Site ID:

JER 3382 / P4B

Page 2 of 2

Other General Comments Regarding the Study Area:

- pond low depth
- clear water
- open water in centre
- connect with R4B

\* ADD TO the MAP (UPDATING) ← \*

Picture #	Description	Picture #	Description
1025	pond		
1026	pond west		
1027	pond east		

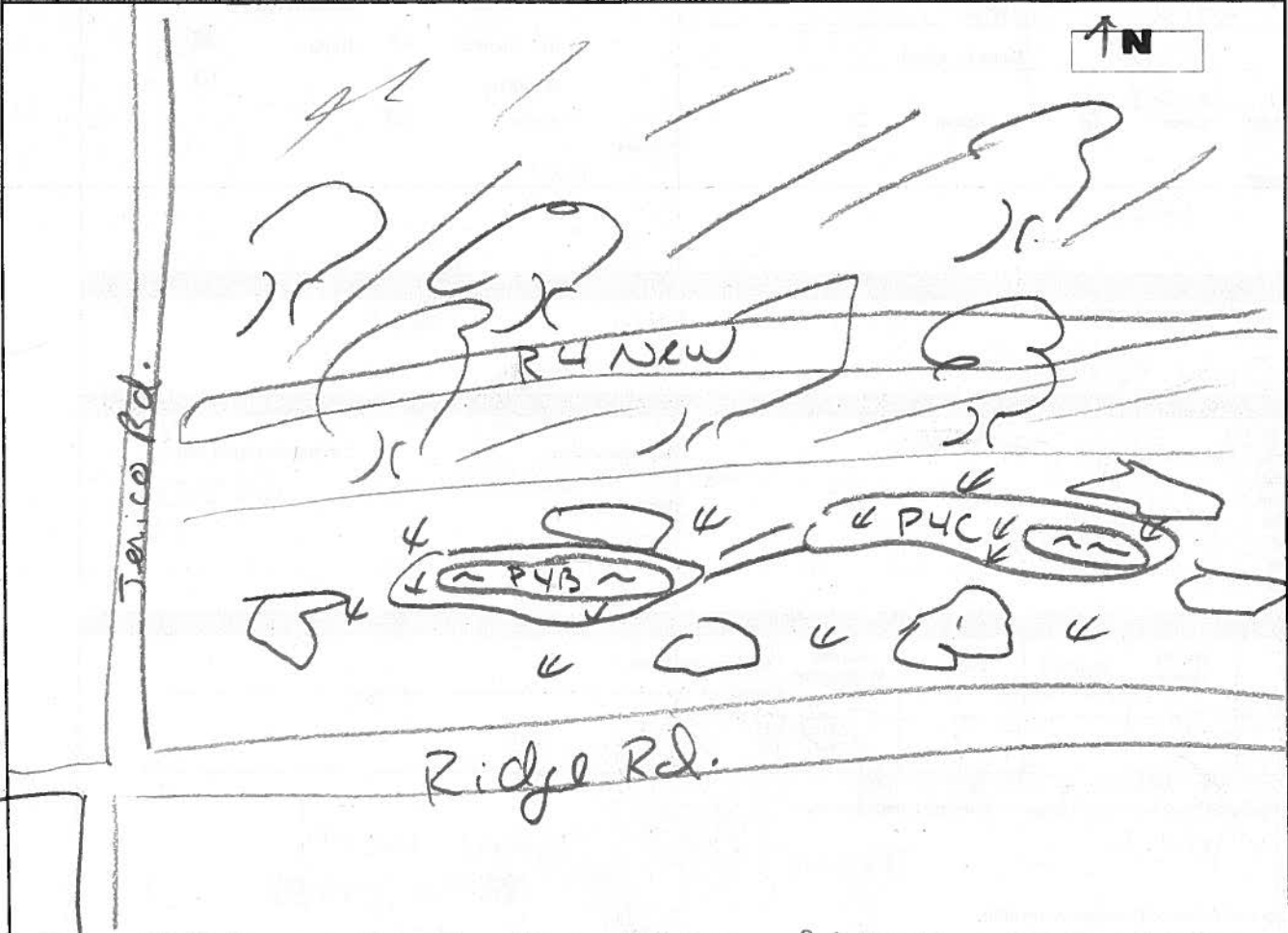

Initial QA/QC By:

L. Bentley

Date:

June 6, 2012

Technical QA/QC By:

Shutter

Date:

Oct 2/12



**Water Bodies (Pond) Assessment Field Collection Form**

<b>AECOM</b>						
<b>General Information</b>						
Study Area: <u>Jericho</u> Goshen Bluewater Land Parcel# <u>JER 3624</u> Site ID: <u>P4.36</u>	Date: <u>May 23/12</u> Start time: <u>13:50</u> End Time: <u>13:59</u>					
Weather Conditions: <u>Sunny, 25°C</u>	Field Crew: <u>C. Boros, J. Epp</u> Field Notes By: <u>C. Boros</u>					
<b>Site Location</b>						
<u>Arkonee Rd, South of Cedar Point ca</u>						
<b>UTM Co-ordinates (continue on page 3 if necessary)</b>						
Easting: <u>432016</u> Northing: <u>4773834</u> Description: <u>P4.36 → from 3623</u>						
<b>Surrounding Landuse</b>						
Residential <input type="checkbox"/> Meadow <input type="checkbox"/> Agriculture <input checked="" type="checkbox"/> Wetland <input type="checkbox"/> Forest <input type="checkbox"/> Livestock <input type="checkbox"/> Other	<b>Type of Pond</b>					
Description: <u>planted corn field</u>	Natural <input type="checkbox"/> Dammed <input type="checkbox"/> Permanent <input checked="" type="checkbox"/> Seasonal <input type="checkbox"/> Dugout Pond <input checked="" type="checkbox"/> Used for Farming <input checked="" type="checkbox"/> Vernal Pools <input type="checkbox"/>					
Description: <u>looks like water holding pond.</u>						
<b>In-Situ Water Quality</b>						
WT (°C): <u>/</u> AT (°C): <u>/</u>	<b>Ground Water and Seepage Indicators</b>					
pH: <u>/</u> Cond ( s/cm): <u>/</u>	Watercress <input type="checkbox"/> Bank Seepage <input checked="" type="checkbox"/> Iron Staining <input type="checkbox"/> None <input type="checkbox"/> Bubbling <input type="checkbox"/> <input type="checkbox"/> Other <input type="checkbox"/>					
D.O. (mg/L) <u>/</u>	Details: <u>no access</u>					
Water Clarity: Clear <input type="checkbox"/> Turbid <input type="checkbox"/>						
Water Colour: <u>no access</u>						
<b>Wildlife Observations</b>						
Observations of Fish and Wildlife <u>/</u>						
<b>In-Situ Habitat</b>						
<b>Substrate (&lt;= &gt;)</b>	<b>Physical Characteristics of Pond</b>					
Bo - Boulder Description Co - Cobble Gr - Gravel Sa - Sand Si - Silt Cl - Clay MK - Muck DT - Detritus	Estimated Size: <u>30m x 15m</u> Estimated Depth (m): <u>n/a</u>					
<u>no access</u>	Notes: <u>no access - hard to assess</u>					
<b>In-Situ Cover (%)</b>						
None	Woody Debris	Boulders	Cobble	Aquatic Vegetation*	Structures	Other
<u>/</u>	<u>/</u>	<u>/</u>	<u>/</u>	<u>/</u>	<u>/</u>	<u>/</u>
Note: Low = 0 - 30% ; Moderate = 30 - 75% ; High = 75 - 100%						
*Aquatic Vegetation Species Present (algae, submergent, emergent etc.) <u>/</u>						
<b>Description and Width of Riparian Vegetation</b>						
<u>~1m - cattails</u>						

Water Bodies (Pond) Assessment Field Collection Form

AECOM Date: May 23/12 Land Parcel/Site ID: JER 3624 P4.30 Page 2 of 2

Online Pond  Y  N Provide Description no stream present  
 Offline Pond  Y  N

Other General Comments Regarding the Study Area:  
 Assessment completed from JER 3624  
 - cattails surrounding pond.

Picture #		Description		Photo log	
Picture #	Description	Picture #	Description	Picture #	Description
1a	Sheet				
1b	Overview				
2	close up				

Sketch of Pond

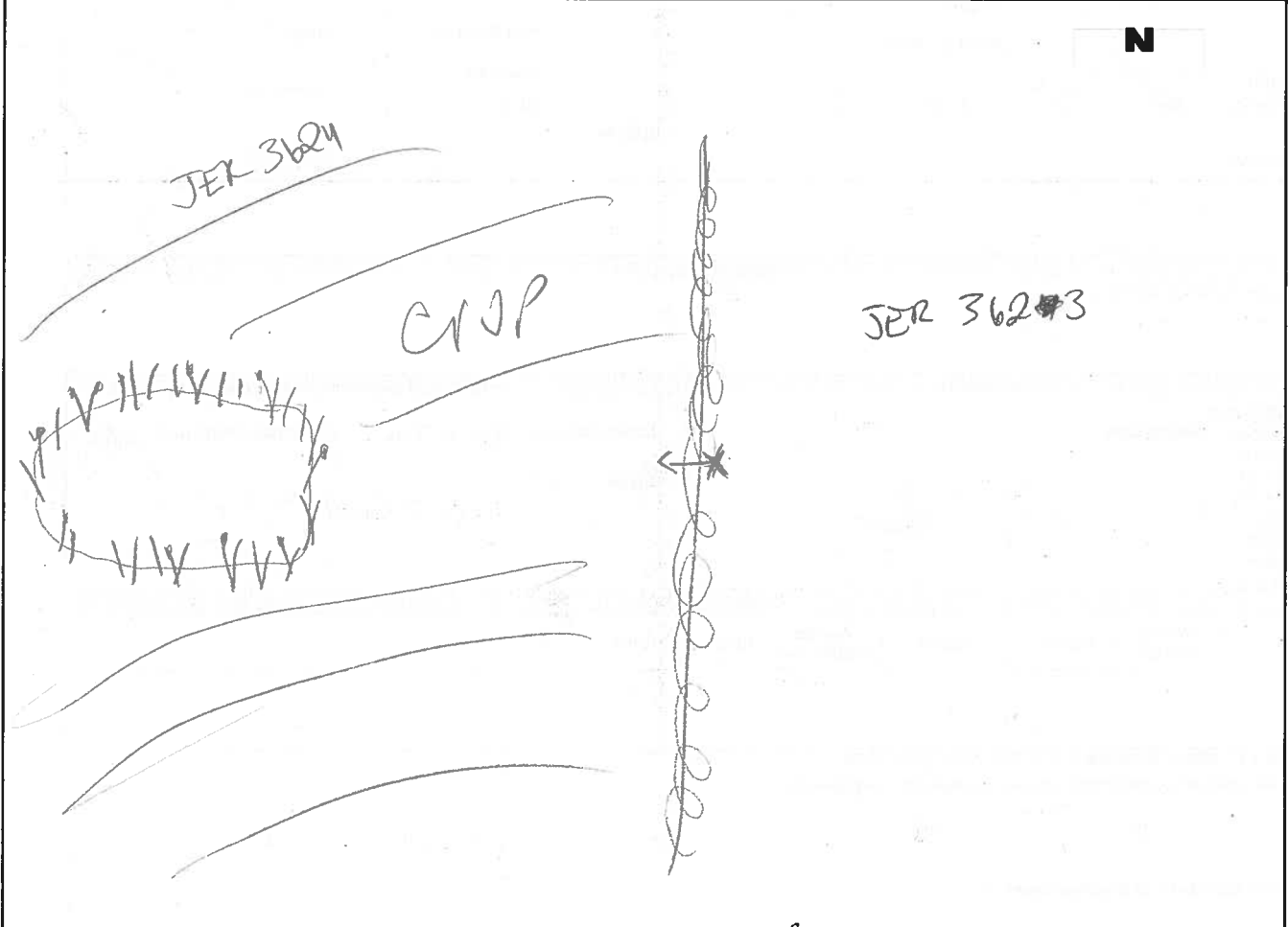

Initial QA/QC By: L. Bentley Date: May 30 2012 Technical QA/QC By: [Signature] Date: June 11/12

Water Bodies (Pond) Assessment Field Collection Form

P4.30

<b>AECOM</b>		Page 1 of 2				
<b>General Information</b>						
Study Area: <u>Jericho</u>	<u>Goshen</u>	<u>Bluewater</u>	Land Parcel# <u>JBR 1008</u> Site ID: <u>P1008</u>			
Date: <u>May 24/12</u>	Start time: <u>14:00</u>	End Time: <u>14:20</u>				
Weather Conditions: <u>Sunny, 25°C</u>		Field Crew: <u>C. Barros, J. EPP</u>				
		Field Notes By: <u>C. Barros</u>				
<b>Site Location</b>						
<u>South of Ravenswood, West Jericho Rd.</u>						
<b>UTM Co-ordinates</b>						
Easting: <u>425298</u>	Northing: <u>4779717</u>	Description: <u>P1008</u>				
Easting:	Northing:	Description:				
<b>Surrounding Landuse</b>		<b>Type of Pond</b>				
Residential: <input type="checkbox"/>	Meadow: <input type="checkbox"/>	Natural: <input type="checkbox"/>	Dammed: <input type="checkbox"/>			
Agriculture: <input type="checkbox"/>	Wetland: <input type="checkbox"/>	Permanent: <input checked="" type="checkbox"/>	Seasonal: <input type="checkbox"/>			
Forest: <input checked="" type="checkbox"/>	Livestock: <input type="checkbox"/>	Dugout Pond: <input checked="" type="checkbox"/>	Used for Farming: <input type="checkbox"/>			
Other: <input type="checkbox"/>		Vernal Pools: <input type="checkbox"/>				
Description:		Description:				
<b>In-Situ Water Quality</b>		<b>Ground Water and Seepage Indicators</b>				
WT (°C): <u>26.63</u>	AT (°C): <u>25°C</u>	Watercress: <input type="checkbox"/>	Bank Seepage: <input type="checkbox"/>			
pH: <u>8.196</u>	Cond (µs/cm): <u>1223</u>	Iron Staining: <input type="checkbox"/>	None: <input checked="" type="checkbox"/>			
D.O. (mg/L): <u>2.81</u>	Turbid: <input checked="" type="checkbox"/>	Bubbling: <input type="checkbox"/>				
Water Clarity: <u>Clear</u> <input checked="" type="checkbox"/>		Details:				
Water Colour: <u>brown</u>						
<b>Wildlife Observations</b>						
Observations of Fish and Wildlife: <u>Duck - wood possibly in duckling</u>						
<b>In-Situ Habitat</b>		<b>Physical Characteristics of Pond</b>				
Substrate (<=>):	Description:	Estimated Size: <u>70 x 70m</u>	Estimated Depth (m): <u>n/a</u>			
Bo - Boulder	/	Notes: <u>not wadeable</u>				
Co - Cobble						
Gr - Gravel						
Sa - Sand						
Si - Silt						
Cl - Clay						
MK - Muck						
DT - Detritus						
<b>In-Situ Cover (%)</b>						
None	Woody Debris	Boulders	Cobble	Aquatic Vegetation*	Structures	Other
Note: Low = 0 - 30%; Moderate = 30 - 75%; High = 75 - 100%						
*Aquatic Vegetation Species Present (algae, submergent, emergent etc.)						
Description and Width of Riparian Vegetation						

Water Bodies (Pond) Assessment Field Collection Form

P4.30

AECOM

Date: May 24/12

Land Parcel/Site ID: JER 1008 pond Page 2 of 2

Online Pond  Y /  N

Provide Description: no stream present in area

Offline Pond  Y /  N

Other General Comments Regarding the Study Area:

Pond surrounded by phragmites

Photo log	
Picture #	Description
1-3	overview

Sketch of Pond

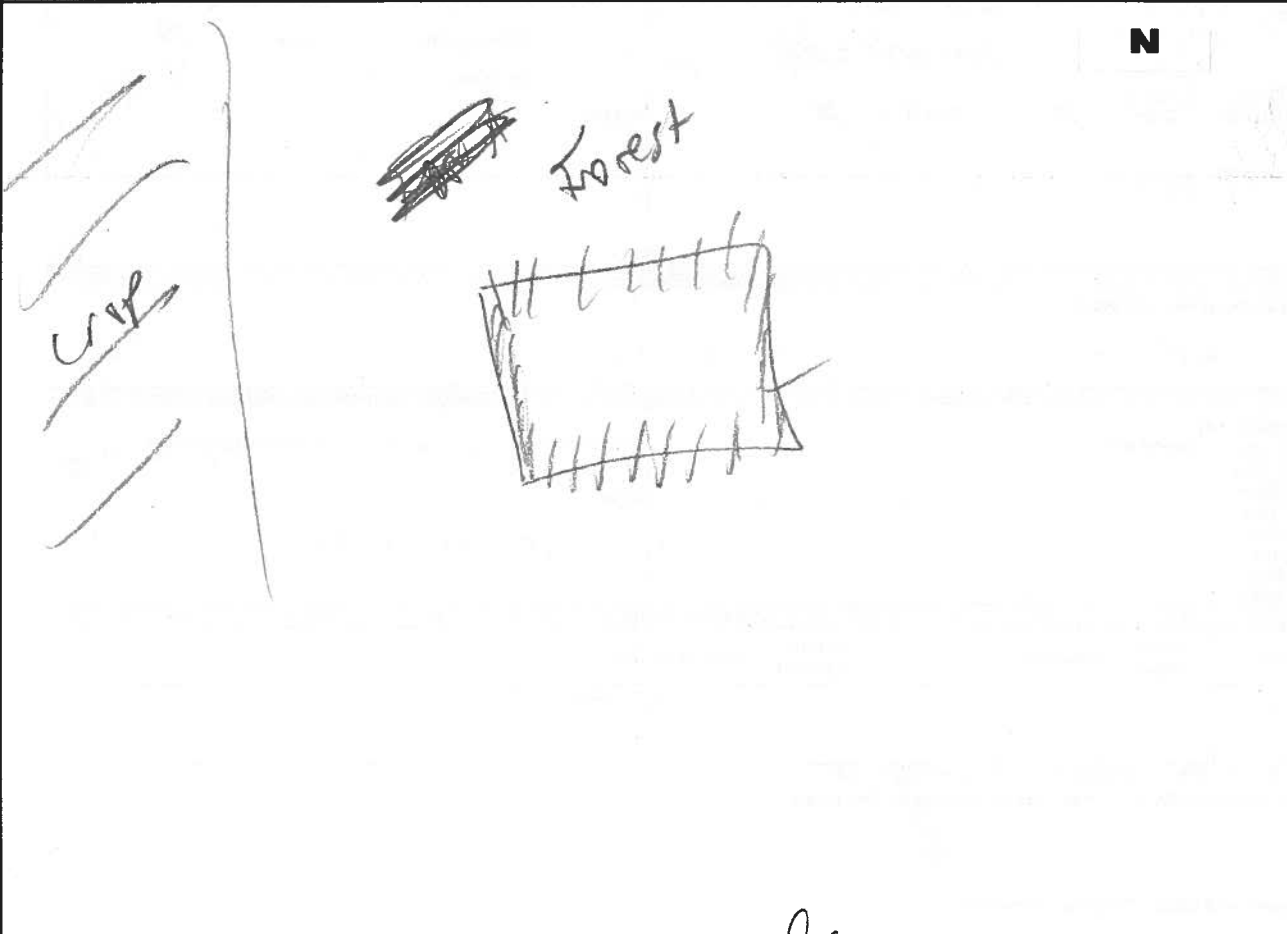

Initial QA/QC By: *L. Bernhey*

Date: May 30, 2012

Technical QA/QC By: *J. [Signature]*

Date: Oct 2/12

P448

# Significant Wildlife Habitat Form

A7COM

Study Area: BLW  JER GSH Map #: JER3301 (2)  
 Date: July 25, 2012 Time Started: 9:15 am  
 Field Staff: SP, SS Time Finished: 9:30 am  
 Weather Conditions: W=2, T=23°C, cloud=0

**Colonial Nesting Tree/Shrub Birds, Osprey Breeding/Feeding, Bald Eagle Breeding/Nesting Habitat**  
 (FET1, FOC, FOM, FOD, SWC, SWM, SWD)  
 Nest bowls present:  No  Yes (if yes, photograph and complete the following)  
 UTMs: \_\_\_\_\_ Number of nests: \_\_\_\_\_  
 Description of nests (location, e.g. in tree/on built structure; material; evidence of recent use; birds present): \_\_\_\_\_  
 Description of habitat (note riparian areas if present, evidence of disturbance): \_\_\_\_\_

**Waterfowls Stopover/Nesting, Amphibian Breeding, Turtle Nesting/Over-wintering, Marsh Breeding Birds**  
 (CUM1, CUT1, MAM, MAS, SAS1, SAM1, SAF1, SWD, SWT1, SWT2) (FOC, FOM, FOD, SWC, SWM, SWD, BOO1, FE01)  
 Standing water present:  No  Yes (if yes, photograph and complete the following)  
 UTMs: 0428255/4779923 Area of standing water delineated on field map \_\_\_\_\_  
 Water depth (m): 2.2m % open water: 90 % emergent vegetation: 10  
 Potential to hold water until at least July in most years:  Yes /  No  
 Description of standing water (permanent pool, evidence of annual spring flooding, etc): permanent pool / pond (man-made)  
 Area and soil/substrate of shoreline habitat: large crushed rock  
 Type and abundance of cover in open water habitat: 10% cover of TYP CATL in open water  
 Type and abundance of cover in surrounding habitat: 12% cover of planted trees in residential yard with mowed grass  
 Evidence of disturbance (e.g. cattle grazing): 0  
 Evidence of use by waterfowl, amphibians, turtles (e.g. broken eggs), marsh breeding birds: fish in pond  
 \*\*\*Complete Vernal Pool Habitat Description Form\*\*\*

**Snake Hibernacula**  
 Fissured rock/foundation or rock/debris pile present:  No  Yes (if yes, photograph and complete the following)  
 UTMs: 0428255/4779923 Likelihood to extend below frost line: unlikely  
 % canopy cover: 0% % slope: 15% Distance to open canopy (m): \_\_\_\_\_  
 Description of fissure or stone pile (composition/material, dimensions, etc): rock piled all around edge of pond, approx 2m up from water level, composed of large crushed rock  
 Description of surrounding habitat (type & abundance of cover, evidence of disturbance, etc): surrounding habitat is mowed grass and open water pond (man-made)

**Seeps and Springs** (FOC, FOM, FOD, SWC, SWM, SWD)  
 Evidence of seep or spring:  No  Yes (if yes, photograph and complete the following)  
 UTMs: \_\_\_\_\_ Description (indicator species, etc): \_\_\_\_\_



Water Bodies (Pond) Assessment Field Collection Form

24.44

**General Information**  
 Study Area: Jericho ~~Goshen~~ Bluewater Land Parcel# ~~3481~~ 3481 Site ID: P3481

Date: July 25/12 Start time: 11:15 End Time: 11:30

Weather Conditions: Sunny, 25°C  
 Field Crew: C. Barros, J. Epp  
 Field Notes By: C. Barros

**Site Location**  
 Northville and Ravenswood

**UTM Co-ordinates**  
 Easting: 428414 Northing: 4780234 Description: P3481 (wig + pond)

Easting: Northing: Description:

Surrounding Landuse		Type of Pond	
Residential <input type="checkbox"/>	Meadow <input type="checkbox"/>	Natural <input type="checkbox"/>	Dammed <input type="checkbox"/>
Agriculture <input checked="" type="checkbox"/>	Wetland <input type="checkbox"/>	Permanent <input type="checkbox"/>	Seasonal <input type="checkbox"/>
Forest <input type="checkbox"/>	Livestock <input type="checkbox"/>	Dugout Pond <input checked="" type="checkbox"/>	Used for Farming <input checked="" type="checkbox"/>
Other <input type="checkbox"/>		Vernal Pools <input type="checkbox"/>	

Description: soy bean  
 Description: water level low.

In-Situ Water Quality		Ground Water and Seepage Indicators	
WT (°C): 26.15	AT (°C): 25°C	Watercress <input type="checkbox"/>	Bank Seepage <input type="checkbox"/>
pH: 8.93	Cond (µs/cm): 292	Iron Staining <input type="checkbox"/>	None <input checked="" type="checkbox"/>
D.O. (mg/L): 6.60		Bubbling <input type="checkbox"/>	
Water Clarity: Clear <input checked="" type="checkbox"/>	Turbid <input type="checkbox"/>	Details:	
Water Colour: n/a			

**Wildlife Observations**  
 Observations of Fish and Wildlife  
 frogs observed jumping into water.

In-Situ Habitat	Physical Characteristics of Pond
<b>Substrate (&lt;=&gt;)</b> Bo - Boulder Co - Cobble Gr - Gravel Sa - Sand Si - Silt Cl - Clay MK - Muck DT - Detritus Description: c1 > si = sa	Estimated Size: 15 x 10 m Estimated Depth (m): ~1m <sup>water</sup> Notes: at vellow water level bank edge to bottom = 2.5-3m

**In-Situ Cover (%)**

None	Woody Debris	Boulders	Cobble	Aquatic Vegetation*	Structures	Other
				100		

Note: Low = 0 - 30% ; Moderate = 30 - 75% ; High = 75 - 100%  
 \*Aquatic Vegetation Species Present (algae, submergent, emergent etc.)

pondweed >> algae >> cattail

**Description and Width of Riparian Vegetation**  
 41m meadow before crop

Water Bodies (Pond) Assessment Field Collection Form

P4.44

AECOM

Date: July 25 / 12

Land Parcel/Site ID: ~~3481~~ 3481 Pond

Page 2 of 2

Online Pond  Y  N

Provide Description isolated

Offline Pond  Y  N

Other General Comments Regarding the Study Area:

digout pond in backyard of barns. Most likely used for farming activities

Photo log

Picture #	Description	Picture #	Description
1-3	overview		
4	pondweed + algae		

Sketch of Pond

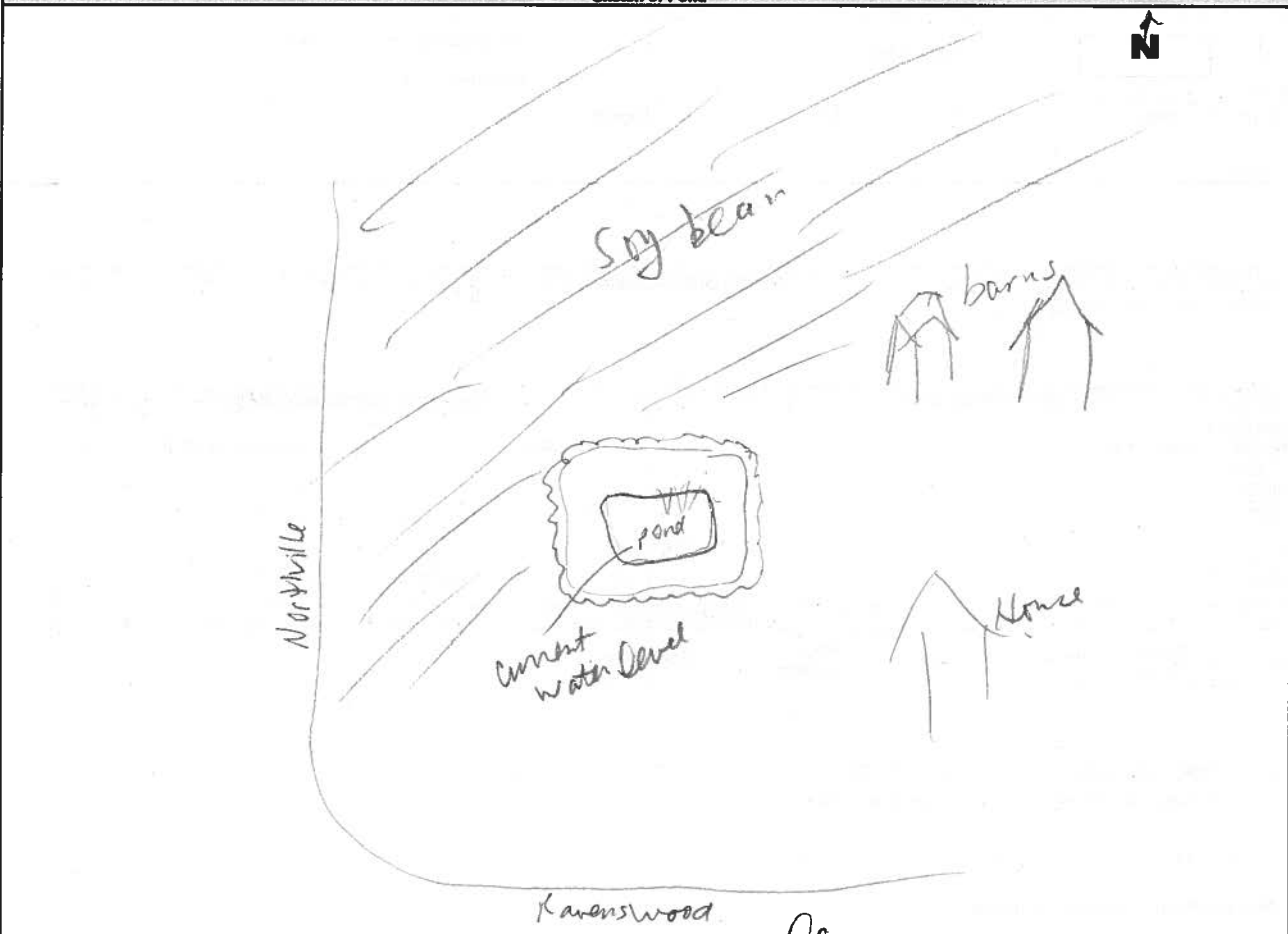

Initial QA/QC By: L. Bentley

Date: August 14, 2012

Technical QA/QC By: [Signature]

Date: Oct 2/12



Water Bodies (Pond) Assessment Field Collection Form

AECOM

General Information

Study Area: Jericho Goshen Bluewater Land Parcel# JER 3623 Site ID: P 3623 PL 39  
 Date: May 23 / 12 Start time: 13:30 End Time: 13:40

Weather Conditions: Sunny 25°C Field Crew: C. Boros, J. Epp  
 Field Notes By: C. Boros

Site Location

Arkona Rd. South of Cedar Point Ln

UTM Co-ordinates (continue on page 3 if necessary)

Easting: 431490 Northing: 4774057 Description: P3623

Easting: Northing: Description:

Surrounding Landuse

Residential  Meadow   
 Agriculture  Wetland   
 Forest  Livestock   
 Other

Type of Pond

Natural  Dammed   
 Permanent  Seasonal   
 Dugout Pond  Used for Farming   
 Vernal Pools

Description: ploughed crop field

Description: dugout

In-Situ Water Quality

WT (°C): 20.18 AT (°C): 25°C  
 pH: 6.59 Cond (µS/cm): 1481  
 D.O. (mg/L) 3.22  
 Water Clarity: Clear  Turbid   
 Water Colour: n/a

Ground Water and Seepage Indicators

Watercress  Bank Seepage   
 Iron Staining  None   
 Bubbling   
 Other

Details:

Wildlife Observations

Observations of Fish and Wildlife

Red winged blackbird

In-Situ Habitat

Substrate (<=>)  
 Bo - Boulder  
 Co - Cobble  
 Gr - Gravel  
 Sa - Sand  
 Si - Silt  
 Cl - Clay  
 MK - Muck  
 DT - Detritus  
 Description: Could not assess

Physical Characteristics of Pond

Estimated Size: 30m x 30m Estimated Depth (m):  
 Notes: too deep to wade in

In-Situ Cover (%)

None	Woody Debris	Boulders	Cobble	Aquatic Vegetation*	Structures	Other

Note: Low = 0 - 30% ; Moderate = 30 - 75% ; High = 75 - 100%

\*Aquatic Vegetation Species Present (algae, submergent, emergent etc.)

Could not assess - completely covered in duckweed

Description and Width of Riparian Vegetation

3m - grassy, shrubs

Water Bodies (Pond) Assessment Field Collection Form

AECOM Date: May 23 / 12 Land Parcel/Site ID: JER3623 Pond Page 2 of 2

Online Pond  Y /  N Provide Description in middle of crop field  
 Offline Pond  Y /  N

Other General Comments Regarding the Study Area:  
pond surface completely covered in duckweed

Picture #		Photo log	
Picture #	Description	Picture #	Description
<u>1a</u> <u>6-2</u>	<u>sheet</u> <u>overview</u>		
<u>3-4</u>	<u>pond</u>		
<u>5</u>	<u>duckweed</u>		

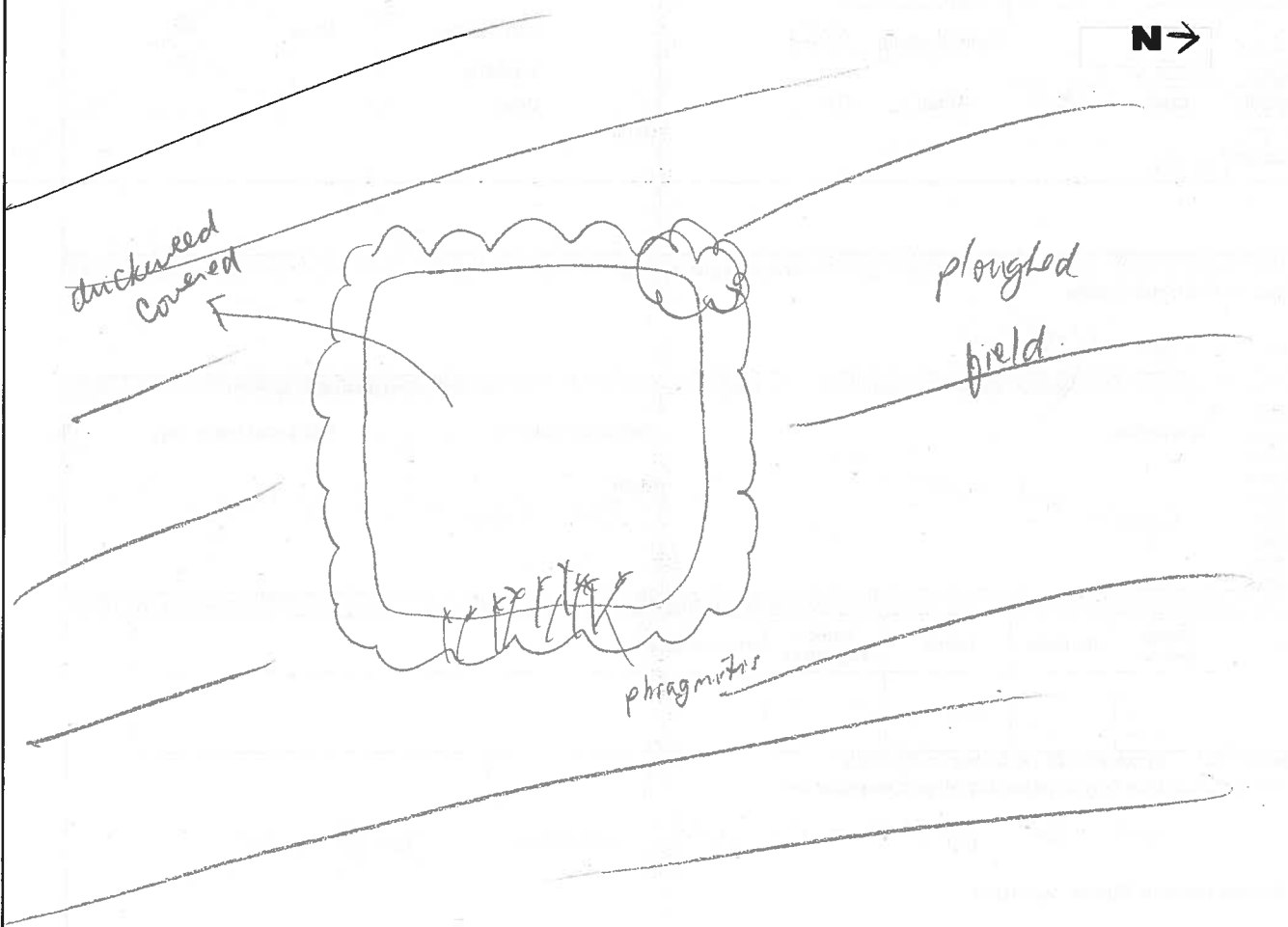

Sketch of Pond



Initial QA/QC By: L. Bentley Date: May 30, 2012 Technical QA/QC By: [Signature] Date: June 11/12

Water Bodies (Pond) Assessment Field Collection Form

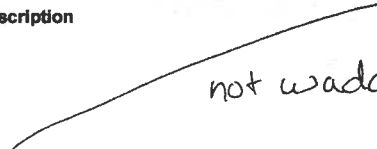
P4.43

<b>AECOM</b>		Page 1 of 2				
<b>General Information</b>						
Study Area: Jericho	Goshen	Bluewater	Land Parcel# JER 3598 Site ID: PJER 3598			
Date: June 12/12	Start time: 9:50	End Time: 10:00				
Weather Conditions: 27° overcast, cloudy		Field Crew: C. Boros, J. Epp Field Notes By: J. Epp				
<b>Site Location</b>						
On Northville, south of Cedar Point.						
<b>UTM Co-ordinates</b>						
Easting: 428261	Northing: 4774199	Description: PJER 3598				
Easting:	Northing:	Description:				
<b>Surrounding Landuse</b>		<b>Type of Pond</b>				
Residential <input checked="" type="checkbox"/>	Meadow <input type="checkbox"/>	Natural <input type="checkbox"/>	Dammed <input type="checkbox"/>			
Agriculture <input checked="" type="checkbox"/>	Wetland <input type="checkbox"/>	Permanent <input checked="" type="checkbox"/>	Seasonal <input type="checkbox"/>			
Forest <input type="checkbox"/>	Livestock <input type="checkbox"/>	Dugout Pond <input checked="" type="checkbox"/>	Used for Farming <input type="checkbox"/>			
Other <input type="checkbox"/>		Vernal Pools <input type="checkbox"/>				
Description: Residence and barns to the <del>west</del> <sup>west</sup> , Agricultural - corn fields to the south + East		Description: Steep banks, rectangle in shape				
<b>In-Situ Water Quality</b>		<b>Ground Water and Seepage Indicators</b>				
WT (°C): 22.8	AT (°C): 27	Watercress <input type="checkbox"/>	Bank Seepage <input type="checkbox"/>			
pH: 7.89	Cond (s/cm): 474	Iron Staining <input type="checkbox"/>	None <input checked="" type="checkbox"/>			
D.O. (mg/L): 5.51		Bubbling <input type="checkbox"/>	<input type="checkbox"/>			
Water Clarity: Clear <input type="checkbox"/>	Turbid <input checked="" type="checkbox"/>	Details: none observed.				
Water Colour: Brown						
<b>Wildlife Observations</b>						
Observations of Fish and Wildlife Heard green frogs.						
<b>In-Situ Habitat</b>		<b>Physical Characteristics of Pond</b>				
Substrate (<=>) Bo - Boulder Co - Cobble Gr - Gravel Sa - Sand Si - Silt Cl - Clay MK - Muck DT - Detritus Description:  not wadable.		Estimated Size: 20x10m Estimated Depth (m): 0.57m Notes:  at edge of water.				
<b>In-Situ Cover (%)</b>						
None	Woody Debris	Boulders	Cobble	Aquatic Vegetation*	Structures	Other
						could not see
Note: Low = 0 - 30%; Moderate = 30 - 75%; High = 75 - 100%						
*Aquatic Vegetation Species Present (algae, submergent, emergent etc.) Algae bloom around edge						
<b>Description and Width of Riparian Vegetation</b> 1.5m of grasses, shrubs.						

Water Bodies (Pond) Assessment Field Collection Form

04.43

AECOM Date: June 12/12 Land Parcel/Site ID: JER3598 Page 2 of 2 Pond

Online Pond Y/N Provide Description  
 Offline Pond Y/N See below

Other General Comments Regarding the Study Area:  
 Possible outlet pipe to regulate water level, may discharge into R4. Could not find the outlet though.

Photo log	
Picture #	Description
1a	sheet overview
1b-2	pipe in middle

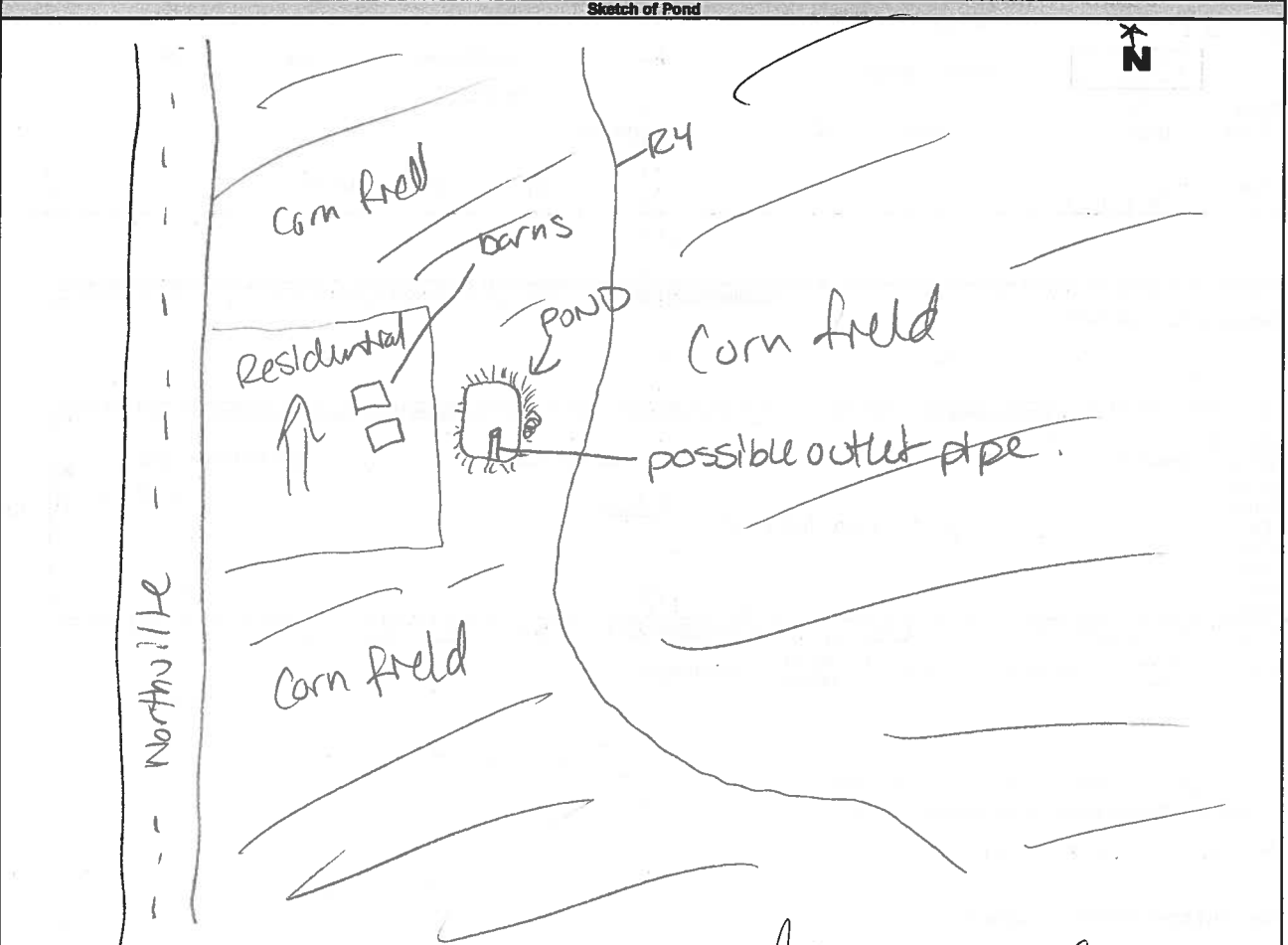

Initial QA/QC By: L Bentley Date: June 26 2012 Technical QA/QC By: [Signature] Date: July 16/12

04.49

# Significant Wildlife Habitat Form

AEGOM

Study Area: BLW (EF) GSH Map #: B-722 7762  
 Date: 25 July, 2012 Time Started: 2:00  
 Field Staff: SEP, JPV Time Finished: 2:20  
 Weather Conditions: 25% clouds, wind = 2-3 80 = 27°C

**Colonial Nesting Tree/Shrub Birds, Osprey Breeding/Feeding, Bald Eagle Breeding/Nesting Habitat**  
 (FET1, FOC, FOM, FOD, SWC, SWM, SWD)

Nest bowls present:  No  Yes (if yes, photograph and complete the following)

UTMs: \_\_\_\_\_ Number of nests: \_\_\_\_\_

Description of nests (location, e.g. in tree/on built structure; material; evidence of recent use; birds present): \_\_\_\_\_

Description of habitat (note riparian areas if present, evidence of disturbance): \_\_\_\_\_

**Waterfowl Stopover/Nesting, Amphibian Breeding, Turtle Nesting/Over-wintering, Marsh Breeding Birds**  
 (CUM1, CUT1, MAM, MAS, SAS1, SAM1, SAF1, SWD, SWT1, SWT2) (FOC, FOM, FOD, SWC, SWM, SWD, BOO1, FEO1)

Standing water present:  No  Yes (if yes, photograph and complete the following)

UTMs: 424091, 4776884  Area of standing water delineated on field map

Water depth (m): ? % open water: ? % emergent vegetation: ?

Description of standing water (permanent pool, evidence of annual spring flooding, etc):  
can't see pond - hedge row & Phragmites blocking view

Area and soil/substrate of shoreline habitat: ?

Type and abundance of cover in open water habitat: ?

Type and abundance of cover in surrounding habitat: ?

Evidence of disturbance (e.g. cattle grazing): ?

Evidence of use by waterfowl, amphibians, turtles (e.g. broken eggs), marsh breeding birds: \_\_\_\_\_

\*\*\*Complete Vernal Pool Habitat Description Form\*\*\*

**Snake Hibernacula**

Fissured rock/foundation or rock/debris pile present:  No  Yes (if yes, photograph and complete the following)

UTMs: \_\_\_\_\_ Likelihood to extend below frost line: \_\_\_\_\_

% canopy cover: \_\_\_\_\_ % slope: \_\_\_\_\_ Distance to open canopy (m): \_\_\_\_\_

Description of fissure or stone pile (composition/material, dimensions, etc): \_\_\_\_\_

Description of surrounding habitat (type & abundance of cover, evidence of disturbance, etc): \_\_\_\_\_

**Seeps and Springs** (FOC, FOM, FOD, SWC, SWM, SWD)

Evidence of seep or spring:  No  Yes (if yes, photograph and complete the following)

UTMs: \_\_\_\_\_ Description (indicator species, etc): \_\_\_\_\_



P 4.46

### Significant Wildlife Habitat Form

AECOM

Study Area:	BLW <u>JER</u> GSH	Map #:	176-JER 3384
Date:	May 17, 2012	Time Started:	12:15
Field Staff:	Michael Ewaschuk, Pat Deacon	Time Finished:	13:10
Weather Conditions: Sunny, clear, wind=2, air=13°C			

**Colonial Nesting Tree/Shrub Birds, Osprey Breeding/Feeding, Bald Eagle Breeding/Nesting Habitat**  
(FET1, FOC, FOM, FOD, SWC, SWM, SWD)

Nest bowls present:  No  Yes (if yes, photograph and complete the following)

UTMs: \_\_\_\_\_ Number of nests: \_\_\_\_\_

Description of nests (location, e.g. in tree/on built structure; material; evidence of recent use; birds present): \_\_\_\_\_

\_\_\_\_\_

Description of habitat (note riparian areas if present, evidence of disturbance): \_\_\_\_\_

**Waterfowls Stopover/Nesting, Amphibian Breeding, Turtle Nesting/Over-wintering, Marsh Breeding Birds**  
(CUM1, CUT1, MAM, MAS, SAS1, SAM1, SAF1, SWD, SWT1, SWT2) (FOC, FOM, FOD, SWC, SWM, SWD, BOO1, FEO1)

Standing water present:  Standing water to July (46)  No  Yes (if yes, photograph and complete the following)

UTMs: \_\_\_\_\_  Area of standing water delineated on field map

Water depth (m): 0.6 % open water: 100 % emergent vegetation: 0

Description of standing water (permanent pool, evidence of annual spring flooding, etc): -very recently-dug micro-pond 4m x 3m

Area and soil/substrate of shoreline habitat: gravelly sand

Type and abundance of cover in open water habitat: -no emergent vegetation

Type and abundance of cover in surrounding habitat: open thicket (mixed with red cedar)

Evidence of disturbance (e.g. cattle grazing): -adjacent horse path

Evidence of use by waterfowl, amphibians, turtles (e.g. broken eggs), marsh breeding birds: -amphibian observed

\*\*\*Complete Vernal Pool Habitat Description Form\*\*\*

**Snake Hibernacula**

Fissured rock/foundation or rock/debris pile present:  No  Yes (if yes, photograph and complete the following)

UTMs: \_\_\_\_\_ Likelihood to extend below frost line: \_\_\_\_\_

% canopy cover: \_\_\_\_\_ % slope: \_\_\_\_\_ Distance to open canopy (m): \_\_\_\_\_

Description of fissure or stone pile (composition/material, dimensions, etc): \_\_\_\_\_

Description of surrounding habitat (type & abundance of cover, evidence of disturbance, etc): \_\_\_\_\_

**Seeps and Springs** (FOC, FOM, FOD, SWC, SWM, SWD)

Evidence of seep or spring:  No  Yes (if yes, photograph and complete the following)

UTMs: \_\_\_\_\_ Description (indicator species, etc): \_\_\_\_\_





Water Bodies (Pond) Assessment Field Collection Form

PS.12

<b>AECOM</b>						
General Information						
Study Area: <u>Jericho</u>		Goshen	Bluewater	Land Parcel# <u>JER3139</u>	Site ID: <u>RS,1 (Pond) ASA</u>	
Date: <u>MAY 30/12</u>		Start time: <u>1145</u>		End Time: <u>1155</u>		
Weather Conditions: <u>Partially cloudy 25°C</u>				Field Crew: <u>C. HARDING S. DARACHE</u>		
				Field Notes By: <u>S. DARACHE</u>		
Site Location						
<u>South of Ravenswood Rd</u>						
Data Collection (continued, page 2 if necessary)						
Easting: _____		Northing: _____		Description: <u>None taken</u>		
Easting: _____		Northing: _____		Description: <u>See the map</u>		
Simultaneous Data						
Residential <input checked="" type="checkbox"/> Meadow <input type="checkbox"/> Agriculture <input type="checkbox"/> Wetland <input type="checkbox"/> Forest <input type="checkbox"/> Livestock <input type="checkbox"/> Other <input type="checkbox"/>			Natural <input type="checkbox"/> Dammed <input type="checkbox"/> Permanent <input type="checkbox"/> Seasonal <input type="checkbox"/> Dugout Pond <input checked="" type="checkbox"/> Used for Farming <input type="checkbox"/> Vernal Pools <input type="checkbox"/>			
Description: _____			Description: <u>Aesthetic pond</u>			
In Situ Water Quality						
WT (°C): _____		AT (°C): <u>25°C</u>		Watercress <input type="checkbox"/> Bank Seepage <input type="checkbox"/>		
pH: _____		Cond (s/cm): _____		Iron Staining <input type="checkbox"/> None <input checked="" type="checkbox"/>		
D.O. (mg/L) _____				Bubbling <input type="checkbox"/> _____ <input type="checkbox"/>		
Water Clarity: <u>Clear</u> <input type="checkbox"/>		<u>Turbid</u> <input type="checkbox"/>		Other <input type="checkbox"/>		
Water Colour: <u>None taken ASA</u>		Details: _____				
Observations of Fish and Wildlife						
<u>None observed</u>						
Physical Parameters						
Substrate (<=>)			Estimated Size:		Estimated Depth (m):	
Bo - Boulder Co - Cobble Gr - Gravel Sa - Sand Si - Silt Cl - Clay MK - Muck DT - Detritus			<u>25 x 25 m</u> Notes: _____		<u>None observed</u>	
Description: <u>BANK: CO</u> <u>Bottom not observed</u>						
In Situ Cover (%)						
None	Woody Debris	Boulders	Cobble	Aquatic Vegetation*	Structures	Other
<u>X</u>						
Note: Low = 0 - 30%; Moderate = 30 - 75%; High = 75 - 100% *Aquatic Vegetation Species Present (algae, submergent, emergent etc.) <u>NONE</u>						
Description and Width of Riparian Vegetation						
<u>One -&gt; mowed</u>						

Water Bodies (Pond) Assessment Field Collection Form

AECOM

Date: MAY 30 12

Land Parcel/Site ID: Jer 3139 / RS (Pond)

Page 2 of 2

Other General Comments Regarding the Study Area:

pond feature - aesthetic  
blue green water

Picture #	Description	Picture #	Description
1106	Pond Jer 3139		
1107	Pond Jer 3139		

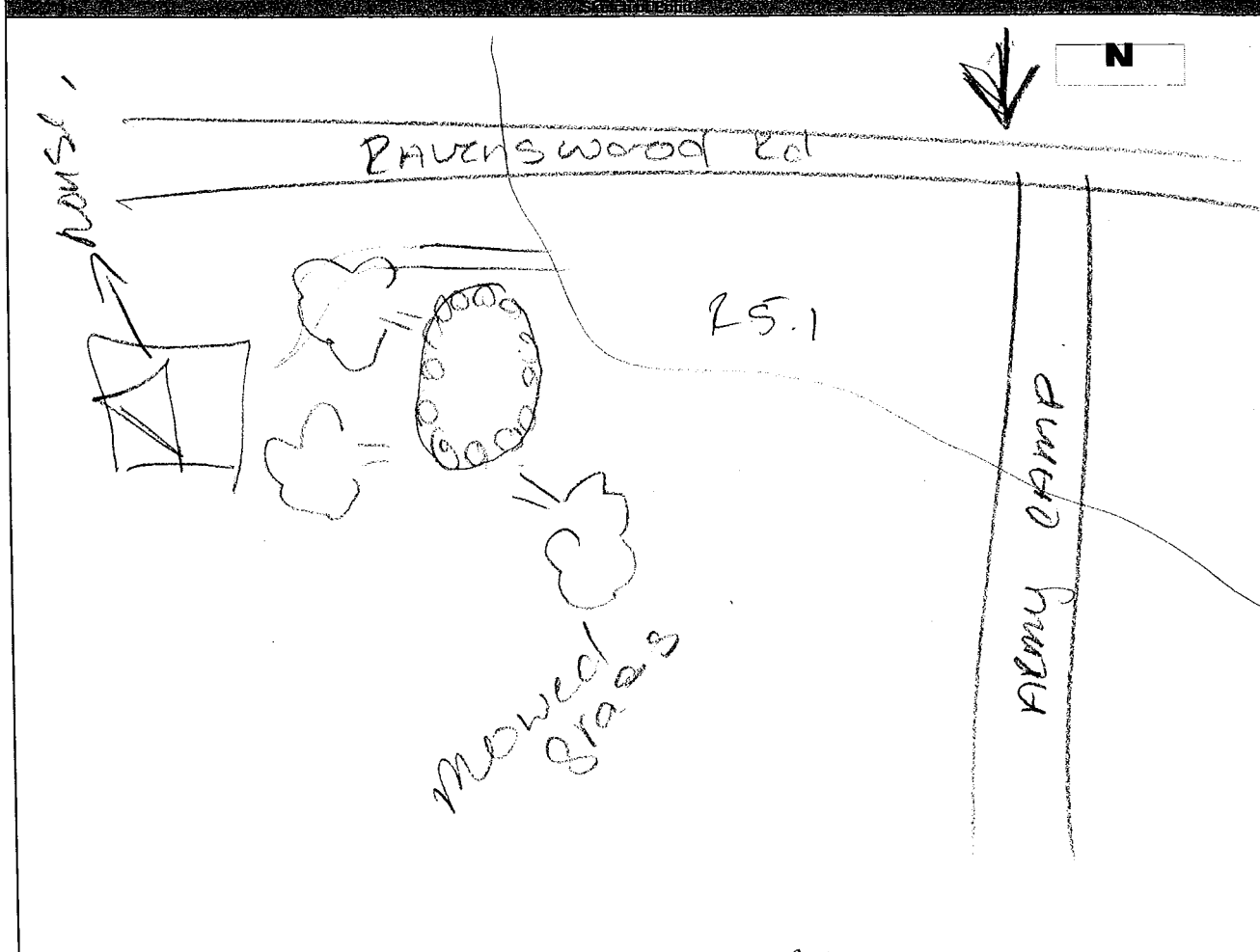

Initial QA/QC By: L. Bentley

Date: June 6 2012

Technical QA/QC By: J. Fletcher

Date: Sep 24/12

Water Bodies (Pond) Assessment Field Collection Form

AECOM

General Information

Study Area: Jericho Goshen Bluewater Land Parcel# 1037 Site ID: Pond 1037 a-Pl 6  
 Date: May 3/12 Start time: 10:35 End Time: 11:50  
 Weather Conditions: Cloudy, 20°C Field Crew: C. Baras, J. Harrold  
 Field Notes By: C. Baras

Site Location

Jericho Rd, north of Juras Rd.

UTM Co-ordinates (continue on page 2 if necessary)

Easting: 0452619 Northing: 4774185 Description: Pond 1037a  
 Easting: Northing: Description:

Surrounding Land Use

Type of Pond

Residential  Meadow   
 Agriculture  Wetland   
 Forest  Livestock   
 Other   
 Description: 3 sides forest, 1 side crop agri field

Natural  Dammed   
 Permanent  Seasonal   
 Dugout Pond  Used for Farming   
 Vernal Pools   
 Description:

In-Situ Water Quality

Ground Water and Seepage Indicators

WT (°C): 13.05 AT (°C): 20°C  
 pH: 7.25 Cond (µs/cm): 347  
 D.O. (mg/L) 9.51  
 Water Clarity: Clear  Turbid   
 Water Colour: n/a

Watercress  Bank Seepage   
 Iron Staining  None   
 Bubbling   
 Other   
 Details:

Wildlife Observations

Observations of Fish and Wildlife  
frogs calling

In-Situ Habitat

Physical Characteristics of Pond

Substrate (<=>)  
 Bo - Boulder Description  
 Co - Cobble  
 Gr - Gravel  
 Sa - Sand  
 Si - Silt  
 Cl - Clay  
 MK - Muck  
 DT - Detritus

Estimated Size: 30 x 35 m Estimated Depth (m):  
 Notes: too deep to wade

In-Situ Cover (%)

None	Woody Debris	Boulders	Cobble	Aquatic Vegetation*	Structures	Other

Note: Low = 0 - 30%; Moderate = 30 - 75%; High = 75 - 100%

\*Aquatic Vegetation Species Present (algae, submergent, emergent etc.)

Could not assess - no visibility

Description and Width of Riparian Vegetation

Immediately surround pond 1m of grasses + shrubs

Water Bodies (Pond) Assessment Field Collection Form

AECOM

Date: May 3/12

Land Parcel/Site ID: Pond JER 1037A

Page 2 of 2

Other General Comments Regarding the Study Area:

Pond completely covered in duckweed

Picture #	Description	Picture #	Description
2-3	sheet pond overview		
4	duckweed		

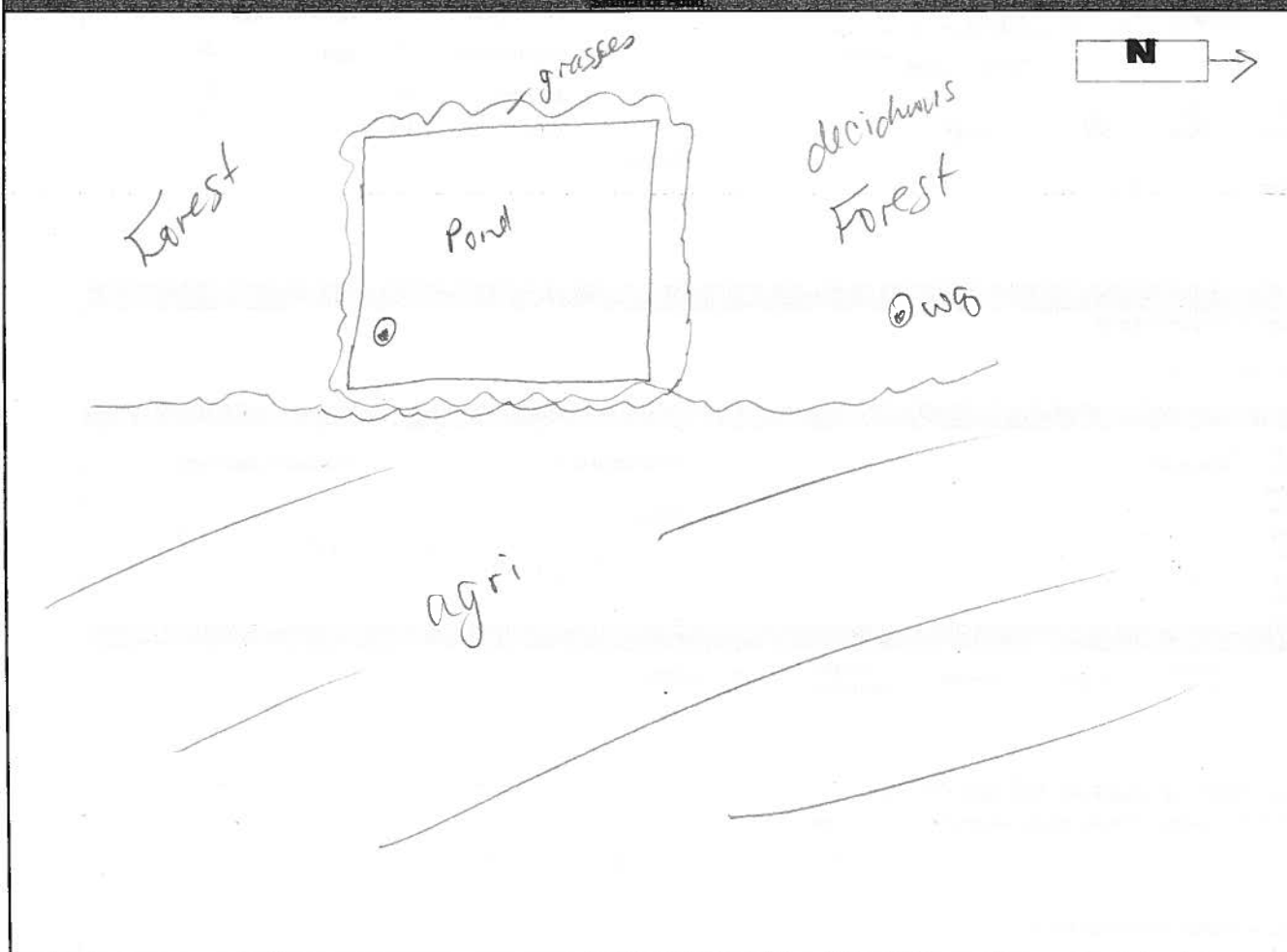

Initial QA/QC By: L. Bentley

Date: May 8, 2012

Technical QA/QC By: Santken

Date: May 18/2012

Water Bodies (Pond) Assessment Field Collection Form

AECOM

General Information

Study Area: Jericho Goshen Bluewater Land Parcel# JER 312 Site ID: P6.3  
 Date: MAY 31/12 Start time: 12:25 End Time: 15:05  
 Weather Conditions: cloudy 18°C Field Crew: SHARDING SDAVICH  
 Field Notes By: SDAVICH

Site Location

South of Thompson and on west of Kinkard RD.

UTM Co-Ordination (continue on page 2 if necessary)

Easting: 421981 Northing: 4778312 Description: (ST) R6B  
 Easting: 422076 Northing: 4778057 Description: R6C (END)

Surrounding Land Use

Residential  Meadow   
 Agriculture  Wetland   
 Forest  Livestock   
 Other   
 Description: crop and some livestock

Type of Pond

Natural  Dammed   
 Permanent  Seasonal   
 Dugout Pond  Used for Farming   
 Vernal Pools   
 Description: natural control under level

In-Situ Water Quality

WT (°C): 18.4 AT (°C): 18.2  
 pH: 7.93 Cond (s/cm): 514  
 D.O. (mg/L) 4.63  
 Water Clarity: Clear  Turbid   
 Water Colour: Green

Ground Water and Seepage Indicators

Watercress  Bank Seepage   
 Iron Staining  None   
 Bubbling   
 Other   
 Details:

Wildlife Observations

Observations of Fish and Wildlife  
Bird Nesting under Bridge

In-Situ Habitat

Substrate (<=>) Description  
 Bo - Boulder  
 Co - Cobble  
 Gr - Gravel  
 Sa - Sand  
 Si - Silt  
 Cl - Clay  
 MK - Muck  
 DT - Detritus  
S: >> Co = Bo (shore)

Physical Characteristics of Pond

Estimated Size: width: 20m  
 Estimated Depth (m): > 1m  
 Notes: -

In-Situ Cover (%)

None	Woody Debris	Boulders	Cobble	Aquatic Vegetation*	Structures	Other
		<u>5</u>				

Note: Low = 0 - 30%; Moderate = 30 - 75%; High = 75 - 100%

\*Aquatic Vegetation Species Present (algae, submergent, emergent etc.)

Algae, Large Fruit Burreed, northern Blue Flies, Arrow Head, Potamo sp., algae

Description and Width of Riparian Vegetation

Grasses, Salix shrubs, deciduous trees. (Salix, ASH) Canada Anemone

Water Bodies (Pond) Assessment Field Collection Form

AECOM

Date:

May 31/12

Land Parcel/Site ID:

P163-JGR  
3192

Page 2 of 2

Other General Comments Regarding the Study Area:

→ Birds nests under bridge  
 → muskrat or mink (> 20) (American cliff swallow)  
 → green Frogs observed  
 → cyprinidae observed  
 → meander stream, large section

\* Pond online

Picture #	Description	Picture #	Description
1163	Birds nest Under Bridge	1167	D/S From R6C
1164	FACING North From Bridge	1168	U/S From (R6C)
1165	FACING South From Bridge		
1166	U/S From Bridge Kinnard		

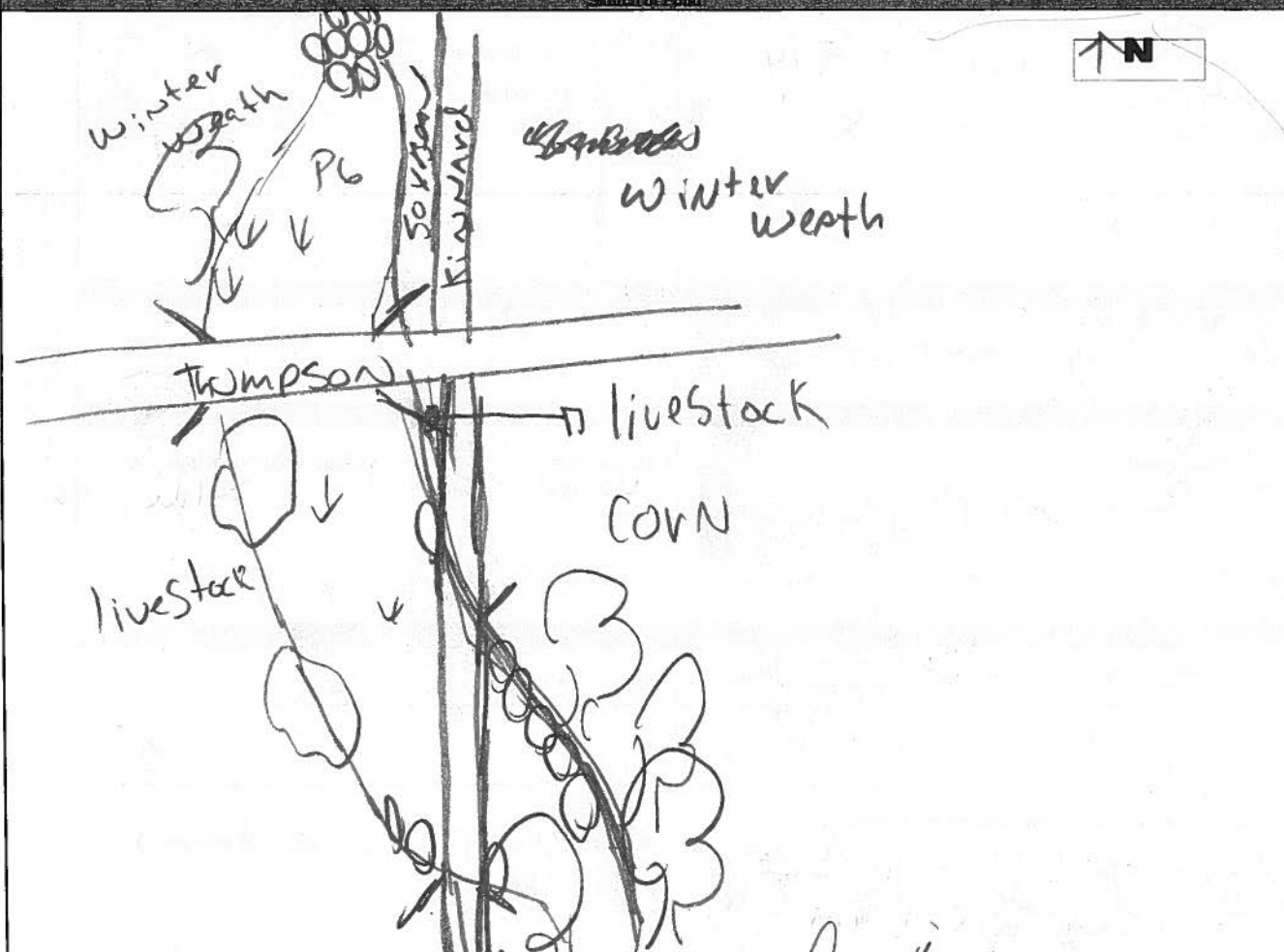

Initial QA/QC By:

L. Bentley

Date:

June 6, 2012

Technical QA/QC By:

[Signature]

Date:

Oct 2/12

P8.7

# Significant Wildlife Habitat Form

AECOM

Study Area:	BLW <input checked="" type="radio"/> JER <input type="radio"/> GSH	Map #:	120-JER1766/1717
Date:	May 22, 2012.	Time Started:	14:45
Field Staff:	Pat D, Erin P	Time Finished:	15:30
Weather Conditions: 15°C, wind 1/W, no precip., 100% cloud cover.			

**Colonial Nesting Tree/Shrub Birds, Osprey Breeding/Feeding, Bald Eagle Breeding/Nesting Habitat**  
(FET1, FOC, FOM, FOD, SWC, SWM, SWD)

Nest bowls present:  No  Yes (if yes, photograph and complete the following)

UTMs: \_\_\_\_\_ Number of nests: \_\_\_\_\_

Description of nests (location, e.g. in tree/on built structure; material; evidence of recent use; birds present): \_\_\_\_\_

Description of habitat (note riparian areas if present, evidence of disturbance): \_\_\_\_\_

**Waterfowls Stopover/Nesting, Amphibian Breeding, Turtle Nesting/Over-wintering, Marsh Breeding Birds**  
(CUM1, CUT1, MAM, MAS, SAS1, SAM1, SAF1, SWD, SWT1, SWT2) (FOC, FOM, FOD, SWC, SWM, SWD, BOO1, FE01)

Standing water present:  No  Yes (if yes, photograph and complete the following)

UTMs: (see field)  Area of standing water delineated on field map

Water depth (m): 1.5 % open water: 90 % emergent vegetation: 10

Potential to hold water until at least July in most years:  Yes  No

Description of standing water (permanent pool, evidence of annual spring flooding, etc):  
Permanent pool, stagnant water with algal blooms.

Area and soil/substrate of shoreline habitat: Anthropogenic, mineral substrates

Type and abundance of cover in open water habitat: Algal blooms with some reed canary grass at edge of water.

Type and abundance of cover in surrounding habitat: Poplar regeneration and sugar maple forest with row crop field to south.

Evidence of disturbance (e.g. cattle grazing): Anthropogenic with poplar regeneration on banks.

Evidence of use by waterfowl, amphibians, turtles (e.g. broken eggs), marsh breeding birds: Amphibians observed, somewhat closed canopy and small size likely limit waterfowl use.

**\*\*\*Complete Vernal Pool Habitat Description Form\*\*\***

**Snake Hibernacula**

Fissured rock/foundation or rock/debris pile present:  No  Yes (if yes, photograph and complete the following)

UTMs: \_\_\_\_\_ Likelihood to extend below frost line: \_\_\_\_\_

% canopy cover: \_\_\_\_\_ % slope: \_\_\_\_\_ Distance to open canopy (m): \_\_\_\_\_

Description of fissure or stone pile (composition/material, dimensions, etc): \_\_\_\_\_

Description of surrounding habitat (type & abundance of cover, evidence of disturbance, etc): \_\_\_\_\_

**Seeps and Springs** (FOC, FOM, FOD, SWC, SWM, SWD)

Evidence of seep or spring:  No  Yes (if yes, photograph and complete the following)

UTMs: \_\_\_\_\_ Description (indicator species, etc): \_\_\_\_\_





P 12.32

Significant Wildlife Habitat Form

AECOM

Study Area: BLW JER GSH Map #: 7-JER 1368  
 Date: Sept 18, 2012 Time Started: 11:45  
 Field Staff: SGT OH Time Finished: 12:15  
 Weather Conditions: Rain, Windy 17°C Overcast

**Colonial Nesting Tree/Shrub Birds, Osprey Breeding/Feeding, Bald Eagle Breeding/Nesting Habitat**  
 (FET1, FOC, FOM, FOD, SWC, SWM, SWD)  
 Nest bowls present:  No  Yes (if yes, photograph and complete the following)  
 UTM: \_\_\_\_\_ Number of nests: \_\_\_\_\_  
 Description of nests (location, e.g. in tree/on built structure; material; evidence of recent use; birds present): \_\_\_\_\_  
 Description of habitat (note riparian areas if present, evidence of disturbance): \_\_\_\_\_

**Waterfowls Stopover/Nesting, Amphibian Breeding, Turtle Nesting/Over-wintering, Marsh Breeding Birds**  
 (CUM1, CUT1, MAM, MAS, SAS1, SAM1, SAF1, SWD, SWT1, SWT2) (FOC, FOM, FOD, SWC, SWM, SWD, BOO1, FE01)  
 Standing water present:  No  Yes (if yes, photograph and complete the following)  
 UTM: 0421500 47638711 Area of standing water delineated on field map \_\_\_\_\_  
 Water depth (m): ≥ 1m % open water: 100 % emergent vegetation: 0  
 Potential to hold water until at least July in most years:  Yes  No  
 Description of standing water (permanent pool, evidence of annual spring flooding, etc): permanent pool - old dug-out pond  
 Area and soil/substrate of shoreline habitat: mineral soil  
 Type and abundance of cover in open water habitat: \_\_\_\_\_  
 Type and abundance of cover in surrounding habitat: Sugar Maple shrubs, Balsam Poplar, Green Ash seedling surrounding and fringing over water  
 Evidence of disturbance (e.g. cattle grazing): little evidence of disturbance  
 Evidence of use by waterfowl, amphibians, turtles (e.g. broken eggs), marsh breeding birds: No evidence of waterfowl use, no amphibians observed.

\*\*\*Complete Vernal Pool Habitat Description Form\*\*\*

**Snake Hibernacula**  
 Fissured rock/foundation or rock/debris pile present:  No  Yes (if yes, photograph and complete the following)  
 UTM: \_\_\_\_\_ Likelihood to extend below frost line: \_\_\_\_\_  
 % canopy cover: \_\_\_\_\_ % slope: \_\_\_\_\_ Distance to open canopy (m): \_\_\_\_\_  
 Description of fissure or stone pile (composition/material, dimensions, etc): \_\_\_\_\_  
 Description of surrounding habitat (type & abundance of cover, evidence of disturbance, etc): \_\_\_\_\_

**Seeps and Springs** (FOC, FOM, FOD, SWC, SWM, SWD)  
 Evidence of seep or spring:  No  Yes (if yes, photograph and complete the following)  
 UTM: \_\_\_\_\_ Description (indicator species, etc): \_\_\_\_\_



Water Bodies (Pond) Assessment Field Collection Form

P12.30

**General Information**  
 Study Area: Jericho Goshen Bluewater Land Parcel# JER 2672 Site ID: P2672 (ASA) P12.31

Date: June 4 / 12 Start time: 14:15 End Time: 14:30

Weather Conditions: Sunny 29°C  
 Field Crew: C Boros S Daraiche  
 Field Notes By: S Daraiche

**Site Location**  
East of Nauvoo  
North of Birnam

**UTM Co-ordinates**  
 Easting: 428384 Northing: 4767407 Description: P2672

Surrounding Landuse		Type of Pond	
Residential <input checked="" type="checkbox"/>	Meadow <input type="checkbox"/>	Natural <input type="checkbox"/>	Dammed <input type="checkbox"/>
Agriculture <input type="checkbox"/>	Wetland <input type="checkbox"/>	Permanent <input checked="" type="checkbox"/>	Seasonal <input type="checkbox"/>
Forest <input type="checkbox"/>	Livestock <input type="checkbox"/>	Dugout Pond <input checked="" type="checkbox"/>	Used for Farming <input type="checkbox"/>
Other <input type="checkbox"/>		Vernal Pools <input type="checkbox"/>	

Description: Agriculture on east Description: maybe for drainage

In-Situ Water Quality		Ground Water and Seepage Indicators	
WT (°C):	AT (°C):	Watercress <input type="checkbox"/>	Bank Seepage <input type="checkbox"/>
pH:	Cond ( s/cm):	Iron Staining <input type="checkbox"/>	None <input checked="" type="checkbox"/>
D.O. (mg/L)		Bubbling <input type="checkbox"/>	
Water Clarity: Clear <input type="checkbox"/> Turbid <input type="checkbox"/>		Details:	
Water Colour: <u>none taken (ASA)</u>			

**Wildlife Observations**  
 Observations of Fish and Wildlife: None observed

In-Situ Habitat	Physical Characteristics of Pond
Substrate (<=>) Bo - Boulder Co - Cobble Gr - Gravel Sa - Sand Si - Silt Cl - Clay MK - Muck DT - Detritus <u>Si</u>	Estimated Size: <u>12m x 12m</u> Estimated Depth (m): Notes: <u>None observed (ASA)</u>

In-Situ Cover (%)						
None	Woody Debris	Boulders	Cobble	Aquatic Vegetation*	Structures	Other
				<u>3</u>		

Note: Low = 0 - 30% ; Moderate = 30 - 75% ; High = 75 - 100%  
 \*Aquatic Vegetation Species Present (algae, submergent, emergent etc.)

Cat tails - Potamo sp  
 Description and Width of Riparian Vegetation:  
-> 0m  
-> mowed

Water Bodies (Pond) Assessment Field Collection Form

P12.30

AECOM Date: June 4/12 Land Parcel/Site ID: Jer2672 / ~~12222~~ Pond Page 2 of 2

Online Pond Y / <sup>(1)</sup> Provide Description  
 Offline Pond <sup>(1)</sup> / N Only closed From a depression course From the Field

Other General Comments Regarding the Study Area:  
 -> maybe Drain the field on east side  
 -> really closed From a House  
 -> the water levels are low

Photo log	
Picture #	Description
3042	baring east from road

Sketch of Pond

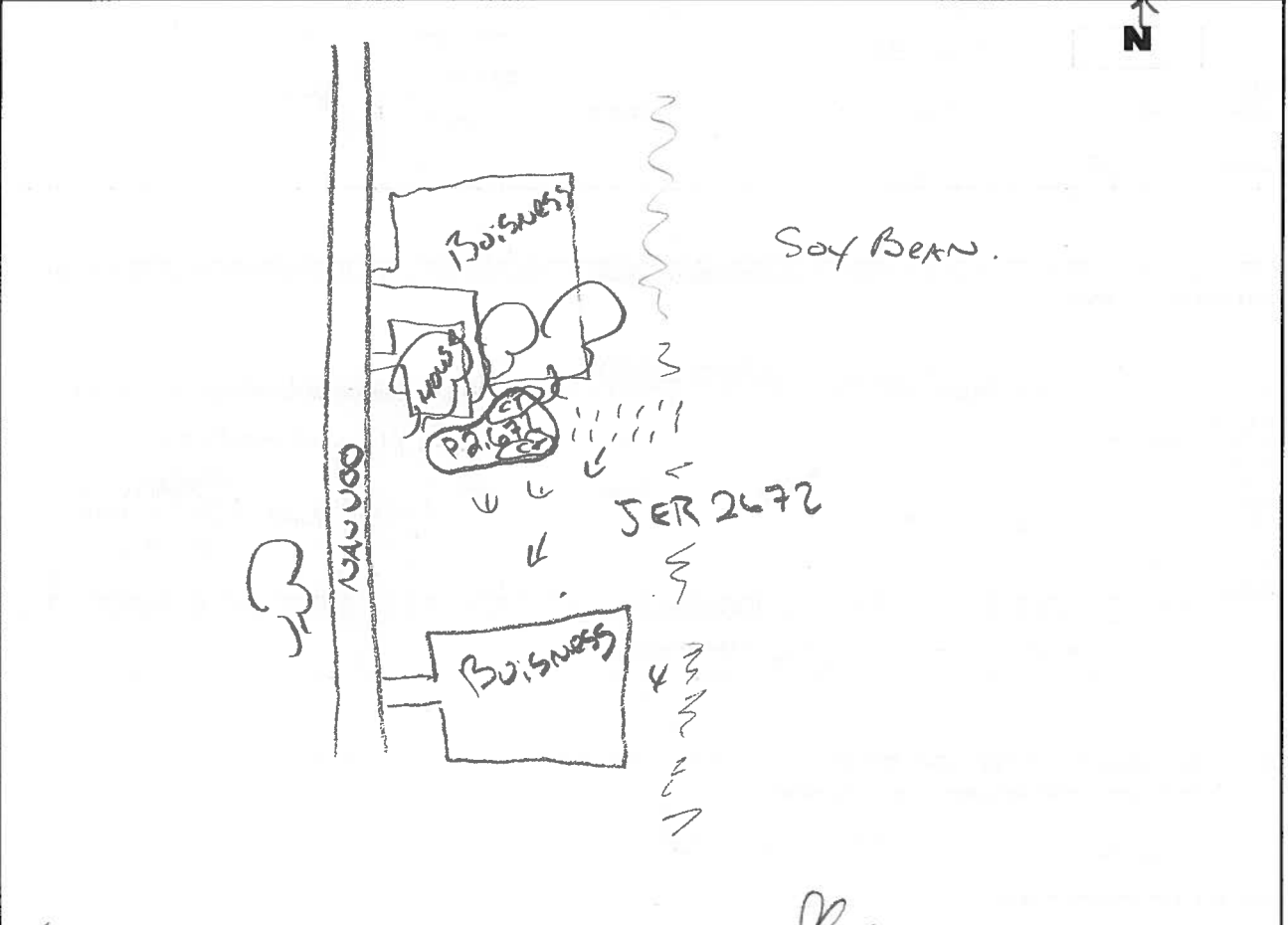

Initial QA/QC By: L Bentley Date: June 14, 2012 Technical QA/QC By: [Signature] Date: Oct 2/12

Water Bodies (Pond) Assessment Field Collection Form

P12.31

<b>AECOM</b> <span style="float: right;">Page 1 of 2</span>						
<b>General Information</b>						
Study Area: <u>Jericho</u> Goshen Bluewater		Land Parcel# <u>Jer2680</u>		Site ID: <u>P2680 (New)</u>		
Date: <u>June 4/12</u>		Start time: <u>14h30</u>		End Time: <u>14:45</u>		
Weather Conditions: <u>Sunny</u> <u>29°C</u>				Field Crew: <u>S Darniche C Bouds</u> Field Notes By: <u>S Darniche</u>		
<b>Site Location</b>						
<u>East of Nauvoo</u>						
<b>UTM Co-ordinates</b>						
Easting: <u>428398</u>		Northing: <u>4767583</u>		Description: <u>P2680</u>		
Easting:		Northing:		Description:		
<b>Surrounding Landuse</b>				<b>Type of Pond</b>		
Residential <input checked="" type="checkbox"/>	Agriculture <input type="checkbox"/>	Forest <input type="checkbox"/>	Other <input type="checkbox"/>	Meadow <input type="checkbox"/>	Wetland <input type="checkbox"/>	Livestock <input type="checkbox"/>
Description:				Description:		
				<u>Aesthetic Pond</u>		
<b>In-Situ Water Quality</b>				<b>Ground Water and Seepage Indicators</b>		
WT (°C): <u>22</u>		AT (°C): <u>29</u>		Watercress <input type="checkbox"/> Bank Seepage <input type="checkbox"/>		
pH: <u>8.69</u>		Cond (µs/cm): <u>406</u>		Iron Staining <input type="checkbox"/> None <input checked="" type="checkbox"/>		
D.O. (mg/L) <u>7.64</u>				Bubbling <input type="checkbox"/>		
Water Clarity: Clear <input type="checkbox"/> Turbid <input checked="" type="checkbox"/>				Details:		
Water Colour: <u>green</u>						
<b>Wildlife Observations</b>						
Observations of Fish and Wildlife <u>None observed</u>						
<b>In-Situ Habitat</b>				<b>Physical Characteristics of Pond</b>		
Substrate (<=>) Bo - Boulder Co - Cobble Gr - Gravel Sa - Sand Si - Silt Cl - Clay MK - Muck DT - Detritus				Estimated Size: <u>10m x 20m</u> Estimated Depth (m):		
Description: <u>rocky slopes</u>				Notes: <u>not wadable</u>		
<b>In-Situ Cover (%)</b>						
None	Woody Debris	Boulders	Cobble	Aquatic Vegetation*	Structures	Other
			20	10		
Note: Low = 0 - 30%; Moderate = 30 - 75%; High = 75 - 100% *Aquatic Vegetation Species Present (algae, submergent, emergent etc.) <u>Cattail</u>						
Description and Width of Riparian Vegetation <u>no riparian veg</u>						

Water Bodies (Pond) Assessment Field Collection Form

P12.31

AECOM Date: June 7/12 Land Parcel/Site ID: JR2680 Pond Page 2 of 2

Online Pond  /  Provide Description pond to collect drainage  
 Offline Pond  /

Other General Comments Regarding the Study Area:  
It is a dugout pond for aesthetics in front of office

Photo log	
Picture #	Description
<u>1343</u>	<u>from road</u>

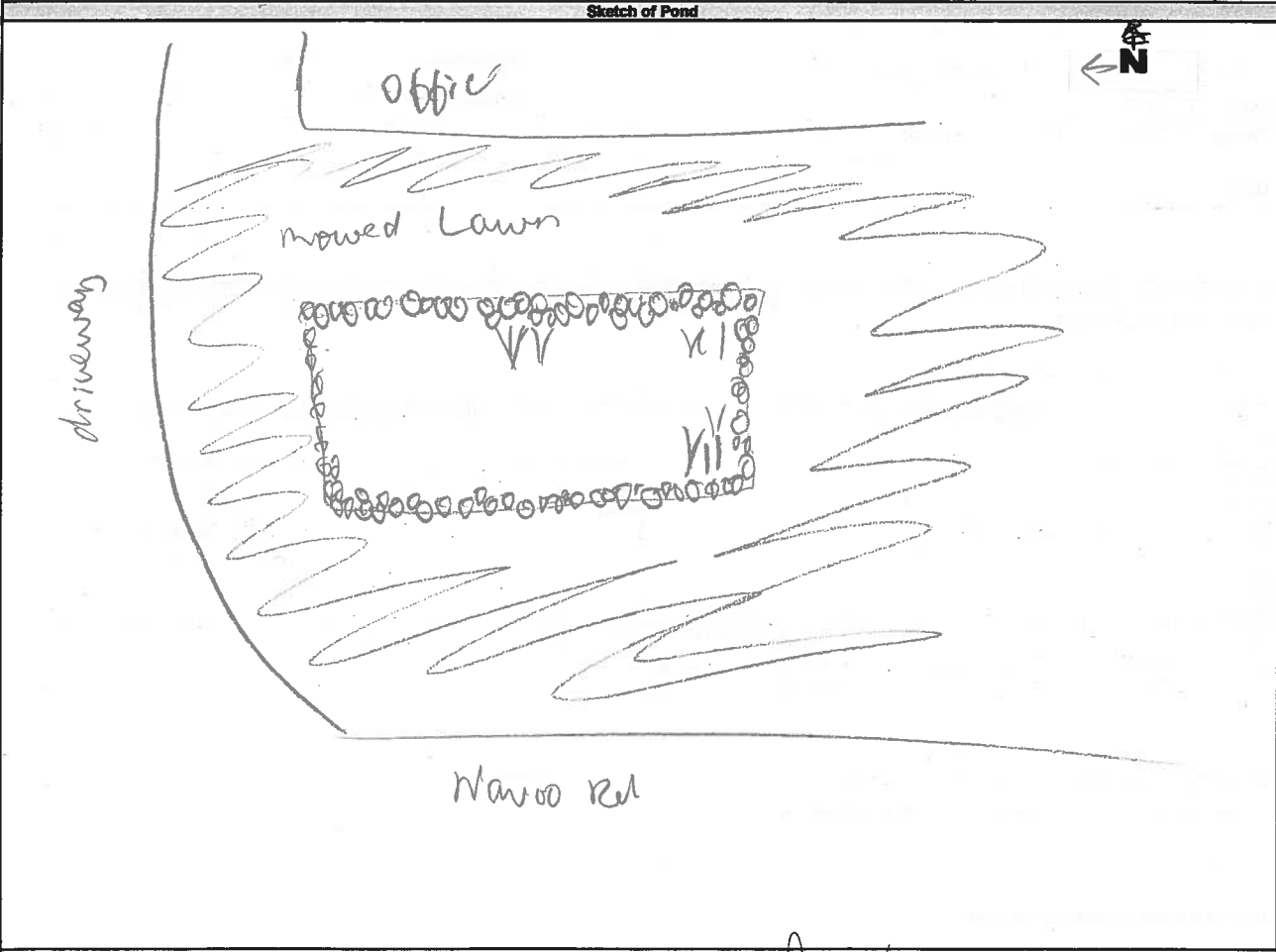

Initial QA/QC By: L. Bentley Date: June 14, 2012 Technical QA/QC By: [Signature] Date: Oct 2/12

Water Bodies (Pond) Assessment Field Collection Form

AECOM

Page 1 of 2

General Information

Study Area: Jericho Goshen Bluewater Land Parcel# JER 2735 Site ID: P12.14  
 Date: JUN 27/12 Start time: 16:20 End Time: 16:30  
 Weather Conditions: SUNNY 28°C Field Crew: C Benoit S Deraiche  
 Field Notes By: S Deraiche

Site Location

West Nauvoo North of Binnau (ASA)

UTM Co-ordinates

Easting: \_\_\_\_\_ Northing: \_\_\_\_\_ Description: None taken

Easting: \_\_\_\_\_ Northing: \_\_\_\_\_ Description: \_\_\_\_\_

Surrounding Landuse

Residential  Meadow   
 Agriculture  Wetland   
 Forest  Livestock   
 Other

Type of Pond

Natural  Dammed   
 Permanent  Seasonal   
 Dugout Pond  Used for Farming   
 Vernal Pools

Description:

Description:

In-Situ Water Quality

WT (°C): \_\_\_\_\_ AT (°C): \_\_\_\_\_  
 pH: \_\_\_\_\_ Cond (µm): \_\_\_\_\_  
 D.O. (mg/L) \_\_\_\_\_  
 Water Clarity: Clear  Turbid

Ground Water and Seepage Indicators

Watercress  Bank Seepage   
 Iron Staining  None   
 Bubbling

Water Colour:

(ASA)

Details:

ASA So Far

Wildlife Observations

Observations of Fish and Wildlife

ASA So Far

In-Situ Habitat

Substrate (<=>) Description  
 Bo - Boulder  
 Co - Cobble  
 Gr - Gravel  
 Sa - Sand  
 Si - Silt  
 Cl - Clay  
 MK - Muck  
 DT - Detritus

~~\_\_\_\_\_~~

Physical Characteristics of Pond

Estimated Size: \_\_\_\_\_ Estimated Depth (m): \_\_\_\_\_

Notes: 180m x 60m (ASA)

In-Situ Cover (%)

None	Woody Debris	Boulders	Cobble	Aquatic Vegetation*	Structures	Other

Note: Low = 0 - 30%; Moderate = 30 - 75%; High = 75 - 100%

\*Aquatic Vegetation Species Present (algae, submergent, emergent etc.)

So Far

Description and Width of Riparian Vegetation

\* Forest plants > 30 on south side

Water Bodies (Pond) Assessment Field Collection Form

JER 2735

AECOM Date: JUN 7/12 Land Parcel/Site ID: P12.14 Page 2 of 2

Online Pond Y /  N Provide Description  
 Offline Pond  Y N NO Stream connect

Other General Comments Regarding the Study Area:  
 -> Pond located of south on field and north of wood forest area.  
 ->

Photo log	
Picture #	Description
1509	Facing west From New Wood

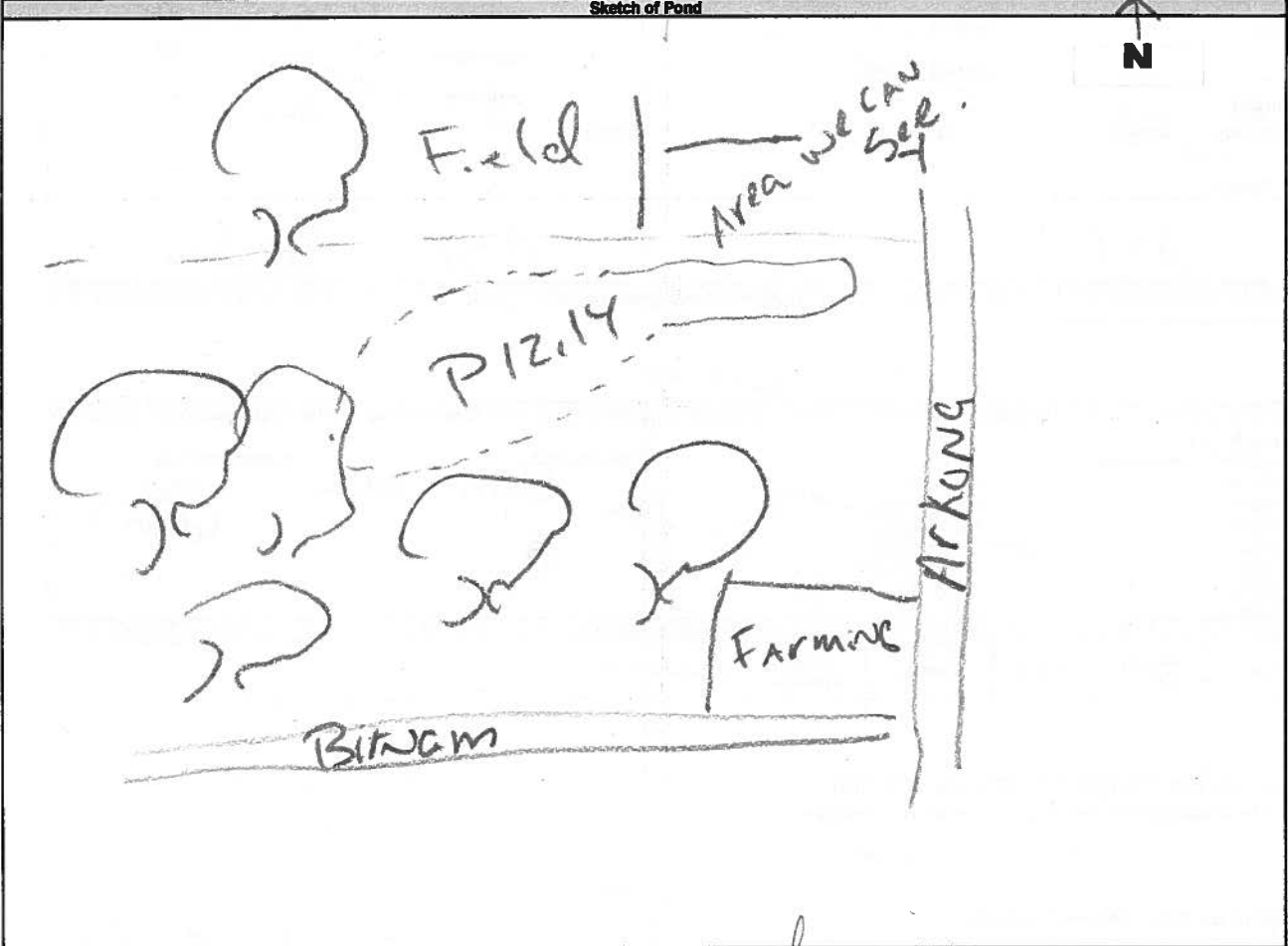

Initial QA/QC By: L. Bentley Date: June 14, 2012 Technical QA/QC By: [Signature] Date: Oct 2/12



Water Bodies (Pond) Assessment Field Collection Form

AECOM

General Information

Study Area: Jericho Goshen Bluewater Land Parcel# JER 12.22 2740 Site ID: P12.22  
 Date: June 7/12 Start time: 16:20 End Time: 16:30  
 Weather Conditions: Sunny, 20°C Field Crew: C. Beros, J. Oaraide  
 Field Notes By: C. Beros

Site Location

Binnam Rd, west of Narwo Roadside Survey

UTM Co-ordinates

Easting: / Northing: / Description: Roadside  
 Easting: / Northing: / Description:

Surrounding Landuse

Residential  Meadow   
 Agriculture  Wetland   
 Forest  Livestock   
 Other

Type of Pond

Natural  Dammed   
 Permanent  Seasonal   
 Dugout Pond  Used for Farming   
 Vernal Pools

Description:

Description:

possibly large storage pond

In-Situ Water Quality

WT (°C): / AT (°C):  
 pH: / Cond ( s/cm):  
 D.O. (mg/L): /

Water Clarity: Clear  Turbid

Water Colour: no access

Ground Water and Seepage indicators

Watercress  Bank Seepage   
 Iron Staining  None   
 Bubbling

Details:

could not assess

Wildlife Observations

Observations of Fish and Wildlife

none observed

In-Situ Habitat

Substrate (<=>) Description  
 Bo - Boulder  
 Co - Cobble  
 Gr - Gravel  
 Sa - Sand  
 Si - Silt  
 Cl - Clay  
 MK - Muck  
 DT - Detritus

Could not assess

Physical Characteristics of Pond

Estimated Size: 100 x 200m Estimated Depth (m): /

Notes:

In-Situ Cover (%)

None	Woody Debris	Boulders	Cobble	Aquatic Vegetation*	Structures	Other

Note: Low = 0 - 30%; Moderate = 30 - 75%; High = 75 - 100%

\*Aquatic Vegetation Species Present (algae, submergent, emergent etc.)

Description and Width of Riparian Vegetation

Could not assess

Water Bodies (Pond) Assessment Field Collection Form

AECOM

Date: June 7/12

Land Parcel/Site ID: JER 2740

Page 2 of 2  
P12.22

Online Pond Y / N

Provide Description

not sure - could not observe

Offline Pond Y / N

Other General Comments Regarding the Study Area:

The GIS mapping of P12.22 does not match actual pond.  
Actual pond much larger and with 50m of road.  
- open water, emergent grasses on edge

		Photo log	
Picture #	Description	Picture #	Description
1576-7	Pond overview		

Sketch of Pond

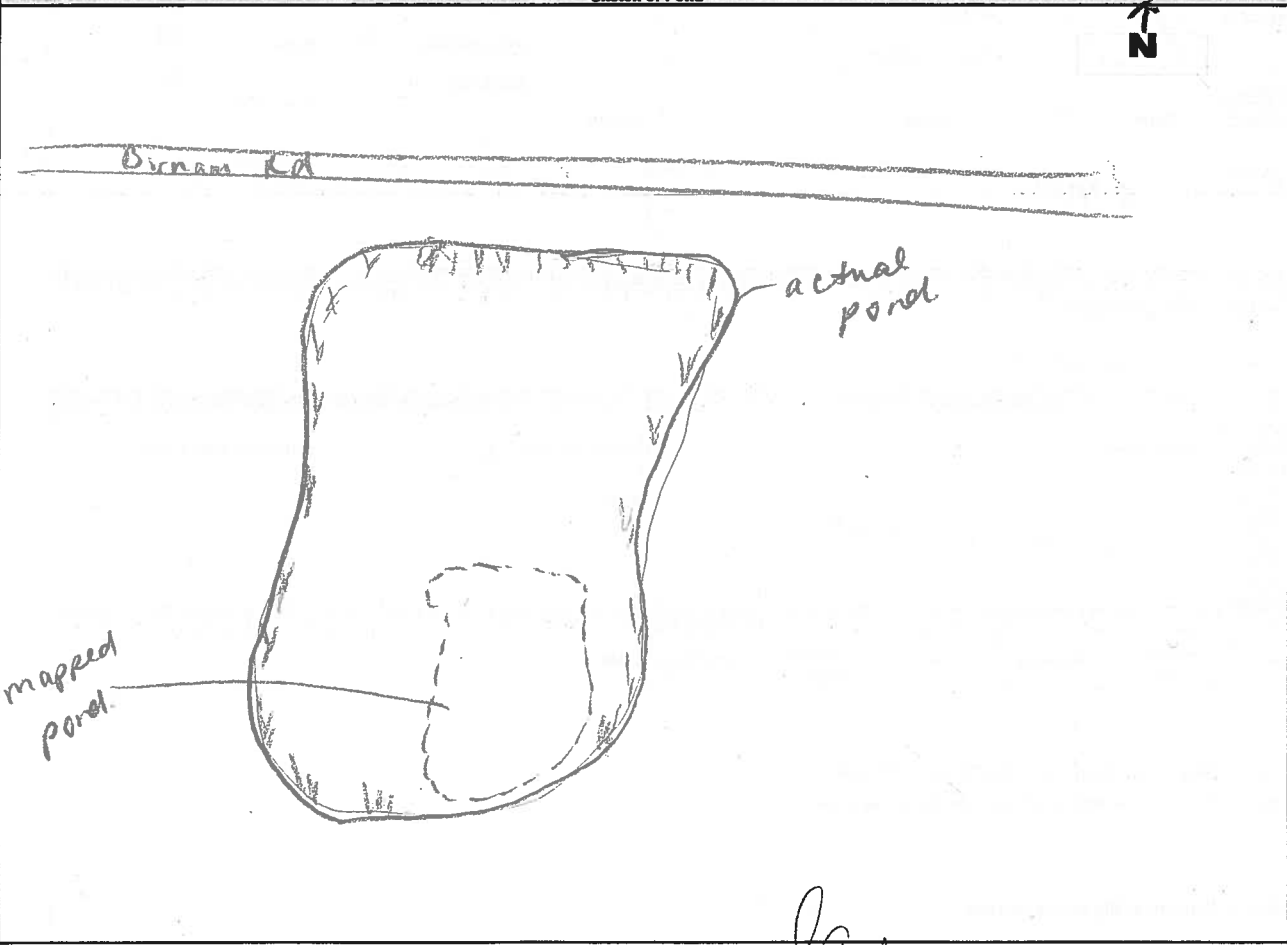

Initial QA/QC By: *Libentley*

Date: June 13, 2012

Technical QA/QC By: *J. Fisher*

Date: Oct 2/12

**Assessment of Non-Water Body  
(update to mapping required)**

<b>AECOM</b>		Page 1 of 2	
<b>General Information</b>			
Study Area: <u>Jenicho</u>	<u>Goshen</u>	<u>Bluewater</u>	Land Parcel# <u>JER 3618</u> Site ID: <u>R4.51</u>
Date: <u>Nov 22/12</u>	Start time: <u>13:45</u>	End Time: <u>13:55</u>	
Weather Conditions: <u>Sunny</u>		Field Crew: <u>C. Boros</u>	Field Notes By: <u>C. Boros</u>
<b>Site Location</b>			
<u>Gordon Rd., north of Jura Line.</u>			
<b>UTM Co-ordinates</b>			
Easting: _____	Northing: _____	Description: _____	
Easting: _____	Northing: _____	Description: _____	
Easting: _____	Northing: _____	Description: _____	
Easting: _____	Northing: _____	Description: _____	
<b>Surrounding Landuse</b>		<b>Ground Water and Seepage Indicators</b>	
Residential <input type="checkbox"/>	Meadow <input type="checkbox"/>	Watercress <input type="checkbox"/>	Bank Seepage <input type="checkbox"/>
Agriculture <input checked="" type="checkbox"/>	Wetland <input type="checkbox"/>	Iron Staining <input type="checkbox"/>	None <input checked="" type="checkbox"/>
Forest <input type="checkbox"/>	Livestock <input type="checkbox"/>	Bubbling <input type="checkbox"/>	
Other <input type="checkbox"/>		Details: _____	
Description: <u>Crops</u>			
<b>Feature Description</b>			
Is the mapped water body any of the below:			
1) a grassed waterway?	<u>Y</u> / <u>N</u>		
2) Temporary channel for surface drainage, that can be tilled or driven through?		<u>Y</u> / <u>N</u>	
3) Rock chutes or spillways?	<u>Y</u> / <u>N</u>		
4) Roadside ditches that are not connected or do not contain a permanent or intermittent stream?			<u>Y</u> / <u>N</u>
5) Temporarily ponded areas that are normally farmed?	<u>Y</u> / <u>N</u>		
6) Artificial bodies of water intended for storage, treatment for farming purposes?			<u>Y</u> / <u>N</u>
8) Any other:			
Description: (i.e. length of change, if it reappears, if there is evidence of water)			
<u>Farmer ploughs through entire field</u>			
<b>Photo log</b>			
Picture #	Description	Picture #	Description

Assessment of Non-Water Body  
(update to mapping required)

AECOM

Date:

Nov 22/12

Land Parcel/Site ID:

JER 3618

Page 2 of 2

Site Sketch

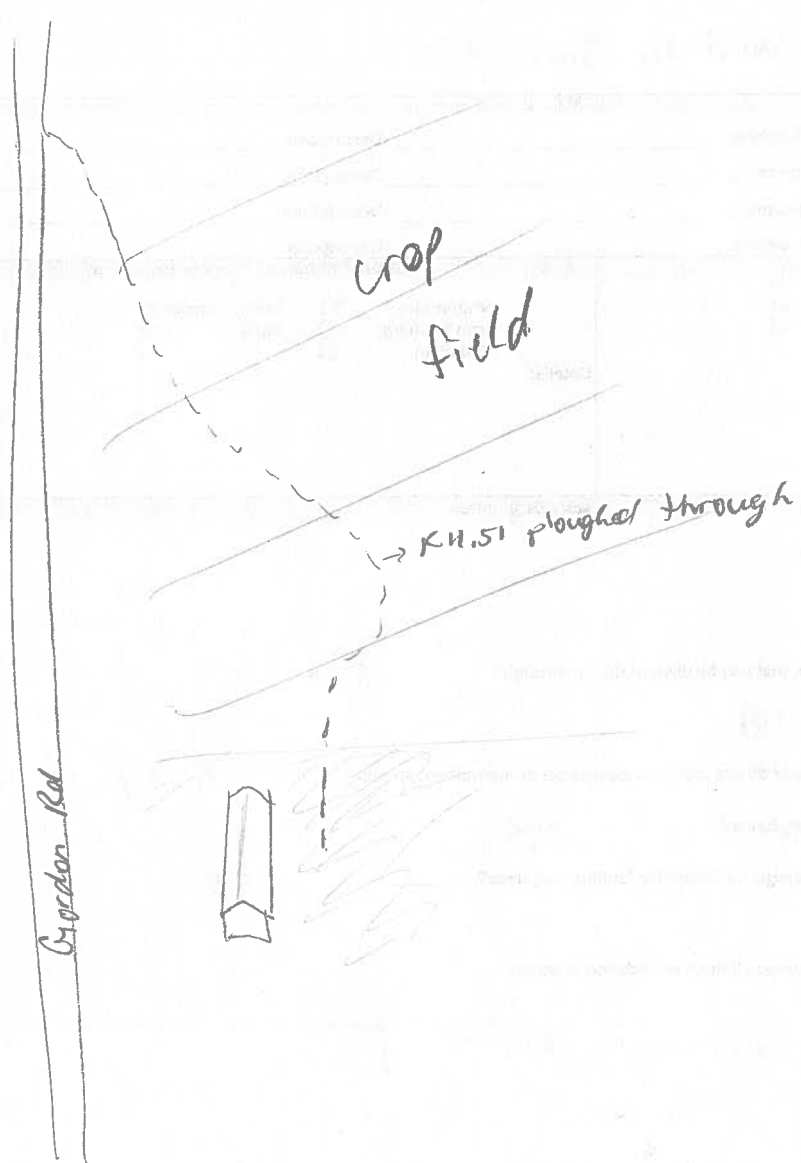

Water Bodies Assessment Field Collection Form

<b>AECOM</b>		Page 1 of 4	
<b>General Information</b>			
Study Area: <u>Jericho</u>	Goshen	Bluewater	Land Parcel# <u>JER3505</u> Site ID: <u>R3.38</u>
Date: <u>Nov 22/10</u>	Start time: <u>12:30</u>	End Time: <u>12:55</u>	
Weather Conditions: <u>Sunny 10°C</u>		Field Crew: <u>C. Boros</u>	Field Notes By: <u>C. Boros</u>
<b>Site Location</b>			
<u>Thompson Line, west of Gordon</u>			
<b>UTM Co-ordinates (continue on page 3 if necessary)</b>			
Easting: <u>430081</u>	Northing: <u>4778020</u>	Description: <u>road</u>	
Easting: _____	Northing: _____	Description: _____	
Easting: _____	Northing: _____	Description: _____	
Easting: _____	Northing: _____	Description: _____	
<b>Surrounding Landuse</b>		<b>Type of Watercourse</b>	
Residential <input type="checkbox"/>	Meadow <input type="checkbox"/>	Intermittent <input type="checkbox"/>	Channelized <input checked="" type="checkbox"/>
Agriculture <input checked="" type="checkbox"/>	Wetland <input type="checkbox"/>	Permanent <input checked="" type="checkbox"/>	Natural Channel <input type="checkbox"/>
Forest <input type="checkbox"/>	Livestock <input type="checkbox"/>	Ephemeral <input type="checkbox"/>	_____ <input type="checkbox"/>
Other _____		Description: _____	
Description: <u>crop fields</u>		Description: <u>straight</u>	
<b>Notes: (include any inputs into the system i.e. tile drainage, seepages, overland flow)</b>			
<u>Tile drains noted on both sides - no flow except at road.</u>			
Is any portion of the water body underground or not as mapped? <u>Y / N</u>			
If Yes describe: _____			
GPS Coordinate: Easting - _____		Northing - _____	
Description - _____			
<b>Description of Land Topography Surrounding Water Body (rolling hills, sloping towards water body)</b>			
<u>flat</u>			
<b>In-Situ Water Quality</b>		<b>Ground Water and Seepage Indicators</b>	
WT (°C): <u>10.05</u>	AT (°C): <u>10°C</u>	Watercress <input type="checkbox"/>	Bank Seepage <input type="checkbox"/>
pH: <u>8.11</u>	Cond (µs/cm): <u>684</u>	Iron Staining <input type="checkbox"/>	None <input checked="" type="checkbox"/>
D.O. (mg/L) <u>11.97</u>		Bubbling <input type="checkbox"/>	_____ <input type="checkbox"/>
Water Clarity: <u>Clear</u> <input type="checkbox"/>	<u>Turbid</u> <input type="checkbox"/>	Other <input type="checkbox"/>	
Water Colour: <u>etc, n/o</u>		Details: _____	
Notes: <u>water depth ~ 0.15m</u>			

**Water Bodies Assessment Field Collection Form**

Stream Morphology															
Site Length (m): <u>200m</u>		Bank Stability:													
Channel Dimensions		<table style="width:100%; border-collapse: collapse;"> <tr> <td style="text-align: center;">Stable</td> <td style="text-align: center;">Slightly unstable</td> <td style="text-align: center;">Moderately unstable</td> <td style="text-align: center;">Unstable</td> </tr> <tr> <td>Left Bank</td> <td align="center"><input type="checkbox"/></td> <td align="center"><input checked="" type="checkbox"/></td> <td align="center"><input type="checkbox"/></td> </tr> <tr> <td>Right Bank</td> <td align="center"><input type="checkbox"/></td> <td align="center"><input checked="" type="checkbox"/></td> <td align="center"><input type="checkbox"/></td> </tr> </table>		Stable	Slightly unstable	Moderately unstable	Unstable	Left Bank	<input type="checkbox"/>	<input checked="" type="checkbox"/>	<input type="checkbox"/>	Right Bank	<input type="checkbox"/>	<input checked="" type="checkbox"/>	<input type="checkbox"/>
Stable	Slightly unstable	Moderately unstable	Unstable												
Left Bank	<input type="checkbox"/>	<input checked="" type="checkbox"/>	<input type="checkbox"/>												
Right Bank	<input type="checkbox"/>	<input checked="" type="checkbox"/>	<input type="checkbox"/>												
Mean Wetted Width (m): <u>0.8</u>	Mean Wetted Depth (m): <u>0.15</u>	Description: <u>bone sinks - could be due to newly dug fur</u>													
Mean Bankfull Width (m): <u>1.3</u>	Mean Bankfull Depth (m): <u>0.5</u>														
Mean Top of Bank Width (m): <u>4</u>	Mean Top of Bank Depth (m): <u>1.5</u>														
Flow Description: (high or low flow conditions, stagnant, etc)															
<u>V.V. slow flow</u>															
Habitat															
Substrate (<=>)		Morphological Structure (%)													
Description Bo - Boulder Co - Cobble Gr - Gravel Sa - Sand Si - Silt Cl - Clay MK - Muck DT - Detritus <u>Si = mk = Cl = Sa</u>		<table border="1" style="width:100%; border-collapse: collapse;"> <tr> <th>Pool</th> <th>Riffle</th> <th>Run</th> <th>Flat</th> </tr> <tr> <td></td> <td></td> <td></td> <td align="center"><u>100</u></td> </tr> </table>		Pool	Riffle	Run	Flat				<u>100</u>				
Pool	Riffle	Run	Flat												
			<u>100</u>												
		Notes: <u>straight</u>													
Instream Cover (%)															
Other	Woody Debris	Boulders	Cobble	Aquatic Vegetation*	None	Undercut Banks									
/	/	/	<u>5</u>	<u>80</u>	/	Average Depth: (% Cover) <u>/</u>									
Note: Low = 0 - 30%; Moderate = 30 - 75%; High = 75 - 100%															
*Aquatic Vegetation Species Present (algae, submergent, emergent etc.)															
<u>emergent grasses &gt;&gt;&gt; algae, duckweed</u>															
Canopy Cover (% closed cover):				Types of Cover (% cover)											
100-90%	<input type="checkbox"/>	30-1%	<input checked="" type="checkbox"/>	Trees	Shrubs <u>20</u>	Man-made structures									
90-60%	<input type="checkbox"/>	0%	<input type="checkbox"/>	Grasses <u>70</u>	Herbaceous <u>10</u>	Other									
60-30%	<input type="checkbox"/>														
Note: Low = 0 - 30%; Moderate = 30 - 60%; High = 60 - 100%															
Notes: (vegetation species, types of structures)															
<u>low canopy cover however very dense grasses in stream.</u>															
Riparian Vegetation															
Width and Description of riparian vegetation:	LB - <u>no riparian past bank edge</u>			RB - <u>"</u>											
Overhanging Vegetation Present	<input checked="" type="checkbox"/>	% Overhanging Vegetation:		<u>0.2%</u>											
Description of Overhanging Vegetation:	<u>one shrub (dogwood) overhanging stream</u>														
Obstructions to Fish Passage															
None Observed	<input type="checkbox"/>	Man-Made	<input checked="" type="checkbox"/>	Natural	<input type="checkbox"/>	Low Flow Barrier	<input type="checkbox"/>								
Description of Barrier:	<u>2 of 4 culverts plugged at road</u>														
Height of Barrier (m)	<u>0.20 , 0.40</u>			GPS Coordinates:											

**Water Bodies Assessment Field Collection Form**

**AECOM**

Date: *Nov 20/12*

Land Parcel/Site ID:

Page 3 of 4

**Other General Comments Regarding the Study Area:**

*Straight channelized feature, densely vegetated in stream.  
Soft bottom and low canopy cover  
↳ appears to have been dug out for tile drainage.*

**Additional UTM Coordinates:**

**Photo log**

Picture #	Description	Picture #	Description
1	<i>overview</i>		
2	<i>inlets at road</i>		
3	<i>overview</i>		
4	<i>channel</i>		
5	<i>overview - in stream</i>		
6	<i>tile drain</i>		
7	<i>algae</i>		
8-9	<i>overview at end (n)</i>		

# Water Bodies Assessment Field Collection Form

**AECOM**

Page 4 of 4

## Watercourse Sketch

Study Area:

Jericho

Goshen

Bluewater

Land Parcel# JEP 3515

Site ID

R.5.38



LEGEND	
10d depth (cm)	→
6w width	⇌
Riffle	○
Run/Glide	□
Pool	○
Island/Bar	■
Fine Substrate	□
Gravel Substrate	##
Cobble/Boulder	oOoO
Debris	***
Cattail	CT
Submerg/Float Veg	SV/FV
Emergent Vegetation	EV
Watercress	W
Iron Staining	Fe
Eroded Bank	
Riprap / Other Stabilization	xxx
Instream Log/Tree	☐
Dam/Weir / Obstruction	AAA
Riparian Tree	⊗
Seep/Spring	▷
Undercut Bank	—
Barrier to Fish Movement	—
Seasonal Barrier	-S-
Fence line	-x-x-
Culvert	┌

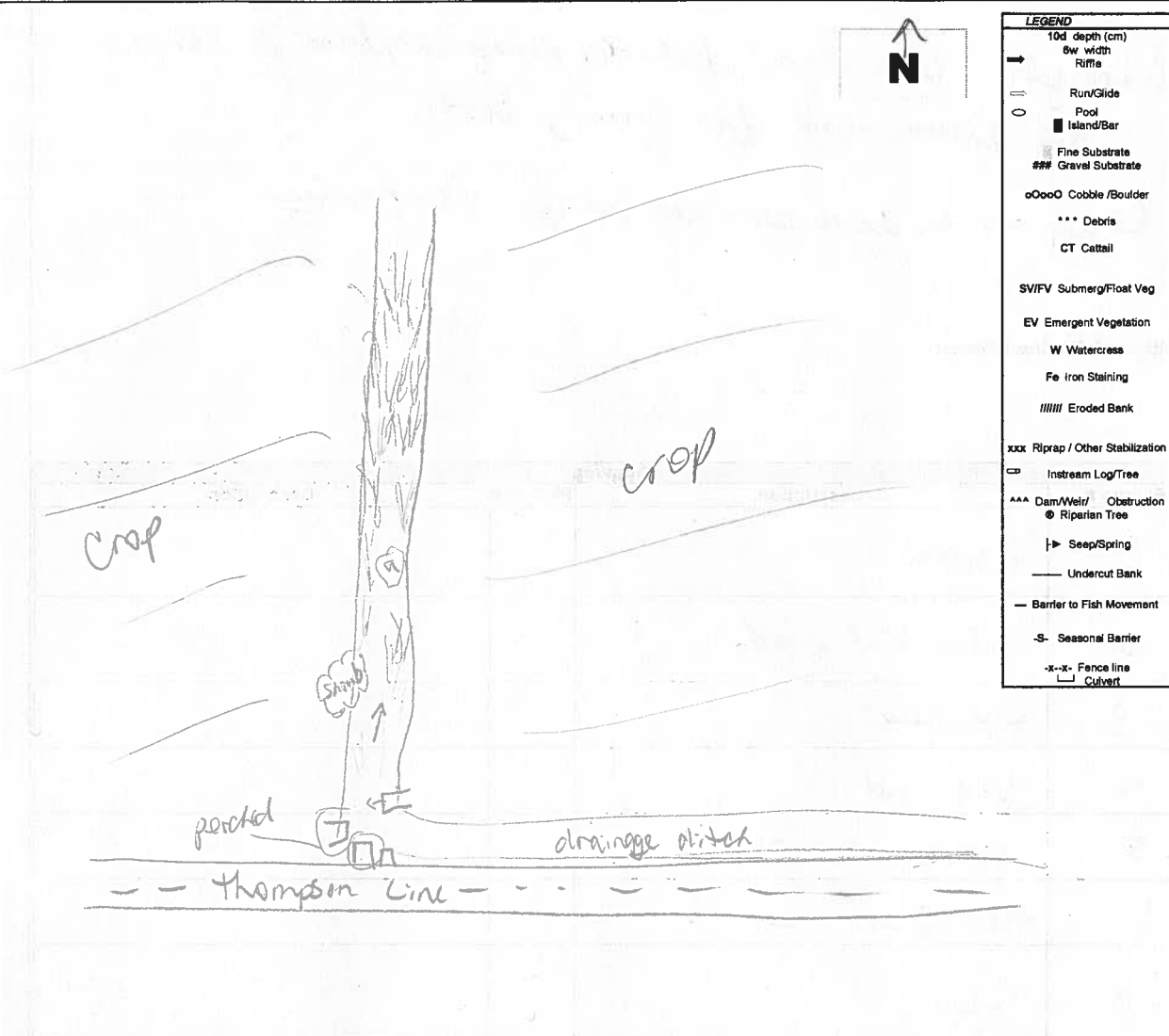

**Horizontal View of Channel**

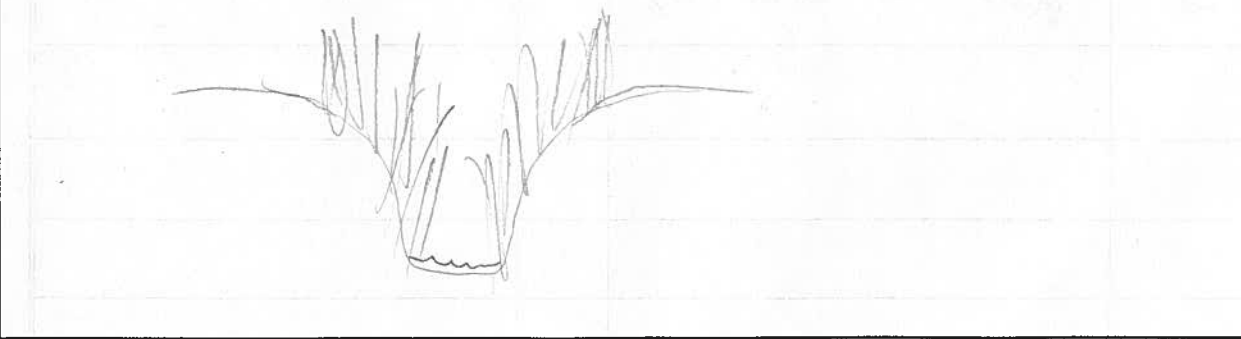

Initial QA/QC By: \_\_\_\_\_ Date: \_\_\_\_\_ Technical QA/QC By: \_\_\_\_\_ Date: \_\_\_\_\_



**Assessment of Non-Water Body  
(update to mapping required)**

<b>AECOM</b>		Page 1 of 2	
<b>General Information</b>			
Study Area: <u>Jericho</u> Goshen Bluewater		Land Parcel# <u>JER 3621</u>	Site ID: <u>R2.94</u>
Date: <u>Nov 22/12</u>	Start time: <u>14:00</u>	End Time: <u>14:10</u>	
Weather Conditions: <u>Sunny, 10°C</u>		Field Crew: <u>C. Boros</u>	Field Notes By: <u>C. Boros</u>
<b>Site Location</b>			
<u>Arkona Rd., south of Cedar Point Ln.</u>			
<b>UTM Co-ordinates</b>			
Easting:	Northing:	Description:	
Easting:	Northing:	Description:	
Easting:	Northing:	Description:	
Easting:	Northing:	Description:	
<b>Surrounding Landuse</b>		<b>Ground Water and Seepage Indicators</b>	
Residential <input type="checkbox"/>	Meadow <input type="checkbox"/>	Watercress <input type="checkbox"/>	Bank Seepage <input type="checkbox"/>
Agriculture <input checked="" type="checkbox"/>	Wetland <input type="checkbox"/>	Iron Staining <input type="checkbox"/>	None <input checked="" type="checkbox"/>
Forest <input type="checkbox"/>	Livestock <input type="checkbox"/>	Bubbling <input type="checkbox"/>	
Other <input type="checkbox"/>			
Description: <u>crop fields</u>		Details:	
<b>Feature Description</b>			
Is the mapped water body any of the below:			
1) a grassed waterway?	Y/N		
2) Temporary channel for surface drainage, that can be tilled or driven through?		Y/N	
3) Rock chutes or spillways?	Y/N		
4) Roadside ditches that are not connected or do not contain a permanent or intermittent stream?			Y/N
5) Temporarily ponded areas that are normally farmed?	Y/N		
6) Artificial bodies of water intended for storage, treatment for farming purposes?			Y/N
8) Any other:			
Description: (i.e. length of change, if it reappears, if there is evidence of water)			
<u>Appears to collect tile drainage + high flow rain events.</u>			
<b>Photo log</b>			
Picture #	Description	Picture #	Description
<u>1</u>	<u>overview</u>	<u>7</u>	<u>drainage gully adjacent to field</u>
<u>2-3</u>	<u>culvert</u>		
<u>4-6</u>	<u>ditch channel</u>		

Assessment of Non-Water Body  
(update to mapping required)

AECOM

Date: Nov 22/12

Land Parcel/Site ID: JAK 3621

Page 2 of 2

Site Sketch

