

- Legend**
- Project Location
 - ▭ Municipal Boundary - Upper
 - ▭ Municipal Boundary - Lower
 - ▭ Watercourse
 - ▭ Waterbody

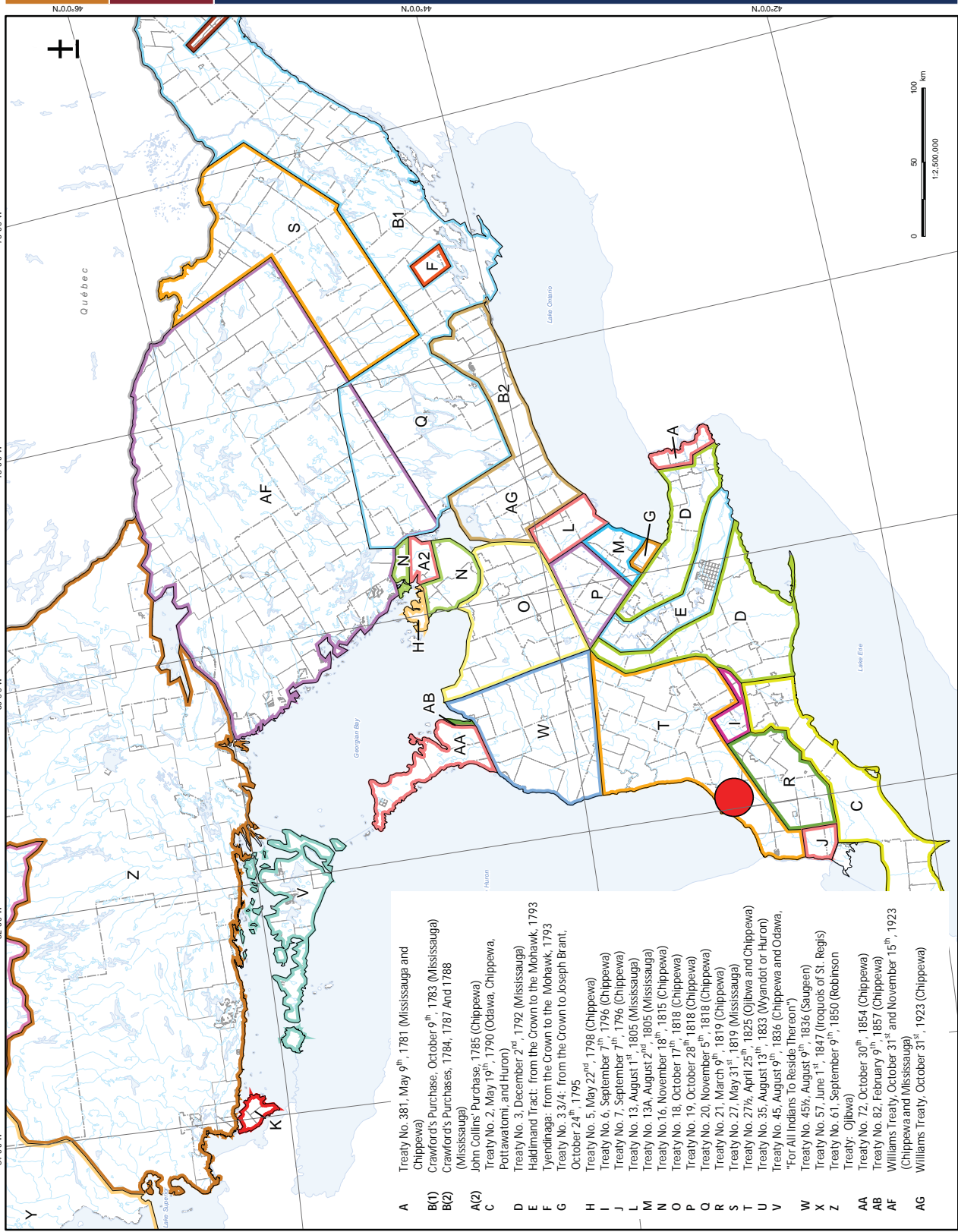

- A Treaty No. 381, May 9th, 1781 (Mississauga and Chippewa)
- B(1) Crawford's Purchase, October 9th, 1783 (Mississauga)
- B(2) Crawford's Purchases, 1784, 1787 And 1788 (Mississauga)
- A(2) John Collins Purchase, 1785 (Chippewa)
- C Treaty No. 2, May 19th, 1790 (Odawa, Chippewa, Pottawatomi, and Huron)
- D Treaty No. 3, December 2nd, 1792 (Mississauga)
- E Haldimand Tract: from the Crown to the Mohawk, 1793
- F Tyeridnaga: from the Crown to the Mohawk, 1793
- G Treaty No. 3/3/4: from the Crown to Joseph Brant, October 24th, 1795
- H Treaty No. 5, May 22nd, 1798 (Chippewa)
- I Treaty No. 6, September 7th, 1796 (Chippewa)
- J Treaty No. 7, September 7th, 1796 (Chippewa)
- L Treaty No. 13, August 1st, 1805 (Mississauga)
- M Treaty No. 13A, August 2nd, 1805 (Mississauga)
- N Treaty No. 16, November 18th, 1815 (Chippewa)
- O Treaty No. 18, October 17th, 1818 (Chippewa)
- P Treaty No. 19, October 28th, 1818 (Chippewa)
- Q Treaty No. 20, November 5th, 1818 (Chippewa)
- R Treaty No. 21, March 9th, 1819 (Chippewa)
- S Treaty No. 27, May 31st, 1819 (Mississauga)
- T Treaty No. 27%, April 25th, 1825 (Ojibwa and Chippewa)
- U Treaty No. 35, August 13th, 1833 (Wyandot or Huron)
- V Treaty No. 45, August 9th, 1836 (Chippewa and Odawa, "For All Indians to Reside Thereon")
- W Treaty No. 45%, August 9th, 1836 (Saugeen)
- X Treaty No. 57, June 1st, 1847 (Iroquois of St. Regis)
- Z Treaty No. 61, September 9th, 1850 (Robinson Treaty, Ojibwa)
- AA Treaty No. 72, October 30th, 1854 (Chippewa)
- AB Treaty No. 82, February 9th, 1857 (Chippewa)
- AF Williams Treaty, October 31st and November 15th, 1923 (Chippewa and Mississauga)
- AG Williams Treaty, October 31st, 1923 (Chippewa)

- Notes**
1. Coordinate System: NAD 1983 Statistics Canada Lambert
 2. Base features produced under license with the Ontario Ministry of Natural Resources © Queen's Printer for Ontario, 2012.
 3. Treaty boundaries adapted from MNR July 1980, based on map compiled by J.L. Morris 2 March 1931. For cartographic representation only.







Client/Project
 Jericho Wind Inc
 Jericho Wind Energy Centre
 Stage 2 Archaeological Assessment

Figure No.
 2

Title
 Treaties and Purchases
 (Adapted from Morris 1931)

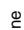
Legend

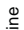
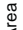
Proposed Project Components

-  Wind Turbine
-  MET Tower
-  Collector Line
-  Laydown Area
-  Access Road

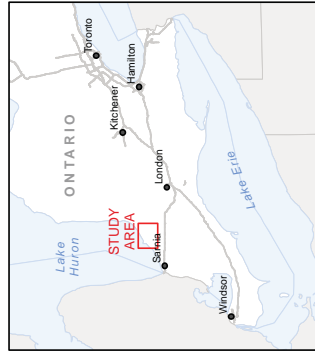

Notes

1. Historical information not to scale.
2. Bosanquet Township map from *Illustrated Historical Atlas of the County of Lambton*. Belden, H. and Co., 1880.



April 2013
160940227

Client/Project
Jericho Wind Inc
Jericho Wind Energy Centre
Stage 2 Archaeological Assessment

Figure No.
3a

Title
A Portion of the 1880 Map of Bosanquet Township

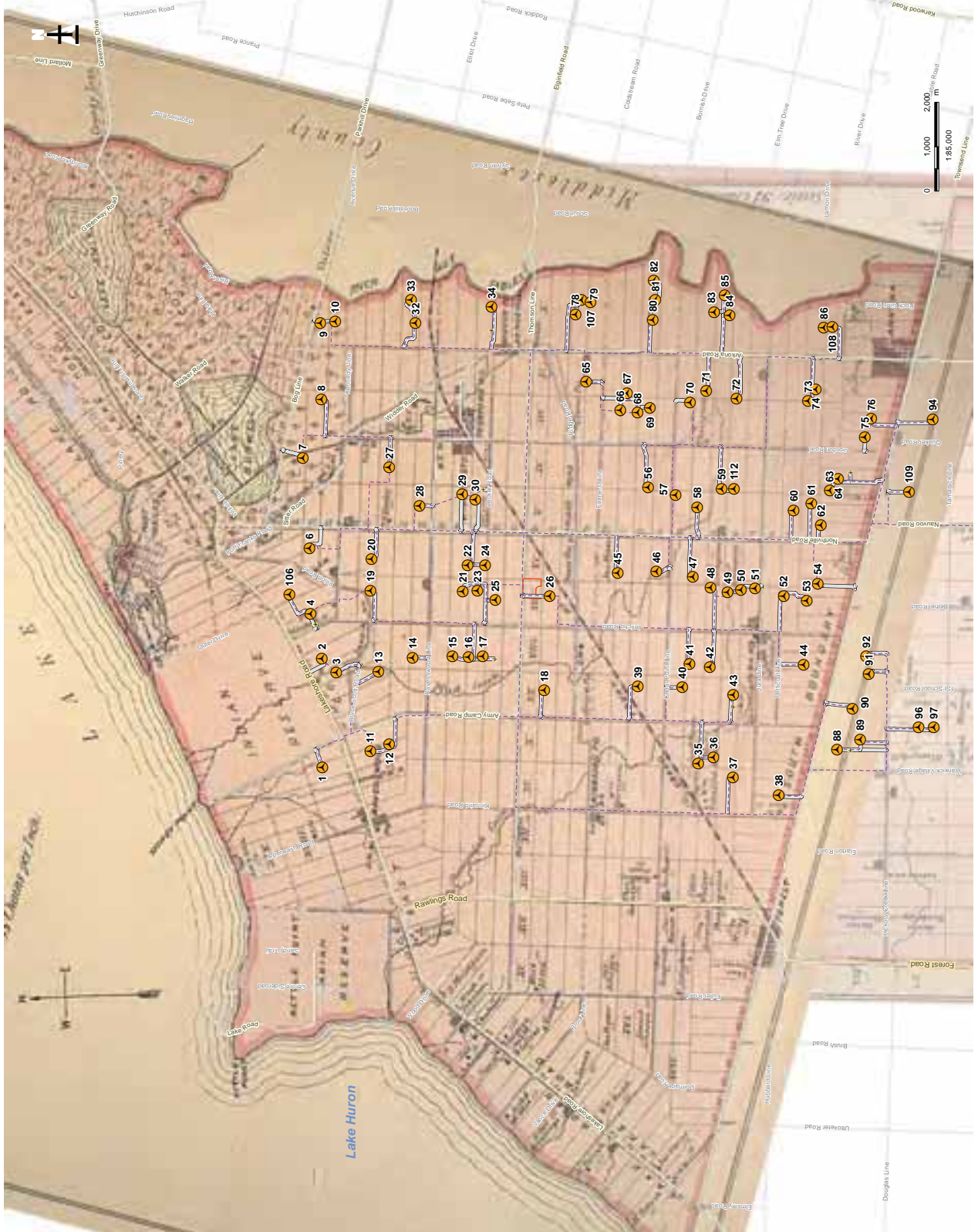

V:\160940227\160940228 - Jericho S/C and S/Work_program\dwg\160940227_S2_Fig3a_H1880Bosanquet.mxd
 Revised: 2013-08-16 By: carolambson

Legend

- Wind Turbine
- MET Tower
- Collector Line
- Laydown Area
- Access Road

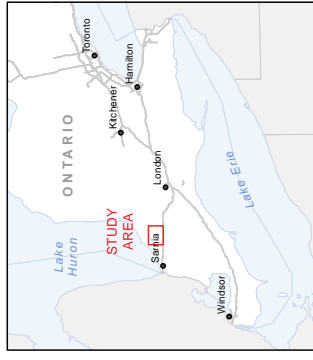

Notes

1. Historical information not to scale.
2. Bosanquet Township map from *Illustrated Historical Atlas of the County of Lambton*. Belden, H. and Co., 1880.



April 2013
16940227

Client/Project
Jericho Wind Inc
Jericho Wind Energy Centre
Stage 2 Archaeological Assessment

Figure No.
- 3b

A Portion of the 1880 Map of Warwick Township

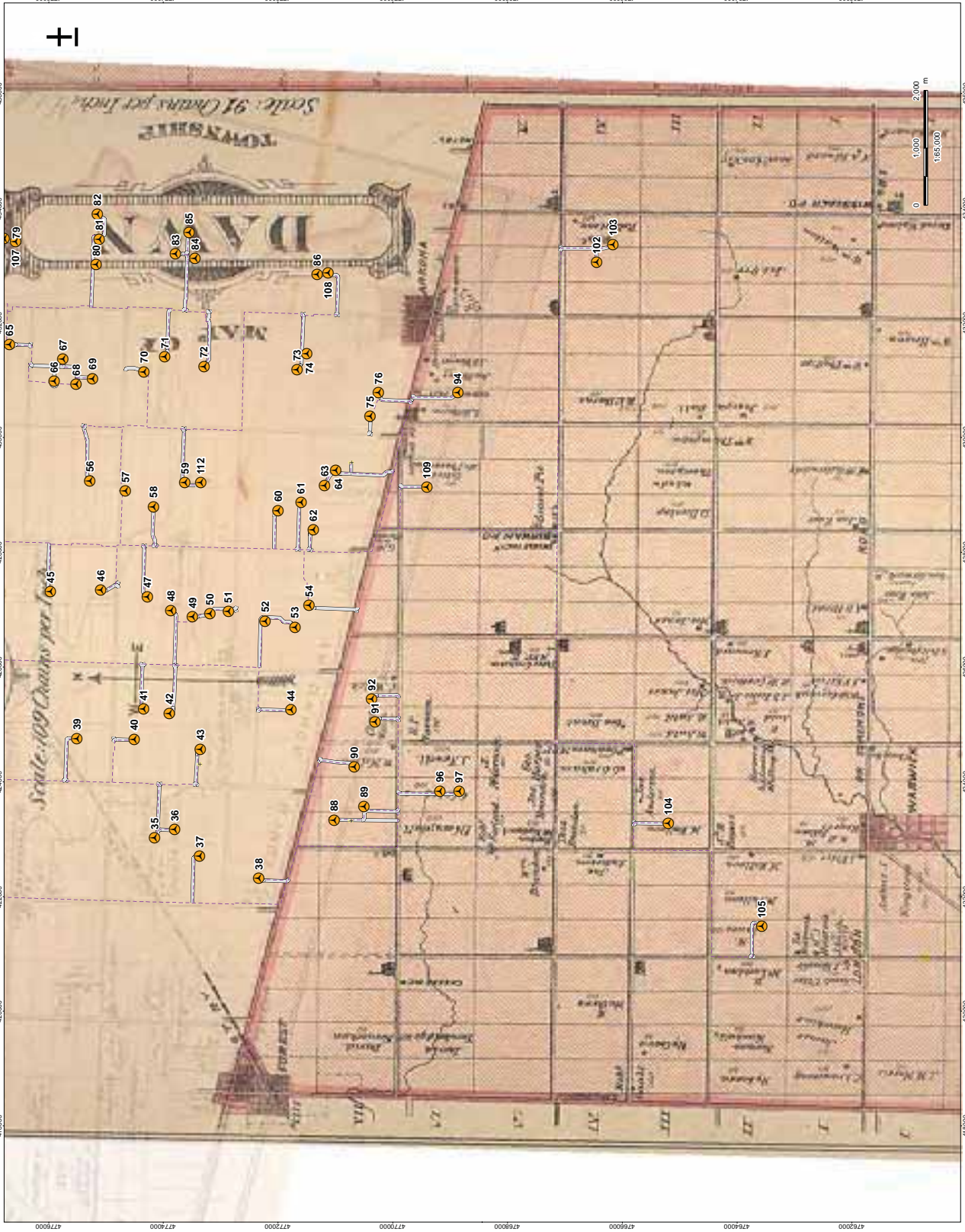

V:\16940227\16940227_48000_S0 and S1\work_program\warwick\03\Stage 2\16940227_S0_Fig 3b\Warwick.mxd
422000
458000
418000 420000 422000 424000 426000 428000 430000 432000 434000 436000 438000 440000 442000 444000 446000 448000 450000 452000 454000 456000 458000
418000 420000 422000 424000 426000 428000 430000 432000 434000 436000 438000 440000 442000 444000 446000 448000 450000 452000 454000 456000 458000
Revised: 2013-04-16 By: carolann

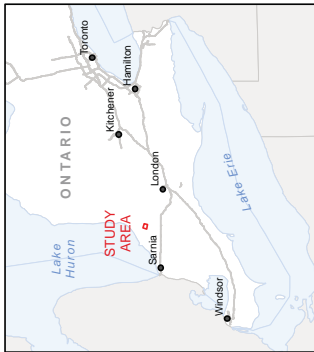
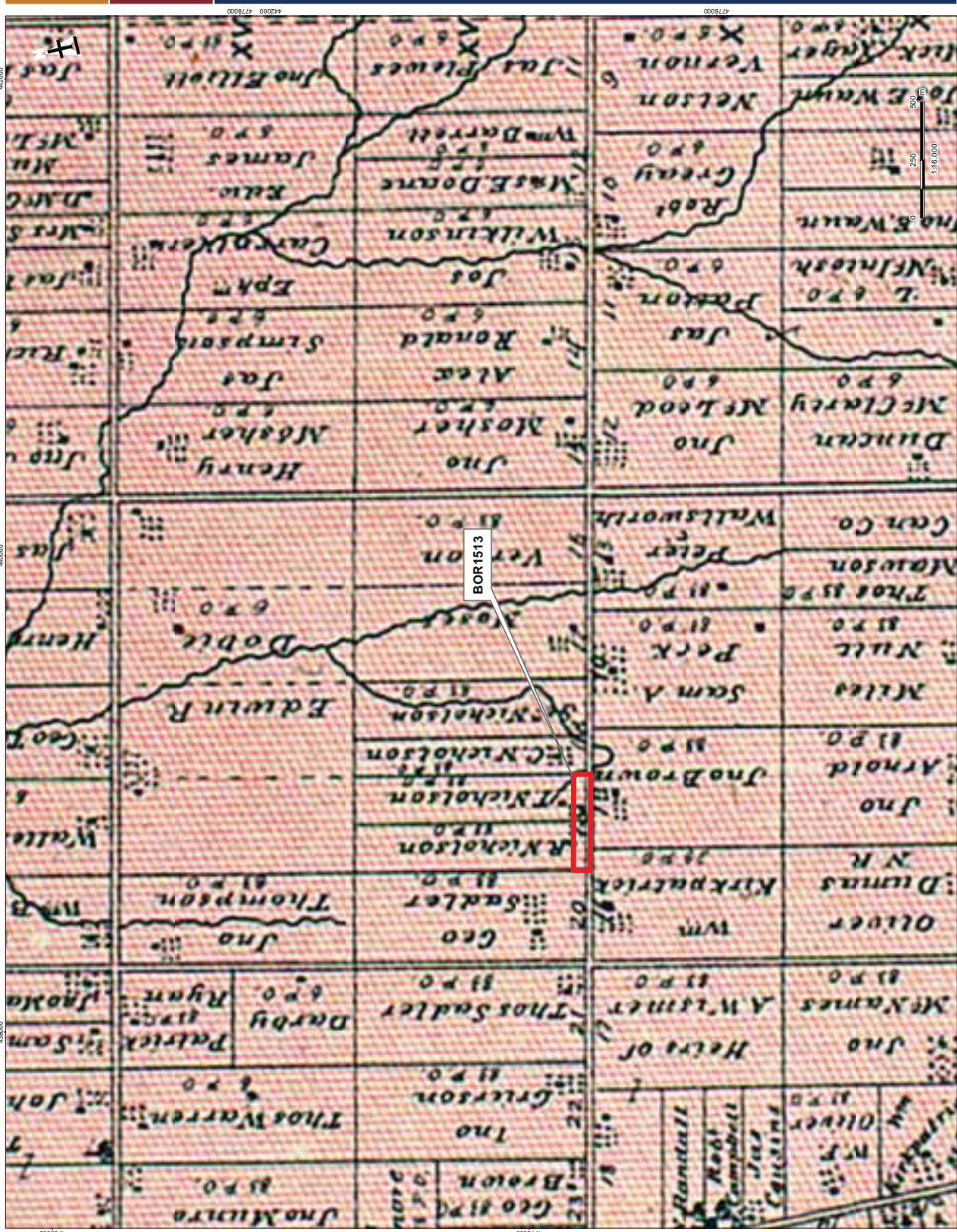

Notes

1. Historical information not to scale.
2. Williams Township map from Page & Co. 1878



Stantec

Client/Project
Jericho Wind Inc
Jericho Wind Energy Centre
Stage 2 Archaeological Assessment

Figure No.
e-3C

Title
**A Portion of the 1878 Map of
Williams Township**

April 2013
160940227



Legend

- Proposed Project Components
- Wind Turbine
- MET Tower
- Collector Line
- Laydown Area
- Access Road
- Previously Assessed Areas (Gold)

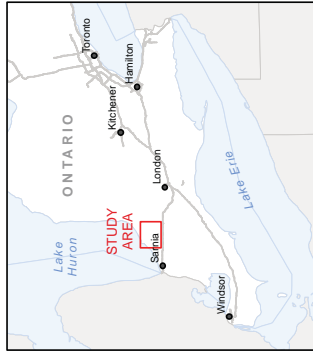

Notes

1. Coordinate System: NAD 1983 UTM Zone 17N
2. Base features produced under license with the Ontario Ministry of Natural Resources © Queen's Printer for Ontario, 2012.



August 2013
16PAA027

Client/Project
Jericho Wind Inc
Jericho Wind Energy Centre
Stage 2 Archaeological Assessment

Figure No.
4

Title

Previously Assessed Areas

V:\16PAA\workspace\16PAA027\16PAA027_Stage 2_Archaeological_Assessment.dwg
418000 419000 420000 421000 422000
4784000 4785000 4786000 4787000 4788000 4789000 4790000
Revised: 2013-08-16 By: carolmason

Legend

- Wind Turbine
- MET Tower
- Collector Line
- Laydown Area
- Access Road

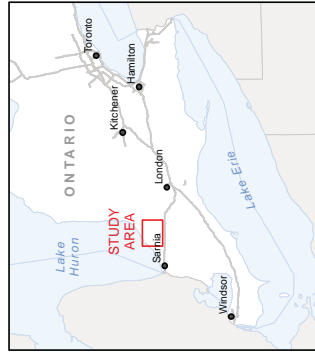

Notes

1. Coordinate System: NAD 1983 UTM Zone 17N
2. Base features produced under license with the Ontario Ministry of Natural Resources © Queen's Printer for Ontario, 2012.



August 2013
16PMAC27

Client/Project
Jericho Wind Inc
Jericho Wind Energy Centre
Stage 2 Archaeological Assessment

Figure No.
5.A

Title
Project Location

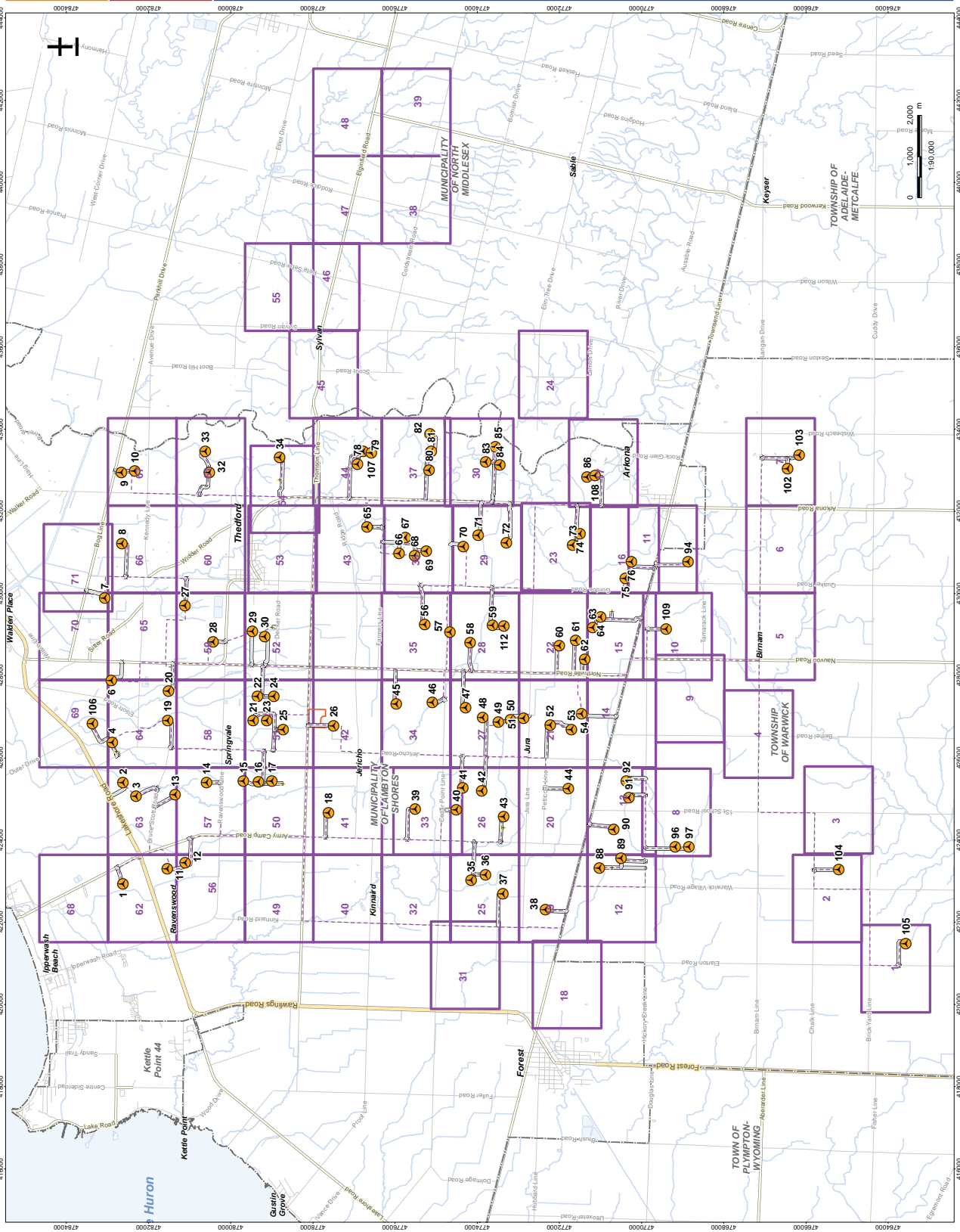

418000 419000 420000 421000 422000 423000 424000 425000 426000 427000 428000 429000 430000 431000 432000 433000 434000 435000 436000 437000 438000 439000 440000 441000 442000 443000 444000

418000 419000 420000 421000 422000 423000 424000 425000 426000 427000 428000 429000 430000 431000 432000 433000 434000 435000 436000 437000 438000 439000 440000 441000 442000 443000 444000

U:\16596\work\4238 - Jericho S2 and S2Arch\program\dwg\16596\Stage 2\16596\4227_S2C_figures_16\Project_Location.dwg
 Revised: 2013-08-16 By: carlamborn



- Legend**
- Photo Location
 - Proposed Project Components**
 - Turbine Location
 - Access Road
 - Construction Area
 - Collector Line
 - Met Tower
 - Survey Type**
 - Previously Disturbed Area - Not Assessed
 - Stage 2 Pedestrian Survey (assessed at 5 metre intervals)
 - Stage 2 Test Pit Survey (assessed at 5 metre intervals)
 - Previously Assessed
 - Existing Features**
 - Roads
 - Watercourse
 - Property Parcels

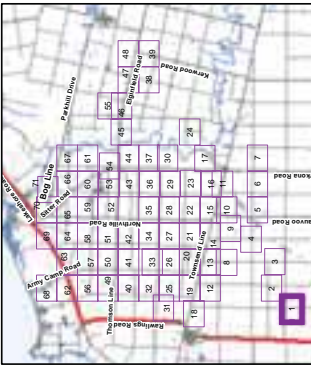

Notes

1. Coordinate System: NAD 1983 UTM Zone 17N
2. Base features produced under license with the Ontario Ministry of Natural Resources © Queen's University
3. Imagery Source: First Base Solutions, 2012 Imagery Date: 2010

Stantec

Client/Project
Jericho Wind Inc
Jericho Wind Energy Centre
Stage 2 Archaeological Assessment

Figure No. 5.1
Title

April 2013
160940227



- Legend**
- Photo Location
 - Proposed Project Components**
 - Turbine Location
 - Access Road
 - Construction Area
 - Collector Line
 - Met Tower
 - Survey Type**
 - Previously Disturbed Area - Not Assessed
 - Stage 2 Pedestrian Survey (assessed at 5 metre intervals)
 - Stage 2 Test Pit Survey (assessed at 5 metre intervals)
 - Previously Assessed
 - Existing Features**
 - Roads
 - Watercourse
 - Property Parcels

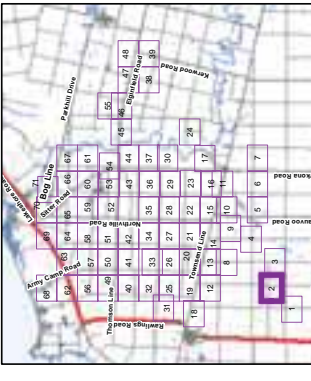

Notes

1. Coordinate System: NAD 1983 UTM Zone 17N
2. Base features produced under license with the Ontario Ministry of Natural Resources © Queen's University
3. Imagery Source: © First Base Solutions, 2012
- Imagery Date: 2010

Stantec

Client/Project
 Jericho Wind Inc
 Jericho Wind Energy Centre
 Stage 2 Archaeological Assessment

Figure No.
 5.2

Title
 Methods

April 2013
 1609A0227



Legend

- Photo Location
- Proposed Project Components**
 - Turbine Location
 - Access Road
 - Construction Area
 - Collector Line
 - Met Tower
- Survey Type**
 - Previously Disturbed Area - Not Assessed
 - Stage 2 Pedestrian Survey (assessed at 5 metre intervals)
 - Stage 2 Test Pit Survey (assessed at 5 metre intervals)
 - Previously Assessed
- Existing Features**
 - Roads
 - Watercourse
 - Property Parcels

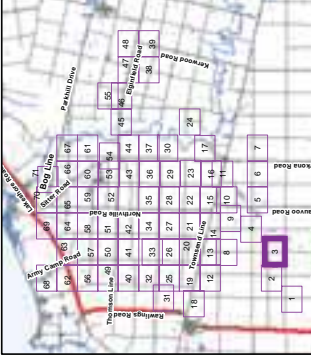

Notes

1. Coordinate System: NAD 1983 UTM Zone 17N
2. Base features produced under license with the Ontario Ministry of Natural Resources © Queen's University
3. Imagery Source: © First Base Solutions, 2012
Imagery Date: 2010



Client/Project
Jericho Wind Inc
Jericho Wind Energy Centre
Stage 2 Archaeological Assessment

Figure No. 5.3
Title

Methods

V:\0169\stake\169\4228 - Jericho S/C and S/Work_program\stake\img\KDS\figs\5.3\169\4227_S2_Fig5.3_MethodsPhotoaerial.mxd
Revised: 2013-08-16 By: carolmason



Legend

- Photo Location
- Proposed Project Components**
 - Turbine Location
 - Access Road
 - Construction Area
 - Collector Line
 - Met Tower
- Survey Type**
 - Previously Disturbed Area - Not Assessed
 - Stage 2 Pedestrian Survey (assessed at 5 metre intervals)
 - Stage 2 Test Pit Survey (assessed at 5 metre intervals)
 - Previously Assessed
- Existing Features**
 - Roads
 - Watercourse
 - Property Parcels

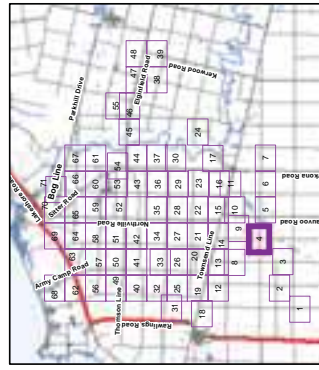

Notes

1. Coordinate System: NAD 1983 UTM Zone 17N
2. Base features produced under license with the Ontario Ministry of Natural Resources © Queen's University
3. Imagery Source: © First Base Solutions, 2012
Imagery Date: 2010



August 2013
160940227

Client/Project
Jericho Wind Inc
Jericho Wind Energy Centre
Stage 2 Archaeological Assessment

Figure No.
5.4

Title
Methods



- Legend**
- Photo Location
 - Proposed Project Components**
 - Turbine Location
 - Access Road
 - Construction Area
 - Collector Line
 - Met Tower
 - Survey Type**
 - Previously Disturbed Area - Not Assessed
 - Stage 2 Pedestrian Survey (assessed at 5 metre intervals)
 - Stage 2 Test Pit Survey (assessed at 5 metre intervals)
 - Previously Assessed
 - Existing Features**
 - Roads
 - Watercourse
 - Property Parcels

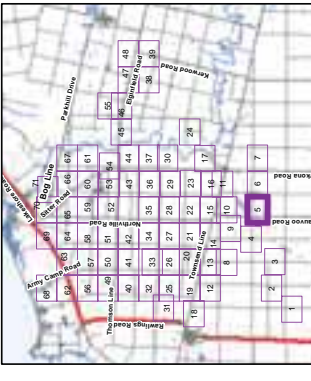

Notes

1. Coordinate System: NAD 1983 UTM Zone 17N
2. Base features produced under license with the Ontario Ministry of Natural Resources © Queen's University
3. Imagery Source: © First Base Solutions, 2012
Imagery Date: 2010

Stantec

Client/Project
Jericho Wind Inc
Jericho Wind Energy Centre
Stage 2 Archaeological Assessment

Figure No. 5.5
Title

August 2013
160940227

Methods

V:\0160940227\160940228 - Jericho S/C and S/Werk_program\dwg\0160940227_SG_Fig5.5_MethodsPhotoAerial.mxd
 Revised: 2013-08-16 By: carolmason



- Legend**
- Photo Location
 - Proposed Project Components**
 - Turbine Location
 - Access Road
 - Construction Area
 - Collector Line
 - Met Tower
 - Survey Type**
 - Previously Disturbed Area - Not Assessed
 - Stage 2 Pedestrian Survey (assessed at 5 metre intervals)
 - Stage 2 Test Pit Survey (assessed at 5 metre intervals)
 - Previously Assessed
 - Existing Features**
 - Roads
 - Watercourse
 - Property Parcels

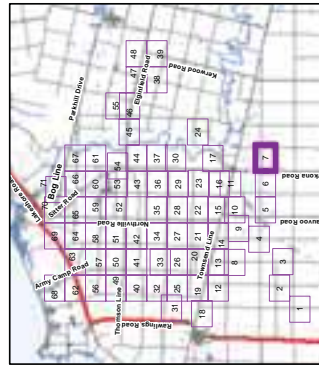

Notes

1. Coordinate System: NAD 1983 UTM, Zone 17N
2. Base features produced under license with the Ontario Ministry of Natural Resources © Queen's University
3. Imagery Source: © First Base Solutions, 2012
Imagery Date: 2010

Stantec

Client/Project
Jericho Wind Inc
Jericho Wind Energy Centre
Stage 2 Archaeological Assessment

Figure No. 5.7
Title

April 2013
160940227

Methods



Legend

- Photo Location
- Proposed Project Components**
 - Turbine Location
 - Access Road
 - Construction Area
 - Collector Line
 - Met Tower
- Survey Type**
 - Previously Disturbed Area - Not Assessed
 - Stage 2 Pedestrian Survey (assessed at 5 metre intervals)
 - Stage 2 Test Pit Survey (assessed at 5 metre intervals)
 - Previously Assessed
- Existing Features**
 - Roads
 - Watercourse
 - Property Parcels

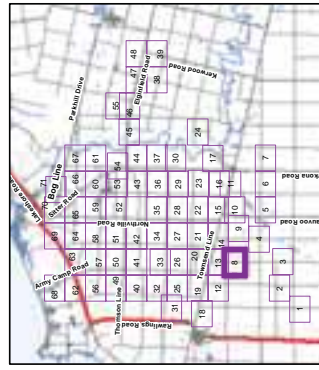

Notes

1. Coordinate System: NAD 1983 UTM Zone 17N
2. Base features produced under license with the Ontario Ministry of Natural Resources © Queen's University
3. Imagery Source: © First Base Solutions, 2012
Imagery Date: 2010



Client/Project
Jericho Wind Inc
Jericho Wind Energy Centre
Stage 2 Archaeological Assessment

Figure No. 5.8
Title

Methods

V:\01694228\1694228 - Jericho S/C and Stewk_program\dwg\01694227_S0_Fig5X_MethodPhotomosaic.mxd
Revised: 2013-08-16 By: carolmason



- Legend**
- Photo Location
 - Proposed Project Components**
 - Turbine Location
 - Access Road
 - Construction Area
 - Collector Line
 - Met Tower
 - Survey Type**
 - Previously Disturbed Area - Not Assessed
 - Stage 2 Pedestrian Survey (assessed at 5 metre intervals)
 - Stage 2 Test Pit Survey (assessed at 5 metre intervals)
 - Previously Assessed
 - Existing Features**
 - Roads
 - Watercourse
 - Property Parcels

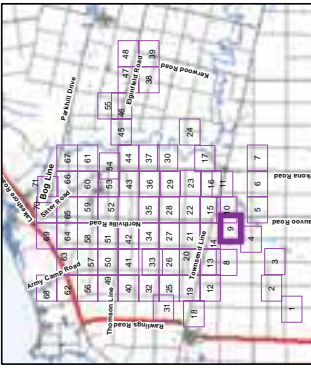

Notes

1. Coordinate System: NAD 1983 UTM Zone 17N
2. Base features produced under license with the Ontario Ministry of Natural Resources © Queen's University
3. Imagery Source: © First Base Solutions, 2012
Imagery Date: 2010

Stantec

Client/Project
Jericho Wind Inc
Jericho Wind Energy Centre
Stage 2 Archaeological Assessment

Figure No. 5.9
Title

August 2013
1609A0227

Methods

V:\01609a0227\01609a0228 - Jericho S/O and Stantec program\dwg\01609a0227_SG_Fig5.9_MethodsPhotocaption.mxd
Revised: 2013-08-16 By: carolmason



- Legend**
- Photo Location
 - Proposed Project Components**
 - Turbine Location
 - Access Road
 - Construction Area
 - Collector Line
 - Met Tower
 - Survey Type**
 - Previously Disturbed Area - Not Assessed
 - Stage 2 Pedestrian Survey (assessed at 5 metre intervals)
 - Stage 2 Test Pit Survey (assessed at 5 metre intervals)
 - Previously Assessed
 - Existing Features**
 - Roads
 - Watercourse
 - Property Parcels

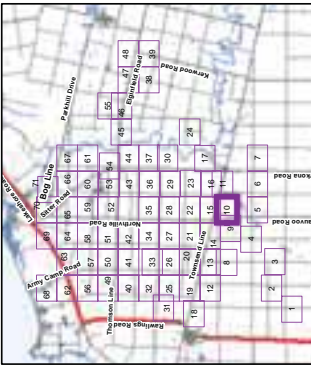

Notes

1. Coordinate System: NAD 1983 UTM Zone 17N
2. Base features produced under license with the Ontario Ministry of Natural Resources © Queen's University
3. Imagery Source: © First Base Solutions, 2012
Imagery Date: 2010

Stantec

Client/Project
Jericho Wind Inc
Jericho Wind Energy Centre
Stage 2 Archaeological Assessment

Figure No. 5.10
Title

August 2013
160940227

Methods



Legend

- Photo Location
- Proposed Project Components**
 - Turbine Location
 - Access Road
 - Construction Area
 - Collector Line
 - Met Tower
- Survey Type**
 - Previously Disturbed Area - Not Assessed
 - Stage 2 Pedestrian Survey (assessed at 5 metre intervals)
 - Stage 2 Test Pit Survey (assessed at 5 metre intervals)
 - Previously Assessed
- Existing Features**
 - Roads
 - Watercourse
 - Property Parcels

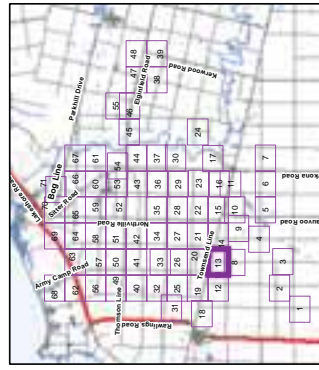

Notes

1. Coordinate System: NAD 1983 UTM Zone 17N
2. Base features produced under license with the Ontario Ministry of Natural Resources © Queen's University
3. Imagery Source: © First Base Solutions, 2012 Imagery Date: 2010

Client/Project
Jericho Wind Inc
Jericho Wind Energy Centre
Stage 2 Archaeological Assessment

Figure No. 5.13
Title

Methods

V:\01694238\1694238 - Jericho S/C and Stewk_program\stewk\GIS\Stage 2\1694238_SG_Fig13X_MethodPhotoLocation.mxd
Revised: 2013-08-16 By: carolmason



- Legend**
- Photo Location
 - Proposed Project Components**
 - Turbine Location
 - Access Road
 - Construction Area
 - Collector Line
 - Met Tower
 - Survey Type**
 - Previously Disturbed Area - Not Assessed
 - Stage 2 Pedestrian Survey (assessed at 5 metre intervals)
 - Stage 2 Test Pit Survey (assessed at 5 metre intervals)
 - Previously Assessed
 - Existing Features**
 - Roads
 - Watercourse
 - Property Parcels

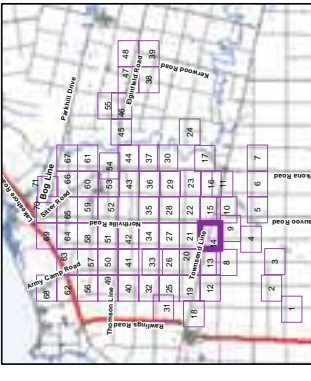

Notes

1. Coordinate System: NAD 1983 UTM, Zone 17N
2. Base features produced under license with the Ontario Ministry of Natural Resources © Queen's University
3. Imagery Source: © First Base Solutions, 2012
Imagery Date: 2010



Client/Project
Jericho Wind Inc
Jericho Wind Energy Centre
Stage 2 Archaeological Assessment

Figure No. 5.14
Title

August 2013
160940227

V:\016940227\016940228 - Jericho S/C and S/Work_program\dwg\016940227_SG_Fig14X_MethodPhotoAerial.mxd
Revised: 2013-08-16 By: carolmason

Legend

- Photo Location
- Proposed Project Components**
 - Turbine Location
 - Access Road
 - Construction Area
 - Collector Line
 - Met Tower
- Survey Type**
 - Previously Disturbed Area - Not Assessed
 - Stage 2 Pedestrian Survey (assessed at 5 metre intervals)
 - Stage 2 Test Pit Survey (assessed at 5 metre intervals)
 - Previously Assessed
- Existing Features**
 - Roads
 - Watercourse
 - Property Parcels

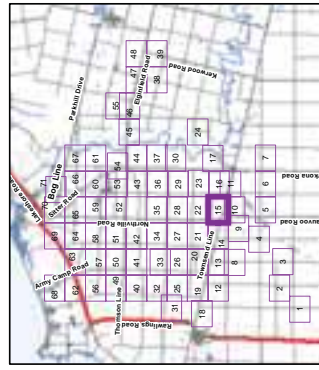

Notes

1. Coordinate System: NAD 1983 UTM Zone 17N
2. Base features produced under license with the Ontario Ministry of Natural Resources © Queen's University
3. Imagery Source: © First Base Solutions, 2012
Imagery Date: 2010

April 2013
1609A0227

Client/Project
Jericho Wind Inc
Jericho Wind Energy Centre
Stage 2 Archaeological Assessment

Figure No. 5.15
Title

Methods



V:\01609a0227\01609a0228 - Jericho S2P and S2W\program\dwg\01609a0227_S2_Fig15X_MethodsPhotoLocation.mxd
Revised: 2013-08-16 By: carolmason



Legend

- Photo Location
- Proposed Project Components**
 - Turbine Location
 - Access Road
 - Construction Area
 - Collector Line
 - Met Tower
- Survey Type**
 - Previously Disturbed Area - Not Assessed
 - Stage 2 Pedestrian Survey (assessed at 5 metre intervals)
 - Stage 2 Test Pit Survey (assessed at 5 metre intervals)
 - Previously Assessed
- Existing Features**
 - Roads
 - Watercourse
 - Property Parcels

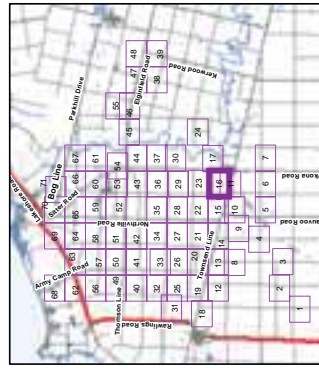

Notes

1. Coordinate System: NAD 1983 UTM Zone 17N
2. Base features produced under license with the Ontario Ministry of Natural Resources © Queen's University
3. Imagery Source: © First Base Solutions, 2012
- Imagery Date: 2010



Client/Project
 Jericho Wind Inc
 Jericho Wind Energy Centre
 Stage 2 Archaeological Assessment

Figure No. 5.16
 Title

Methods



Legend

- Photo Location
- Proposed Project Components**
 - Turbine Location
 - Access Road
 - Construction Area
 - Collector Line
 - Met Tower
- Survey Type**
 - Previously Disturbed Area - Not Assessed
 - Stage 2 Pedestrian Survey (assessed at 5 metre intervals)
 - Stage 2 Test Pit Survey (assessed at 5 metre intervals)
 - Previously Assessed
- Existing Features**
 - Roads
 - Watercourse
 - Property Parcels

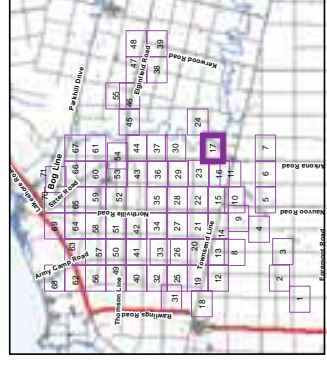

Notes

1. Coordinate System: NAD 1983 UTM Zone 17N
2. Base features produced under license with the Ontario Ministry of Natural Resources © Queen's University
3. Imagery Source: © First Base Solutions, 2012
Imagery Date: 2010



Client/Project
Jericho Wind Inc
Jericho Wind Energy Centre
Stage 2 Archaeological Assessment

Figure No. 5.17
Title

Methods

V:\16594238\16594238 - Jericho S2 and S2work_program\dwg\16594238_S2_Fig5X_MethodsPhotoLocation.mxd
Revised: 2013-08-16 By: carolmason



- Legend**
- Photo Location
 - Proposed Project Components**
 - Turbine Location
 - Access Road
 - Construction Area
 - Collector Line
 - Met Tower
 - Survey Type**
 - Previously Disturbed Area - Not Assessed
 - Stage 2 Pedestrian Survey (assessed at 5 metre intervals)
 - Stage 2 Test Pit Survey (assessed at 5 metre intervals)
 - Previously Assessed
 - Existing Features**
 - Roads
 - Watercourse
 - Property Parcels

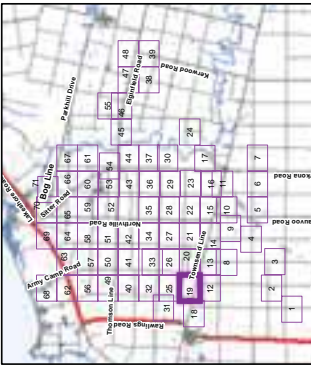

Notes

1. Coordinate System: NAD 1983 UTM, Zone 17N
2. Base features produced under license with the Ontario Ministry of Natural Resources © Queen's University
3. Imagery Source: © First Base Solutions, 2012
Imagery Date: 2010

Stantec

Client/Project
Jericho Wind Inc
Jericho Wind Energy Centre
Stage 2 Archaeological Assessment

Figure No. 5.19
Title

August 2013
1609A0227

Methods

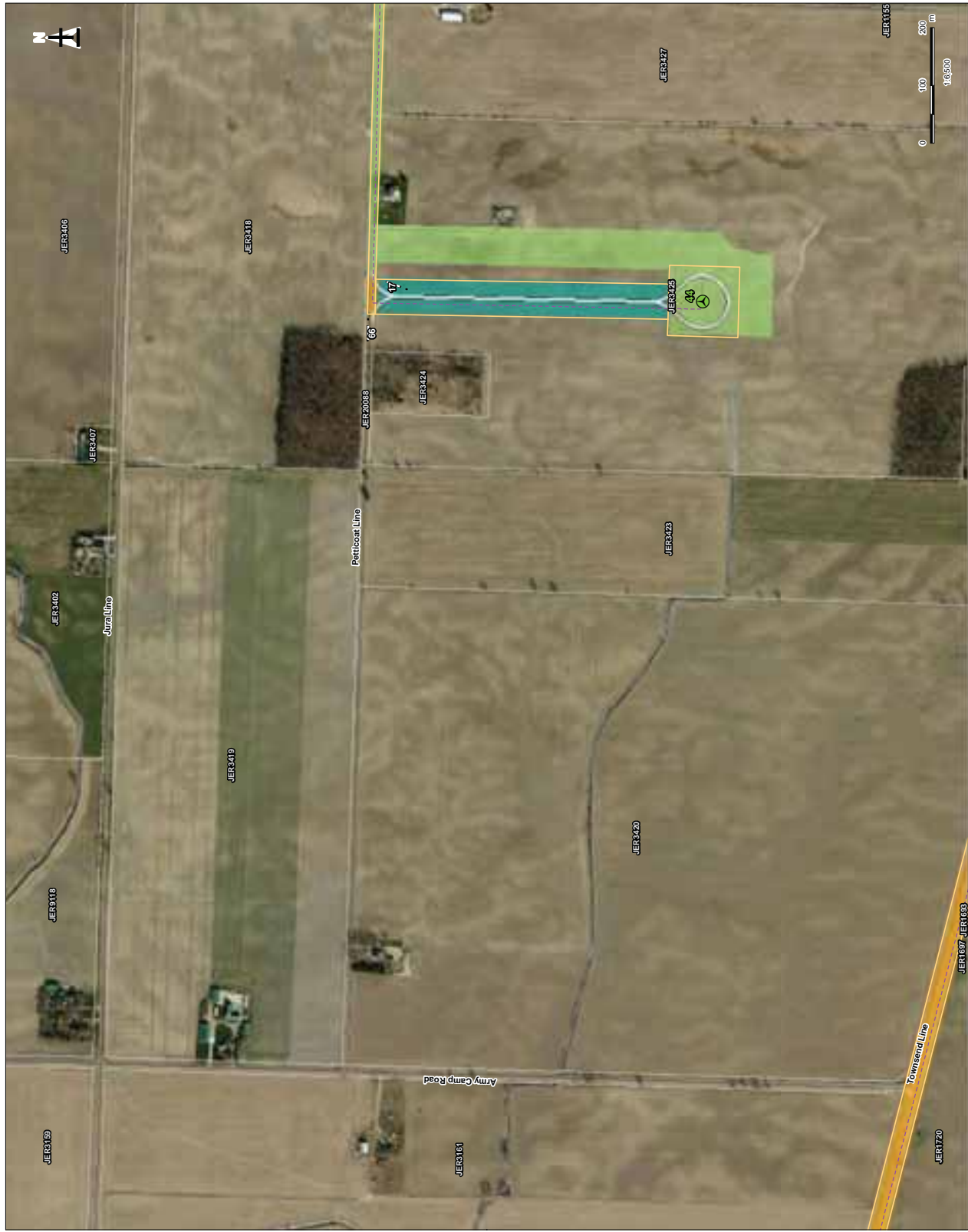

- Legend**
- Photo Location
 - Proposed Project Components**
 - Turbine Location
 - Access Road
 - Construction Area
 - Collector Line
 - Met Tower
 - Survey Type**
 - Previously Disturbed Area - Not Assessed
 - Stage 2 Pedestrian Survey (assessed at 5 metre intervals)
 - Stage 2 Test Pit Survey (assessed at 5 metre intervals)
 - Previously Assessed
 - Existing Features**
 - Roads
 - Watercourse
 - Property Parcels

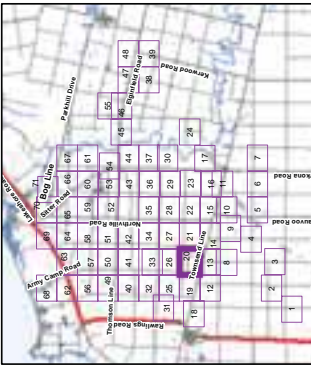

Notes

1. Coordinate System: NAD 1983 UTM Zone 17N
2. Base features produced under license with the Ontario Ministry of Natural Resources © Queen's University
3. Imagery Source: © First Base Solutions, 2012. Imagery Date: 2010

Stantec

Client/Project
 Jericho Wind Inc
 Jericho Wind Energy Centre
 Stage 2 Archaeological Assessment

Figure No. 5.20
 Title

August 2013
 1609A0227

Methods

V:\01609a0227\1609a0228 - Jericho S/C and S/Work_program\dwg\01609a0227_SG_Fig5XX_MethodPhotoAerial.mxd
 Revised: 2013-08-16 By: carolmason